

TRAFFIC SIGNAL LEGEND

	PROPOSED	EXISTING
DETECTOR LOOP		
SIGNAL HEAD		
G.S. CONDUIT IN TRENCH OR PUSHED		
SIGNAL HEAD WITH BACKPLATE		
RACEWAY FOR MAGNETIC DETECTOR, TYPE I OR II		
VEHICLE DETECTOR, NON-COMPENSATED MAGNETIC TYPE		

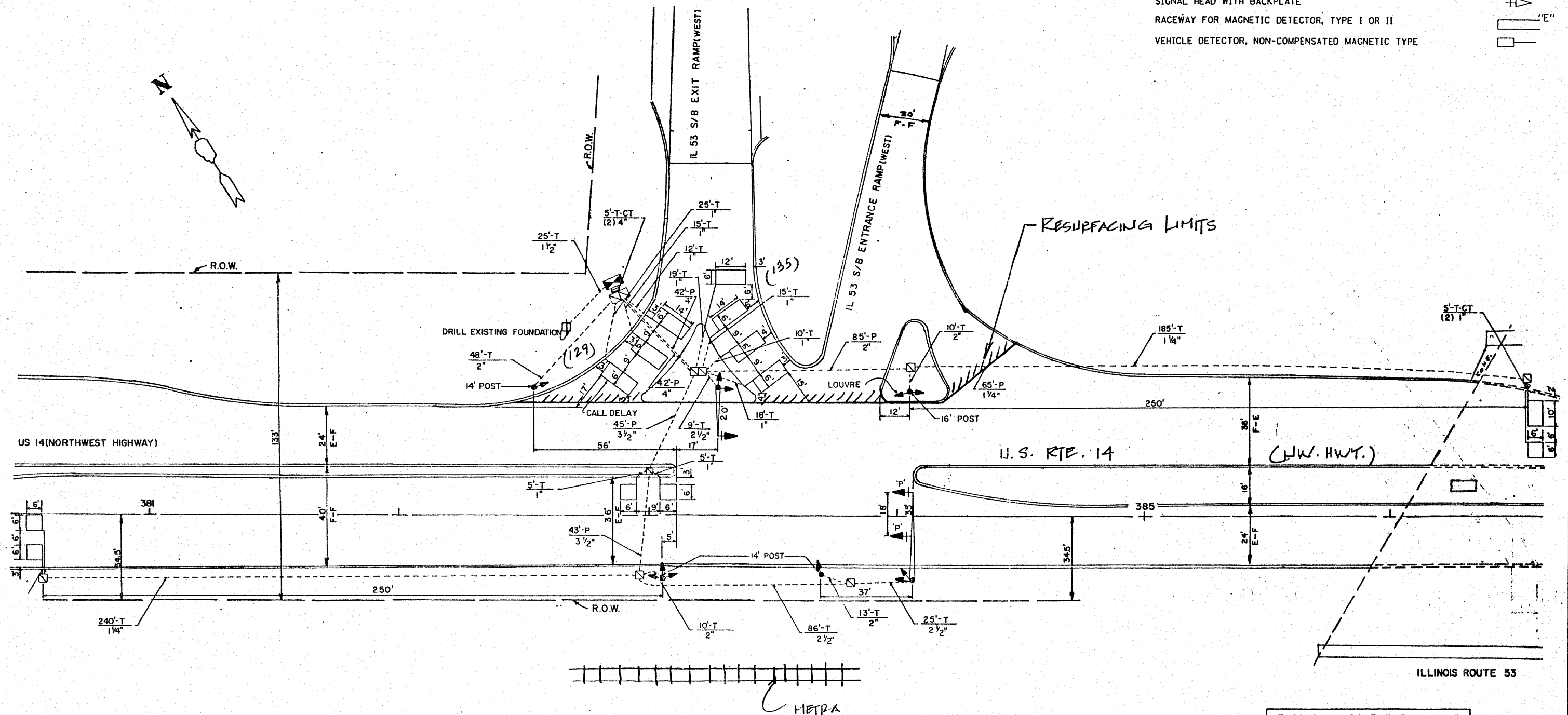

THIS PLAN IS FOR THE SOLE PURPOSE OF DETECTOR LOOP REPLACEMENTS ONLY

REPLACE ALL DETECTOR LOOPS AS SHOWN (WITHIN THE RESURFACING LIMITS)

CODE	QUANTITY	UNIT	ITEM
88600600	264	FOOT	DETECTOR LOOP, REPLACEMENT

FILE NAME *	USER NAME = kanthaphixaybc	DESIGNED - BCK	REVISED -
c:\pwworkspace\1001\KANTHAPHIXAYBC\JOB1126	4\Traffic.Legend.v7.dgn	DRAWN* - BCK	REVISED -
	PLOT SCALE = 39.9368' / IN.	CHECKED - DAD	REVISED -

STATE OF ILLINOIS
DEPARTMENT OF TRANSPORTATION

DISTRICT ONE - DETECTOR LOOP REPLACEMENT
ILL. ROUTE 53 (W. RAMP) @ U.S. RTE. 14

F.A.P. RTE.	SECTION	COUNTY	TOTAL SHEETS	SHEET NO.
290	1531-3, 1, 0 305-302	COOK	314	277
CONTRACT NO.			60138	

SCALE: NONE SHEET NO. OF SHEETS STA. TO STA.