

TRAFFIC SIGNAL LEGEND

	PROPOSED	EXISTING
CONTROLLER		
SERVICE INSTALLATION		
SIGNAL HEAD		
SIGNAL HEAD WITH BACKPLATE		
SIGNAL HEAD, PEDESTRIAN		
SIGNAL POST		
MAST ARM ASSEMBLY AND POLE, STEEL		
MAST ARM ASSEMBLY AND POLE, ALUMINUM		
HANDHOLE		
HEAVY DUTY HANDHOLE		
DOUBLE HANDHOLE		
C.S. CONDUIT IN TRENCH OR PUSHED		
UPPER NO. INDICATES LENGTH, LOWER NO. IS SIZE "T", "P", & "CT" INDICATE CONDUIT TRENCHED, PUSHED, OR IN COMMON TRENCH, RESPECTIVELY	$\frac{12-T}{2}$	$(23-E-2)$ FIRST NO. IS LENGTH SECOND NO. IS SIZE
PEDESTRIAN CALL PUSHBUTTON		
DETECTOR LOOP		
PRE-INSTALLED SIGNAL HEAD		
UNIT DUCT		
RECYCLAL		
TRAFFIC SIGNAL EQUIPMENT TO BE REMOVED		
LIGHT DETECTOR CONFIRMATION BEACON		

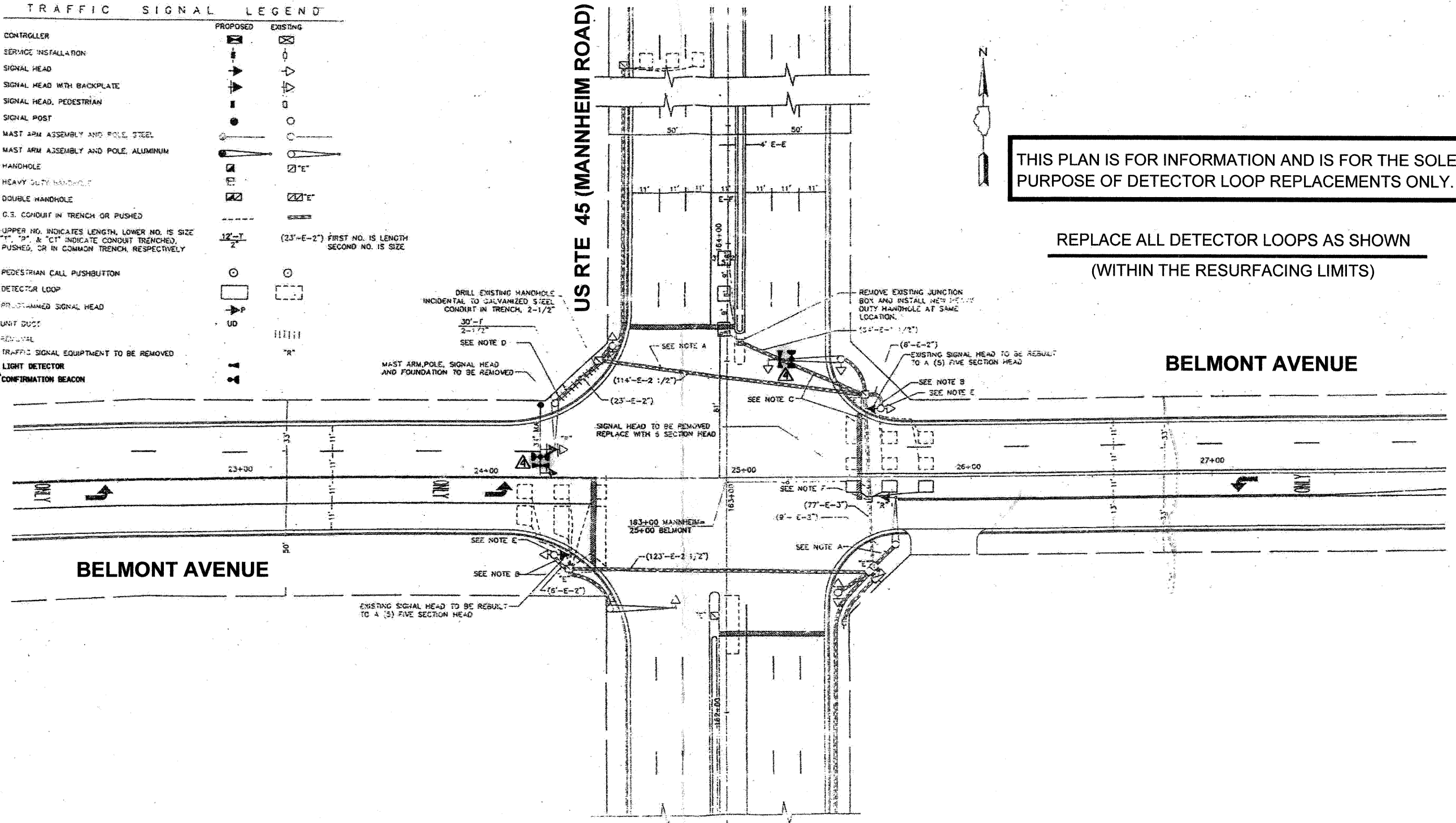

THIS PLAN IS FOR INFORMATION AND IS FOR THE SOLE PURPOSE OF DETECTOR LOOP REPLACEMENTS ONLY.

REPLACE ALL DETECTOR LOOPS AS SHOWN
(WITHIN THE RESURFACING LIMITS)

CODE	QUANTITY	UNIT	ITEM
88600600	1130	FOOT	DETECTOR LOOP REPLACEMENT