

TRAFFIC SIGNAL LEGEND

	PROPOSED	EXISTING
DETECTOR LOOP		
SIGNAL HEAD		
G.S. CONDUIT IN TRENCH OR PUSHED		
SIGNAL HEAD WITH BACKPLATE		
RACEWAY FOR MAGNETIC DETECTOR, TYPE I OR II		
VEHICLE DETECTOR, NON-COMPENSATED MAGNETIC TYPE		

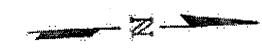

QUARRY ENTR.

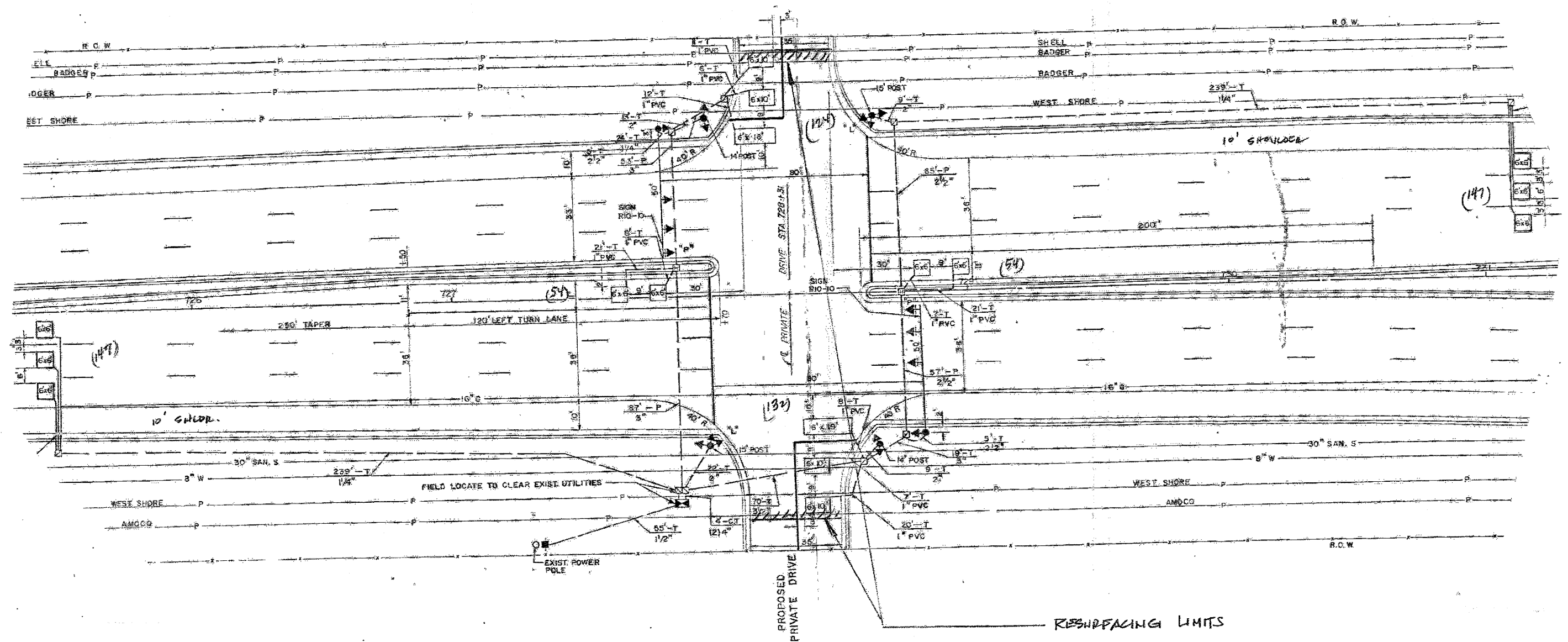

ELMHURST - CHICAGO STONE COMPANY.

THIS PLAN IS FOR THE SOLE PURPOSE OF DETECTOR LOOP REPLACEMENTS ONLY

REPLACE ALL DETECTOR LOOPS AS SHOWN (WITHIN THE RESURFACING LIMITS)

CODE	QUANTITY	UNIT	ITEM
86600600	658	FOOT	DETECTOR LOOP, REPLACEMENT

FILE NAME =	USER NAME = kentphuzgbc	DESIGNED - BCK	REVISED -
ct:\pwwork\PHIDOT\KANTHAPHIXAYBC\081126	1\traffic\legend_v7.dgn	DRAWN - BCK	REVISED -
	PLOT SCALE = 3/4" = 1' IN.	CHECKED - DAD	REVISED -
	PLOT DATE = 4/3/2009	DATE	REVISED -

STATE OF ILLINOIS
DEPARTMENT OF TRANSPORTATION

DISTRICT ONE - DETECTOR LOOP REPLACEMENT
ILL. ROUTE 83 @ STONE QUARRY DR.
SCALE: NONE SHEET NO. OF SHEETS STA. TO STA.

F.A.P. RTE. 344	SECTION 543-X-RS-2	COUNTY DuPage	TOTAL SHEETS 30	SHEET NO. 16
FED. ROAD DIST. NO.		ILLINOIS FED. AID PROJECT CONTRACT NO. 60J20		