

I-55 NB & SB TO LAGRANGE RD SB DETOUR

- NOTE 1: EXIT RAMP CLOSURE TO FOLLOW DISTRICT DETAIL FOR FREEWAY ENTRANCE AND EXIT RAMP CLOSURE DETAILS (TC-8).
- NOTE 2: ADD PORTABLE CHANGEABLE MESSAGE SIGN (PCMS) AT THE EAST SIDE OF IL 171 ON SOUTHBOUND I-55.
- NOTE 3: ADD PORTABLE CHANGEABLE MESSAGE SIGN (PCMS) AT THE WEST SIDE OF IL 173 ON NORTHBOUND I-55.

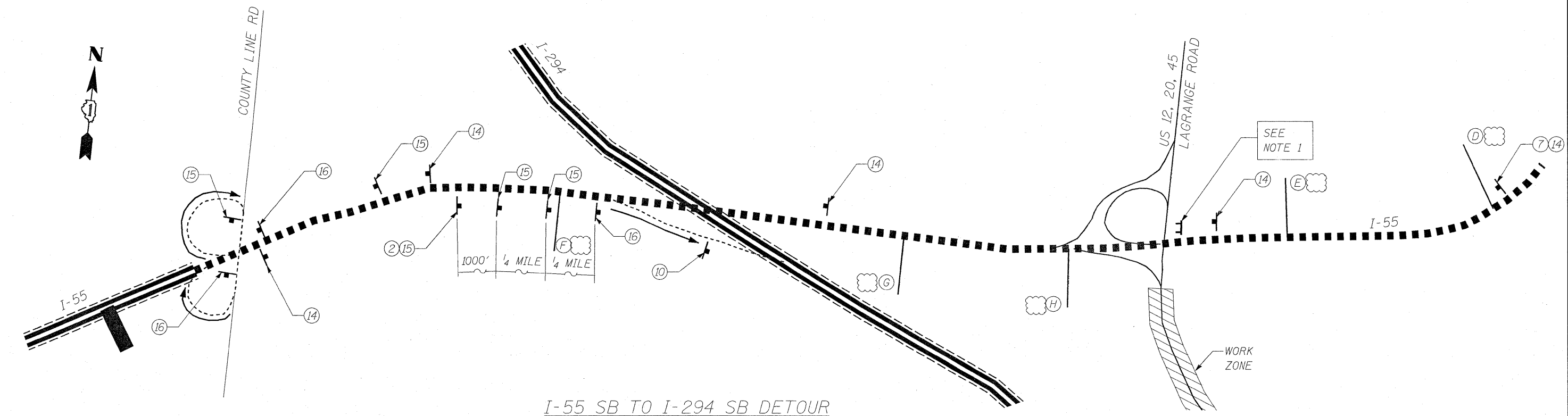

I-55 SB TO I-294 SB DETOUR

	DESIGNED - MJY	REVISED - 4/13/2010	<b>STATE OF ILLINOIS</b> <b>DEPARTMENT OF TRANSPORTATION</b>	<b>DETOUR PLAN - OVERVIEW</b> <b>US 12, 20, 45 SB (LA GRANGE RD) OVER SANTA FE DR, RRs, DES PLAINES</b>		F.A.P. RTE. 330	SECTION 462 X-B-1	COUNTY COOK	TOTAL SHEETS 54	SHEET NO. 19
	DRAWN - SV	CHECKED - MJY, DC		DATE - 01/29/2010	SCALE: NONE	SHEET NO. 19 OF 54 SHEETS	STA. 31+99.36 TO STA. 69+00.70	D-91-227-10 CONTRACT NO. 60J37 <small>FED. ROAD DIST. NO. [ILLINOIS] FED. AID PROJECT</small>		

Rev Sheet 4-13-10