

EXISTING TYPICAL SECTION
STA. 31+99.36 TO STA. 41+29.23
STA. 68+66.40 TO STA 69+00.70

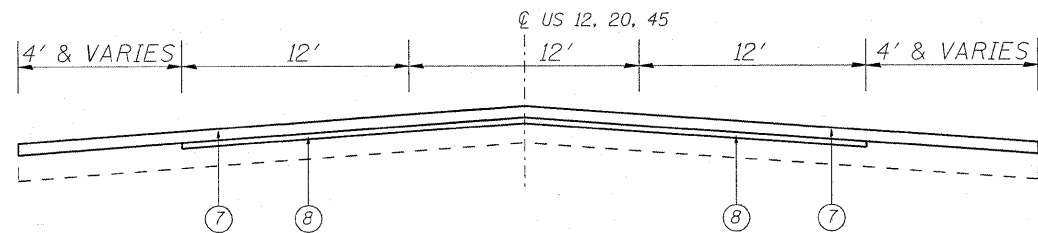

PROPOSED TYPICAL SECTION
STA. 31+99.36 TO STA. 41+29.23
STA. 68+66.40 TO STA 69+00.70

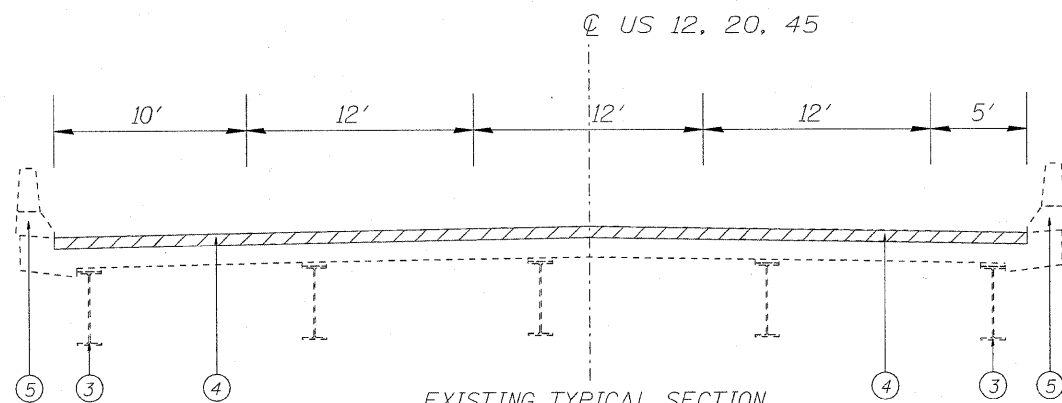

EXISTING TYPICAL SECTION
STA. 41+29.23 TO STA. 68+66.40

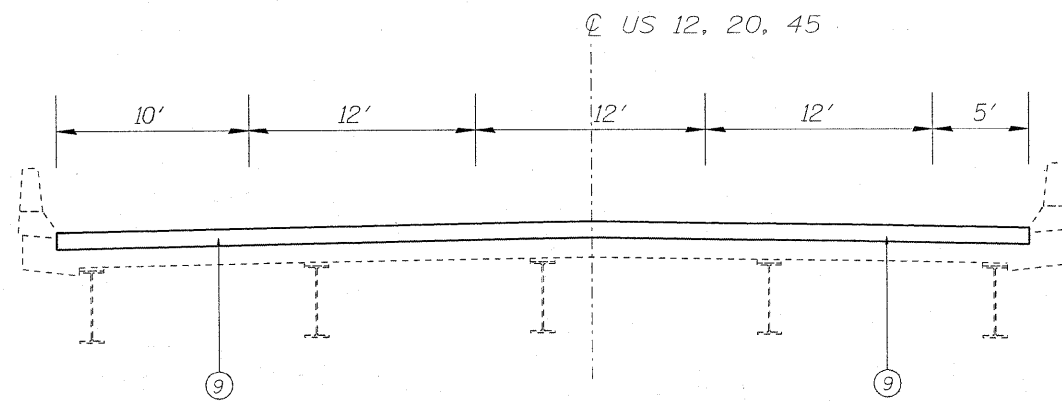

PROPOSED TYPICAL SECTION
STA. 41+29.23 TO STA. 68+66.40

LEGEND

- ① EXISTING HMA OVERLAY
- ② EXISTING BASE COURSE, 4"
- ③ EXISTING WF STEEL BEAMS
- ④ EXISTING BRIDGE DECK HYDRO-SCARIFICATION, 1/2"
- ⑤ EXISTING PARAPET WALLS
- ⑥ PROPOSED HOT-MIX ASPHALT SURFACE REMOVAL, VARIABLE DEPTH
- ⑦ PROPOSED POLYMERIZED HMA SURFACE CSE., MIX "F", N90, 1 3/4"
- ⑧ PROPOSED LEVELING BINDER (MACHINE METHOD), N70, 3/4"
- ⑨ PROPOSED BRIDGE DECK LATEX CONCRETE OVERLAY, 2 1/4"
- ⑩ HMA SURFACE REMOVAL, 1 1/2"

| HOT-MIX ASPHALT MIXTURE REQUIREMENTS | | |
|--------------------------------------|--|------------------|
| OPERATION | MIXTURE TYPE | DESIGN AIR VOIDS |
| ROADWAY | POLYMERIZED HMA SURFACE COURSE, MIX "F", N90 (IL 9.5 mm), 1 3/4" | 4% @ 90 GYR |
| | LEVELING BINDER (MACHINE METHOD), N70, 3/4" | 4% @ 70 GYR |
| SHOULDER | POLYMERIZED HMA SURFACE COURSE, MIX "F", N90 (IL 9.5 mm), 1 3/4" | 4% @ 90 GYR |
| HMA PAVEMENT (FULL DEPTH), 12" | POLYMERIZED HMA SURFACE COURSE, MIX "F", N90 (IL 9.5 mm), 1 3/4" | 4% @ 90 GYR |
| | LEVELING BINDER (MACHINE METHOD), N70, 10 1/4" | 4% @ 70 GYR |

NOTES:

THE UNIT WEIGHT USED TO CALCULATE ALL HMA SURFACE COURSE MIXTURES IS 112 LBS/SQ-YD/IN.

FOR "AC TYPE" FOR POLYMERIZED HMA MIXES SHALL BE "SBS/SBR PG 70 -22" AND FOR NON-POLYMERIZED HMA THE "AC TYPE" SHALL BE "PG 64 -22" UNLESS MODIFIED BY DISTRICT ONE SPECIAL PROVISIONS. FOR "PERCENT OF RAP" SEE DISTRICT ONE SPECIAL PROVISIONS.

GENERAL NOTES:

1. ALL PROPOSED PAVEMENT MARKINGS SHALL BE PLACED IN ACCORDANCE WITH "DISTRICT ONE TYPICAL PAVEMENT MARKINGS" (TC-13).
2. POLYUREA PAVEMENT MARKING TYPE I - LINE 4" SOLID WHITE SHALL BE PLACED ALONG 2" FROM EDGE OF PAVEMENT WHERE AGGREGATE OR HMA SHOULDER IS PRESENT.
3. IN ADDITION TO FIELD REVIEW AND AERIAL DATA, PLAN DIMENSIONS AND DETAILS RELATIVE TO THE EXISTING FACILITIES HAVE BEEN TAKEN FROM EXISTING PLANS AND ARE SUBJECT TO CONSTRUCTION VARIATIONS. IT SHALL BE THE CONTRACTOR'S RESPONSIBILITY TO VERIFY SUCH DIMENSIONS AND DETAILS IN THE FIELD. SUCH VARIATIONS SHALL NOT BE A CAUSE FOR ADDITIONAL COMPENSATION DUE TO A CHANGE IN THE SCOPE OF THE WORK. HOWEVER, THE CONTRACTOR WILL BE PAID FOR THE QUANTITY ACTUALLY FURNISHED AT THE BID PRICE FOR THE WORK.

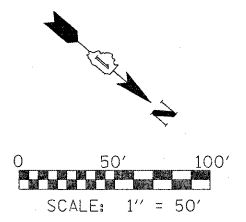
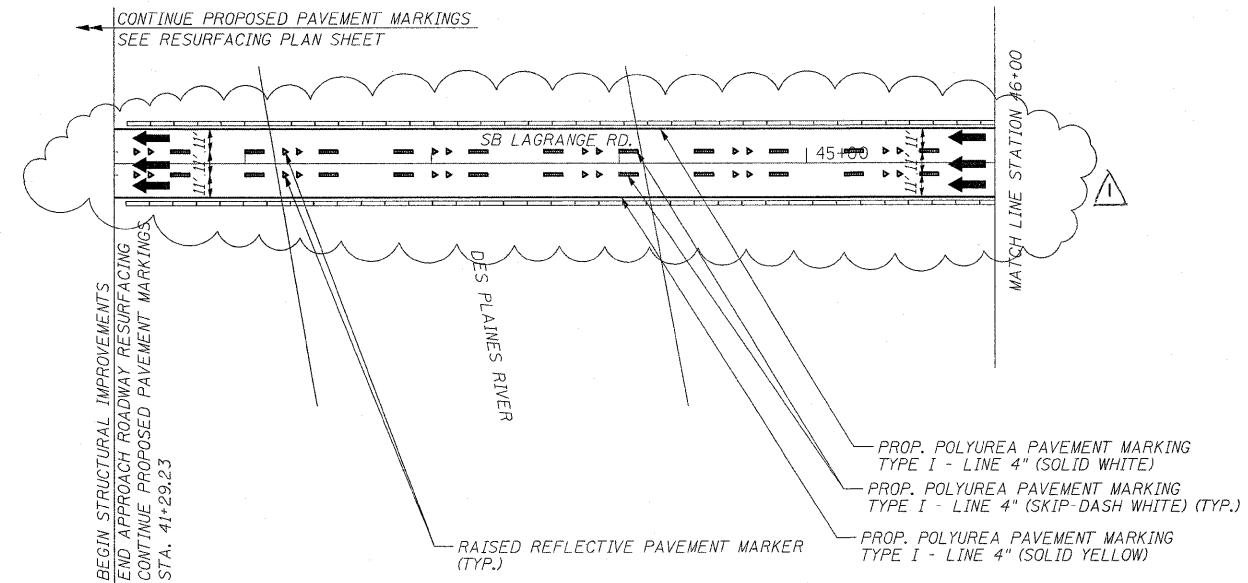

| | | | | | | | | | | | | |
|----------------------|--------------------|----------------|-----------------------|---|---|-----------|---------------------------|-------------|---------|--------------------------------|--------------|-----------|
| FILE NAME = | USER NAME = #USER# | DESIGNED - SEW | REVISED - 04/13/2010 | STATE OF ILLINOIS DEPARTMENT OF TRANSPORTATION | PAVEMENT MARKING PLANS US ROUTE 12, 20, 45 SB (LA GRANGE RD) - S.N. 016-2407 | | | F.A.P. RTE. | SECTION | COUNTY | TOTAL SHEETS | SHEET NO. |
| #FILE# | | DRAWN - SEW | REVISED - | | 330 | 462 X-B-I | COOK | 54 | 14 | | | |
| PLOT SCALE = #SCALE# | | CHECKED - FML | REVISED - | | CONTRACT NO. 60J37 | | | | | | | |
| PLOT DATE = #DATE# | | DATE - 01/2010 | REVISED - | | FED. ROAD DIST. NO. ILLINOIS FED. AID PROJECT | | | | | | | |
| | | | | SCALE: 1"=50' | | | SHEET NO. 14 OF 54 SHEETS | | | STA. 31+99.36 TO STA. 69+00.70 | | |

Rev Sheet 4-15-10

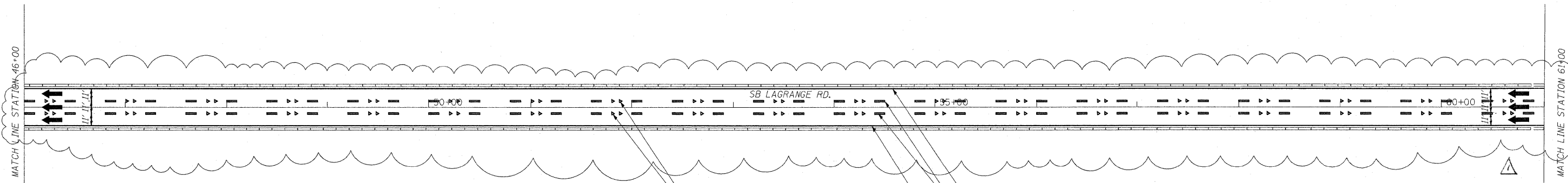

GENERAL NOTES:



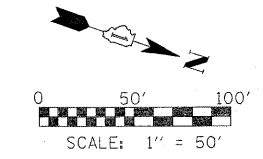
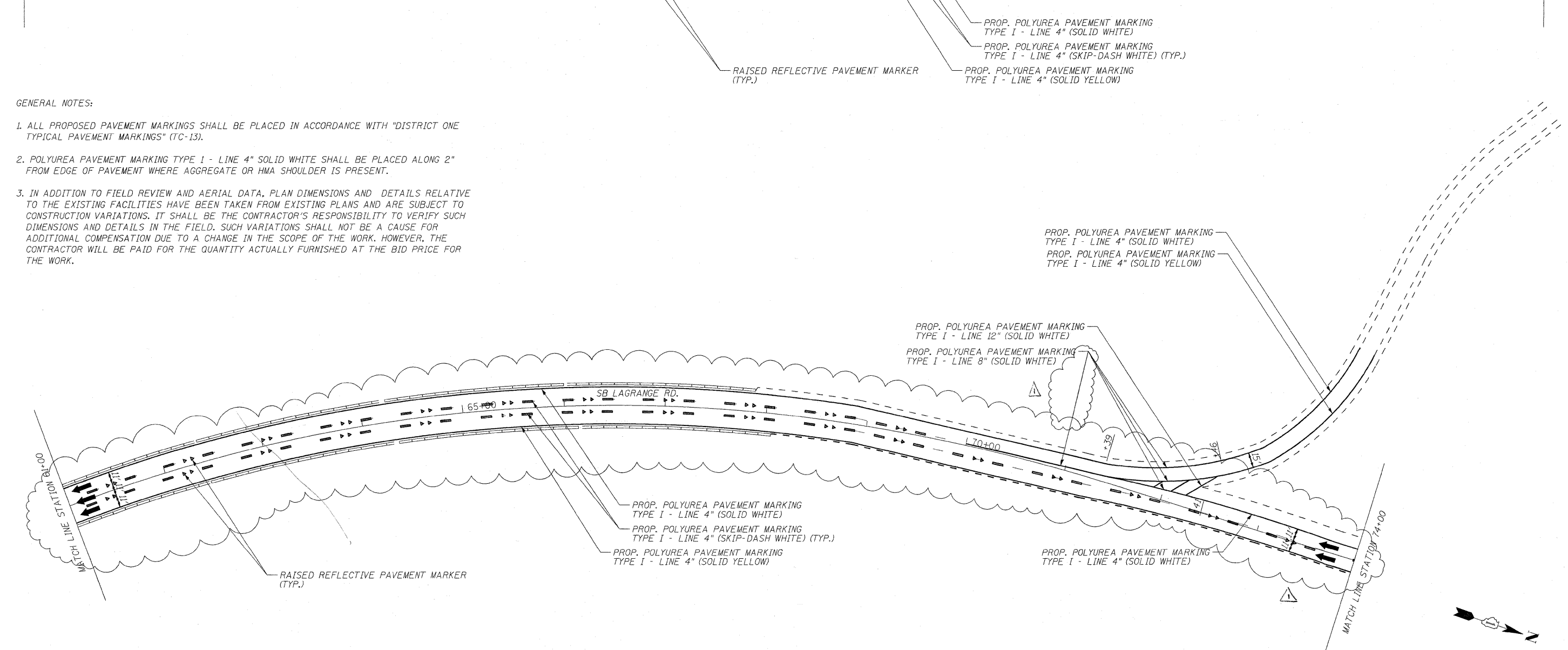



1. ALL PROPOSED PAVEMENT MARKINGS SHALL BE PLACED IN ACCORDANCE WITH "DISTRICT ONE TYPICAL PAVEMENT MARKINGS" (TC-13).
2. POLYUREA PAVEMENT MARKING TYPE I - LINE 4" SOLID WHITE SHALL BE PLACED ALONG 2" FROM EDGE OF PAVEMENT WHERE AGGREGATE OR HMA SHOULDER IS PRESENT.
3. IN ADDITION TO FIELD REVIEW AND AERIAL DATA, PLAN DIMENSIONS AND DETAILS RELATIVE TO THE EXISTING FACILITIES HAVE BEEN TAKEN FROM EXISTING PLANS AND ARE SUBJECT TO CONSTRUCTION VARIATIONS. IT SHALL BE THE CONTRACTOR'S RESPONSIBILITY TO VERIFY SUCH DIMENSIONS AND DETAILS IN THE FIELD. SUCH VARIATIONS SHALL NOT BE A CAUSE FOR ADDITIONAL COMPENSATION DUE TO A CHANGE IN THE SCOPE OF THE WORK. HOWEVER, THE CONTRACTOR WILL BE PAID FOR THE QUANTITY ACTUALLY FURNISHED AT THE BID PRICE FOR THE WORK.

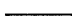

| | | | | | | | | | | | | |
|-------------|----------------------|----------------|-----------------------|---|---|---------------------------|------|--------------------------------|---------|--------|--------------|-----------|
| FILE NAME = | USER NAME = #USER# | DESIGNED - SEW | REVISED - 04/13/2010 | STATE OF ILLINOIS DEPARTMENT OF TRANSPORTATION | PAVEMENT MARKING PLANS US ROUTE 12, 20, 45 SB (LA GRANGE RD) - S.N. 016-2407 | | | F.A.P. RTE. | SECTION | COUNTY | TOTAL SHEETS | SHEET NO. |
| #FILE# | | DRAWN - SEW | REVISED - | | 330 | 462 X-B-I | COOK | 54 | 15 | | | |
| | PLOT SCALE = #SCALE# | CHECKED - FML | REVISED - | | CONTRACT NO. 60J37 | | | | | | | |
| | PLOT DATE = #DATE# | DATE - 01/2010 | REVISED - | | FED. ROAD DIST. NO. ILLINOIS FED. AID PROJECT | | | | | | | |
| | | | | SCALE: 1"=50' | | SHEET NO. 15 OF 54 SHEETS | | STA. 31+99.36 TO STA. 69+00.70 | | | | |

Rev. Sheet 4-15-10

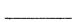
LEGEND

-  Interstate
-  Interstate (Detour)
-  Main Local Roads
-  Main Local Roads (Detour)
-  Collector Roads
-  Existing overhead DMS on NB I-55
-  County Line Road

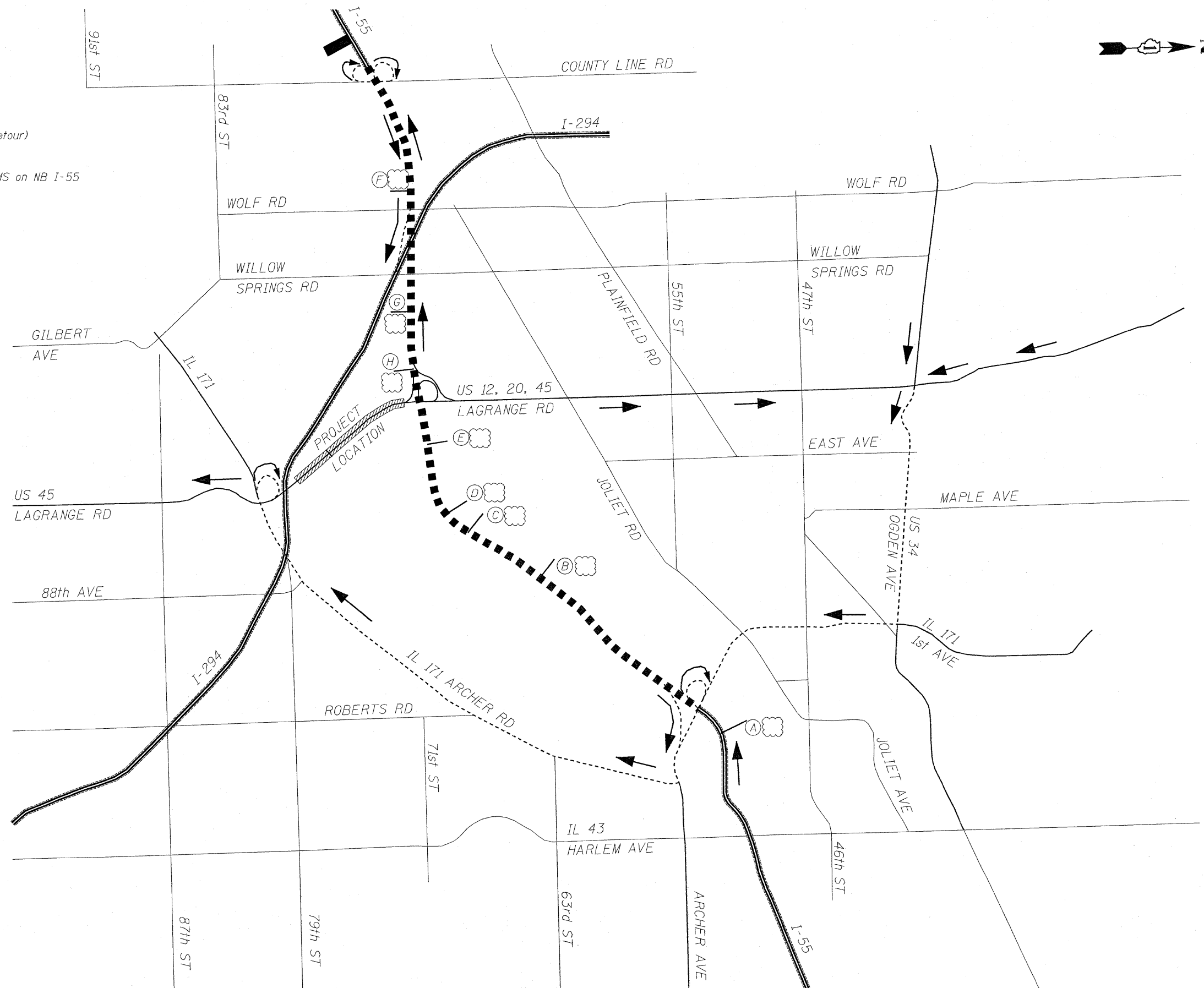

Rev. Sheet 4-13-10

LOCO, INC.
 CONSULTING ENGINEERS
 1960 WALL ST, SUITE 222
 NAPERVILLE, ILLINOIS 60563 PH: 630/577-3100

| | |
|-------------------|---------------------|
| DESIGNED - MJY | REVISED - 4/13/2010 |
| DRAWN - SV | REVISED - |
| CHECKED - MJY, DC | REVISED - |
| DATE - 01/29/2010 | REVISED - |

**STATE OF ILLINOIS
 DEPARTMENT OF TRANSPORTATION**

DETOUR PLAN - OVERVIEW
US 12, 20, 45 SB (LA GRANGE RD) OVER SANTA FE DR, RRs, DES PLAINES
 SCALE: NONE SHEET NO. 17 OF 54 SHEETS STA. 31+99.36 TO STA. 69+00.70

| | | | | |
|---------------------|-------------------|---------------------------|-----------------|--------------|
| F.A.P. RTE. 330 | SECTION 462 X-B-1 | COUNTY COOK | TOTAL SHEETS 54 | SHEET NO. 17 |
| D-91-227-10 | | CONTRACT NO. 60J37 | | |
| FED. ROAD DIST. NO. | | ILLINOIS FED. AID PROJECT | | |

LEGEND

- Interstate
- ■ ■ Interstate (Detour)
- Main Local Roads
- - - Main Local Roads (Detour)
- Collector Roads

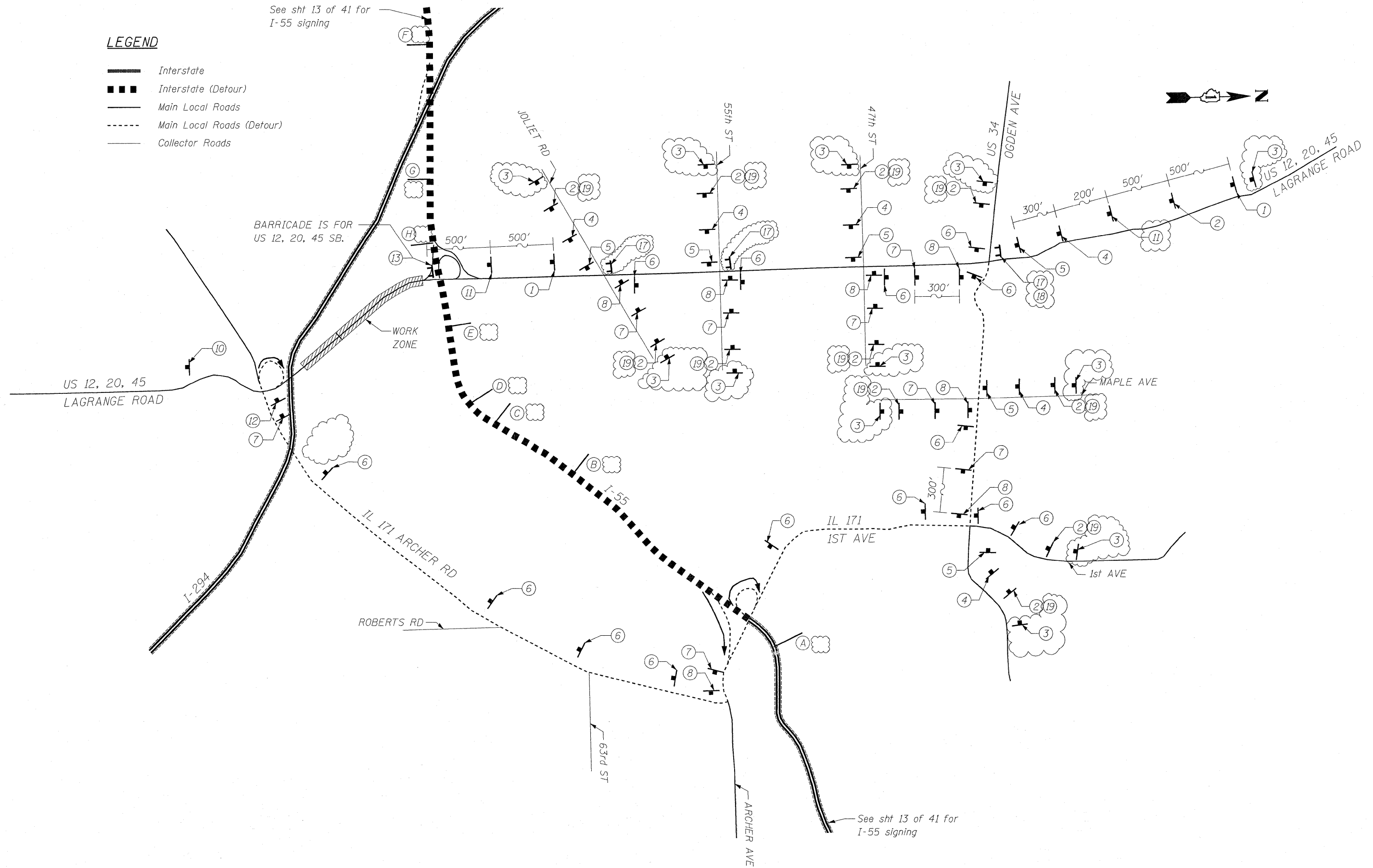

LOCAL ROADS DETOUR FOR LAGRANGE SB

LONCO, INC.
 CONSULTING ENGINEERS
 1560 WALL ST, SUITE 222
 NAPERVILLE, ILLINOIS 60563 PH 630/ 577-9100

| | |
|-------------------|---------------------|
| DESIGNED - MJY | REVISED - 4/13/2010 |
| DRAWN - SV | REVISED - |
| CHECKED - MJY, DC | REVISED - |
| DATE - 01/29/2010 | REVISED - |

| | |
|-------------------|---------------------|
| DESIGNED - MJY | REVISED - 4/13/2010 |
| DRAWN - SV | REVISED - |
| CHECKED - MJY, DC | REVISED - |
| DATE - 01/29/2010 | REVISED - |

**STATE OF ILLINOIS
 DEPARTMENT OF TRANSPORTATION**

DETOUR PLAN - OVERVIEW
US 12, 20, 45 SB (LA GRANGE RD) OVER SANTA FE DR, RRS, DES PLAINES
 SCALE: NONE SHEET NO. 18 OF 54 SHEETS STA. 31+99.36 TO STA. 69+00.70

Rev. Sheet 4-13-10

| F.A.P. RTE. | SECTION | COUNTY | TOTAL SHEETS | SHEET NO. |
|---------------------|-----------|---------------------------|--------------|-----------|
| 330 | 462 X-B-1 | COOK | 54 | 18 |
| D-91-227-10 | | CONTRACT NO. 60J37 | | |
| FED. ROAD DIST. NO. | | ILLINOIS FED. AID PROJECT | | |

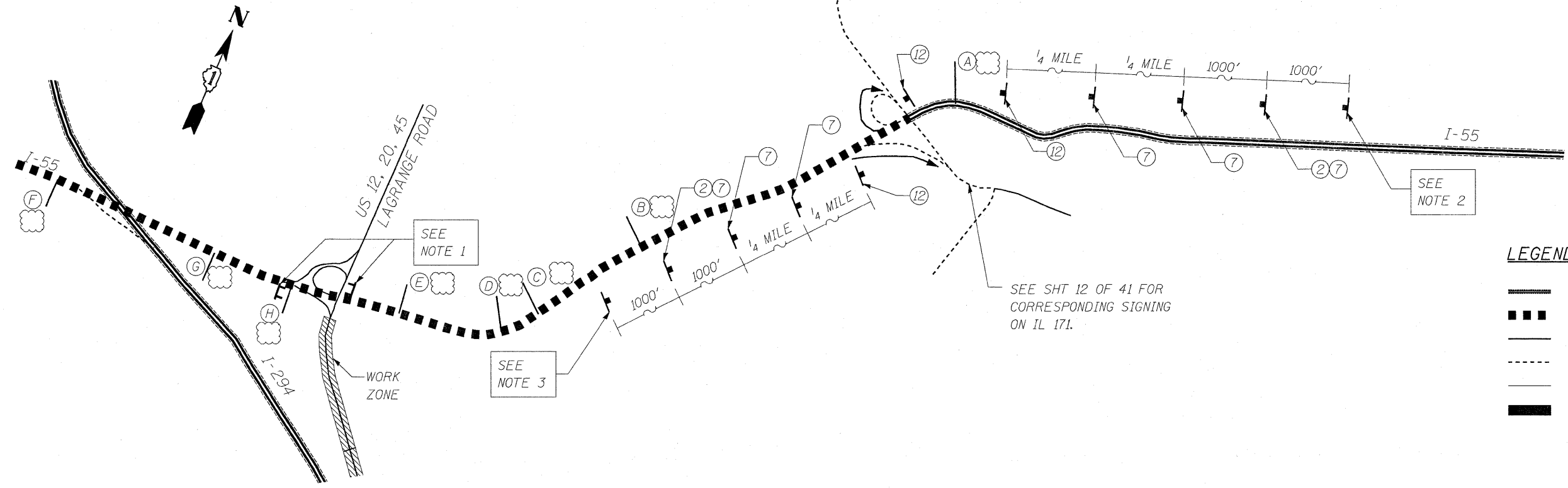

I-55 NB & SB TO LAGRANGE RD SB DETOUR

- NOTE 1: EXIT RAMP CLOSURE TO FOLLOW DISTRICT DETAIL FOR FREEWAY ENTRANCE AND EXIT RAMP CLOSURE DETAILS (TC-8).
- NOTE 2: ADD PORTABLE CHANGEABLE MESSAGE SIGN (PCMS) AT THE EAST SIDE OF IL 171 ON SOUTHBOUND I-55.
- NOTE 3: ADD PORTABLE CHANGEABLE MESSAGE SIGN (PCMS) AT THE WEST SIDE OF IL 173 ON NORTHBOUND I-55.

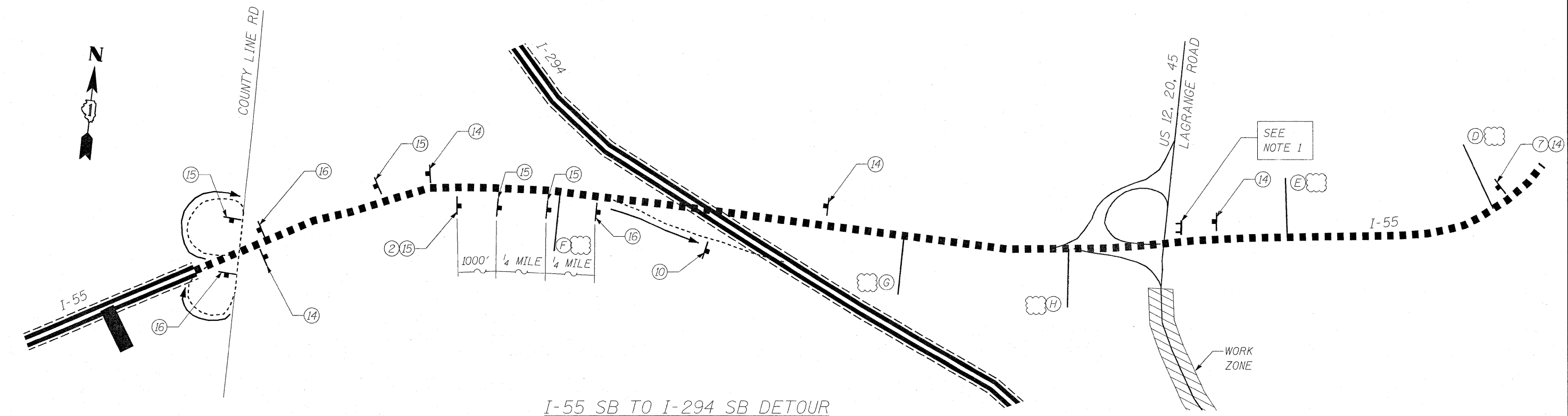

I-55 SB TO I-294 SB DETOUR

| | | | | | | | | | | |
|---|----------------|---------------------|---|--|-------------|---------------------------|--------------------------------|--|-----------------|--------------------|
| 1560 WALL ST, SUITE 222 HAPERVILLE, ILLINOIS 60563 PH (630) 577-9100 | DESIGNED - MJY | REVISED - 4/13/2010 | STATE OF ILLINOIS DEPARTMENT OF TRANSPORTATION | DETOUR PLAN - OVERVIEW US 12, 20, 45 SB (LA GRANGE RD) OVER SANTA FE DR, RRs, DES PLAINES | | F.A.P. RTE. 330 | SECTION 462 X-B-1 | COUNTY COOK | TOTAL SHEETS 54 | SHEET NO. 19 |
| | DRAWN - SV | CHECKED - MJY, DC | | DATE - 01/29/2010 | SCALE: NONE | SHEET NO. 19 OF 54 SHEETS | STA. 31+99.36 TO STA. 69+00.70 | D-91-227-10 ILLINOIS FED. AID PROJECT | | CONTRACT NO. 60J37 |

Rev Sheet 4-13-10

LEGEND

F - TYPE III BARRICADE WITH TWO FLASHING LIGHTS

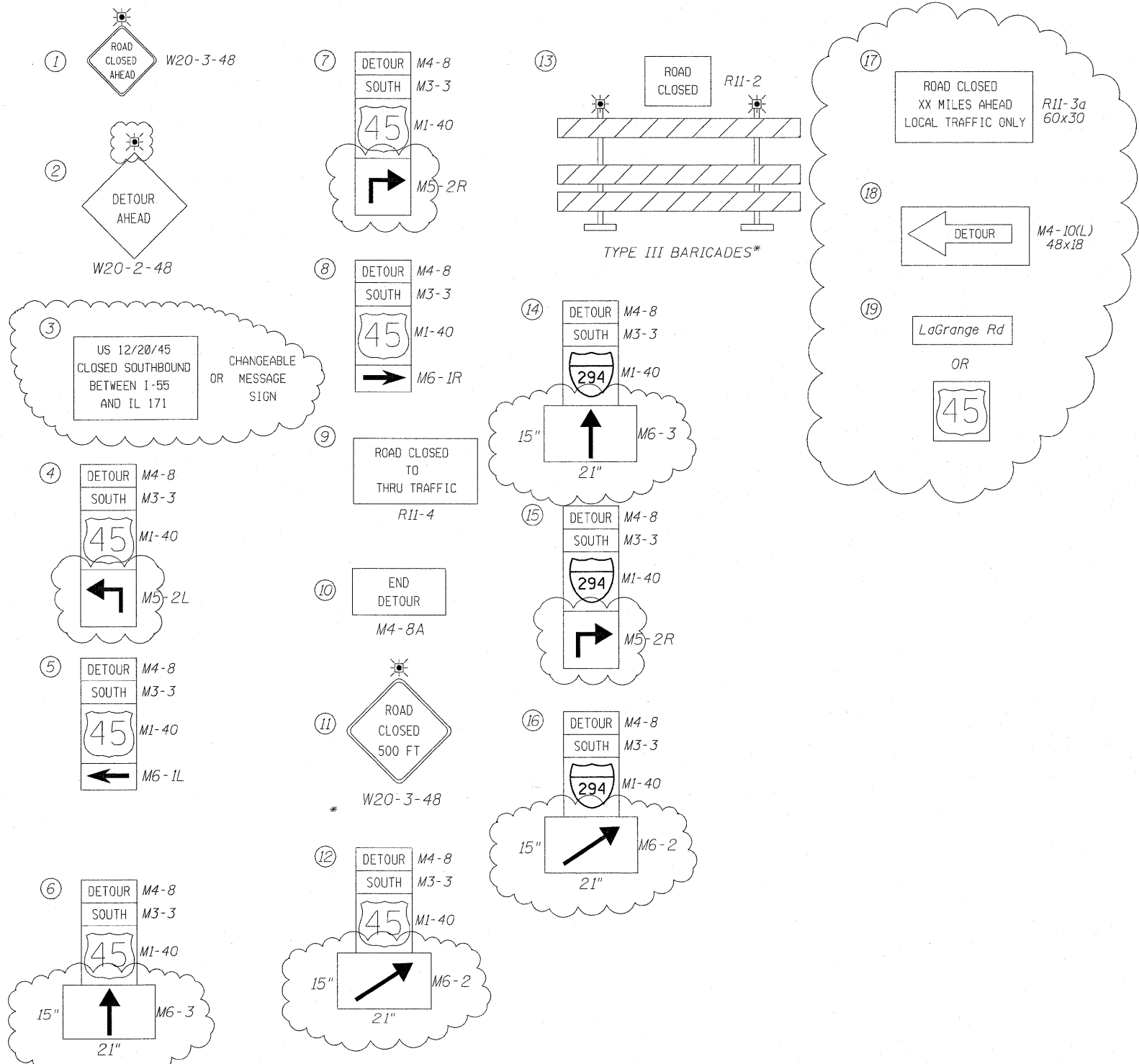

*IF A TYPE III BARRICADE WITH AN ATTACHED SIGN PANEL WHICH MEETS NCHRP 350 REQUIREMENTS IS NOT AVAILABLE, THE SIGNS SHALL BE MOUNTED, ABOVE THE BARRICADES, ON SEPARATE SIGNS SUPPORTS THAT MEET NCHRP 350 REQUIREMENTS.

EXISTING OVERHEAD SIGNING FOR I-55 NB & SB FOR INFORMATION ONLY

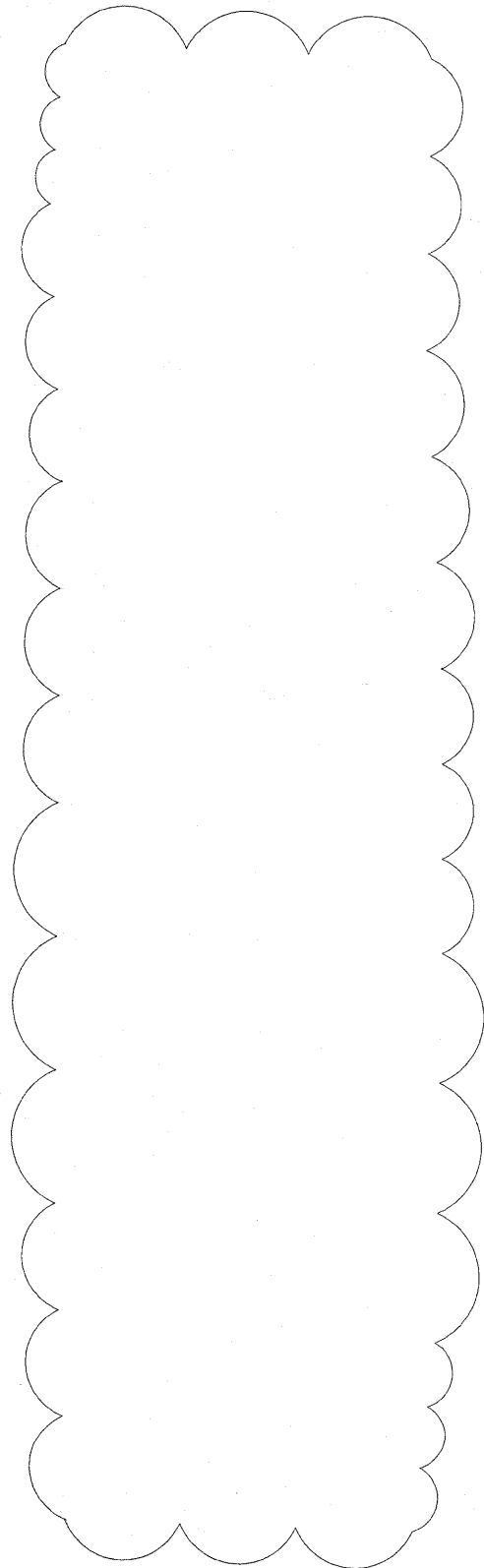
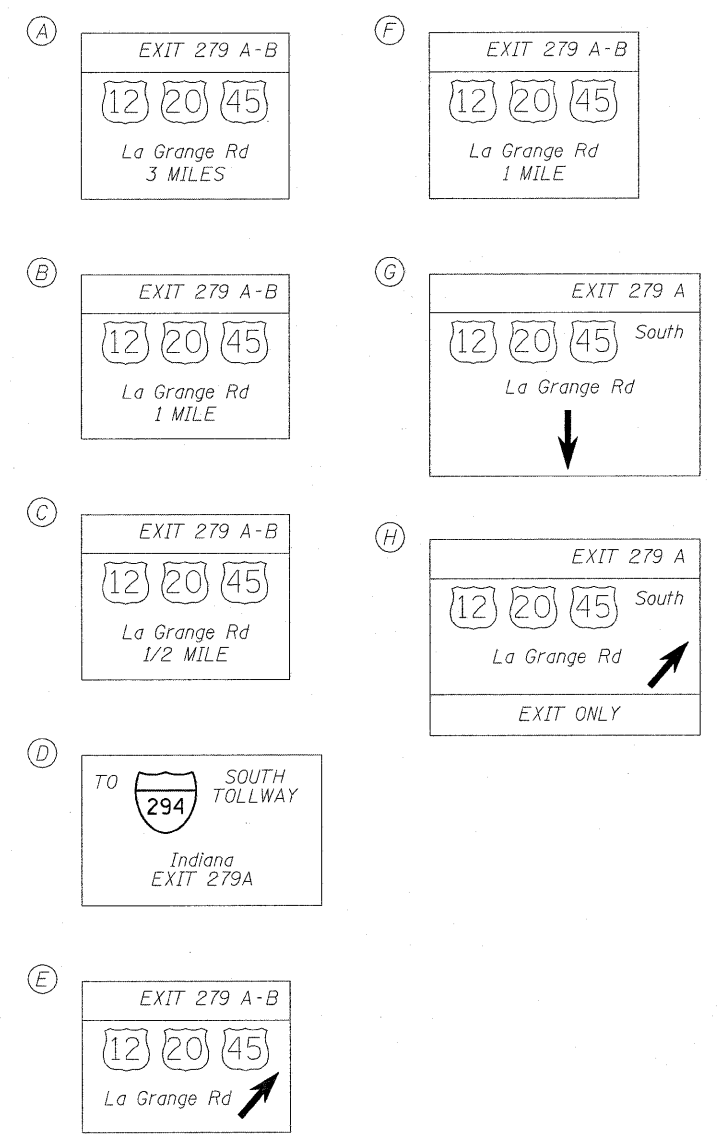

Rev Sheet 4-13 10