

- LEGEND**
- Interstate
  - - - Interstate (Detour)
  - Main Local Roads
  - - - Main Local Roads (Detour)
  - Collector Roads
  - Existing overhead DMS on NB I-55
  - ⊙ County Line Road

I-55 NB & SB TO LAGRANGE RD SB DETOUR

- NOTE 1: EXIT RAMP CLOSURE TO FOLLOW DISTRICT DETAIL FOR FREEWAY ENTRANCE AND EXIT RAMP CLOSURE DETAILS (TC-8).
- NOTE 2: ADD PORTABLE CHANGEABLE MESSAGE SIGN (PCMS) AT THE EAST SIDE OF IL 171 ON SOUTHBOUND I-55.
- NOTE 3: ADD PORTABLE CHANGEABLE MESSAGE SIGN (PCMS) AT THE WEST SIDE OF IL 173 ON NORTHBOUND I-55.

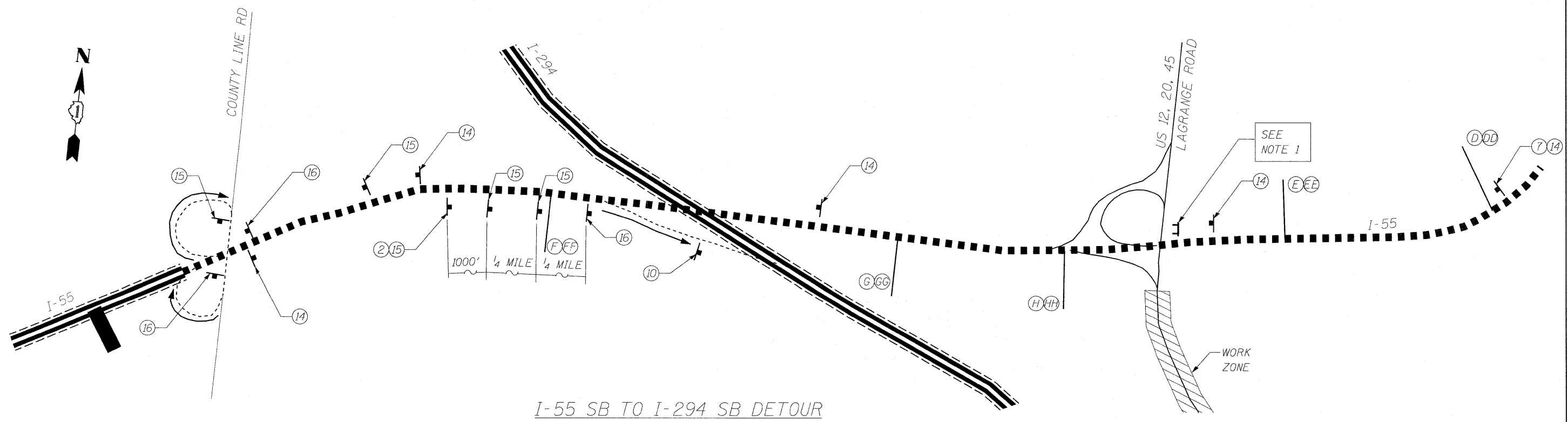

I-55 SB TO I-294 SB DETOUR

**LOWCO, INC.**  
 CONSULTING ENGINEERS  
 1560 WALL ST, SUITE 222  
 NAPERVILLE, ILLINOIS 60563 PH: 630 577-9100

DESIGNED - MJY	REVISED -
DRAWN - SV	REVISED -
CHECKED - MJY, DC	REVISED -
DATE - 01/29/2010	REVISED -

**STATE OF ILLINOIS  
 DEPARTMENT OF TRANSPORTATION**

**DETOUR PLAN - OVERVIEW**  
**US 12, 20, 45 SB (LA GRANGE RD) OVER SANTA FE DR, RRs, DES PLAINES**  
 SCALE: NONE SHEET NO. 19 OF 54 SHEETS STA. 31+99.36 TO STA. 69+00.70

F.A.P. RTE. 330	SECTION 462 X-B-1	COUNTY COOK	TOTAL SHEETS 54	SHEET NO. 19
D-91-227-10		CONTRACT NO. 60J37		
FED. ROAD DIST. NO.		ILLINOIS FED. AID PROJECT		