

WET RF TEM TAPE T3 4
SOLID YELLOW LINE

TEMP CONC
BARRIER

MATCHLINE STA. 29+50

BEGIN PROJECT LIMITS
STA. 31+99.36

NOTE: TEMPORARY CONCRETE BARRIER, TEMPORARY STRIPING AND
TEMPORARY MAINTENANCE OF TRAFFIC WILL CONTINUE FOR
CONTRACTO NO. 60J37.

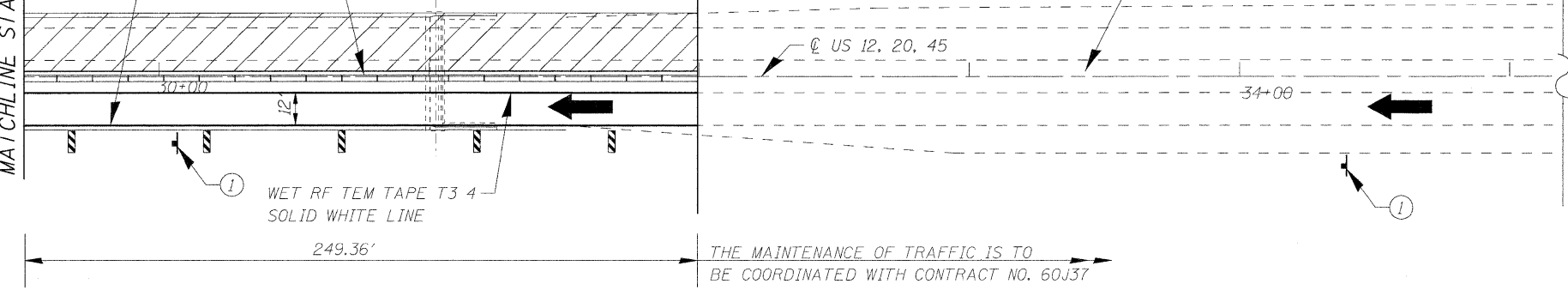

LEGEND

- WORK ZONE
- BARRICADE W/ STEADY BURN LIGHT
- TYPE III BARRICADE WITH FLASHING LIGHTS
- SIGN
- IMPACT ATTENUATORS
- CONCRETE BARRIER
- SINGLE VERTICAL PANEL

NOTES:

BARRICADE AND PANEL SPACING SHALL BE 25' CENTERS IN TAPER SECTIONS AND 50' CENTERS IN TANGENT SECTIONS.

VERTICAL PANELS SHALL BE USED WHEN CANNOT BE PLACED ON THE EXISTING PAVEMENT OR PAVED SHOULDER.

ALL SIGNS, BARRICADES AND OTHER TRAFFIC CONTROL DEVICES SHOWN ON THIS SHEET SHALL BE ACCORDING TO SECTION 701 OF THE STANDARD SPECIFICATIONS AND SHALL NOT BE PAID FOR SEPARATELY, BUT SHALL BE PAID FOR AT THE CONTRACT LUMP SUM PRICE FOR "TRAFFIC CONTROL AND PROTECTION, (SPECIAL)". ALL TEMPORARY PAVEMENT MARKING WILL BE PAID FOR SEPARATELY.

STAGE 1

1. INSTALL TRAFFIC CONTROL AND TEMPORARY CONCRETE BARRIER IN ACCORDANCE WITH STAGE 1 MAINTENANCE OF TRAFFIC AND STANDARD 701400 AND 701401.
2. REMOVE TOP 1/2" OF THE WEST PORTION OF THE EXISTING DECK SURFACE, AND EXISTING APPROACH PAVEMENT.
3. INSTALL NEW DECK SLAB REPAIR (FULL DEPTH, TYPE II) AND BRIDGE DECK LATEX CONCRETE OVERLAY, 2 1/4"
4. CONSTRUCT NEW APPROACH PAVEMENT.
5. CONSTRUCT ROADWAY ON WEST SIDE OF LA GRANGE ROAD IN ACCORDANCE WITH SHEET 15.

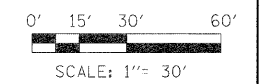
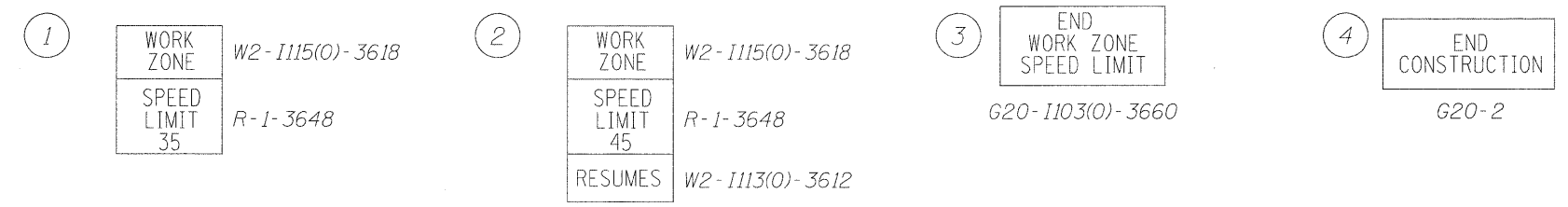

LOCO, INC.
CONSULTING ENGINEERS
1560 WALL ST, SUITE 222
NAPERVILLE, ILLINOIS 60563 PH: (630) 577-9100

DESIGNED - MJY	REVISED -
DRAWN - ST, TSC	REVISED -
CHECKED - MJY, DC	REVISED -
DATE - 01/29/2010	REVISED -

**STATE OF ILLINOIS
DEPARTMENT OF TRANSPORTATION**

**CONSTRUCTION STAGING PLAN - STAGE 1
US 12, 20, 45 SB (LA GRANGE RD) OVER CN RR AND CANALS**
SCALE: 1" = 30' SHEET NO. 8 OF 41 SHEETS STA. 16+97.50 TO STA. 31+99.36

F.A.P. RTE.	SECTION	COUNTY	TOTAL SHEETS	SHEET NO.
330	462 X-B-1-1	COOK	41	8
D-91-229-10			CONTRACT NO. 60J38	
FED. ROAD DIST. NO. ILLINOIS FED. AID PROJECT				