

LEGEND

- ① EXISTING PCC PAVEMENT ± 9"
- ② EXISTING PCC WIDENING 9"
- ③ EXISTING HMA SURFACE ± 3 3/4" (AFTER MILLING)
- ④ EXISTING HMA SHOULDER
- ⑤ EXISTING AGGREGATE SHOULDER
- ⑥ PROP. HMA SURFACE REMOVAL, 2 1/4"
- ⑦ PROP. POLYMERIZED LEVELING BINDER (MM), IL-4.75, N50, 3/4"
- ⑧ PROP. HMA SURFACE COURSE, MIX "D", N70 1 1/2"
- ⑨ PROP. GRADING & SHAPING SHOULDERS

REMOVAL ITEM

* WIDTHS OF HMA AND AGGREGATE SHOULDERS MAY VARY

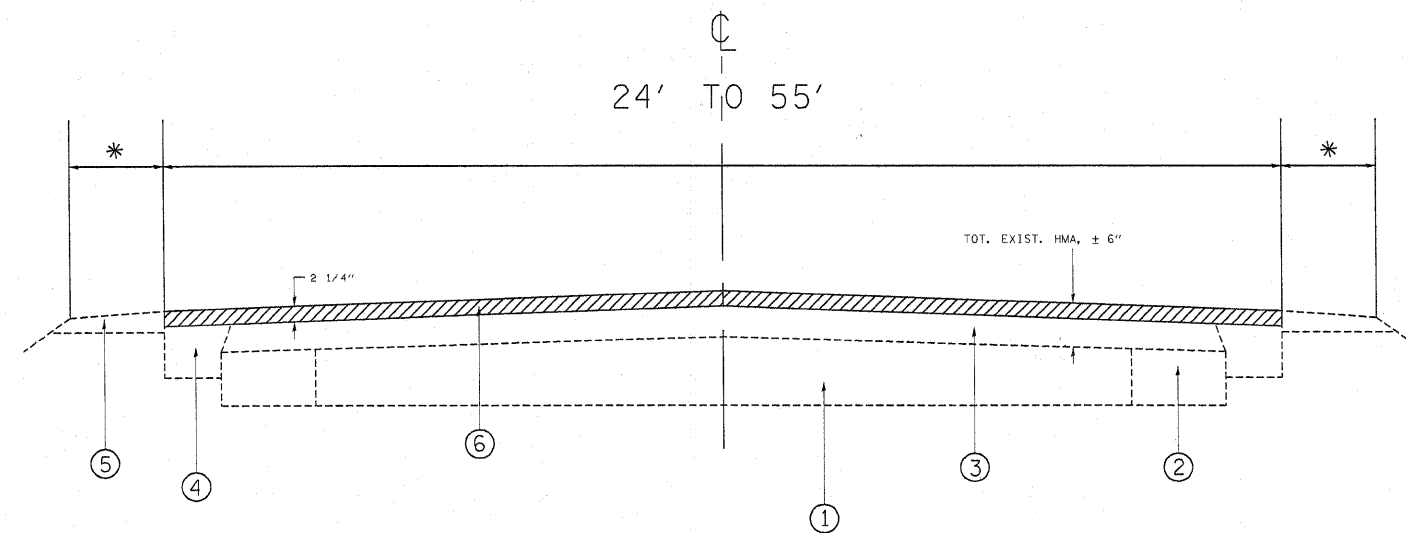

EXISTING TYPICAL CROSS SECTION

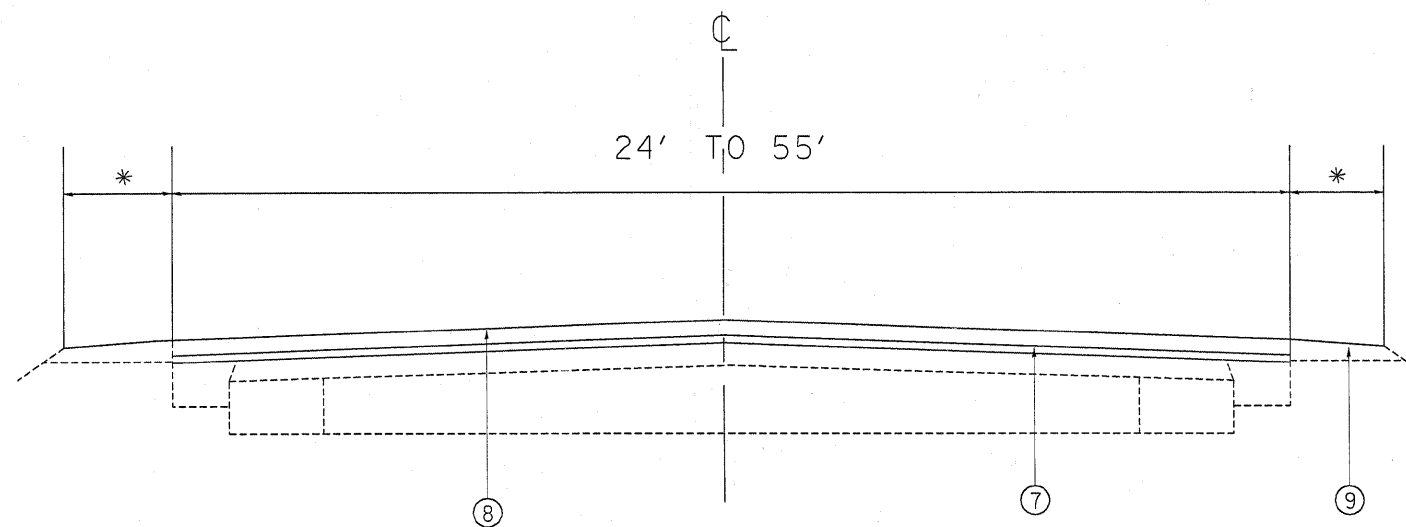

PROPOSED TYPICAL CROSS SECTION

HMA MIXTURE REQUIREMENTS

MIXTURE USES	% VOIDS @ Ndes
HMA SURFACE COURSE, MIX "D", N70 (IL 9.5 mm)	4% @ 70 GYR.
POLY. LEVELING BINDER (MM), IL-4.75, N50	4% @ 50 GYR.
CLASS D PATCHES (HMA BINDER IL-19 mm)	4% @ 70 GYR.

- THE UNIT WEIGHT USED TO CALCULATE ALL HMA SURFACE MIXTURES IS 112 LBS/SQ YD/IN
- THE "AC TYPE" FOR POLYMERIZED HMA MIXES SHALL BE "SBS/SBR PG 70 -22" AND FOR NON-POLYMERIZED HMA THE "AC TYPE" SHALL BE "PG 64-22" UNLESS MODIFIED BY DISTRICT ONE SPECIAL PROVISIONS. FOR "PERCENT OF RAP" SEE DISTRICT ONE SPECIAL PROVISIONS.

NOTE:

THE CONTRACTOR SHALL MILL FIRST BEFORE PATCHING

CURB & GUTTER IS PRESENT FROM: STA 65+15.25 TO STA 67+55.71

FILE NAME =	USER NAME = mossse	DESIGNED -	REVISED -	STATE OF ILLINOIS DEPARTMENT OF TRANSPORTATION	F.A.P. RTE.	SECTION	COUNTY	TOTAL SHEETS	SHEET NO.	
o:\pwork\pwork\DOT\MOSSSE\d0175322\01243@-sht-plan.dgn		DRAWN -	REVISED -		335	119 RS-13	LAKE	17	4	
PLOT SCALE = 50.0000' / IN.		CHECKED -	REVISED -		CONTRACT NO. 60J53					
PLOT DATE = 2/3/2010		DATE -	REVISED -		ILLINOIS FED. AID PROJECT					
					SCALE:	SHEET NO.	OF	SHEETS	STA.	TO STA.