

EXIST. CURVE E.176-1  
 PI STA. = 97+83.88  
 $\Delta = 15^\circ 14' 14''$  (RT)  
 $D = 1^\circ 32' 55''$   
 $R = 3,700.00'$   
 $T = 494.91'$   
 $L = 983.98'$   
 $E = 32.95'$   
 $e =$   
 T.R. =  
 S.E. RUN =  
 P.C. STA. = 92+88.97  
 P.T. STA. = 102+72.95

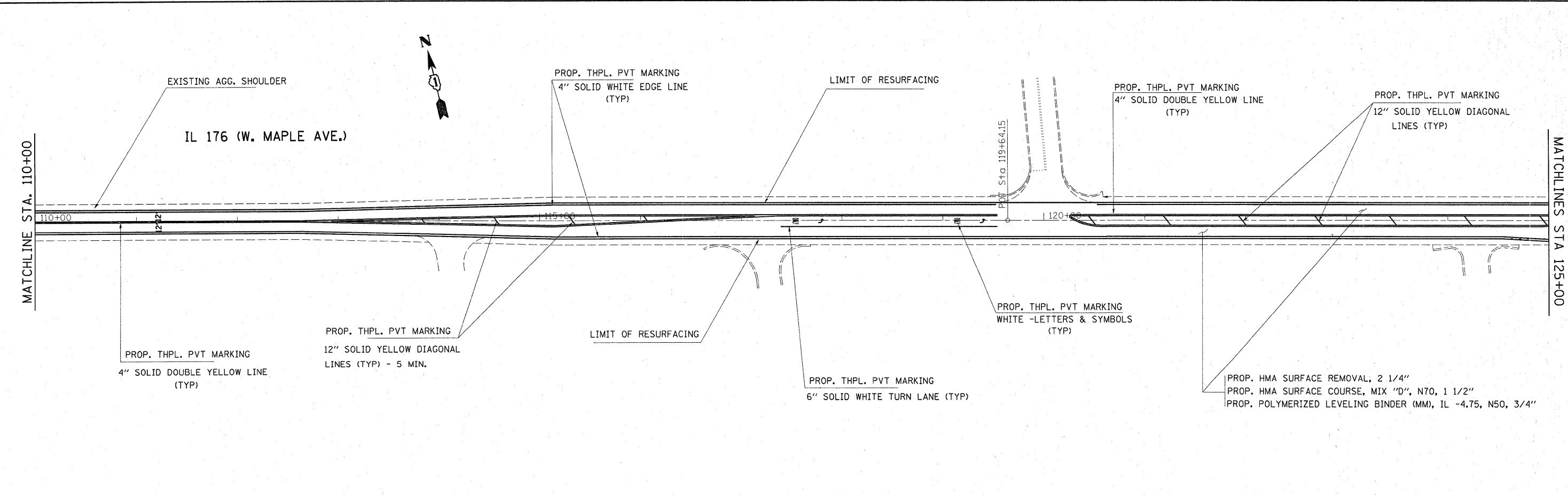
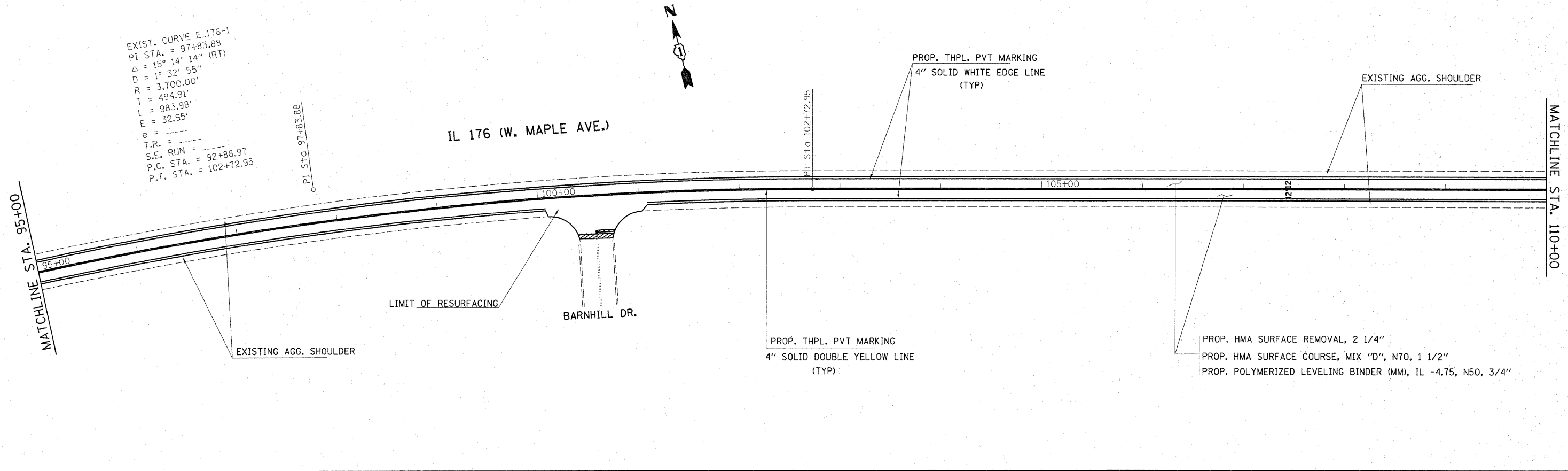

FILE NAME =	USER NAME = gorenhautab	DESIGNED -	REVISED - Ag 3/5/10	<b>STATE OF ILLINOIS DEPARTMENT OF TRANSPORTATION</b>	<b>IL RTE. 176 (IL RTE. 60 / 83 TO MIDLOTHIAN ROAD) EXISTING AND PROPOSED ROADWAY PLAN</b>		F.A.U RTE.	SECTION	COUNTY	TOTAL SHEETS	SHEET NO.
ct:\pw\work\VPWIDOT\GORENGAUTAB\d0177846	D131910-shr-plan.dgn	DRAWN -	REVISED -		SCALE: 1" = 50'	SHEET NO.	OF SHEETS	STA.	LAKE	20	6
	PLOT SCALE = 50.0000' / IN.	CHECKED -	REVISED -						CONTRACT NO. 60J97		
	PLOT DATE = 3/5/2010	DATE -	REVISED -						ILLINOIS FED. AID PROJECT		