

MATCH LINE STA. 425+00

MATCH LINE STA. 440+00

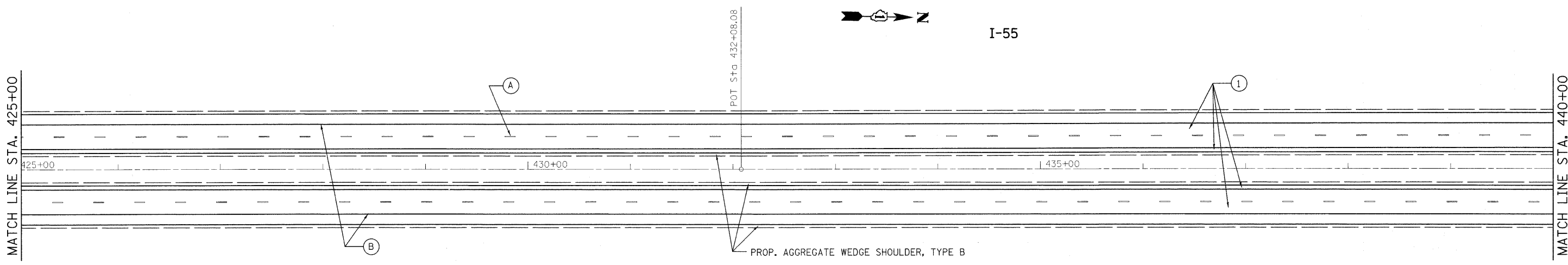

PROP. AGGREGATE WEDGE SHOULDER, TYPE B

- ① PROP. HOT-MIX ASPHALT SURFACE REMOVAL, 4"
PROP. POLYMERIZED HMA SURFACE COURSE, SMA, N80, 2"
PROP. POLYMERIZED HMA BINDER COURSE, SMA, N80, 2"
- ② PROP. HOT-MIX ASPHALT SURFACE REMOVAL, 4"
PROP. HMA SURFACE COURSE, MIX. "D", N70, 1 1/2"
PROP. HMA BINDER COURSE, IL-19, N70, 2 1/2"
- ③ PROP. HOT-MIX ASPHALT SURFACE REMOVAL, 2 1/4"
PROP. HMA SURFACE COURSE, MIX. "D", N70, 1 1/2"
PROP. POLY. LEVELING BINDER, IL-4.75, N50, 3/4"

- Ⓐ PROP. PREFORMED PLASTIC PAVEMENT MARKING, TYPE B-INLAID-LINE 5" (TYP.)
- Ⓑ PROP. THERMOPLASTIC PAVEMENT MARKING-LINE 4", WHITE (TYP.)
- Ⓒ PROP. THERMOPLASTIC PAVEMENT MARKING-LINE 4", YELLOW (TYP.)
- Ⓓ PROP. THERMOPLASTIC PAVEMENT MARKING-LINE 8", WHITE (TYP.)
- Ⓔ PROP. THERMOPLASTIC PAVEMENT MARKING-LINE 12", WHITE (TYP.)

MATCH LINE STA. 440+00

MATCH LINE STA. 455+00

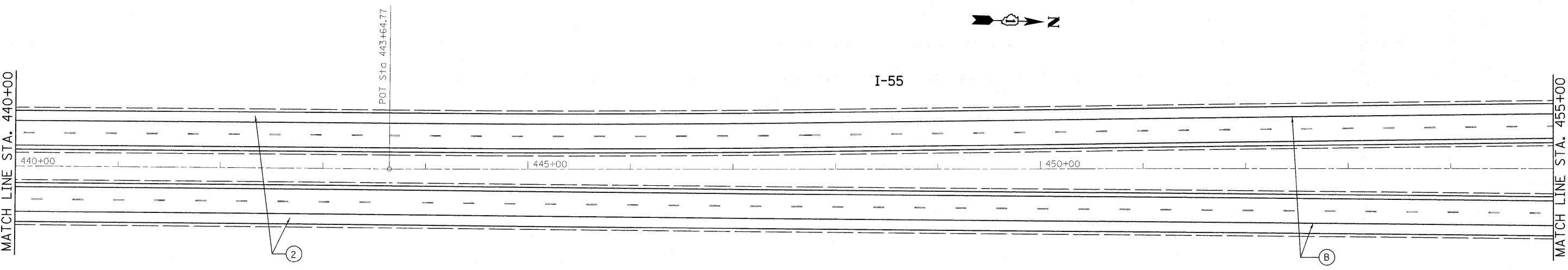

I-55

FILE NAME =	USER NAME = ababawa	DESIGNED -	REVISED -
cs:\pw_work\PW\DOT\ABEBAWA\0169692\shd	blanudgn	DRAWN -	REVISED -
PLOT SCALE = 50.0000' / IN.	CHECKED -	REVISED -	REVISED -
PLOT DATE = 2/11/2010	DATE -	REVISED -	REVISED -

STATE OF ILLINOIS
DEPARTMENT OF TRANSPORTATION

IL. ROUTE 55
KANKAKEE RIVER TO S. OF I-80

SCALE: SHEET NO. OF SHEETS STA. TO STA.

F.A.I. RTE.	SECTION	COUNTY	TOTAL SHEETS	SHEET NO.
55	99 (1&2) RS-12	WILL	110	22
CONTRACT NO. 60K04				
ILLINOIS FED. AID PROJECT				