

STATE OF ILLINOIS
DEPARTMENT OF TRANSPORTATION

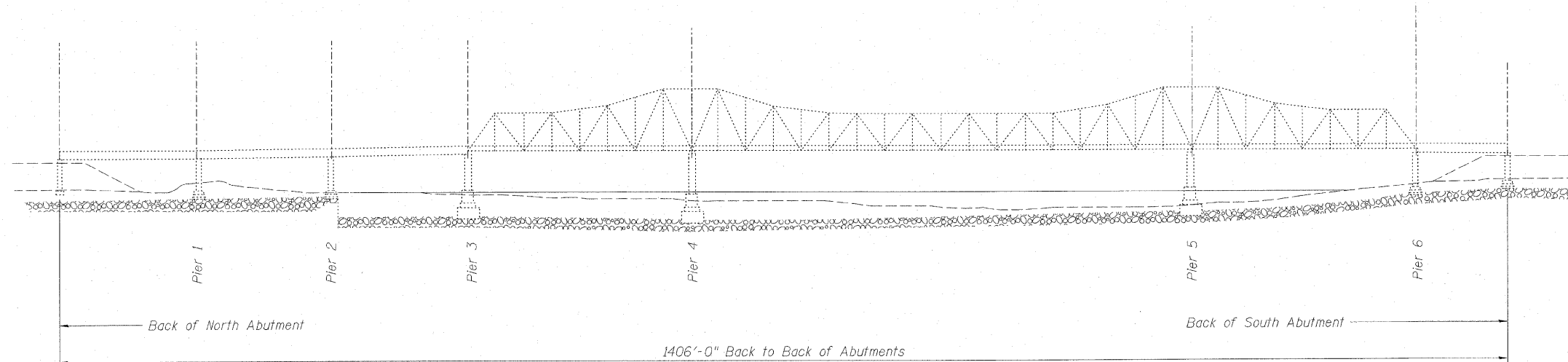

ELEVATION

TOTAL BILL OF MATERIAL

ITEM	UNIT	TOTAL
Bituminous Materials (Prime Coat)	Gal.	40
Work Zone Pavement Marking Removal	Sq. Ft.	801
Thermoplastic Pavement Marking - Line 4"	Ft.	1841
Thermoplastic Pavement Marking - Line 5"	Ft.	230
Pavement Marking Removal	Sq. Ft.	567
Wet Reflective Temporary Tape, Type III, 4"	Ft.	1976
Wet Reflective Temporary Tape, Type III, 5"	Ft.	340
Partial Depth Patch, Mix "F", N90	Ton	22.3
Asphaltic Emulsion Slurry Seal	Sq. Yd.	3324

All deck surface on spans 4, 5, & 6 will have Asphaltic Emulsion Slurry Seal.

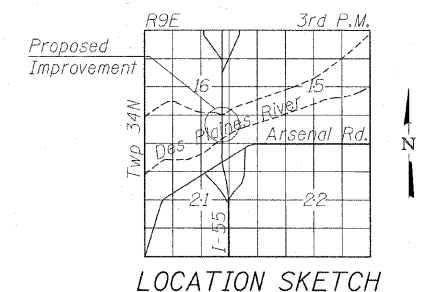
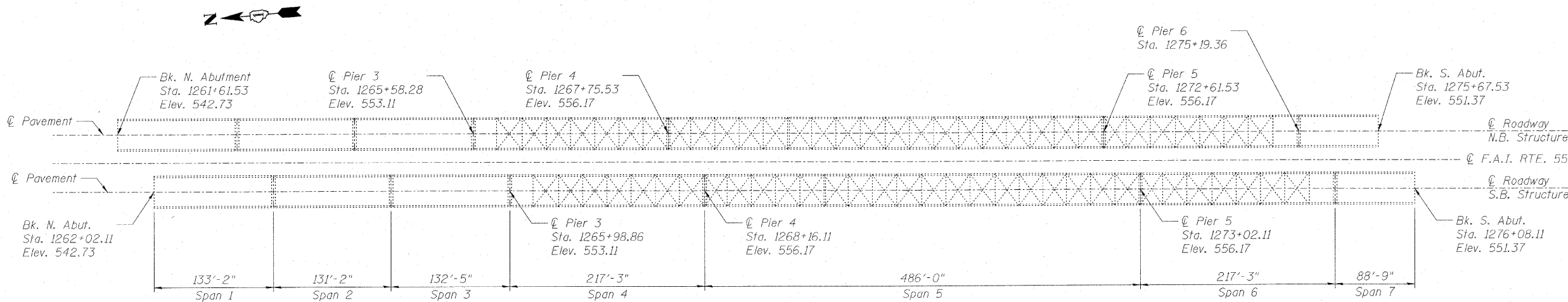

GENERAL NOTES

Plan dimensions and details relative to existing plans are subject to nominal construction variations. The Contractor shall field verify existing dimensions and details affecting new construction and make necessary approved adjustments prior to construction or ordering of materials. Such variations shall not be cause for additional compensation for a change in scope of the work, however, the Contractor will be paid for the quantity actually furnished at the unit price bid for the work.

The Contractor should use caution when removing the existing HMA as not to damage the existing waterproofing membrane system. Any damage is to be repair at the Contractor's expense.

The Contractor must take extreme care so that the slurry material does not drain into the Des Plaines River. The deck drains must be plugged to the satisfaction of the Resident Engineer. The cost for this will be incidental to the slurry seal application.

INDEX OF SHEETS:

1. General Plan and Elevation
2. Cross Section & Staging
3. Deck Plan - Span 4 & 5
4. Deck Plan - Span 5 & 6

GENERAL PLAN AND ELEVATION
I-55 NB OVER DES PLAINES RIVER
F.A.I. RTE. 55 - SEC. 87BD-I-8
WILL COUNTY
STATION 1268+84.82
STRUCTURE NO. 099-0009

DESIGNED	BRT
CHECKED	BJM
DRAWN	JNH
CHECKED	BJM



B. Robert Tessitore
B. Robert Tessitore
Expires: 11-30-10
02-24-2010
Date



Wight & Company
2500 North Frontage Road . Darien . IL 60561
630.969.7000 630.969.7979 fax
Design Firm Registration 184-000451

SHEET NO. 1 4 SHEETS	F.A.I. RTE.	SECTION	COUNTY	TOTAL SHEETS	SHEET NO.
	55	99 (1&2) RS-12	WILL	110	85
CONTRACT NO. 60K04					
FED. ROAD DIST. NO. ILLINOIS FED. AID PROJECT					