

ROUTE	SECTION	COUNTY	TOTAL SHEETS	SHEET NUMBER
VARIOUS	2010-008 RS	LAKE	35	1

**STATE OF ILLINOIS**  
**DEPARTMENT OF TRANSPORTATION**  
**DIVISION OF HIGHWAYS**  
**DISTRICT ONE**  
**PROPOSED HIGHWAY PLANS**

**CONTRACT NO. 60K27**

D-91-466-10

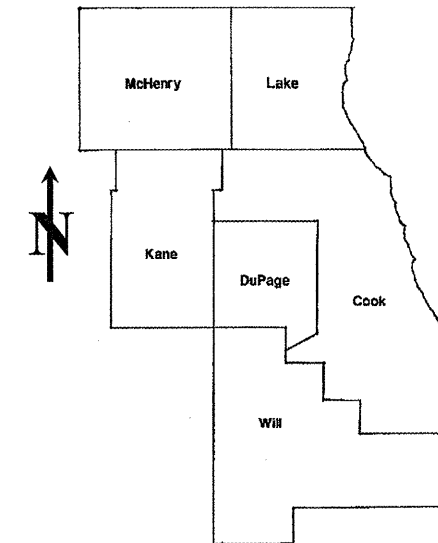

LOCATION OF IMPROVEMENT INDICATED THUS:

FOR INDEX OF SHEETS SEE SHEET 2

VARIOUS ROUTES  
 SECTION: 2010-008 RS  
 VARIOUS LOCATIONS IN LAKE COUNTY  
 INTERMITTENT PAVEMENT RESURFACING  
 LAKE COUNTY  
 C-91-466-10

DISTRICT ONE - DESIGN - PLAN PREPARATION ENGINEER:  
 KEN ENG / (847) 705-4247

**CONTRACT NO. 60K27**

**STATE OF ILLINOIS**  
**DEPARTMENT OF TRANSPORTATION**  
**DIVISION OF HIGHWAYS**  
 SUBMITTED: FEBRUARY 16, 2010  
*Diana M. O'Hara*  
 DEPUTY DIRECTOR OF HIGHWAYS, REGION ENGINEER  
March 19, 2010  
*Scott E. Still, P.E.*  
 ENGINEER OF DESIGN AND ENVIRONMENT  
*Acting*  
March 19, 2010  
*Christine M. Reed*  
 DIRECTOR, DIVISION OF HIGHWAYS

**PRINTED BY THE AUTHORITY**  
**OF THE STATE OF ILLINOIS**

**J.U.L.I.E.: JOINT UTILITY LOCATION**  
**INFORMATION FOR EXCAVATION**  
**(312) 744-7000**

INDEX OF SHEETS

STATE STANDARDS

GENERAL NOTES

<u>SHEET NO.</u>	<u>DESCRIPTION</u>	<u>STANDARD NO.</u>	<u>DESCRIPTION</u>
1	TITLE SHEET	000001-05	TYPICAL SYMBOLS, ABBREVIATIONS AND PATTERNS
2	INDEX OF SHEETS, STATE STANDARDS AND GENERAL NOTES	701201-03	LANE CLOSURE, 2L, 2W, DAY ONLY
3	SUMMARY OF QUANTITIES	701301-03	LANE CLOSURE, 2L, 2W, SHORT TIME OPERATIONS
4	GENERAL LOCATION MAP	701306-02	LANE CLOSURE, 2L, 2W, SLOW MOVING OPERATIONS - DAY ONLY
5	SUMMARY OF PATCHING SCHEDULE	701336-05	LANE CLOSURE, 2L, 2W, WORK AREAS IN SERIES
6-28	PATCHING SCHEDULE	701501-05	URBAN LANE CLOSURE, 2L, 2W, UNDIVIDED
29	BUTT JOINT AND HMA TAPER DETAILS	701601-06	URBAN LANE CLOSURE, MULTILANE, 1W OR 2W WITH NONTRAVERSABLE MEDIAN
30	TRAFFIC CONTROL AND PROTECTION FOR SIDE ROADS, INTERSECTIONS AND DRIVEWAYS	701606-06	URBAN LANE CLOSURE, MULTILANE, 2W WITH MOUNTABLE MEDIAN
31	TYPICAL APPLICATIONS: RAISED REFLECTIVE PAVEMENT MARKERS (SNOW-PLOW RESISTANT)	701701-06	URBAN LANE CLOSURE, MULTILANE INTERSECTION
32	DISTRICT ONE TYPICAL PAVEMENT MARKINGS	701901-01	TRAFFIC CONTROL DEVICES
33	TRAFFIC CONTROL AND PROTECTION OF TURN BAYS (TO REMAIN OPEN TO TRAFFIC)		
34	ARTERIAL ROAD INFORMATION SIGN		
35	DETECTOR LOOP INSTALLATION DETAIL FOR ROADWAY RESURFACING		

BEFORE STARTING ANY EXCAVATION, THE CONTRACTOR SHALL CALL "JULIE" AT (800) 892-0123 OR 811 FOR FIELD LOCATIONS OF BURIED ELECTRIC, TELEPHONE AND GAS FACILITIES. (48 HOUR NOTIFICATION REQUIRED)

THE CONTRACTOR WILL NOT BE ALLOWED TO SET UP A YARD OR FIELD OFFICE ON STATE (OR TOLLWAY) PROPERTY WITHOUT WRITTEN PERMISSION FROM THE DEPARTMENT (OR ISTHA)

WHEN ARTIFICIAL LIGHTING IS UTILIZED IN NIGHT OPERATIONS, THE CONTRACTOR SHALL EXERCISE THE UTMOST PRECAUTIONS IN PREVENTING ADVERSE VISIBILITY TO THE MOTORING PUBLIC AND ADJOINING RESIDENTIAL AREAS.

ANY PAVEMENT MARKINGS AND RAISED REFLECTIVE PAVEMENT MARKERS OBLITERATED BY MILLING AND RESURFACING OPERATIONS ON SIDE STREETS AND ENTRANCES SHALL BE REPLACED AND PAID FOR IN KIND.

BEFORE BEGINNING ANY WORK, THE CONTRACTOR SHALL RETAIN AND RECORD FOR FUTURE REFERENCE, ALL EXISTING PAVEMENT MARKING LINES (AND RAISED REFLECTIVE PAVEMENT MARKERS) IN ORDER THAT THESE LOCATIONS CAN BE RE-ESTABLISHED FOR STRIPING. EXACT LOCATIONS OF ALL PAVEMENT MARKINGS SHALL BE AS DIRECTED BY THE ENGINEER.

ALL PAVEMENT PATCHING LOCATIONS WILL BE DETERMINED IN THE FIELD BY THE ENGINEER.

THE CONTRACTOR SHALL CONTACT THE DISTRICT ONE TRAFFIC CONTROL SUPERVISOR AT (847) 705-4470 A MINIMUM OF 72 HOURS IN ADVANCE OF BEGINNING WORK.

THE ENGINEER SHALL CONTACT MS. DEBBIE HANLON, AREA TRAFFIC FIELD ENGINEER AT (847) 438-2300 MINIMUM OF TWO (2) WEEKS PRIOR TO PLACEMENT OF PERMANENT PAVEMENT MARKINGS.

DOUBLE LANE MARKERS ARE TO BE USED AS SHOWN ON THE DISTRICT ONE DETAIL "TYPICAL APPLICATIONS - RAISED REFLECTIVE PAVEMENT MARKERS (SNOW-PLOW RESISTANT)" SHOWN IN THE PLANS.

THE EXISTING ROADWAY TYPICAL SECTION IS ASSUMED TO HAVE A 3 INCH HOT-MIX ASPHALT OVERLAY ON TOP OF A TEN INCH CONCRETE BASE.

ALL PAVEMENT PATCHES SHOWN IN THE PLANS ARE TWO (2) INCH MILL AND RESURFACE ONLY. THE MINIMUM WIDTH FOR MILLING AND PATCHING SHALL BE TWO (2) FEET.

NO PATCHING OR RESURFACING IS TO BE DONE WITHIN FIFTY (50) FEET OF ANY RAILROAD CROSSING WITHOUT OBTAINING THE PROPER RAILROAD PROTECTIVE LIABILITY INSURANCE.

THE COST OF TRAFFIC CONTROL AND PROTECTION FOR THE PROJECT SHALL BE INCLUDED IN THE COST OF THE ASSOCIATED ROAD WORK.

THE COST OF ANY PARTIAL OR FULL DEPTH PATCHING REQUIRED AFTER THE REMOVAL OF THE EXISTING 2 INCH HOT-MIX ASPHALT SURFACE SHALL BE PAID FOR IN ACCORDANCE WITH ARTICLE 109.04 OF THE STANDARD SPECIFICATIONS.

HOT-MIX ASPHALT MIXTURE REQUIREMENTS

MIXTURE TYPE	AC TYPE	AIR VOIDS (%)
HOT-MIX ASPHALT SURFACE COURSE, MIX "D", N70 (IL 9.5MM), 2"	PG 64-22	4% @ 70 GYR

THE UNIT WEIGHT USED TO CALCULATE ALL HOT-MIX ASPHALT SURFACE MIXTURE QUANTITIES IS 112 LBS/SY/IN.

SUMMARY OF QUANTITIES			URBAN CONSTRUCTION TYPE CODE						SUMMARY OF QUANTITIES			CONSTRUCTION TYPE CODE						
CODE NO	ITEM	UNIT	TOTAL QUANTITIES 100% STATE	1000					CODE NO	ITEM	UNIT	TOTAL QUANTITIES						
40600200	BITUMINOUS MATERIALS (PRIME COAT)	TON	14	14														
40600300	AGGREGATE (PRIME COAT)	TON	68	68														
40600400	MIXTURE FOR CRACKS, JOINTS, AND FLANGEWAYS	TON	51	51														
40600982	HOT-MIX ASPHALT SURFACE REMOVAL - BUTT JOINT	SO YD	1011	1011														
40603340	HOT-MIX ASPHALT SURFACE COURSE, MIX "D", N70	TON	3772	3772														
44000157	HOT-MIX ASPHALT SURFACE REMOVAL, 2"	SO YD	33676	33676														
67000400	ENGINEER'S FIELD OFFICE, TYPE A	CAL MO	6	6														
67100100	MOBILIZATION	L SUM	1	1														
70300100	SHORT-TERM PAVEMENT MARKING	FOOT	8504	8504														
70301000	WORK ZONE PAVEMENT MARKING REMOVAL	SO FT	2835	2835														
*78000100	THERMOPLASTIC PAVEMENT MARKING - LETTERS AND SYMBOLS	SO FT	100	100														
*78000200	THERMOPLASTIC PAVEMENT MARKING - LINE 4"	FOOT	44492	44492														
*78000400	THERMOPLASTIC PAVEMENT MARKING - LINE 6"	FOOT	1000	1000														
*78000600	THERMOPLASTIC PAVEMENT MARKING - LINE 12"	FOOT	100	100														
*78000650	THERMOPLASTIC PAVEMENT MARKING - LINE 24"	FOOT	100	100														
*78100100	RAISED REFLECTIVE PAVEMENT MARKER	EACH	452	452														
78300200	RAISED REFLECTIVE PAVEMENT MARKER REMOVAL	EACH	452	452														
*88600600	DETECTOR LOOP REPLACEMENT	FOOT	150	150														
X0322256	TEMPORARY INFORMATION SIGNING	SO FT	360	360														

\* SPECIALTY ITEM

FILE NAME = c:\pwwork\pwwork\wlgreendp\0183559-Design.dgn	USER NAME = wlgreendp	DESIGNED -	REVISED -	<b>STATE OF ILLINOIS DEPARTMENT OF TRANSPORTATION</b>	<b>SUMMARY OF QUANTITIES</b>			F.A. RTE. VAR.	SECTION 2010-008 RS	COUNTY LAKE	TOTAL SHEETS 35	SHEET NO. 3
PLOT SCALE = 100,000' / IN.	CHECKED -	REVISED -	SCALE:					SHEET NO. OF SHEETS STA. TO STA.	FED. ROAD DIST. NO. 1 ILLINOIS FED. AID PROJECT			
PLOT DATE = 2/17/2010	DATE -	REVISED -										

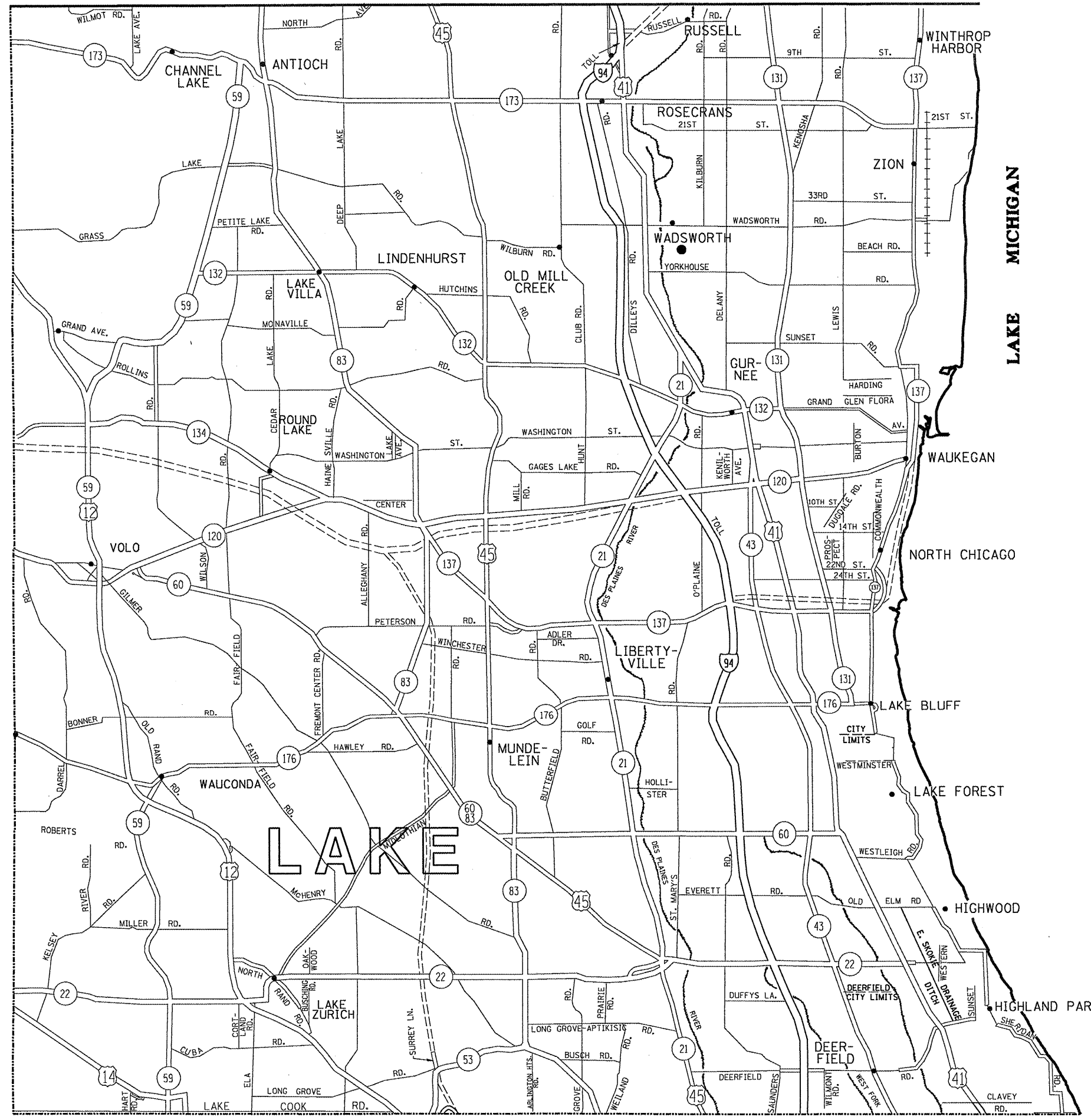

FILE NAME =	USER NAME = wilgreendp
es:\pwwork\VPWIDOT\WILGREENDP\d0183559\Design.dgn	
PLOT SCALE = 100.0000' / IN.	
PLOT DATE = 2/10/2010	

DESIGNED -	REVISED -
DRAWN -	REVISED -
CHECKED -	REVISED -
DATE -	REVISED -

STATE OF ILLINOIS
DEPARTMENT OF TRANSPORTATION

<b>STATE OF ILLINOIS DEPARTMENT OF TRANSPORTATION</b>	
SCALE:	SHEET NO. OF SHEETS STA. TO STA.

<b>GENERAL LOCATION MAP - LAKE COUNTY</b>	
F.A. RTE.	SECTION
VAR.	2010-008 RS
COUNTY	LAKE
TOTAL SHEETS	35
SHEET NO.	4
CONTRACT NO. 60K27	
FED. ROAD DIST. NO. 1 [ILLINOIS] FED. AID PROJECT	

SUMMARY - LAKE COUNTY ROUTES	HMA 2" MILL & RESURFACE (SY)
IL 22 (US 12 TO US 14)	6794
IL 59 (IL 22 TO US 12)	6723
MIDLOTHIAN RD. (IL 176 TO MAIN ST.)	13555
US 41 MAINLINE (SOUTH OF W. PARK AVE) & (NORTH OF DEERFIELD RD.)	618
US 41 RAMPS AT DEERFIELD RD.	1708
US 41 RAMPS AT IL 120	3150
US 41 RAMPS AT WASHINGTON ST.	1128
LAKE COUNTY TOTALS =	33676 SY

FILE NAME =	USER NAME = wilgreendp	DESIGNED -	REVISED -
c:\pw\work\pw\d01\wilgreendp\d0183859\Design.dgn		DRAWN -	REVISED -
PLOT SCALE = 100.0000 "/ IN.		CHECKED -	REVISED -
PLOT DATE = 2/17/2010		DATE -	REVISED -

**STATE OF ILLINOIS  
DEPARTMENT OF TRANSPORTATION**

**SUMMARY OF PATCHING SCHEDULE  
LAKE COUNTY**

SCALE: SHEET NO. OF SHEETS STA. TO STA.

F.A. RTE.	SECTION	COUNTY	TOTAL SHEETS	SHEET NO.
VAR.	2010-008 RS	LAKE	35	5
FED. ROAD DIST. NO. 1 ILLINOIS FED. AID PROJECT			CONTRACT NO. 60K27	























ROUTE: Midlothian Rd. (IL 176 to Main St.)							
CROSS STREETS		DIRECTION (EB/WB) (NB/SB)	LANE NO. (1, 2, 3)	PAVEMENT PATCH WIDTH	PAVEMENT PATCH LENGTH	REPAIR AREA (SQ FT)	REPAIR AREA (SQ YD)
FROM	TO						
Main St	IL 176	NB	1	12	2	24	3
		NB	1	12	2	24	3
		NB	1	12	2	24	3
		NB	1	12	2	24	3
		NB	1	12	2	24	3
		NB	1	12	2	24	3
		NB	1	12	2	24	3
		NB	1	12	2	24	3
		NB	1	12	2	24	3
		NB	1	12	2	24	3
		NB	1	12	2	24	3
		NB	1	12	2	24	3
		NB	1	12	2	24	3
		NB	1	12	2	24	3
		NB	1	12	2	24	3
		NB	1	12	2	24	3
		NB	1	12	2	24	3
		NB	1	12	2	24	3
		NB	1	12	2	24	3
		Main St	IL 176	NB	1	12	2
NB	1			12	2	24	3
NB	1			12	2	24	3
NB	1			12	2	24	3
NB	1			12	2	24	3
NB	1			12	2	24	3
NB	1			12	2	24	3
NB	1			12	2	24	3
NB	1			12	2	24	3
NB	1			12	2	24	3
NB	1			12	2	24	3
NB	1			12	2	24	3
NB	1			12	2	24	3
NB	1			12	2	24	3
NB	1			12	2	24	3
NB	1			12	2	24	3
NB	1			12	2	24	3
NB	1			12	2	24	3
NB	1			12	2	24	3

ROUTE: Midlothian Rd. (IL 176 to Main St.)							
CROSS STREETS		DIRECTION (EB/WB) (NB/SB)	LANE NO. (1, 2, 3)	PAVEMENT PATCH WIDTH	PAVEMENT PATCH LENGTH	REPAIR AREA (SQ FT)	REPAIR AREA (SQ YD)
FROM	TO						
Main St	IL 176	NB	1	12	2	24	3
		NB	1	12	2	24	3
		NB	1	12	2	24	3
		NB	1	12	2	24	3
		NB	1	12	2	24	3
		NB	1	12	2	24	3
		NB	1	12	2	24	3
		NB	1	12	2	24	3
		NB	1	12	2	24	3
		NB	1	12	2	24	3
		NB	1	12	2	24	3
		NB	1	12	2	24	3
		NB	1	12	2	24	3
		NB	1	12	2	24	3
		NB	1	12	2	24	3
		NB	1	12	2	24	3
		NB	1	12	2	24	3
		NB	1	12	2	24	3
		NB	1	12	2	24	3
		Main St	IL 176	NB	1	12	2
NB	1			12	2	24	3
NB	1			12	2	24	3
NB	1			12	2	24	3
NB	1			12	2	24	3
NB	1			12	2	24	3
NB	1			12	2	24	3
NB	1			12	2	24	3
NB	1			12	2	24	3
NB	1			12	2	24	3
NB	1			12	2	24	3
NB	1			12	2	24	3
NB	1			12	2	24	3
NB	1			12	2	24	3
NB	1			12	2	24	3
NB	1			12	2	24	3
NB	1			12	2	24	3
NB	1			12	2	24	3
NB	1			12	2	24	3
Main St	IL 176			NB	1	12	2
		NB	1	12	2	24	3
		NB	1	12	2	24	3
		NB	1	12	2	24	3
		NB	1	12	2	24	3
		NB	1	12	2	24	3
		NB	1	12	2	24	3
		NB	1	12	2	24	3
		NB	1	12	2	24	3
		NB	1	12	2	24	3
		NB	1	12	2	24	3
		NB	1	12	2	24	3
		NB	1	12	2	24	3
		NB	1	12	2	24	3
		NB	1	12	2	24	3
		NB	1	12	2	24	3
		NB	1	12	2	24	3
		NB	1	12	2	24	3
		NB	1	12	2	24	3
		NB	1	12	2	24	3

CONTINUED ON NEXT SHEET

FILE NAME =	USER NAME = wlgreendp	DESIGNED -	REVISED -	<b>STATE OF ILLINOIS DEPARTMENT OF TRANSPORTATION</b>	<b>PATCHING SCHEDULE MIDLOTHIAN RD.</b>	F.A. RTE.	SECTION	COUNTY	TOTAL SHEETS	SHEET NO.		
ct\pwwork\pwwid\wlgreendp\08183559\design.dgn	DRAWN -	REVISED -	VAR.			2010-008 RS	LAKE	35	16			
PLOT SCALE = 1/8" = 100.0000' / IN.	CHECKED -	REVISED -	SCALE:			SHEET NO.	OF	SHEETS	STA.	TO	STA.	FED. ROAD DIST. NO. 1 (ILLINOIS) FED. AID PROJECT
PLOT DATE = 2/13/2010	DATE -	REVISED -										CONTRACT NO. 60K27

















ROUTE: US 41 Mainline - (NB - S/O of West Park) & (SB - N/O Deerfield)							
CROSS STREETS		DIRECTION (EB/WB) (NB/SB)	LANE NO. (1, 2, 3)	PAVEMENT		REPAIR	
FROM	TO			PATCH WIDTH	PATCH LENGTH	AREA (SQ FT)	REPAIR AREA (SQ YD)
S/O West Park (Mainline)		NB	1/ LTL	12	6	72.0	8.0
		NB	1/ LTL	12	6	72.0	8.0
		NB	1/ LTL	12	6	72.0	8.0
		NB	2	3	25	75.0	8.3
		NB	2	3	25	75.0	8.3
		NB	2	3	25	75.0	8.3
		NB	2	3	25	75.0	8.3
		NB	2	3	25	75.0	8.3
		NB	2	3	25	75.0	8.3
		NB	2	12	25	300.0	33.3
		NB	2	12	25	300.0	33.3
		NB	2	12	25	300.0	33.3
		NB	2	12	25	300.0	33.3
		NB	2	12	6	72.0	8.0
		NB	3/ RTL	18	25	450.0	50.0
		NB	3/ RTL	18	25	450.0	50.0
		NB	3/ RTL	18	25	450.0	50.0
		NB	3/ RTL	18	25	450.0	50.0
		NB	3/ RTL	12	6	72.0	8.0
N/O Deerfield (Mainline)		SB	1	3	25	75.0	8.3
		SB	1	3	25	75.0	8.3
		SB	1	3	25	75.0	8.3
		SB	1	3	25	75.0	8.3
		SB	1	3	25	75.0	8.3
		SB	1	3	25	75.0	8.3
		SB	1	3	25	75.0	8.3
		SB	1	3	25	75.0	8.3
		SB	1	3	25	75.0	8.3
		SB	1	3	25	75.0	8.3
		SB	1	3	25	75.0	8.3
		SB	1	3	25	75.0	8.3
		SB	1	12	10	120.0	13.3
		SB	1	12	6	72.0	8.0
		SB	1	12	6	72.0	8.0
		SB	1	12	6	72.0	8.0
		SB	1	12	25	300.0	33.3
		SB	2	12	6	72.0	8.0
		SB	2	12	6	72.0	8.0
		SB	2	12	6	72.0	8.0
<b>TOTALS:</b>						<b>751</b>	<b>618</b>
						<b>FT</b>	<b>SY</b>

FILE NAME =	USER NAME = wlgreendp	DESIGNED -	REVISED -	<b>STATE OF ILLINOIS DEPARTMENT OF TRANSPORTATION</b>	<b>PATCHING SCHEDULE US 41 MAINLINE</b>			F.A. RTE.	SECTION	COUNTY	TOTAL SHEETS	SHEET NO.	
ct:\pw\work\PW100T\WILGREENDP\0183559\Design.dgn	DRAWN -	REVISED -	VAR.					2010-008 RS	LAKE	35	24		
PLOT SCALE = 100.0000 ' / IN.	CHECKED -	REVISED -	SCALE:			SHEET NO.	OF	SHEETS	STA.	TO STA.	CONTRACT NO. 60K27		
PLOT DATE = 2/13/2010	DATE -	REVISED -	FED. ROAD DIST. NO. 1 [ILLINOIS] FED. AID PROJECT										





ROUTE: US 41 Ramps at IL 120							
CROSS STREETS		DIRECTION (EB/WB) (NB/SB)	LANE NO. (1, 2, 3)	PAVEMENT PATCH WIDTH	PAVEMENT PATCH LENGTH	REPAIR AREA (SQ FT)	REPAIR AREA (SQ YD)
FROM	TO						
SB US 41	EB IL 120		RAMP	20	4	80	9
				20	4	80	9
				20	4	80	9
				20	4	80	9
				20	4	80	9
				20	4	80	9
				20	4	80	9
				20	4	80	9
				20	4	80	9
				20	4	80	9
				20	4	80	9
				20	4	80	9
				20	4	80	9
				20	4	80	9
				20	4	80	9
				20	4	80	9
				20	4	80	9
				20	4	80	9
				20	4	80	9
		WB IL 120	SB US 41		RAMP	20	4
				20	4	80	9
				20	4	80	9
				20	4	80	9
				20	4	80	9
				20	4	80	9
				20	4	80	9
				20	4	80	9
				20	4	80	9
				20	4	80	9
				20	4	80	9
				20	4	80	9
				20	4	80	9
				20	4	80	9
				20	4	80	9
				20	4	80	9
				20	4	80	9
				20	4	80	9
				20	4	80	9
NB US 41	EB IL 120				RAMP	20	4
				20	4	80	9
				20	4	80	9
				20	4	80	9
				20	4	80	9
				20	4	80	9
				20	4	80	9
				20	4	80	9
				20	4	80	9
				20	4	80	9
				20	4	80	9
				20	4	80	9
				20	4	80	9
				20	4	80	9
				20	4	80	9
				20	4	80	9
				20	4	80	9
				20	4	80	9
				20	4	80	9

ROUTE: US 41 Ramps at IL 120							
CROSS STREETS		DIRECTION (EB/WB) (NB/SB)	LANE NO. (1, 2, 3)	PAVEMENT PATCH WIDTH	PAVEMENT PATCH LENGTH	REPAIR AREA (SQ FT)	REPAIR AREA (SQ YD)
FROM	TO						
NB US 41	EB IL 120		RAMP	20	4	80	9
				20	4	80	9
				20	4	80	9
				20	4	80	9
				20	4	80	9
				20	4	80	9
				20	4	80	9
				20	4	80	9
				20	4	80	9
				20	4	80	9
				20	4	80	9
				20	4	80	9
				20	4	80	9
				20	4	80	9
				20	4	80	9
				20	4	80	9
				20	4	80	9
				20	4	80	9
				20	4	80	9
		WB IL 120	NB US 41		RAMP	20	4
				20	4	80	9
				20	4	80	9
				20	4	80	9
				20	4	80	9
				20	4	80	9
				20	4	80	9
				20	4	80	9
				20	4	80	9
				20	4	80	9
				20	4	80	9
				20	4	80	9
				20	4	80	9
				20	4	80	9
				20	4	80	9
				20	4	80	9
				20	4	80	9
				20	4	80	9
				20	4	80	9
WB IL 120	NB US 41				RAMP	20	4
				20	4	80	9
				20	4	80	9
				20	4	80	9
				20	4	80	9
				20	4	80	9
				20	4	80	9
				20	4	80	9
				20	4	80	9
				20	4	80	9
				20	4	80	9
				20	4	80	9
				20	4	80	9
				20	4	80	9
				20	4	80	9
				20	4	80	9
				20	4	80	9
				20	4	80	9
				20	4	80	9
				20	4	80	9

CONTINUED ON NEXT SHEET

Design.dgn 2/13/2010 2:19:27 PM User:wilgreendp

ROUTE: US 41 Ramps at IL 120								
CROSS STREETS		DIRECTION (EB/WB) (NB/SB)	LANE NO. (1, 2, 3)	PAVEMENT	PAVEMENT	REPAIR	REPAIR	
FROM	TO			PATCH WIDTH	PATCH LENGTH	AREA (SQ FT)	AREA (SQ YD)	
WB IL 120	NB US 41		RAMP	3	50	150	17	
					3	50	150	17
					3	50	150	17
					3	100	300	33
					3	100	300	33
					3	100	300	33
					3	100	300	33
					3	100	300	33
					3	100	300	33
					3	100	300	33
NB US 41	WB IL 120		RAMP	20	4	80	9	
					20	4	80	9
					20	4	80	9
					20	4	80	9
					20	4	80	9
					20	4	80	9
					20	4	80	9
					20	4	80	9
					20	4	80	9
					20	4	80	9
					20	4	80	9
					20	4	80	9
					20	4	80	9
					20	4	80	9
					20	4	80	9
					20	4	80	9
					20	4	80	9
					20	4	80	9
					20	4	80	9
					20	4	80	9
					20	4	80	9
					20	4	80	9
					20	15	300	33
					20	20	400	44
					20	20	400	44
			20	15	300	33		
			20	15	300	33		
			3	50	150	17		
			3	50	150	17		
			3	50	150	17		
			3	50	150	17		
			3	50	150	17		
			3	50	150	17		
			3	50	150	17		
			3	50	150	17		
			3	50	150	17		
			3	50	150	17		
			3	100	300	33		
			3	100	300	33		
			3	100	300	33		
			3	100	300	33		
			3	100	300	33		
			3	100	300	33		
			3	100	300	33		
			3	100	300	33		
			3	100	300	33		
			3	100	300	33		
			3	100	300	33		
<b>TOTALS:</b>					<b>6135</b>		<b>3150</b>	
					<b>FT</b>		<b>SY</b>	

FILE NAME =	USER NAME = wlgreendp	DESIGNED -	REVISED -	<b>STATE OF ILLINOIS DEPARTMENT OF TRANSPORTATION</b>	<b>PATCHING SCHEDULE US 41 AT IL 120 RAMPS</b>				F.A. RTE.	SECTION	COUNTY	TOTAL SHEETS	SHEET NO.	
et:\pw\work\PWIDOT\WILGREENOP\0183559\Design.dgn		DRAWN -	REVISED -		SCALE:	SHEET NO.	OF	SHEETS	STA.	TO STA.	VAR.	2010-008 RS	LAKE	35 27
		PLOT SCALE = 100.0000' / IN.	CHECKED -											
		PLOT DATE = 2/13/2010	DATE -											
			REVISED -											
											CONTRACT NO. 60K27			
											FED. ROAD DIST. NO. 1 [ILLINOIS] FED. AID PROJECT			



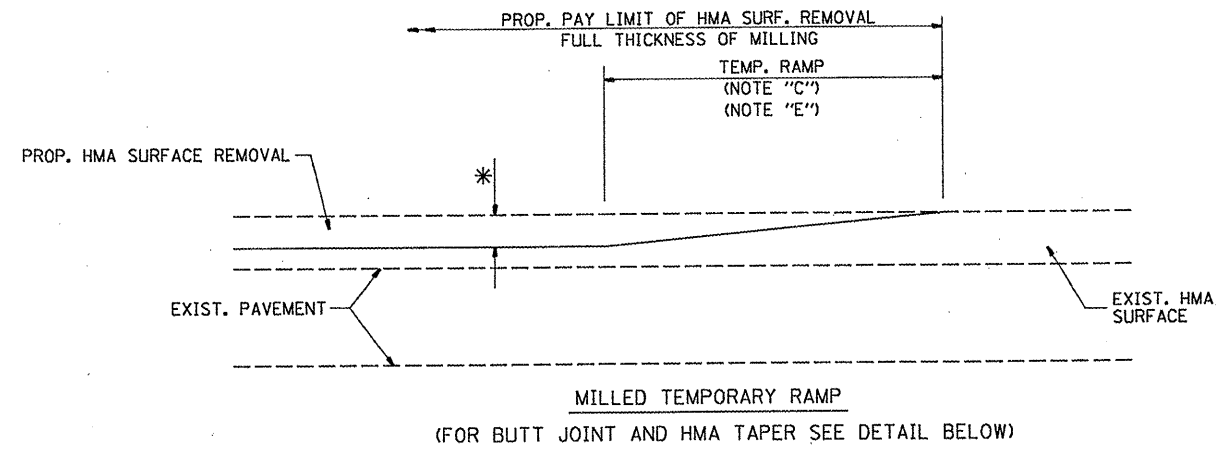

**OPTION 1**

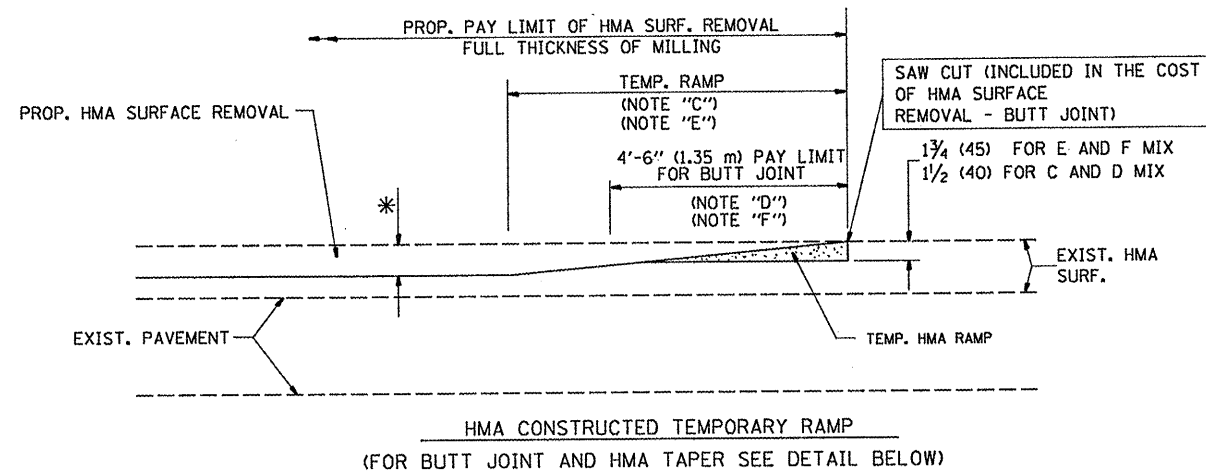

**OPTION 2**

**TYPICAL TEMPORARY RAMP**

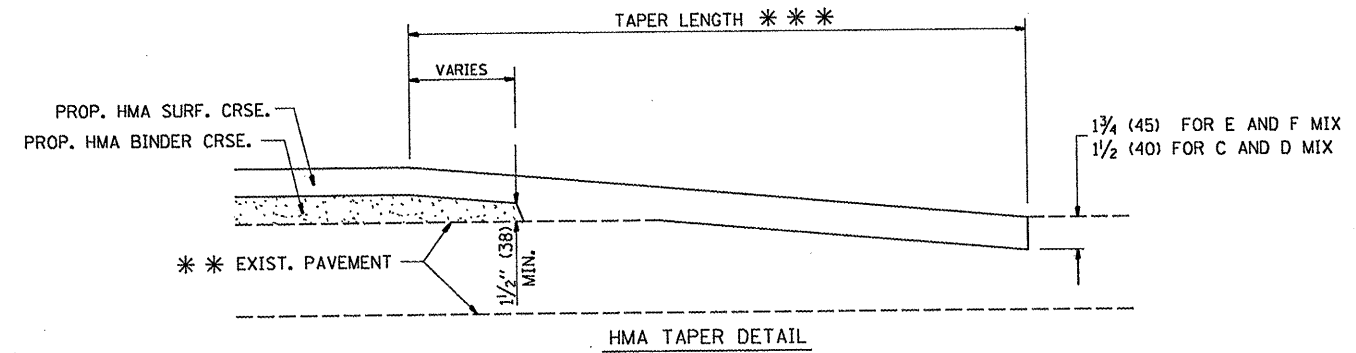
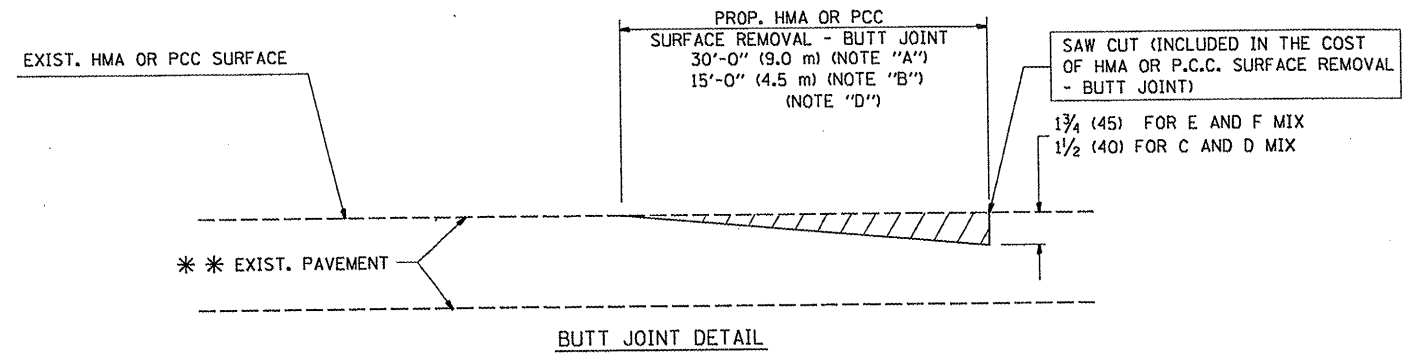

**TYPICAL BUTT JOINT AND HMA TAPER FOR RESURFACING ONLY**

\*\*\* PC CONCRETE, HMA OR HMA RESURFACED PAVEMENT.

**NOTES**

- A: MAINLINE ROADWAYS AND MAJOR SIDE ROADS.
- B: MINOR SIDE ROADS.
- C: THE TEMP. RAMP SHALL BE CONSTRUCTED IMMEDIATELY UPON REMOVAL OF THE EXISTING HMA SURFACE.
- D: THE BUTT JOINT SHALL BE CONSTRUCTED IMMEDIATELY PRIOR TO PLACING THE PROPOSED HMA COURSES.
- E: TAPER THE TEMP. RAMP AT A RATE OF 3'-0" (900 mm) PER 1 INCH (25 mm) OF MILLING THICKNESS.
- F: INSTALLATION AND REMOVAL OF THE 4'-6" (1.35 m) TEMP. RAMP IS INCLUDED IN COST OF HMA SURFACE REMOVAL - BUTT JOINT

G: SEE ARTICLE 406.08 AND 406.14 OF THE STANDARD SPECIFICATIONS FOR "HMA AND/OR PCC SURFACE REMOVAL, BUTT JOINT".

\* SEE TYPICAL SECTIONS FOR MILLING THICKNESS.

\*\*\* 20'-0" (6.1 m) PER 1 (25) RESURFACING (NOTE "A")  
10'-0" (3.0 m) PER 1 (25) RESURFACING (NOTE "B")

**BASIS OF PAYMENT:**

THE BUTT JOINT WILL BE PAID FOR AT THE CONTRACT UNIT PRICE PER SQUARE YARD (SQUARE METER) FOR "HOT-MIX ASPHALT SURFACE REMOVAL - BUTT JOINT" OR FOR "PORTLAND CEMENT CONCRETE SURFACE REMOVAL - BUTT JOINT".

ALL DIMENSIONS ARE IN INCHES (MILLIMETERS) UNLESS OTHERWISE SHOWN.

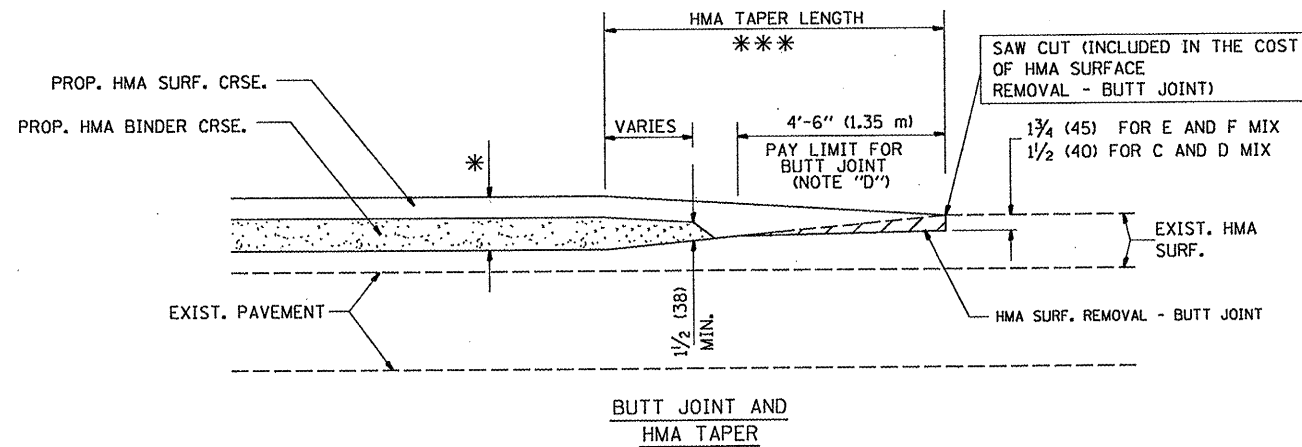

**TYPICAL BUTT JOINT AND HMA TAPER FOR MILLING AND RESURFACING**

FILE NAME =	USER NAME = whitetar	DESIGNED - M. DE YONG	REVISED - R. SHAH 10-25-94	<b>STATE OF ILLINOIS DEPARTMENT OF TRANSPORTATION</b>	<b>BUTT JOINT AND HMA TAPER DETAILS</b>			F.A. RTE. VAR	SECTION 2010-008 RS	COUNTY LAKE	TOTAL SHEETS 35	SHEET NO. 29
or:\pwwork\PWIDOT\WHITETAR\d0175544\018Std.dgn	Std.dgn	DRAWN -	REVISED - A. ABBAS 03-21-97		SCALE: NONE	SHEET NO. 1 OF 1 SHEETS	STA. TO STA.	<b>BD400-05 BD32</b>		CONTRACT NO. 60K27		
PLOT SCALE = 100.0000' / IN.	CHECKED -	REVISED - M. GOMEZ 04-06-01	DATE - 06-13-90					FED. ROAD DIST. NO. 1 ILLINOIS FED. AID PROJECT				
PLOT DATE = 2/10/2010	DATE - 06-13-90	REVISED - R. BORO 01-01-07										

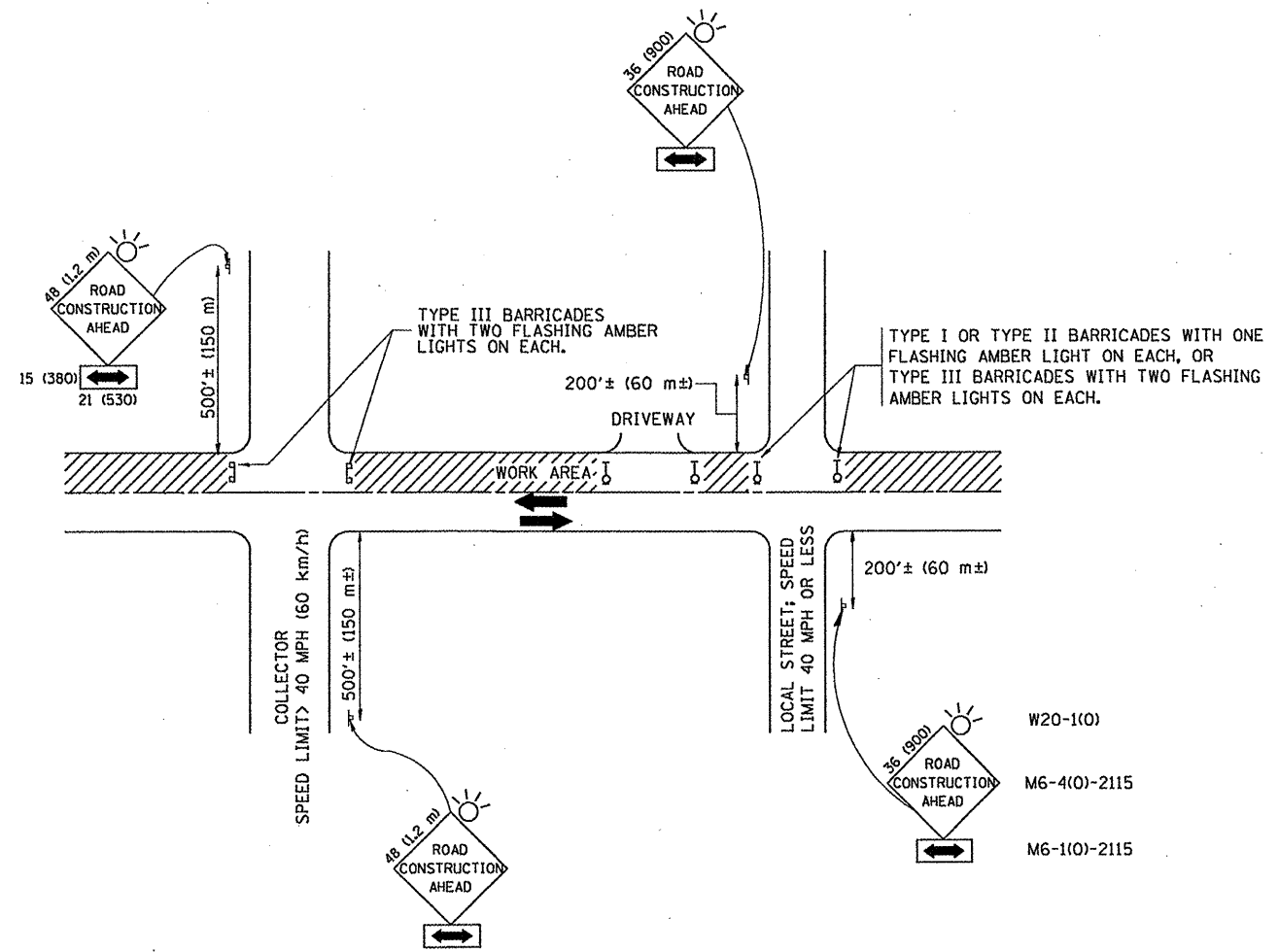

**TRAFFIC CONTROL AND PROTECTION FOR SIDE ROADS, INTERSECTIONS, AND DRIVEWAYS**

**NOTES:**

**A. FOR NO LANE RESTRICTION ON THE SIDE ROAD OR DRIVEWAYS**

1. SIDE ROAD WITH A SPEED LIMIT OF 40 MPH (60 km/h) OR LESS AS SHOWN ON THE DRAWING AND AS DIRECTED BY THE ENGINEER:

a) ONE ROAD CONSTRUCTION AHEAD SIGN 36 x 36 (900x900) WITH A FLASHER AND FLAG MOUNTED ON IT APPROXIMATELY 200' (60 m) IN ADVANCE OF THE MAIN ROUTE.

b) THE CLOSED PORTION OF THE MAIN ROUTE SHALL BE PROTECTED BY BLOCKING WITH TYPE I, TYPE II OR TYPE III BARRICADES, 1/3 OF THE CROSS SECTION OF THE CLOSED PORTION.

2. SIDE ROAD WITH A SPEED LIMIT GREATER THAN 40 MPH (60 km/h) AS SHOWN ON THE DRAWING AND AS DIRECTED BY THE ENGINEER:

a) ONE ROAD CONSTRUCTION AHEAD SIGN 48 x 48 (1.2 m x 1.2 m) WITH A FLASHER MOUNTED ON IT APPROXIMATELY 500' (150 m) IN ADVANCE OF THE MAIN ROUTE.

b) THE CLOSED PORTION OF THE MAIN ROUTE SHALL BE PROTECTED BY BLOCKING WITH TYPE III BARRICADES, 1/2 OF THE CROSS SECTION OF THE CLOSED PORTION.

3. WHEN THE SIDE ROAD LIES BETWEEN THE BEGINNING OF THE MAINLINE SIGNING AND THE WORK ZONE, A SINGLE HEADED ARROW (M6-1) SHALL BE USED IN LIEU OF THE DOUBLE HEADED ARROW (M6-4).

**B. FOR A LANE CLOSURE ON A SIDE ROAD OR DRIVEWAY:**

USE APPLICABLE PORTIONS OF THE TYPICAL APPLICATION OF TRAFFIC CONTROL DEVICES (STD. 701501, STD. 701606 OR THE APPROPRIATE STANDARD). THE SPACING OF SIGNS AND BARRICADES SHALL BE ADJUSTED FOR FIELD CONDITIONS AS DIRECTED BY THE ENGINEER. THE DIRECTIONAL ARROW SHALL BE COVERED OR REMOVED WHEN NO LONGER CONSISTENT WITH THE SIDE ROAD LANE CLOSURE.

C. ADVANCE WARNING SIGNS ARE TO BE OMITTED ON DRIVEWAY UNLESS OTHERWISE NOTED.

D. THE TRAFFIC CONTROL AND PROTECTION FOR SIDE ROADS, INTERSECTIONS, AND DRIVEWAYS SHALL BE INCIDENTAL TO THE COST OF SPECIFIED TRAFFIC CONTROL STANDARDS OR ITEMS.

All dimensions are in millimeters (inches) unless otherwise shown.

**STATE OF ILLINOIS  
DEPARTMENT OF TRANSPORTATION**

**TRAFFIC CONTROL AND PROTECTION FOR  
SIDE ROADS, INTERSECTIONS, AND DRIVEWAYS**

SCALE: NONE SHEET NO. 1 OF 1 SHEETS STA. TO STA.

F.A. RTE.	SECTION	COUNTY	TOTAL SHEETS	SHEET NO.
VAR	2010-008 RS	LAKE	35	30
TC-10			CONTRACT NO. 60K27	
FED. ROAD DIST. NO. 1 ILLINOIS FED. AID PROJECT				

FILE NAME #	USER NAME = whitetar	DESIGNED - LHA	REVISED - J. OBERLE 10-18-95
ct:\pwwork\PWIDOT\WHITETAR\0178544\01	Std.dgn	DRAWN -	REVISED - A. HOUSEH 03-06-96
	PLOT SCALE = 100.0000 ' / IN.	CHECKED -	REVISED - A. HOUSEH 10-15-96
	PLOT DATE = 2/10/2010	DATE - 06-89	REVISED - T. RAMMACHER 01-06-00

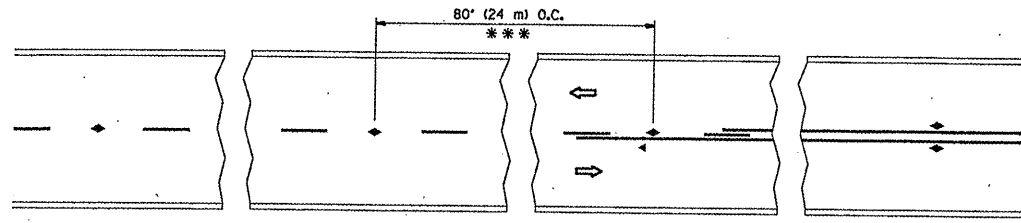

\*\*\* REDUCE TO 40' (12 m) O.C. ON CURVES WITH POSTED OR ADVISORY SPEED 45 M.P.H. (70 km/h) OR LESS.

**TWO-LANE/TWO-WAY**

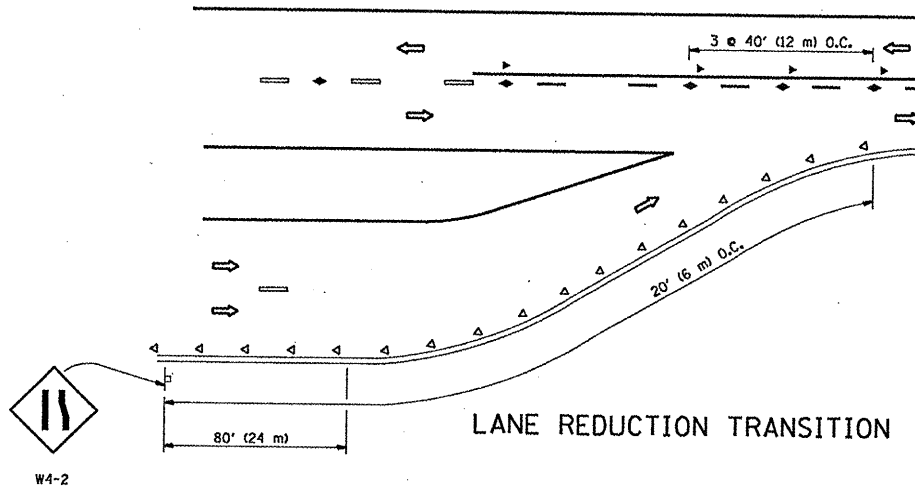

**LANE REDUCTION TRANSITION**

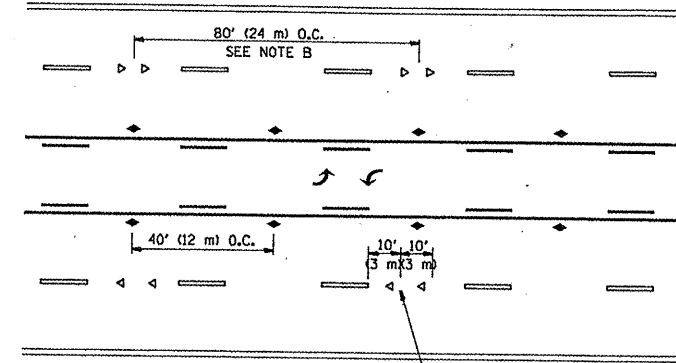

**TWO-WAY LEFT TURN**

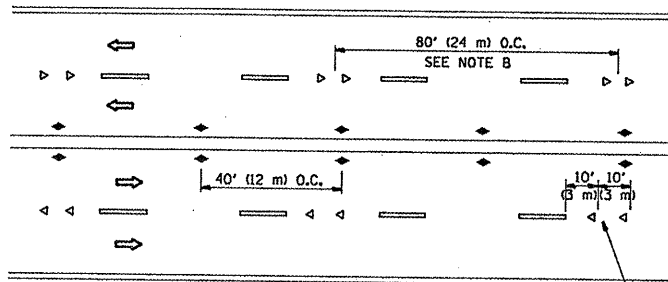

**MULTI-LANE/UNDIVIDED**

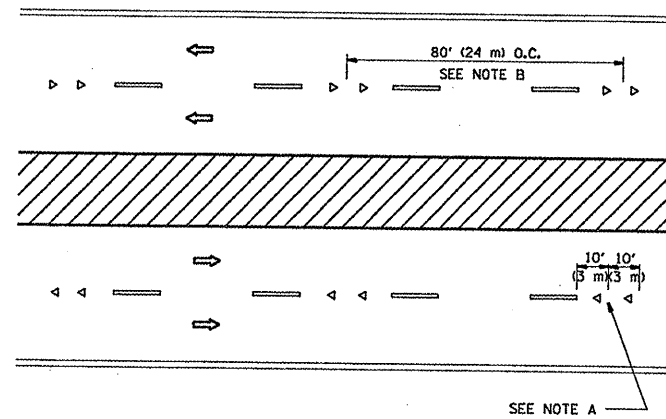

**MULTI-LANE/DIVIDED**

**GENERAL NOTES**

1. MARKERS USED WITH DASHED LINES SHALL BE CENTERED IN THE GAP BETWEEN SEGMENTS.
2. MARKERS USED ADJACENT TO SOLID LINES SHALL BE OFFSET 2 TO 3 (50 TO 75) TOWARD TRAFFIC AS SHOWN.
3. MARKERS THROUGH TANGENTS LESS THAN 500' (150 m) IN LENGTH BETWEEN CURVES SHALL BE INSTALLED AT THE LESSER OF THE TWO CURVE SPACINGS.

**SYMBOLS**

- YELLOW STRIPE
- WHITE STRIPE
- ◀ ONE-WAY AMBER MARKER
- ◄ ONE-WAY CRYSTAL MARKER (W/O)
- ◆ TWO-WAY AMBER MARKER

**LANE MARKER NOTES**

- A. USE DOUBLE LANE LINE MARKERS SPACED AS SHOWN.
- B. REDUCE TO 40' (12 m) O.C. ON CURVES WHERE ADVISORY SPEEDS ARE 10 M.P.H (20 km/h) LOWER THAN POSTED SPEEDS.

**DESIGN NOTES**

1. DOUBLE LANE LINE MARKERS SHALL BE USED UNLESS SPECIFIED OTHERWISE.
2. EXCEPT AS SHOWN ON THE LANE REDUCTION TRANSITION AND FREEWAY EXIT RAMP DETAIL, MARKERS ARE NOT TO BE SPECIFIED ON RIGHT EDGE LINES.
3. THE EXACT MARKER LIMITS, SPACING, AND COLOR SHOULD BE INCLUDED IN THE PLANS.
4. MARKERS SHOULD NOT BE USED ALONGSIDE CURBS EXCEPT FOR EXTREMELY SHORT SECTIONS OF CURBS WHERE NOT MORE THAN TWO MARKERS WOULD BE INVOLVED.

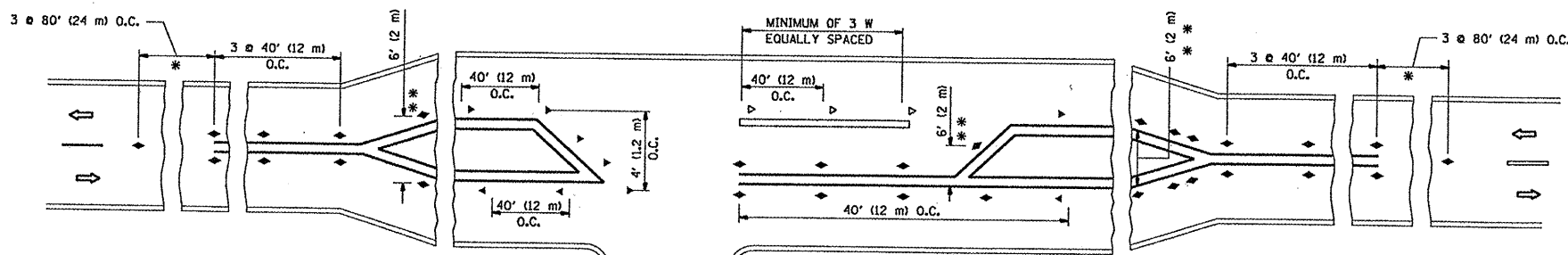

\* SEE TWO-LANE/TWO-WAY WHERE MARKERS CONTINUE  
 \*\* WHERE THE MEDIAN WIDTH IS 6' (1.2 m) OR LESS USE TWO-WAY MARKERS.

**LEFT TURN**

All dimensions are in inches (millimeters) unless otherwise shown.

FILE NAME =	USER NAME = whitatar	DESIGNED -	REVISED - T. RAMMACHER 09-19-94
cr:\pw\work\PIWIDOT\WHITATAR\d0175544\Std.dgn	Std.dgn	DRAWN -	REVISED - T. RAMMACHER 03-12-99
	PLOT SCALE = 100.0000' / IN.	CHECKED -	REVISED - T. RAMMACHER 01-06-00
	PLOT DATE = 2/10/2010	DATE -	REVISED - C. JUCIUS 09-09-09

**STATE OF ILLINOIS  
DEPARTMENT OF TRANSPORTATION**

**TYPICAL APPLICATIONS  
RAISED REFLECTIVE PAVEMENT MARKERS (SNOW-PLOW RESISTANT)**

F.A. RTE.	SECTION	COUNTY	TOTAL SHEETS	SHEET NO.
VAR.	2010-008 RS	LAKE	35	31
TC-11		CONTRACT NO. 60K27		
FED. ROAD DIST. NO. 1   ILLINOIS   FED. AID PROJECT				

SCALE: NONE SHEET NO. 1 OF 1 SHEETS STA. TO STA.

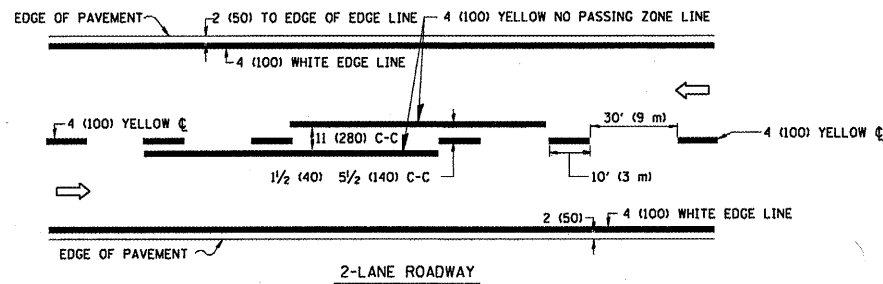

2-LANE ROADWAY

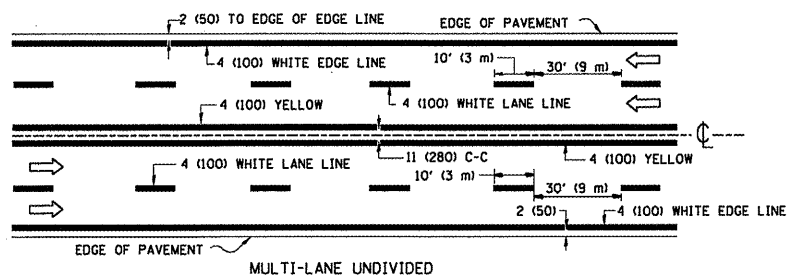

MULTI-LANE UNDIVIDED

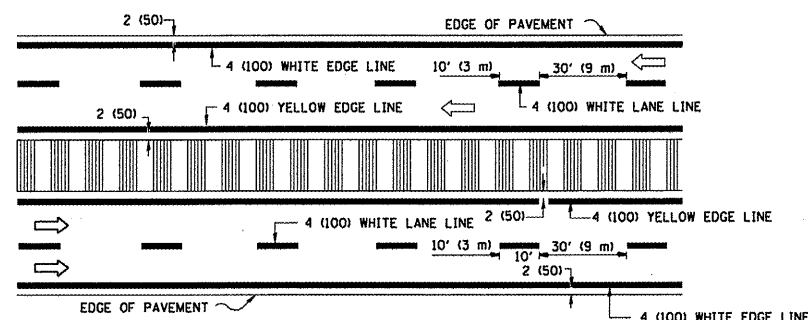

MULTI-LANE DIVIDED WITH MOUNTABLE MEDIAN

NOTE: MEDIANS WITH BARRIER CURB DO NOT REQUIRE AN EDGE LINE

TYPICAL LANE AND EDGE LINE MARKING

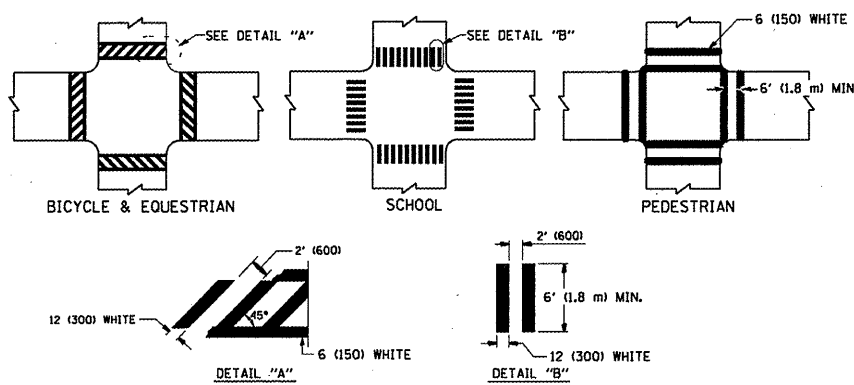

TYPICAL CROSSWALK MARKING

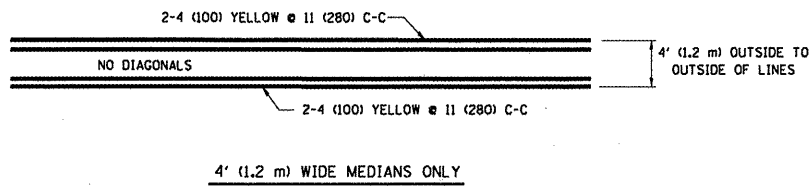

4' (1.2 m) WIDE MEDIANS ONLY

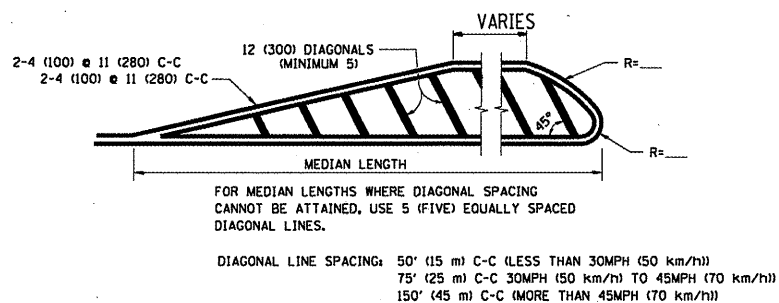

MEDIANS OVER 4' (1.2 m) WIDE

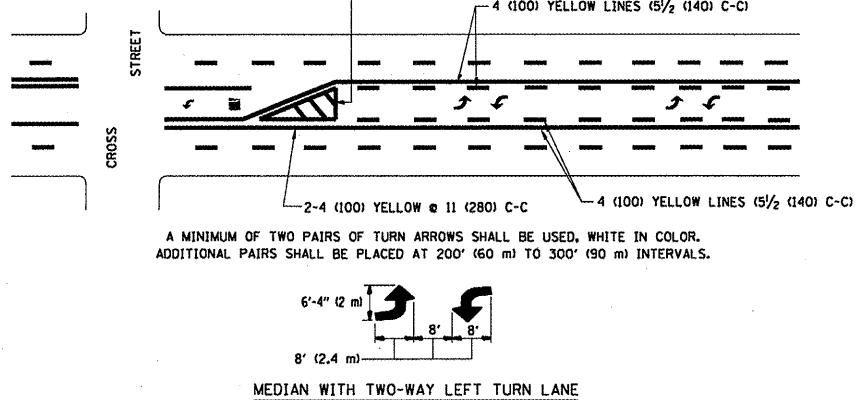

TYPICAL PAINTED MEDIAN MARKING

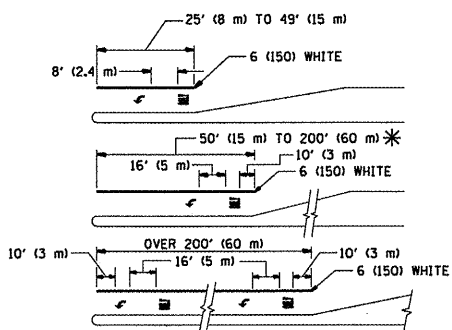

TYPICAL LEFT (OR RIGHT) TURN LANE

TYPICAL TURN LANE MARKING

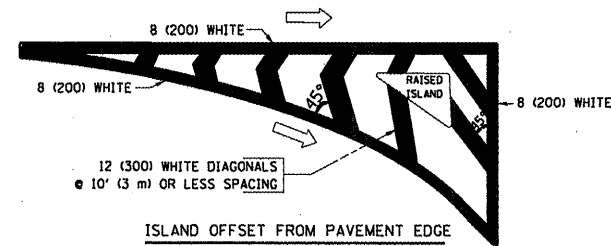

ISLAND OFFSET FROM PAVEMENT EDGE

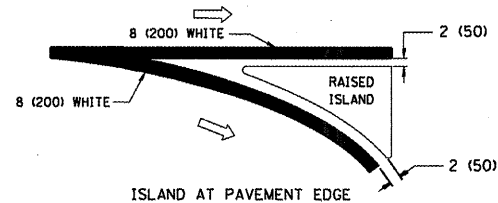

ISLAND AT PAVEMENT EDGE

TYPICAL ISLAND MARKING

TYPE OF MARKING	WIDTH OF LINE	PATTERN	COLOR	SPACING / REMARKS
CENTERLINE ON 2 LANE PAVEMENT	4 (100)	SKIP-DASH	YELLOW	10' (3 m) LINE WITH 30' (9 m) SPACE
CENTERLINE ON MULTI-LANE UNDIVIDED PAVEMENT	2 @ 4 (100)	SOLID	YELLOW	11 (280) C-C
NO PASSING ZONE LINES FOR ONE DIRECTION FOR BOTH DIRECTIONS	4 (100) 2 @ 4 (100)	SOLID SOLID	YELLOW YELLOW	5/2 (140) C-C FROM SKIP-DASH CENTERLINE 11 (280) C-C OMIT SKIP-DASH CENTERLINE BETWEEN
LANE LINES	4 (100) 5 (125) ON FREEWAYS	SKIP-DASH SKIP-DASH	WHITE WHITE	10' (3 m) LINE WITH 30' (9 m) SPACE
DOTTED LINES (EXTENSIONS OF CENTER, LANE OR TURN LANE MARKINGS)	SAME AS LINE BEING EXTENDED	SKIP-DASH	SAME AS LINE BEING EXTENDED	2' (600) LINE WITH 6' (1.8 m) SPACE
EDGE LINES	4 (100)	SOLID	YELLOW-LEFT WHITE-RIGHT	OUTLINE MOUNTABLE MEDIANS IN YELLOW; EDGE LINES ARE NOT USED NEXT TO BARRIER CURB
TURN LANE MARKINGS	6 (150) LINE; FULL SIZE LETTERS & SYMBOLS (8' (2.4m))	SOLID	WHITE	SEE TYPICAL TURN LANE MARKING DETAIL
TWO WAY LEFT TURN MARKING	2 @ 4 (100) EACH DIRECTION 8' (2.4m) LEFT ARROW	SKIP-DASH AND SOLID IN PAIRS	YELLOW WHITE	10' (3 m) LINE WITH 30' (9 m) SPACE FOR SKIP-DASH; 5/2 (140) C-C BETWEEN SOLID LINE AND SKIP-DASH LINE SEE TYPICAL TWO-WAY LEFT TURN MARKING DETAIL
CROSSWALK LINES (PEDESTRIAN) A. DIAGONALS (BIKE & EQUESTRIAN) B. LONGITUDINAL BARS (SCHOOL)	2 @ 6 (150) 12 (300) @ 45° 12 (300) @ 90°	SOLID SOLID SOLID	WHITE WHITE WHITE	NOT LESS THAN 6' (1.8 m) APART 2' (600) APART SEE TYPICAL CROSSWALK MARKING DETAILS.
STOP LINES	24 (600)	SOLID	WHITE	PLACE 4' (1.2 m) IN ADVANCE OF AND PARALLEL TO CROSSWALK, IF PRESENT. OTHERWISE, PLACE AT DESIRED STOPPING POINT. PARALLEL TO CROSSROAD CENTERLINE, WHERE POSSIBLE
PAINTED MEDIANS	2 @ 4 (100) WITH 12 (300) DIAGONALS @ 45° NO DIAGONALS USED FOR 4' (1.2 m) WIDE MEDIANS	SOLID	YELLOW; TWO WAY TRAFFIC WHITE; ONE WAY TRAFFIC	11 (280) C-C FOR THE DOUBLE LINE SEE TYPICAL PAINTED MEDIAN MARKING.
GORE MARKING AND CHANNELIZING LINES	8 (200) WITH 12 (300) DIAGONALS @ 45°	SOLID	WHITE	DIAGONALS: 15' (4.5 m) C-C (LESS THAN 30MPH (50 km/h)) 20' (6 m) C-C (30MPH (50 km/h) TO 45MPH (70 km/h)) 30' (9 m) C-C (OVER 45MPH (70 km/h))
RAILROAD CROSSING	24 (600) TRANSVERSE LINES; "RR" 15' (4.5 m) LINE FOR "X"	SOLID	WHITE	SEE STATE STANDARD 780001 AREA OF: "R"=3.6 SQ. FT. (0.33 m <sup>2</sup> ) EACH "X"=54.0 SQ. FT. (5.0 m <sup>2</sup> )
SHOULDER DIAGONALS	12 (300) @ 45°	SOLID	WHITE - RIGHT YELLOW - LEFT	50' (15 m) C-C (LESS THAN 30MPH (50 km/h)) 75' (25 m) C-C (30 MPH (50 km/h) TO 45MPH (70 km/h)) 150' (45 m) C-C (OVER 45MPH (70 km/h))

FOR FURTHER DETAILS ON PAVEMENT MARKING REFER TO STANDARD SPECIFICATIONS FOR ROAD AND BRIDGE CONSTRUCTION AND STATE STANDARD 780001.

All dimensions are in inches (millimeters) unless otherwise shown.

FILE NAME =	USER NAME = wilgreendp	DESIGNED - EVERS	REVISED - T. RAMMACHER 10-27-94
es:\p\work\p\WIDOT\WILGREENDP\0183559\dwg\Std.dgn		DRAWN -	REVISED - C. JUCIUS 09-09-09
PLOT SCALE = 100.0000' / IN.		CHECKED -	REVISED -
PLOT DATE = 2/17/2010		DATE - 03-19-90	REVISED -

STATE OF ILLINOIS  
DEPARTMENT OF TRANSPORTATION

DISTRICT ONE		F.A. RTE.	SECTION	COUNTY	TOTAL SHEETS	SHEET NO.
TYPICAL PAVEMENT MARKINGS		VAR.	2010-008 RS	LAKE	35	32
SCALE: NONE		TC-13		CONTRACT NO. 60K27		
SHEET NO. 1 OF 1 SHEETS		FED. ROAD DIST. NO. 1 ILLINOIS		FED. AID PROJECT		



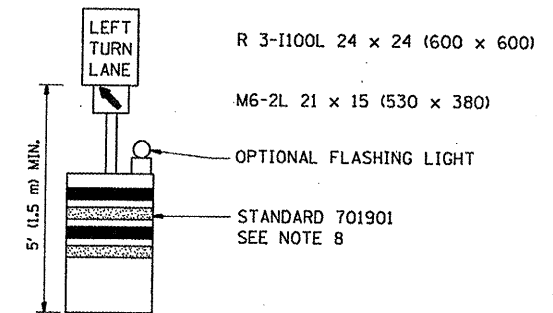
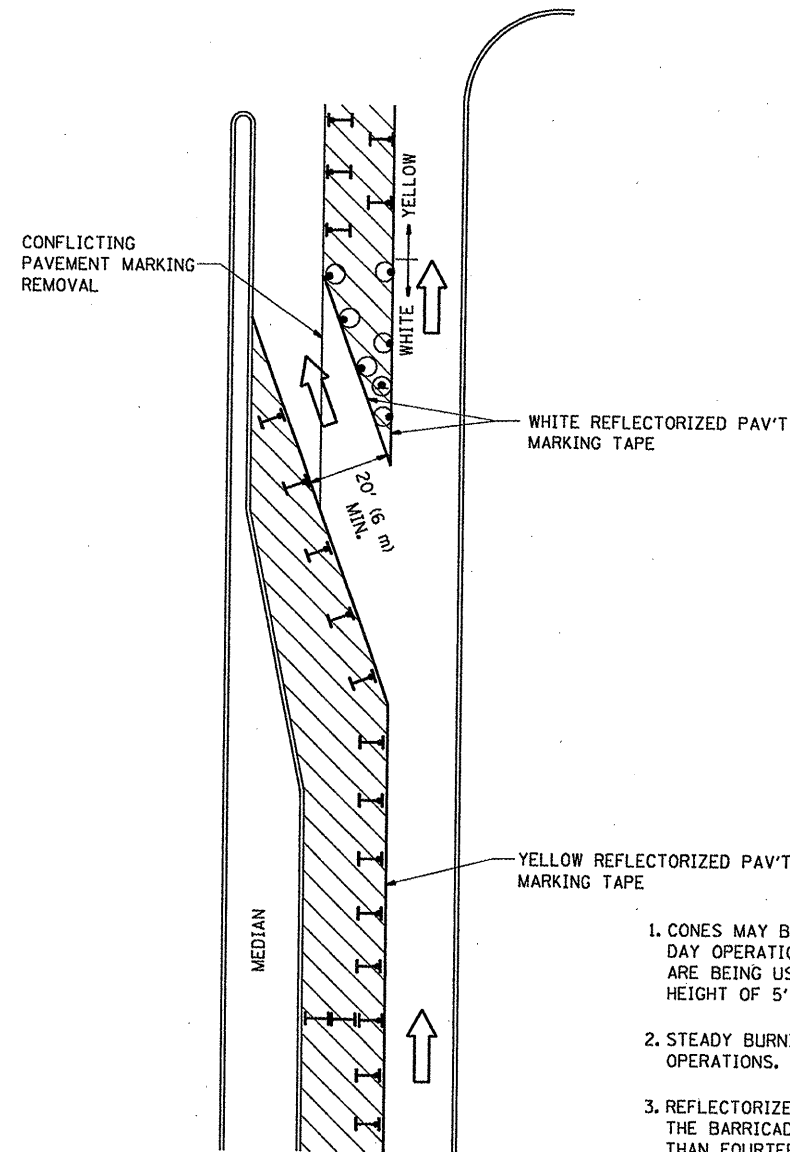





**GENERAL NOTES**

1. CONES MAY BE SUBSTITUTED FOR BARRICADES OR DRUMS AT HALF THE SPACING DURING DAY OPERATIONS. CONES SHALL BE A MINIMUM OF 28 (710) IN HEIGHT. WHEN CONES ARE BEING USED, THE "LEFT TURN LANE" SIGN MAY BE SKID MOUNTED AT A MINIMUM HEIGHT OF 5' (1.5 m).
2. STEADY BURNING LIGHTS WILL NOT BE REQUIRED ON BARRICADES OR DRUMS FOR DAY OPERATIONS. ALL LIGHTS SHALL BE MONODIRECTIONAL.
3. REFLECTORIZED TEMPORARY PAVEMENT MARKING TAPE SHALL BE PLACED THROUGHOUT THE BARRICADED AREA OF EACH TURN BAY WHERE THE CLOSURE TIME IS GREATER THAN FOURTEEN DAYS.
4. THIS APPLICATION ALSO APPLIES WHEN WORK IS BEING PERFORMED IN THE RIGHT LANE(S) AND THE RIGHT TURN BAY IS TO REMAIN OPEN. UNDER THIS CONDITION, "RIGHT TURN LANE" R3-100 24 x 24 (600 x 600) AND M6-2R 21 x 15 (530 x 380) SHALL BE USED.
5. THESE CONTROLS SHALL SUPPLEMENT MAINLINE TRAFFIC CONTROL FOR LANE CLOSURES.
6. LONGITUDINAL DIMENSIONS MAY BE ADJUSTED TO FIT FIELD CONDITIONS.
7. FORM OPER 725 IS REQUIRED.
8. IF A DRUM OR TYPE II BARRICADE WITH AN ATTACHED SIGN PANEL WHICH MEETS NCHRP 350 REQUIREMENTS IS NOT AVAILABLE, THE SIGNS SHALL BE MOUNTED, ABOVE THE BARRICADES, ON SEPARATE SIGNS SUPPORTS THAT MEET NCHRP 350 PREQUIREMENTS.
9. TRAFFIC CONTROL AND PROTECTION AT TURN BAYS (TO REMAIN OPEN TO TRAFFIC) SHALL BE INCLUDED IN THE COST SPECIFIED TRAFFIC CONTROL STANDARDS OR ITEMS.

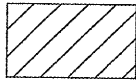
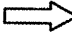
All dimensions are in inches (millimeters) unless otherwise shown.

**LEGEND**

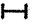
-  WORK AREA
-  LANE OPEN TO TRAFFIC
-  TYPE I OR II BARRICADE WITH STEADY BURN LIGHT
-  DRUM WITH STEADY BURN LIGHT
-  DRUM WITH SIGN (WITH OPTIONAL FLASHING LIGHT) SEE DETAIL
-  TYPE I OR II CHECK BARRICADE WITH FLASHING LIGHT

FILE NAME =	USER NAME = whitetar	REVISED - T. RAMMACHER 09-08-94	REVISED - R. BORO 09-14-09
at\pwork\PWIDOT\WHITETAR\d0175544\d018	Std.dgn	REVISED - A. HOUSEH 11-07-95	REVISED -
	PLOT SCALE = 100.0000' / IN.	REVISED - A. HOUSEH 10-12-96	REVISED -
	PLOT DATE = 2/18/2018	REVISED - T. RAMMACHER 01-06-00	REVISED -

STATE OF ILLINOIS  
DEPARTMENT OF TRANSPORTATION

TRAFFIC CONTROL AND PROTECTION AT TURN BAYS  
(TO REMAIN OPEN TO TRAFFIC)

SCALE: NONE SHEET NO. 1 OF 1 SHEETS STA. TO STA.

F.A. RTE.	SECTION	COUNTY	TOTAL SHEETS	SHEET NO.
VAR	2010-008 RS	LAKE	35	33
TC-14		CONTRACT NO. 60K27		
FED. ROAD DIST. NO. 1 ILLINOIS FED. AID PROJECT				

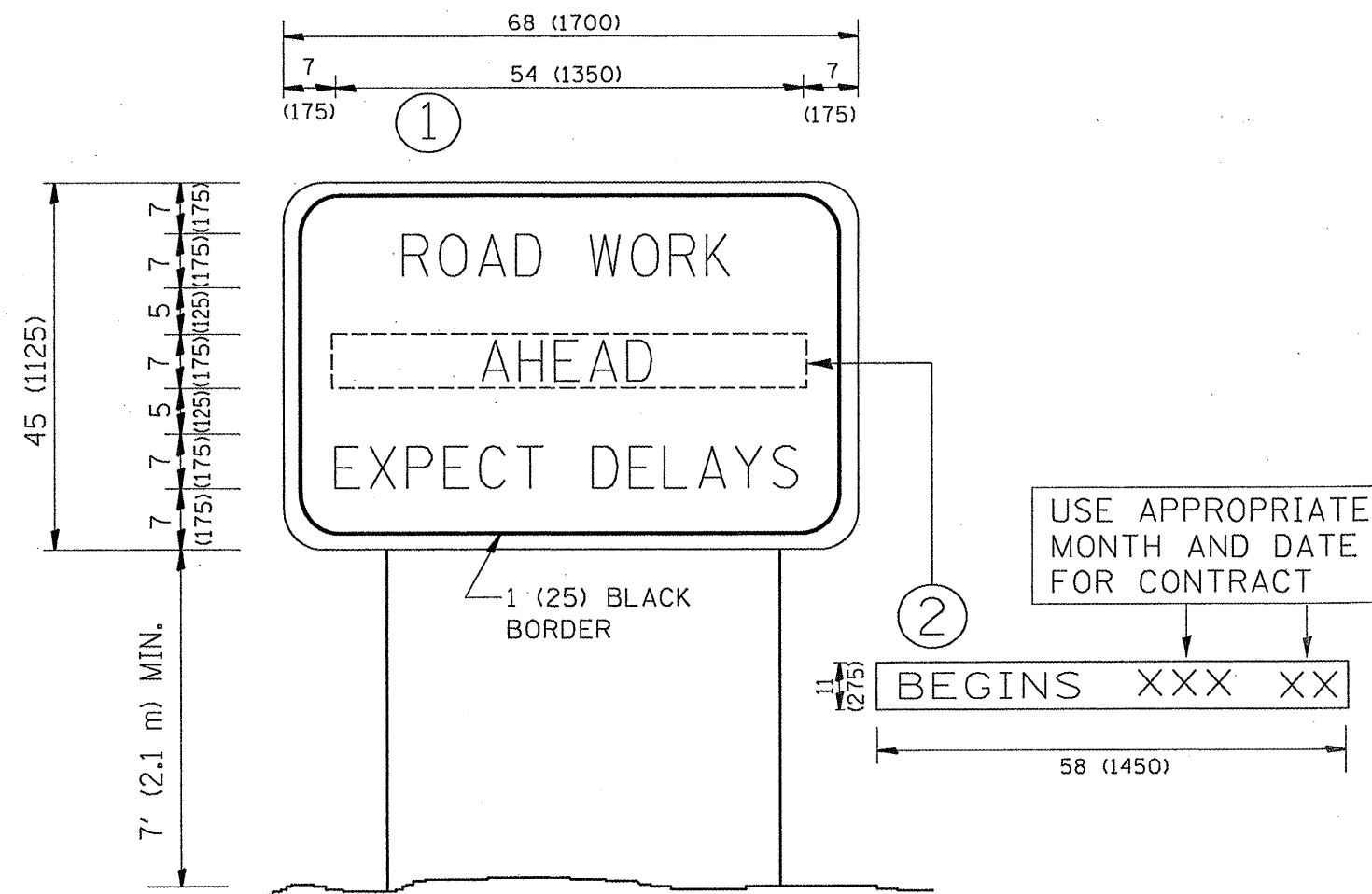

**NOTES:**

1. USE BLACK LETTERING ON ORANGE BACKGROUND.
2. ERECT SIGNS IN ADVANCE OF THE LOCATION FOR THE "ROAD CONSTRUCTION AHEAD" SIGN AT LOCATIONS AS DIRECTED BY THE ENGINEER.
3. ERECT SIGN ① WITH INSTALLED PANEL ② ONE WEEK PRIOR TO THE START OF CONSTRUCTION.
4. REMOVE PANEL ② SOON AFTER THE START OF CONSTRUCTION.
5. SEE SPECIAL PROVISION FOR "TEMPORARY INFORMATION SIGNING" FOR ADDITIONAL INFORMATION.
6. ONE SIGN ASSEMBLY EQUALS 25.70 SQ. FT. (2.3 SQ. M.)
7. SHALL BE PAID FOR AS TEMPORARY INFORMATION SIGNING.

ALL DIMENSIONS ARE IN INCHES (MILLIMETERS) UNLESS OTHERWISE SHOWN.

FILE NAME =	USER NAME = whitetar	DESIGNED -	REVISED - R. MIRS 09-15-97
ct:\pw\work\PWIDOT\WHITETAR\0175544\DI	Std.dgn	DRAWN -	REVISED - R. MIRS 12-11-97
PLOT SCALE = 100.0000 ' / IN.	CHECKED -	REVISED - T. RAMMACHER 02-02-99	
PLOT DATE = 2/10/2010	DATE -	REVISED - C. JUCIUS 01-31-07	

**STATE OF ILLINOIS  
DEPARTMENT OF TRANSPORTATION**

**ARTERIAL ROAD  
INFORMATION SIGN**

SCALE: NONE SHEET NO. 1 OF 1 SHEETS STA. TO STA.

F.A. RTE.	SECTION	COUNTY	TOTAL SHEETS	SHEET NO.
VAR	2010-008 RS	LAKE	35	34
TC-22		CONTRACT NO. 60K27		
FED. ROAD DIST. NO. 1 ILLINOIS FED. AID PROJECT				

**LOOPS NEXT TO SHOULDERS**

PROVIDE A PAVEMENT REPLACEMENT NOTE WHICH SHOULD EQUAL 3' (900 mm) X WIDTH OF PAVED SHOULDER.

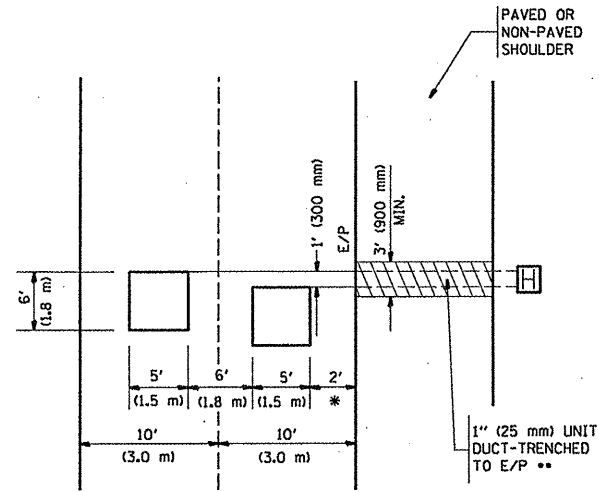

\* = (600 mm)

\*\* UNIT DUCT IS TO BE SHOWN ON PLAN SHEETS BUT SHALL NOT BE INCLUDED IN THE PAY ITEMS.

**LEFT TURN LANES WITH MEDIANS  
VOLUME DENSITY ("FAR OUT" DETECTION)  
ON SAME APPROACH  
(PROTECTED / PERMITTED LEFT TURN PHASING)**

HANDHOLE LOCATION MAY VARY DEPENDING ON GEOMETRICS AND DESIGN OF TRAFFIC SIGNALS. HEAVY-DUTY HANDHOLES TO BE USED WHEN THE MEDIAN IS MOUNTABLE. REFER TO STANDARD 814001 TO ENSURE THAT HANDHOLE FITS IN MEDIAN.

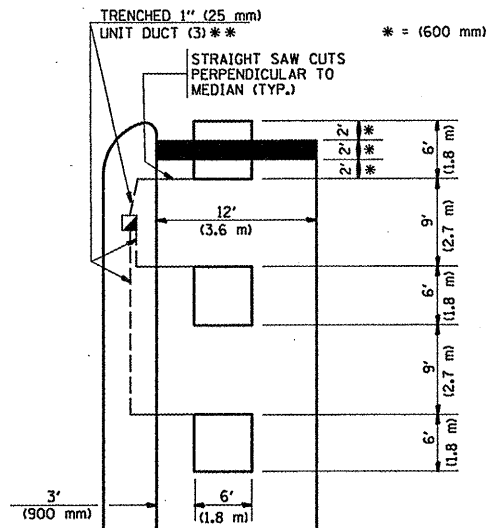

\* = (600 mm)

\*\* UNIT DUCT IS TO BE SHOWN ON PLAN SHEETS BUT SHALL NOT BE INCLUDED IN THE PAY ITEMS.

NOTE: DUAL LEFT TURNS NOT SHOWN REFER TO PLAN SHEET FOR DETECTOR LOOP REPLACEMENT

**LEFT TURN LANES WITHOUT MEDIANS  
VOLUME DENSITY ("FAR OUT" DETECTION)  
ON SAME APPROACH  
(PROTECTED / PERMITTED LEFT TURN PHASING)**

\* = (600 mm)

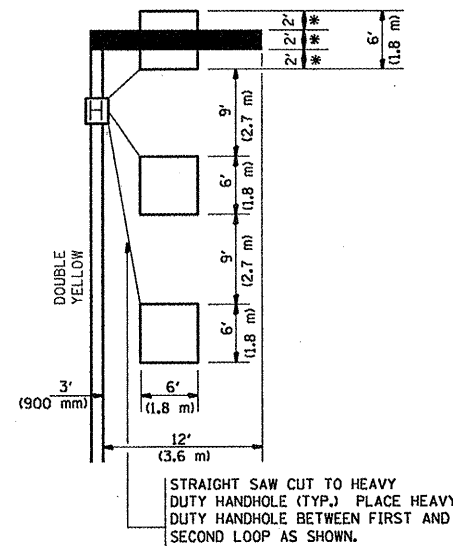

NOTE: DUAL LEFT TURNS NOT SHOWN REFER TO PLAN SHEET FOR DETECTOR LOOP REPLACEMENT

**ARTERIAL-VOLUME DENSITY ("FAR OUT" DETECTION)  
CROSS STREET-VOLUME DENSITY ("FAR OUT" DETECTION)**

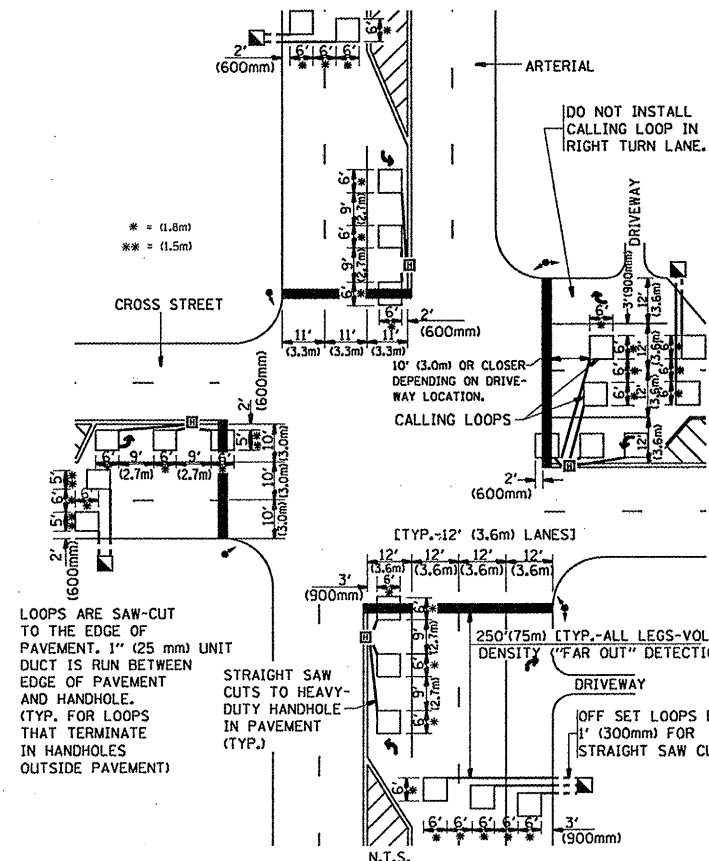

DETAIL 1  
N.T.S.

**ARTERIAL-VOLUME DENSITY ("FAR OUT" DETECTION)  
CROSS STREET-NON VOLUME DENSITY ("UPTIGHT" PRESENCE DETECTION)**

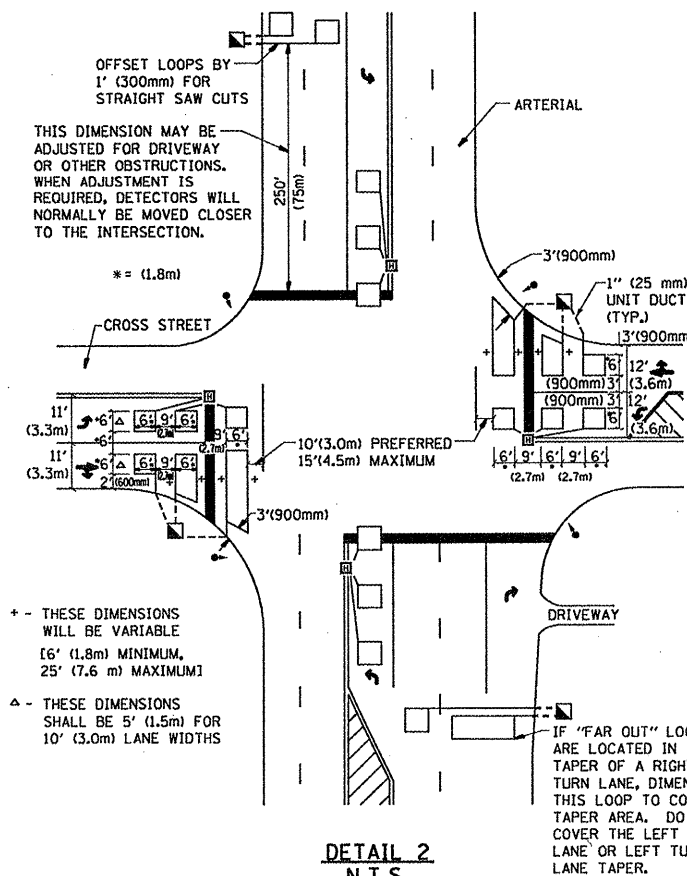

DETAIL 2  
N.T.S.

**NOTES:**

**VEHICLES LOOP DETECTORS**

- \* ALL LEAD IN CABLE SHALL BE TWO CONDUCTOR NO. 14 TWISTED, SHIELDED.
- \* EACH DETECTOR LOOP SHALL HAVE ITS OWN SAW CUT FROM THE LOOP TO THE EDGE OF PAVEMENT OR TO A HANDHOLE IN THE PAVEMENT.
- \* EACH DETECTOR LOOP SHALL HAVE ITS OWN ONE INCH (25 mm) UNIT DUCT BETWEEN THE EDGE OF PAVEMENT AND THE FIRST HANDHOLE OR JUNCTION BOX. EACH UNIT DUCT RUN SHALL BE SHOWN ON THE PLANS BY THE DESIGNER, BUT SHALL NOT BE PAID FOR SEPARATELY. THIS ITEM IS INCIDENTAL TO THE PAY ITEM FOR DETECTOR LOOPS.
- \* ONE DIMENSION OF ALL DETECTOR LOOPS SHALL BE SIX FEET (1.8 m)
- \* EACH LANE OF NON-LOCKING, PRESENCE DETECTION AND EACH LANE OF A DOUBLE LEFT TURN LANE REQUIRES A SEPARATE INDUCTIVE LOOP DETECTOR AND LEAD IN CABLE.
- \* WHEN NON-LOCKING, PRESENCE DETECTION IS USED, MORE THAN ONE LOOP PER LANE IS REQUIRED BEHIND THE STOP BAR (i.e. 1-1/2, 1-3/4, 2).
- \* WHEN SYSTEM LOOPS ARE REQUIRED ON AN APPROACH OF AN INTERSECTION, THE LOOPS USED FOR VOLUME DENSITY AND INTERSECTION TIMING SHALL ALSO BE USED AS SYSTEM DETECTORS. EACH ONE OF THESE TYPE OF LOOPS REQUIRES A SEPARATE TWO CONDUCTOR NO. 14 TWISTED SHIELDED CABLE AND A SEPARATE INDUCTIVE LOOP DETECTOR WHEN NEW CONTROLLERS ARE UTILIZED. THE DESIGNER SHALL LABEL THESE TYPES OF LOOPS AS "INTERSECTION AND SAMPLING (SYSTEM) DETECTORS" ON THE SIGNAL LAYOUT, THE INTERCONNECT PLAN AND THE SYSTEM CABLE PLAN. WHEN AN EXISTING CONTROLLER IS UTILIZED FOR THIS TYPE OF DETECTION, THE PAY ITEM "INDUCTIVE LOOP DETECTOR WITH SYSTEM OUTPUT" SHOULD BE USED.

**PLACEMENT OF DETECTORS**

THE FOLLOWING FIGURES REPRESENT THE MOST COMMON DETECTOR LOOP LOCATIONS AND SIZES. ADJUSTMENTS WILL BE NECESSARY FOR SPECIFIC GEOMETRIC CONSIDERATIONS.

LOCATIONS AND DEMENSIONS OF DETECTOR LOOPS ARE REQUIRED ON ALL SIGNAL LAYOUT PLAN SHEETS.

"FAR OUT" DETECTION REFERS TO LOCKING, PRESENCE TYPE DETECTION LOCATED IN THRU LANES, RIGHT TURN LANES, AND RIGHT TURN LANE TAPER AREAS (IF APPLICABLE), USUALLY 250' (75 m) IN ADVANCE OF STOP BARS. "UPTIGHT" DETECTION REFERS TO NON-LOCKING PRESENCE TYPE DETECTION LOCATED IN ALL LANES AND 10'-15' (3.0 m-4.5 m) BEHIND THE CROSSING STREET'S EDGE OF PAVEMENT EXTENDED.

**NOTE:**

ALL DETAILS AND NOTES SHOWN ARE FROM THE I.D.O.T. DISTRICT 1 TRAFFIC SIGNAL DESIGN GUIDELINES DATED JANUARY 1995

THIS DRAWING HAS BEEN PREPARED TO ASSIST THE RESIDENT ENGINEER FOR ALL ROADWAY RESURFACING OR S.M.A.R.T. PROJECTS WHERE THE DIMENSIONS ARE NOT SHOWN ON THE PLANS AND THE FINAL LOCATIONS FOR CROSSWALKS OR STOP BARS ARE NOT DETERMINED.

FILE NAME =	USER NAME = whitatar	DESIGNED -	REVISED -
cr\pwork\VP\WIDOT\WHITETAR\0179544\019	Std.dgn	DRAWN -	REVISED -
	PLOT SCALE = 100.0000' / IN.	CHECKED - R.K.F.	REVISED -
	PLOT DATE = 2/10/2010	DATE	REVISED -

STATE OF ILLINOIS  
DEPARTMENT OF TRANSPORTATION

DISTRICT 1 - DETECTOR LOOP INSTALLATION  
DETAILS FOR ROADWAY RESURFACING

SCALE: NONE SHEET NO. 1 OF 1 SHEETS STA. TO STA.

F.A. RTE.	SECTION	COUNTY	TOTAL SHEETS	SHEET NO.
VAR	2010-008 RS	LAKE	35	35
	TS-07	CONTRACT NO.	60K27	
FED. ROAD DIST. NO. 1 ILLINOIS FED. AID PROJECT				