

ROUTE	SECTION	COUNTY	TOTAL SHEETS	SHEET NUMBER
VARIOUS	2010-010 RS	DUPAGE	47	1

STATE OF ILLINOIS
DEPARTMENT OF TRANSPORTATION
DIVISION OF HIGHWAYS
DISTRICT ONE
PROPOSED HIGHWAY PLANS

CONTRACT NO. 60K29

D-91-468-10

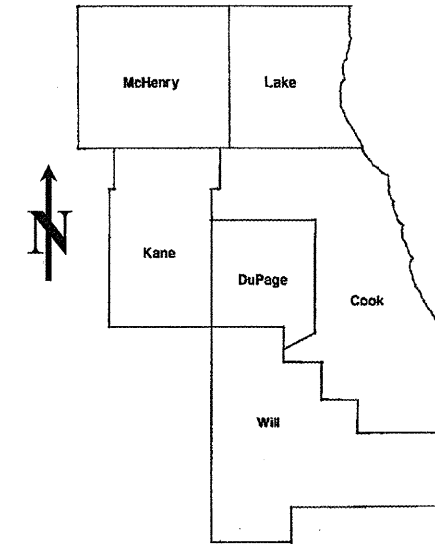

LOCATION OF IMPROVEMENT INDICATED THUS:

FOR INDEX OF SHEETS SEE SHEET 2

VARIOUS ROUTES
 SECTION: 2010-010 RS
 VARIOUS LOCATIONS IN DUPAGE COUNTY
 INTERMITTENT PAVEMENT RESURFACING
 DUPAGE COUNTY
 C-91-468-10

DISTRICT ONE - DESIGN - PLAN PREPARATION ENGINEER:
 KEN ENG / (847) 705-4247

CONTRACT NO. 60K29

STATE OF ILLINOIS
DEPARTMENT OF TRANSPORTATION
DIVISION OF HIGHWAYS
 SUBMITTED: FEBRUARY 16, 2010
Diana M. O'Keefe
DEPUTY DIRECTOR OF HIGHWAYS, REGION ENGINEER
March 19, 2010
Scott E. Stitt, P.E.
ENGINEER OF DESIGN AND ENVIRONMENT
March 19, 2010
Christine M. Reed
DIRECTOR, DIVISION OF HIGHWAYS

PRINTED BY THE AUTHORITY
OF THE STATE OF ILLINOIS

J.U.L.I.E.: JOINT UTILITY LOCATION
INFORMATION FOR EXCAVATION
(312) 744-7000

INDEX OF SHEETS

STATE STANDARDS

GENERAL NOTES

<u>SHEET NO.</u>	<u>DESCRIPTION</u>	<u>STANDARD NO.</u>	<u>DESCRIPTION</u>
1	TITLE SHEET	000001-05	TYPICAL SYMBOLS, ABBREVIATIONS AND PATTERNS
2	INDEX OF SHEETS, STATE STANDARDS AND GENERAL NOTES	701201-03	LANE CLOSURE, 2L, 2W, DAY ONLY
3	SUMMARY OF QUANTITIES	701301-03	LANE CLOSURE, 2L, 2W, SHORT TIME OPERATIONS
4	GENERAL LOCATION MAP	701306-02	LANE CLOSURE, 2L, 2W, SLOW MOVING OPERATIONS - DAY ONLY
5	SUMMARY OF PATCHING SCHEDULE	701336-05	LANE CLOSURE, 2L, 2W, WORK AREAS IN SERIES
6-40	PATCHING SCHEDULE	701501-05	URBAN LANE CLOSURE, 2L, 2W, UNDIVIDED
41	BUTT JOINT AND HMA TAPER DETAILS	701601-06	URBAN LANE CLOSURE, MULTILANE, 1W OR 2W WITH NONTRAVERSABLE MEDIAN
42	TRAFFIC CONTROL AND PROTECTION FOR SIDE ROADS, INTERSECTIONS AND DRIVEWAYS	701606-06	URBAN LANE CLOSURE, MULTILANE, 2W WITH MOUNTABLE MEDIAN
43	TYPICAL APPLICATIONS: RAISED REFLECTIVE PAVEMENT MARKERS (SNOW-PLOW RESISTANT)	701701-06	URBAN LANE CLOSURE, MULTILANE INTERSECTION
44	DISTRICT ONE TYPICAL PAVEMENT MARKINGS	701901-01	TRAFFIC CONTROL DEVICES
45	TRAFFIC CONTROL AND PROTECTION OF TURN BAYS (TO REMAIN OPEN TO TRAFFIC)		
46	ARTERIAL ROAD INFORMATION SIGN		
47	DETECTOR LOOP INSTALLATION DETAIL FOR ROADWAY RESURFACING		

BEFORE STARTING ANY EXCAVATION, THE CONTRACTOR SHALL CALL "JULIE" AT (800) 892-0123 OR 811 FOR FIELD LOCATIONS OF BURIED ELECTRIC, TELEPHONE AND GAS FACILITIES. (48 HOUR NOTIFICATION REQUIRED)

THE CONTRACTOR WILL NOT BE ALLOWED TO SET UP A YARD OR FIELD OFFICE ON STATE (OR TOLLWAY) PROPERTY WITHOUT WRITTEN PERMISSION FROM THE DEPARTMENT (OR ISTHA)

WHEN ARTIFICIAL LIGHTING IS UTILIZED IN NIGHT OPERATIONS, THE CONTRACTOR SHALL EXERCISE THE UTMOST PRECAUTIONS IN PREVENTING ADVERSE VISIBILITY TO THE MOTORING PUBLIC AND ADJOINING RESIDENTIAL AREAS.

ANY PAVEMENT MARKINGS AND RAISED REFLECTIVE PAVEMENT MARKERS OBLITERATED BY MILLING AND RESURFACING OPERATIONS ON SIDE STREETS AND ENTRANCES SHALL BE REPLACED AND PAID FOR IN KIND.

BEFORE BEGINNING ANY WORK, THE CONTRACTOR SHALL RETAIN AND RECORD FOR FUTURE REFERENCE, ALL EXISTING PAVEMENT MARKING LINES (AND RAISED REFLECTIVE PAVEMENT MARKERS) IN ORDER THAT THESE LOCATIONS CAN BE RE-ESTABLISHED FOR STRIPING. EXACT LOCATIONS OF ALL PAVEMENT MARKINGS SHALL BE AS DIRECTED BY THE ENGINEER.

ALL PAVEMENT PATCHING LOCATIONS WILL BE DETERMINED IN THE FIELD BY THE ENGINEER.

THE CONTRACTOR SHALL CONTACT THE DISTRICT ONE TRAFFIC CONTROL SUPERVISOR AT (847) 705-4470 A MINIMUM OF 72 HOURS IN ADVANCE OF BEGINNING WORK.

THE ENGINEER SHALL CONTACT MR. DON CHIARUGI, AREA TRAFFIC FIELD ENGINEER AT (847) 741-9857 MINIMUM OF TWO (2) WEEKS PRIOR TO PLACEMENT OF PERMANENT PAVEMENT MARKINGS.

DOUBLE LANE MARKERS ARE TO BE USED AS SHOWN ON THE DISTRICT ONE DETAIL "TYPICAL APPLICATIONS - RAISED REFLECTIVE PAVEMENT MARKERS (SNOW-PLOW RESISTANT)" SHOWN IN THE PLANS.

THE EXISTING ROADWAY TYPICAL SECTION IS ASSUMED TO HAVE A 3 INCH HOT-MIX ASPHALT OVERLAY ON TOP OF A TEN INCH CONCRETE BASE.

ALL PAVEMENT PATCHES SHOWN IN THE PLANS ARE TWO (2) INCH MILL AND RESURFACE ONLY. THE MINIMUM WIDTH FOR MILLING AND PATCHING SHALL BE TWO (2) FEET.

NO PATCHING OR RESURFACING IS TO BE DONE WITHIN FIFTY (50) FEET OF ANY RAILROAD CROSSING WITHOUT OBTAINING THE PROPER RAILROAD PROTECTIVE LIABILITY INSURANCE.

THE COST OF TRAFFIC CONTROL AND PROTECTION FOR THE PROJECT SHALL BE INCLUDED IN THE COST OF THE ASSOCIATED ROAD WORK.

THE COST OF ANY PARTIAL OR FULL DEPTH PATCHING REQUIRED AFTER THE REMOVAL OF THE EXISTING 2 INCH HOT-MIX ASPHALT SURFACE SHALL BE PAID FOR IN ACCORDANCE WITH ARTICLE 109.04 OF THE STANDARD SPECIFICATIONS.

HOT-MIX ASPHALT MIXTURE REQUIREMENTS

MIXTURE TYPE	AC TYPE	AIR VOIDS (%)
HOT-MIX ASPHALT SURFACE COURSE, MIX "D", N70 (IL 9.5MM), 2"	PG 64-22	4% @ 70 GYR

THE UNIT WEIGHT USED TO CALCULATE ALL HOT-MIX ASPHALT SURFACE MIXTURE QUANTITIES IS 112 LBS/SY/IN.

FILE NAME =	USER NAME = wlgreendp	DESIGNED -	REVISED -	STATE OF ILLINOIS DEPARTMENT OF TRANSPORTATION	INDEX OF SHEETS, STATE STANDARDS AND GENERAL NOTES	F.A. RTE.	SECTION	COUNTY	TOTAL SHEETS	SHEET NO.
ct:\pwwork\pwwork\wlgreendp\d0183689\Design.dgn	DRAWN -	REVISED -	VAR.			2010-010 RS	DUPAGE	47	2	
PLOT SCALE = 100.0000' / IN.	CHECKED -	REVISED -	CONTRACT NO. 60K29							
PLOT DATE = 2/20/2010	DATE -	REVISED -	FED. ROAD DIST. NO. 1 (ILLINOIS) FED. AID PROJECT							
				SCALE:	SHEET NO. OF SHEETS	STA.	TO STA.			

SUMMARY OF QUANTITIES			URBAN 100% STATE TOTAL QUANTITIES	CONSTRUCTION TYPE CODE						SUMMARY OF QUANTITIES			TOTAL QUANTITIES	CONSTRUCTION TYPE CODE					
CODE NO	ITEM	UNIT		1000						CODE NO	ITEM	UNIT							
40600200	BITUMINOUS MATERIALS (PRIME COAT)	TON	24	24															
40600300	AGGREGATE (PRIME COAT)	TON	117	117															
40600400	MIXTURE FOR CRACKS, JOINTS, AND FLANGWAYS	TON	88	88															
40600982	HOT-MIX ASPHALT SURFACE REMOVAL - BUTT JOINT	SO YD	1752	1752															
40603340	HOT-MIX ASPHALT SURFACE COURSE, MIX "D", N70	TON	6538	6538															
44000157	HOT-MIX ASPHALT SURFACE REMOVAL, 2"	SO YD	58368	58368															
67000400	ENGINEER'S FIELD OFFICE, TYPE A	CAL MO	6	6															
67100100	MOBILIZATION	L SUM	1	1															
70300100	SHORT-TERM PAVEMENT MARKING	FOOT	12968	12968															
70301000	WORK ZONE PAVEMENT MARKING REMOVAL	SO FT	4323	4323															
* 78000100	THERMOPLASTIC PAVEMENT MARKING - LETTERS AND SYMBOLS	SO FT	200	200															
* 78000200	THERMOPLASTIC PAVEMENT MARKING - LINE 4"	FOOT	36000	36000															
* 78000400	THERMOPLASTIC PAVEMENT MARKING - LINE 6"	FOOT	2960	2960															
* 78000500	THERMOPLASTIC PAVEMENT MARKING - LINE 8"	FOOT	150	150															
* 78000600	THERMOPLASTIC PAVEMENT MARKING - LINE 12"	FOOT	424	424															
* 78000650	THERMOPLASTIC PAVEMENT MARKING - LINE 24"	FOOT	360	360															
* 78100100	RAISED REFLECTIVE PAVEMENT MARKER	EACH	1975	1975															
78300200	RAISED REFLECTIVE PAVEMENT MARKER REMOVAL	EACH	1975	1975															
* 88600600	DETECTOR LOOP REPLACEMENT	FOOT	2080	2080															
X0322256	TEMPORARY INFORMATION SIGNING	SO FT	1645	1645															
* SPECIALTY ITEM																			

FILE NAME =	USER NAME = wjgreendp	DESIGNED -	REVISED -	STATE OF ILLINOIS DEPARTMENT OF TRANSPORTATION				SUMMARY OF QUANTITIES				F.A. RTE.	SECTION	COUNTY	TOTAL SHEETS	SHEET NO.					
c:\pwr\work\p10\wjlgrndp\d0183609\Design.dgn		DRAWN -	REVISED -									VAR.	2010-010 RS	DUPAGE	47	3					
	PLOT SCALE = 100,0000' / IN.	CHECKED -	REVISED -									SCALE:	SHEET NO.	OF	SHEETS	STA.	TO STA.	FED. ROAD DIST. NO. 1 (ILLINOIS) FED. AID PROJECT			
	PLOT DATE = 2/20/2010	DATE -	REVISED -									CONTRACT NO. 60K29									

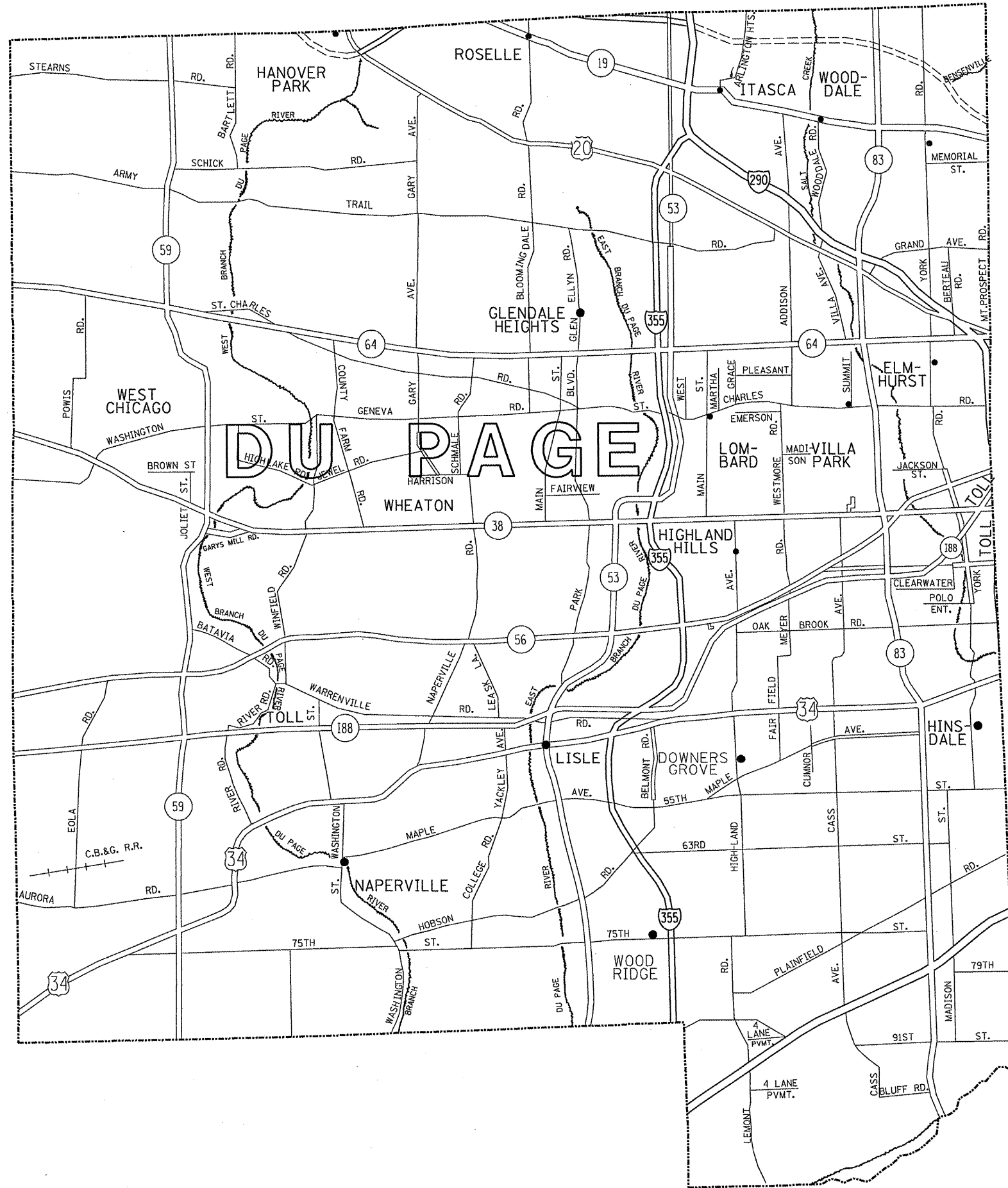

FILE NAME =	USER NAME = wilgreendp	DESIGNED -	REVISED -	STATE OF ILLINOIS DEPARTMENT OF TRANSPORTATION	GENERAL LOCATION MAP - DUPAGE COUNTY			F.A. RTE.	SECTION	COUNTY	TOTAL SHEETS	SHEET NO.
es:\pwwork\pwidot\WILGREENDP\j0183609\design.dgn		DRAWN -	REVISED -		VAR.	2010-010 RS	DUPAGE	47	4			
PLOT SCALE = 100.0000' / IN.		CHECKED -	REVISED -		SCALE: SHEET NO. OF SHEETS STA. TO STA.			CONTRACT NO. 60K29				
PLOT DATE = 2/10/2010		DATE -	REVISED -					FED. ROAD DIST. NO. 1 (ILLINOIS) FED. AID PROJECT				

SUMMARY - DUPAGE COUNTY ROUTES	HMA 2" MILL & RESURFACE (SY)
IL 19 (ADDISON RD. TO OAK WOOD RD.)	870
IL 19 (BAKER DR. TO LLOYD AVE.)	1031
IL 19 (EASTVIEW AVE. TO DIVISION ST.)	3177
IL 19 (EMMERSON AVE. TO PROSPECT AVE.)	889
IL 19 (SPRING LAKE DR. TO WALNUT AVE.)	2052
IL 38 WB (HIGHLAND AVE. TO MAIN ST. IN LOMBARD)	27
IL 38 (IL 53 TO NICOLL WAY)	27
IL 38 (COUNTY FARM RD. TO IL 53)	221
IL 38 (HARRISON ST. TO MICHIGAN AVE.)	2252
IL 53 (IL 56 TO WILSON AVE.)	1336
IL 53 (IL 64 TO SIDNEY AVE.)	8000
IL 56 (CAMDEN CT. TO FAIRFIELD AVE.)	3100
IL 56 EB (LEFT TURN LANE TO GRAY AVE.)	667
IL 56 EB (LEFT TURN LAN TO BOB-O-LINK RD.)	189
IL 56 WB (I-355 TO LLOYD AVE. LEFT TURN BAYS)	800
IL 56 (IL 83 TO CAMBRIDGE AVE.)	511
IL 56 WB (TO WB IL 38 ENTRANCE RAMP)	240
IL 56 EB (EAST OF BRIARCLIFF RD. TO ESPLANADE RD.)	588
IL 56 (WEST BRANCH DUPAGE RIVER TO IL 53)	3393
IL 64 (I-290 WB RAMP TO BERTEAU AVE)	878
IL 64 (BROADVIEW AVE. TO EAST OF I-355)	2786
IL 83 SB (67TH ST. TO PLAINFIELD RD.)	872
IL 83 SB (74TH ST. TO 75TH ST.)	58
IL 83 (HAWTHORN AVE. TO FOSTER AVE.)	141
IL 83 (AT IL 38 EXIT RAMPS)	405
IL 83 (NORTH AND SOUTH OF THORNDALE AVE.)	342
IL 83 NB (SOUTH OF MIDWAY DR. TO 72ND CT.)	461
IL 83 NB (SOUTH OF PLAINFIELD RD. TO 69TH ST.)	356
IL 83 NB (BLUFF RD. TO NIELSON RD.)	551
IL 83 NB (CASCADE CIRCLE TO TIMBERLAKE DR.)	552
IL 83 (DEVON AVE. TO TOWER LN.)	2039
IL 83 (HILLSIDE DR. TO FAY AVE.)	6634
US 20 (WEST BRANCH DUPAGE RIVER TO GARY AVE.)	926
US 20 (END OF I-290 EXIT RAMP TO WALNUT ST.)	1333
US 20 (YORK RD. TO 100 FT. WEST OF YORK RD.)	528
US 34 (NORTH AURORA RD. TO BELMONT RD.)	9475
US 34 (BLACKHAWK DR. TO SALT CREEK LN.)	404
YORK RD. (SOUTH OF BRIDGE TO FRONTAGE RD.)	257
DUPAGE COUNTY TOTALS =	58368
	SY

FILE NAME =	USER NAME = wilgreendp	DESIGNED -	REVISED -	STATE OF ILLINOIS DEPARTMENT OF TRANSPORTATION	SUMMARY OF PATCHING SCHEDULE DUPAGE COUNTY			F.A. RTE.	SECTION	COUNTY	TOTAL SHEETS	SHEET NO.	
ca:\pwwork\pwwidot\wilgreendp\08183609\Design.dgn	DRAWN -	REVISED -	REVISED -					VAR.	2010-010 RS	DUPAGE	47	5	
PLOT SCALE = 100.0000' / IN.	CHECKED -	REVISED -	REVISED -		SCALE:	SHEET NO.	OF	SHEETS	STA.	TO	STA.	FED. ROAD DIST. NO. 1	ILLINOIS FED. AID PROJECT
PLOT DATE = 2/20/2010	DATE -	REVISED -	REVISED -										CONTRACT NO. 60K29

ROUTE: IL 19 (Baker Dr. to Lloyd Ave.)									
CROSS STREETS		DIRECTION	LANE	PAVEMENT	PAVEMENT	REPAIR	REPAIR		
FROM	TO	(EB/WB)	NO.	PATCH	PATCH	AREA	AREA		
		(NB/SB)	(1, 2, 3)	WIDTH	LENGTH	(SQ FT)	(SQ YD)		
Baker Dr.	Lloyd Ave.	EB	1	12	6	72	8		
		EB	2	12	6	72	8		
		EB	1	12	6	72	8		
		EB	2	12	6	72	8		
		EB	1	12	6	72	8		
		EB	2	12	6	72	8		
		EB	1	12	6	72	8		
		EB	2	12	6	72	8		
		EB	1	12	6	72	8		
		EB	2	12	6	72	8		
		EB	1	12	6	72	8		
		EB	2	12	6	72	8		
		EB	1	12	6	72	8		
		EB	2	12	6	72	8		
		EB	1	12	6	72	8		
		EB	2	12	6	72	8		
		EB	1	12	6	72	8		
		EB	2	12	6	72	8		
		Baker Dr.	Lloyd Ave.	EB	1	12	6	72	8
				EB	2	12	6	72	8
EB	1			12	6	72	8		
EB	2			12	6	72	8		
EB	1			12	6	72	8		
EB	2			12	6	72	8		
EB	1			12	6	72	8		
EB	2			12	6	72	8		
EB	1			12	6	72	8		
EB	2			12	6	72	8		
EB	1			12	6	72	8		
EB	2			12	6	72	8		
EB	1			12	6	72	8		
EB	2			12	6	72	8		
EB	1			12	6	72	8		
EB	2			12	6	72	8		
EB	1			12	6	72	8		
EB	2			12	6	72	8		
EB	2			2	200	400	44		
EB	2			12	200	2400	267		

ROUTE: IL 19 (Baker Dr. to Lloyd Ave.)									
CROSS STREETS		DIRECTION	LANE	PAVEMENT	PAVEMENT	REPAIR	REPAIR		
FROM	TO	(EB/WB)	NO.	PATCH	PATCH	AREA	AREA		
		(NB/SB)	(1, 2, 3)	WIDTH	LENGTH	(SQ FT)	(SQ YD)		
Baker Dr.	Lloyd Ave.	WB	1	12	6	72	8		
		WB	2	12	6	72	8		
		WB	1	12	6	72	8		
		WB	2	12	6	72	8		
		WB	1	12	6	72	8		
		WB	2	12	6	72	8		
		WB	1	12	6	72	8		
		WB	2	12	6	72	8		
		WB	1	12	6	72	8		
		WB	2	12	6	72	8		
		WB	1	12	6	72	8		
		WB	2	12	6	72	8		
		WB	1	12	6	72	8		
		WB	2	12	6	72	8		
		WB	1	12	6	72	8		
		WB	2	12	6	72	8		
		WB	1	12	6	72	8		
		WB	2	12	6	72	8		
		Baker Dr.	Lloyd Ave.	WB	2	12	6	72	8
				WB	1	12	6	72	8
WB	2			12	6	72	8		
WB	1			12	6	72	8		
WB	2			12	6	72	8		
WB	1			12	6	72	8		
WB	2			12	6	72	8		
WB	1			12	6	72	8		
WB	2			12	6	72	8		
WB	1			12	6	72	8		
WB	2			12	6	72	8		
WB	1			12	6	72	8		
WB	2			12	6	72	8		
WB	1			12	6	72	8		
WB	2			12	6	72	8		
WB	1			12	6	72	8		
WB	2			12	6	72	8		
WB	2			2	20	400	44		
WB	2			12	20	240	27		
WB	2			12	20	240	27		
TOTALS:						970	1031		
						FT	SY		

ROUTE: IL 19 (Eastview Ave. to Division St.)							
CROSS STREETS		DIRECTION	LANE	PAVEMENT	PAVEMENT	REPAIR	REPAIR
FROM	TO	(EB/WB) (NB/SB)	NO. (1, 2, 3)	PATCH WIDTH	PATCH LENGTH	AREA (SQ FT)	AREA (SQ YD)
Eastview Ave.	Division St.	WB	1	12	6	72	8
		WB	2	12	6	72	8
		WB	1	12	6	72	8
		WB	2	12	6	72	8
		WB	1	12	6	72	8
		WB	2	12	6	72	8
		WB	1	12	6	72	8
		WB	2	12	6	72	8
		WB	1	12	6	72	8
		WB	2	12	6	72	8
		WB	1	12	6	72	8
		WB	2	12	6	72	8
		WB	1	12	6	72	8
		WB	2	12	6	72	8
		WB	1	12	6	72	8
Eastview Ave.	Division St.	WB	2	12	6	72	8
		WB	1	12	6	72	8
		WB	2	12	6	72	8
		WB	1	12	6	72	8
		WB	2	12	6	72	8
		WB	1	12	6	72	8
		WB	2	12	6	72	8
		WB	1	12	6	72	8
		WB	2	12	6	72	8
		WB	1	12	6	72	8
		WB	2	12	6	72	8
		WB	1	12	6	72	8
		WB	2	12	6	72	8
		WB	1	12	6	72	8
		WB	2	12	6	72	8
Eastview Ave.	Division St.	WB	2	12	6	72	8
		WB	1	12	6	72	8
		WB	2	12	6	72	8
		WB	1	12	6	72	8
		WB	2	12	6	72	8
		WB	1	12	6	72	8
		WB	2	12	6	72	8
		WB	1	12	6	72	8
		WB	2	12	6	72	8
		WB	1	12	6	72	8
		WB	2	12	6	72	8
		WB	1	12	6	72	8
		WB	2	12	6	72	8
		WB	1	12	6	72	8
		WB	2	12	6	72	8

ROUTE: IL 19 (Eastview Ave. to Division St.)									
CROSS STREETS		DIRECTION	LANE	PAVEMENT	PAVEMENT	REPAIR	REPAIR		
FROM	TO	(EB/WB) (NB/SB)	NO. (1, 2, 3)	PATCH WIDTH	PATCH LENGTH	AREA (SQ FT)	AREA (SQ YD)		
		WB	1	12	6	72	8		
		WB	2	12	6	72	8		
		WB	1	12	6	72	8		
		WB	2	12	6	72	8		
		WB	1	12	6	72	8		
		WB	2	12	6	72	8		
		WB	1	12	6	72	8		
		WB	2	12	6	72	8		
		WB	1	12	6	72	8		
		WB	2	12	6	72	8		
		WB	1	12	6	72	8		
		WB	2	12	6	72	8		
		WB	1	12	6	72	8		
		WB	2	12	6	72	8		
		WB	1	12	6	72	8		
		WB	2	12	6	72	8		
		WB	1	12	6	72	8		
		WB	2	12	6	72	8		
		WB	1	12	6	72	8		
		WB	2	12	6	72	8		
		WB	1	12	6	72	8		
		WB	2	12	6	72	8		
		WB	1	12	6	72	8		
		WB	2	12	6	72	8		
		WB	1	12	6	72	8		
		WB	2	12	6	72	8		
		Eastview Ave.	Division St.	WB	2	12	6	72	8
				WB	1	12	6	72	8
				WB	2	12	6	72	8
				WB	1	12	6	72	8
WB	2			12	6	72	8		
WB	1			12	6	72	8		
Eastview Ave.	Division St.	WB	2	12	6	72	8		
		WB	1	12	6	72	8		
		WB	2	12	6	72	8		
		WB	1	12	6	72	8		
		WB	2	12	6	72	8		
		WB	1	12	6	72	8		
Eastview Ave.	Division St.	WB	2	12	6	72	8		
		WB	1	12	6	72	8		
		WB	2	12	6	72	8		
		WB	1	12	6	72	8		
		WB	2	12	6	72	8		
		WB	1	12	6	72	8		

CONTINUED ON NEXT SHEET

FILE NAME =	USER NAME = wilgreendp	DESIGNED -	REVISED -	STATE OF ILLINOIS DEPARTMENT OF TRANSPORTATION	PATCHING SCHEDULE IL 19		F.A. RTE.	SECTION	COUNTY	TOTAL SHEETS	SHEET NO.
c:\pwork\puidot\wilgreendp\d0183609\Design.dgn	DRAWN -	REVISED -	VAR.				2010-010 RS	DUPAGE	47	8	
PLOT SCALE = 100.0000 ' / IN.	CHECKED -	REVISED -	SCALE: SHEET NO. OF SHEETS STA. TO STA.		FED. ROAD DIST. NO. 1 ILLINOIS FED. AID PROJECT		CONTRACT NO. 60K29				
PLOT DATE = 2/20/2010	DATE -	REVISED -									

ROUTE: IL 19 (Spring Lake Dr. to Walnut Ave.)									
CROSS STREETS		DIRECTION (EB/WB) (NB/SB)	LANE NO. (1, 2, 3)	PAVEMENT		REPAIR			
FROM	TO			PATCH WIDTH	PATCH LENGTH	AREA (SQ FT)	AREA (SQ YD)		
Spring Lake Dr.	Walnut Ave.	EB	1	12	6	72	8		
		EB	2	12	6	72	8		
		EB	1	12	6	72	8		
		EB	2	12	6	72	8		
		EB	1	12	6	72	8		
		EB	2	12	6	72	8		
		EB	1	12	6	72	8		
		EB	2	12	6	72	8		
		EB	1	12	6	72	8		
		EB	2	12	6	72	8		
		EB	1	12	6	72	8		
		EB	2	12	6	72	8		
		EB	1	12	6	72	8		
		EB	2	12	6	72	8		
		EB	1	12	6	72	8		
		EB	2	12	6	72	8		
		EB	1	12	6	72	8		
		EB	2	12	6	72	8		
		Spring Lake Dr.	Walnut Ave.	EB	2	12	6	72	8
				EB	1	12	6	72	8
EB	2			12	6	72	8		
EB	1			12	6	72	8		
EB	2			12	6	72	8		
EB	1			12	6	72	8		
EB	2			12	6	72	8		
EB	1			12	6	72	8		
EB	2			12	6	72	8		
EB	1			12	6	72	8		
EB	2			12	6	72	8		
EB	1			12	6	72	8		
EB	2			12	6	72	8		
EB	1			12	6	72	8		
EB	2			12	6	72	8		
EB	1			12	6	72	8		
EB	2			12	6	72	8		

ROUTE: IL 19 (Spring Lake Dr. to Walnut Ave.)							
CROSS STREETS		DIRECTION (EB/WB) (NB/SB)	LANE NO. (1, 2, 3)	PAVEMENT		REPAIR	
FROM	TO			PATCH WIDTH	PATCH LENGTH	AREA (SQ FT)	AREA (SQ YD)
Spring Lake Dr.	Walnut Ave.	EB	2	12	6	72	8
		EB	1	12	6	72	8
		EB	2	12	6	72	8
		EB	1	12	6	72	8
		EB	2	12	6	72	8
		EB	1	12	6	72	8
		EB	2	12	6	72	8
		EB	1	12	6	72	8
		EB	2	12	6	72	8
		EB	1	12	6	72	8
		EB	2	12	6	72	8
		EB	1	12	6	72	8
		EB	2	12	6	72	8
		EB	1	12	6	72	8
		EB	2	12	6	72	8
		EB	1	12	6	72	8
		EB	2	12	6	72	8
		EB	1	12	6	72	8
		EB	2	12	6	72	8
		Spring Lake Dr.	Walnut Ave.	EB	2	2	100
EB	2			2	300	600	67
EB	2			2	100	200	22
EB	2			12	8	96	11
EB	2			12	10	120	13
EB	1			12	30	360	40
WB	1			12	6	72	8
WB	1			12	6	72	8
WB	1			12	6	72	8
WB	1			12	6	72	8
WB	1			12	6	72	8
WB	1			12	6	72	8
WB	1			12	6	72	8
WB	1			12	6	72	8
WB	1			12	6	72	8
WB	1			12	6	72	8
WB	1			12	6	72	8
WB	1			12	6	72	8
WB	1			12	6	72	8
Spring Lake Dr.	Walnut Ave.			WB	1	12	6
		WB	1	12	6	72	8
		WB	1	12	6	72	8
		WB	1	12	6	72	8
		WB	1	12	6	72	8
		WB	1	12	6	72	8
		WB	1	12	6	72	8
		WB	1	12	6	72	8
		WB	1	12	6	72	8
		WB	1	12	6	72	8
		WB	1	12	6	72	8
		WB	1	12	6	72	8
		WB	1	12	6	72	8
		WB	1	12	6	72	8
		WB	1	12	6	72	8
		WB	1	12	6	72	8
		WB	1	12	6	72	8

CONTINUED ON NEXT SHEET

FILE NAME =	USER NAME = wilgreendp	DESIGNED -	REVISED -	STATE OF ILLINOIS DEPARTMENT OF TRANSPORTATION	PATCHING SCHEDULE IL 19			F.A. RTE.	SECTION	COUNTY	TOTAL SHEETS	SHEET NO.		
ce:\pwk\work\p1\dot\wilgreendp\d0183689\Design.dgn	DRAWN -	REVISED -	REVISED -		SCALE:	SHEET NO.	OF	SHEETS	STA.	TO STA.	VAR.	2010-010 RS	DUPAGE	47 12
	PLOT SCALE = 100.0000' / IN.	CHECKED -	REVISED -		FED. ROAD DIST. NO. 1	ILLINOIS FED. AID PROJECT		CONTRACT NO. 60K29						
	PLOT DATE = 2/20/2010	DATE -	REVISED -											

ROUTE: IL 38 WB (Highland Ave. to Main St. in Lombard)							
CROSS STREETS		DIRECTION	LANE	PAVEMENT	PAVEMENT	REPAIR	REPAIR
FROM	TO	(EB/WB)	NO.	PATCH	PATCH	AREA	AREA
		(NB/SB)	(1, 2, 3)	WIDTH	LENGTH	(SQ FT)	(SQ YD)
Highland Ave.	Main St.	WB	1 & 2	2	50	100	11
		WB	2	12	12	144	16
TOTALS:					62		27
					FT		SY

ROUTE: IL 38 (IL 53 to Nicoll Way)							
CROSS STREETS		DIRECTION	LANE	PAVEMENT	PAVEMENT	REPAIR	REPAIR
FROM	TO	(EB/WB)	NO.	PATCH	PATCH	AREA	AREA
		(NB/SB)	(1, 2, 3)	WIDTH	LENGTH	(SQ FT)	(SQ YD)
IL 53	Nicoll Way	EB	1	12	4	48	5
		EB	1	12	4	48	5
		WB	1	12	12	144	16
TOTALS:					20		27
					FT		SY

ROUTE: IL 38 (County Farm Rd. to IL 53)							
CROSS STREETS		DIRECTION	LANE	PAVEMENT	PAVEMENT	REPAIR	REPAIR
FROM	TO	(EB/WB)	NO.	PATCH	PATCH	AREA	AREA
		(NB/SB)	(1, 2, 3)	WIDTH	LENGTH	(SQ FT)	(SQ YD)
IL. 53	County Farm Road						
Myrtlewood		WB	1	12	6		
Woodlawn		WB	1	12	8	96	11
Woodlawn		WB	2	12	8	96	11
Knollwood		WB	1	12	10	120	13
Knollwood		WB	2	12	10	120	13
Chase St.		WB	2	12	12	144	16
Blanchard St		WB	2	12	15	180	20
Prospect		WB	1 & 2	2	150	300	33
County Farm Road	IL. 53						
Myrtlewood		EB (E.P)	2	2	300	600	67
Sunset		EB	1	12	6	72	8
Sunset		EB	2	12	6	72	8
Main St.		EB	1	12	8	96	11
Main St.		EB	2	12	8	96	11
TOTALS:					547		221
					FT		SY

ROUTE: IL 38 (Harrison St. to Michigan Ave.)							
CROSS STREETS		DIRECTION	LANE	PAVEMENT	PAVEMENT	REPAIR	REPAIR
FROM	TO	(EB/WB) (NB/SB)	NO. (1, 2, 3)	PATCH WIDTH	PATCH LENGTH	AREA (SQ FT)	AREA (SQ YD)
Harrison Street	IL. 56	WB	1	12	6	72	8
		WB	2	12	6	72	8
		WB	1	12	6	72	8
		WB	2	12	6	72	8
		WB	3	12	6	72	8
		WB	1	12	4	48	5
		WB	2	12	4	48	5
		WB	3	12	4	48	5
		WB	3	12	6	72	8
		WB	2 & 3	2	500	1000	111
		WB	2 & 3	2	1000	2000	222
		WB	3	12	6	72	8
		WB	2 & 3	2	500	1000	111
		WB	2 & 3	2	500	1000	111
		WB	2	12	6	72	8
		WB	2 & 3	2	700	1400	156
Harrison Street	IL. 56	WB	3	12	15	180	20
IL. 56	IL. 83	WB	2 & 3	2	200	400	44
		WB	1	12	7	84	9
		WB	2	12	7	84	9
		WB	3	12	7	84	9
IL. 56	IL. 83	WB	2 & 3	2	200	400	44
IL. 83	Michigan	WB	2 & 3	2	25	50	6
		WB	1	12	12	144	16
		WB	2	12	25	300	33
		WB	3	12	7	84	9
		WB	2	12	10	120	13
		WB	3	12	8	96	11
Michigan	Ardmore	WB	1	12	12	144	16
Michigan	IL. 83	EB	2 & 3	2	1000	2000	222
		EB	1 & 2	2	1000	2000	222
		EB	1 & 2	2	1000	2000	222
		EB	2 & 3	2	1000	2000	222
Michigan	IL. 83	EB	1	12	6	72	8
IL. 83	York Rd	EB	2 & 3	2	75	150	17
		EB	2	12	20	240	27
		EB	3	12	12	144	16
		EB	2	12	4	48	5
		EB	1	12	4	48	5
		EB	3	12	4	48	5
		EB	1 & 2	2	80	160	18
		EB	1	12	4	48	5
		EB	3	12	4	48	5
		EB	2 & 3	2	500	1000	111
		EB	2	12	6	72	8
		EB	1	12	4	48	5
		EB	2	12	6	72	8
IL. 83	York Rd.	EB	2	12	65	780	87
TOTALS:						8589	2252
						FT	SY

FILE NAME =	USER NAME = wilgreendp	DESIGNED -	REVISED -	STATE OF ILLINOIS DEPARTMENT OF TRANSPORTATION	PATCHING SCHEDULE IL 38			F.A. RTE.	SECTION	COUNTY	TOTAL SHEETS	SHEET NO.			
at:\pwork\pwork\wilgreendp\2183689\Design.dgn		DRAWN -	REVISED -		SCALE:	SHEET NO.	OF	SHEETS	STA.	TO STA.	VAR.	2010-010 RS	DUPAGE	47	15
		PLOT SCALE = 100.0000' / IN.	CHECKED -		REVISED -							CONTRACT NO. 60K29			
		PLOT DATE = 2/20/2010	DATE -		REVISED -							FED. ROAD DIST. NO. 1 ILLINOIS FED. AID PROJECT			

ROUTE: IL 53 (IL 56 to Wilson Ave.)							
CROSS STREETS		DIRECTION	LANE	PAVEMENT	PAVEMENT	REPAIR	REPAIR
FROM	TO	(EB/WB)	NO.	PATCH	PATCH	AREA	AREA
		(NB/SB)	(1, 2, 3)	WIDTH	LENGTH	(SQ FT)	(SQ YD)
North of IL 56		NB	1	12	12	144	16
Sheehan	250' south	NB	1	2	250	500	56
	N of Sheehan	NB	1	2	150	300	33
S of Abbey	100' South	NB	1	2	100	200	22
		NB	1	2	100	200	22
S of IL 38		SB	1	12	12	144	16
N of Abbey Dr		SB	1	12	20	240	26
		SB	1	12	20	240	26
N of Sheehan		SB	1	12	20	240	26
S of Sheehan		SB	1	12	100	1200	133
S of Sheehan		SB	1	12	300	3600	400
N of 56		SB	1	12	12	144	16
		SB	1	12	12	144	16
		SB	1	12	12	144	16
		SB	1	12	12	144	16
		SB	1	12	12	144	16
		SB	1	12	12	144	16
		SB	1	12	12	144	16
		SB	1	12	12	144	16
		SB	1	12	12	144	16
		SB	1	12	12	144	16
		SB	1	12	12	144	16
		SB	1	12	300	3600	400
TOTALS:						1504	1336
						FT	SY

ROUTE: IL 53 (IL 64 to Sidney Ave.)							
CROSS STREETS		DIRECTION	LANE	PAVEMENT	PAVEMENT	REPAIR	REPAIR
FROM	TO	(EB/WB)	NO.	PATCH	PATCH	AREA	AREA
		(NB/SB)	(1, 2, 3)	WIDTH	LENGTH	(SQ FT)	(SQ YD)
IL Rte 64 (North Ave)	Sidney Ave	NB/SB	1,2	48	1500	72000	8000
TOTALS:						1500	8000
						FT	SY

ROUTE: IL 56 (Camden Ct. to Fairfield Ave.)							
CROSS STREETS		DIRECTION	LANE	PAVEMENT	PAVEMENT	REPAIR	REPAIR
FROM	TO	(EB/WB) (NB/SB)	NO. (1, 2, 3)	PATCH WIDTH	PATCH LENGTH	AREA (SQ FT)	AREA (SQ YD)
Farfield		EB	1,2,3	4	36	144	16
		EB	1,2,3	4	36	144	16
		EB	1,2,3	4	36	144	16
		EB	1,2,3	4	36	144	16
		EB	1,2,3	12	36	432	48
		EB	3	4	12	48	5
		EB	3	4	12	48	5
		EB	3	4	12	48	5
		EB	1,2,3	4	36	144	16
		EB	1,2,3	4	36	144	16
		EB	1,2,3	4	36	144	16
		EB	1,2,3	4	36	144	16
Technology Dr		EB	1,2,3	4	36	144	16
		EB	1,2,3	8	36	288	32
		EB	1,2,3	4	36	144	16
		EB	1,2,3	4	36	144	16
		EB	1,2,3	4	36	144	16
		EB	1,2,3	4	36	144	16
		EB	1,2,3	4	36	144	16
		EB	1,2,3	12	36	432	48
		EB	1,2,3	12	36	432	48
		EB	1,2,3	12	36	432	48
		EB	1,2,3	12	36	432	48
		EB	1,2,3,4	4	48	192	21
Fountain Square		EB	1,2,3,4	4	48	192	21
		EB	1	4	12	48	5
		EB	1,2,3	4	36	144	16
		EB	1,2,3	4	36	144	16
		EB	1,2,3	4	36	144	16
		EB	1,2,3	4	36	144	16
		EB	2,3	4	24	96	11
		EB	1,2,3	4	36	144	16
		EB	1,2,3	4	36	144	16
		EB	1,2,3	4	36	144	16
		EB	1,2,3	4	36	144	16
		EB	1,2,3	12	36	432	48
Meyer Rd		EB	1,2,3	4	36	144	16
		EB	1,2,3	4	36	144	16
		EB	1,2,3	12	36	432	48
		EB	1,2,3	4	36	144	16
		EB	1,2,3	4	36	144	16
		EB	1,2,3	4	36	144	16
		EB	1,2,3	4	36	144	16
		EB	1,2,3	4	36	144	16
		EB	1,2,3	4	36	144	16
		EB	1,2,3	4	36	144	16
		EB	1,2,3	4	36	144	16
		EB	1,2,3	6	36	216	24
Trans Am Plaza		EB	1,2,3	4	36	144	16
		EB	1,2,3	4	36	144	16
		EB	1,2,3	4	36	144	16
		EB	1,2,3	4	36	144	16
		EB	1,2,3	4	36	144	16
		EB	1,2,3	4	36	144	16
		EB	1,2,3	4	36	144	16
		EB	1,2,3	4	36	144	16
		EB	1,2,3	6	36	216	24
		EB	1,2,3	4	36	144	16
		EB	1,2,3	4	36	144	16
		EB	1,2,3	4	36	144	16
Camden		WB	2,3	4	24	96	11
		WB	1,2,3	4	36	144	16
		WB	1,2,3	4	36	144	16
		WB	1,2,3	4	36	144	16
		WB	1,2,3	4	36	144	16

ROUTE: IL 56 (Camden Ct. to Fairfield Ave.)								
CROSS STREETS		DIRECTION	LANE	PAVEMENT	PAVEMENT	REPAIR	REPAIR	
FROM	TO	(EB/WB) (NB/SB)	NO. (1, 2, 3)	PATCH WIDTH	PATCH LENGTH	AREA (SQ FT)	AREA (SQ YD)	
Trans Am Plaza		WB	1,2,3	4	36	144	16	
		WB	1,2,3	4	36	144	16	
		WB	1,2,3	6	36	216	24	
		WB	1,2,3	6	36	216	24	
		WB	1,2,3	4	36	144	16	
		WB	1,2,3	6	36	216	24	
		WB	1,2,3	6	36	216	24	
		WB	1,2,3	6	36	216	24	
		WB	1,2,3	4	36	144	16	
		WB	1,2,3	6	36	216	24	
		WB	1,2,3	4	36	144	16	
		WB	1,2,3	6	36	216	24	
Meyers Rd		WB	1,2,3	4	36	144	16	
		WB	1,2,3	6	36	216	24	
		WB	1,2,3	4	36	144	16	
		WB	1,2,3	4	36	144	16	
		WB	1,2,3	4	36	144	16	
		WB	1,2,3	4	36	144	16	
		WB	1,2,3	4	36	144	16	
		WB	1,2,3	4	36	144	16	
		WB	1,2,3	6	36	216	24	
		WB	1,2,3	4	36	144	16	
		WB	1,2,3	6	36	216	24	
		WB	1,2,3	4	36	144	16	
Fountain Square		WB	1,2,3	4	36	144	16	
		WB	1,2,3	6	36	216	24	
		WB	1,2,3	6	36	216	24	
		WB	1,2,3	4	36	144	16	
		WB	1,2,3	4	36	144	16	
		WB	1,2,3	6	36	216	24	
		WB	1,2,3	4	36	144	16	
		WB	1,2,3	6	36	216	24	
		WB	1,2,3	4	36	144	16	
		WB	1,2,3	6	36	216	24	
		WB	1,2,3	4	36	144	16	
		WB	1,2,3	6	36	216	24	
Technonly Drive		WB	1,2,3	6	36	216	24	
		WB	1,2,3	6	36	216	24	
		WB	1,2,3	4	36	144	16	
		WB	1,2,3	6	36	216	24	
		WB	1,2,3	4	36	144	16	
		WB	1,2,3	6	36	216	24	
		WB	1,2,3	6	36	216	24	
		WB	1,2,3	6	36	216	24	
		WB	1,2,3	4	36	144	16	
		WB	1,2,3	6	36	216	24	
		WB	1,2,3	4	36	144	16	
		WB	1,2,3	6	36	216	24	
Fairfield Ave		WB	1,2,3,4	4	48	192	21	
		WB	1,2,3,4	4	48	192	21	
		Joint		2	160	320	36	
		Joint		2	160	320	36	
		Joint		2	1000	2000	222	
	Fontana Square Drive		Joint		2	240	480	53
			Joint		2	320	640	71
	Maxwell							
	Fairfield(WB)							
	Fairfield (EB)							
			Joint		2	240	480	53
			Joint		2	560	1120	124
Fontana Square Drive		Joint		2	40	80	9	
		Joint		2	200	400	44	
		Joint		2	240	480	53	
Canden		Joint		2	320	640	71	
		TOTALS:				7584	3100	
						FT	SY	

ROUTE: IL 56 EB (Left Turn to Gray Ave.)							
CROSS STREETS		DIRECTION	LANE	PAVEMENT	PAVEMENT	REPAIR	REPAIR
FROM	TO	(EB/WB)	NO.	PATCH	PATCH	AREA	AREA
		(NB/SB)	(1, 2, 3)	WIDTH	LENGTH	(SQ FT)	(SQ YD)
EB Lt Bay to Gray Ave		EB	Left Turn	12	500	6000	667
TOTALS:					500		667
					FT		SY

ROUTE: IL 56 EB (At Bob-O-Link Rd. Left Turn Lane)							
CROSS STREETS		DIRECTION	LANE	PAVEMENT	PAVEMENT	REPAIR	REPAIR
FROM	TO	(EB/WB)	NO.	PATCH	PATCH	AREA	AREA
		(NB/SB)	(1, 2, 3)	WIDTH	LENGTH	(SQ FT)	(SQ YD)
At Bob-O-Link Rd. Turn Lane		EB	Turn Lane	11	20	220	24
		EB	Turn Lane	11	4	44	5
		EB	Turn Lane	11	10	110	12
		EB	Turn Lane	11	10	110	12
		EB	X Over	24	30	720	80
		EB	Turn Lane	4	50	200	22
		EB	Turn Lane	4	75	300	33
TOTALS:					199		189
					FT		SY

ROUTE: IL 56 WB (I-355 to Lloyd Ave.) - Left Turn Bays							
CROSS STREETS		DIRECTION	LANE	PAVEMENT	PAVEMENT	REPAIR	REPAIR
FROM	TO	(EB/WB)	NO.	PATCH	PATCH	AREA	AREA
		(NB/SB)	(1, 2, 3)	WIDTH	LENGTH	(SQ FT)	(SQ YD)
IL 56 WB Left Turn Bays							
I-355	Lloyd Ave.	WB	Left Turn	12	300	3600	400
		WB	Left Turn	12	300	3600	400
TOTALS:					600		800
					FT		SY

ROUTE: IL 56 (IL 83 to Cambridge Ave.)							
CROSS STREETS		DIRECTION	LANE	PAVEMENT	PAVEMENT	REPAIR	REPAIR
FROM	TO	(EB/WB) (NB/SB)	NO. (1, 2, 3)	PATCH WIDTH	PATCH LENGTH	AREA (SQ FT)	AREA (SQ YD)
IL. 83	York Road	EB	1	12	20	240	27
		EB	3 & Ramp	2	150	300	33
		EB	1 & 2	2	200	400	44
		EB	1	12	4	48	5
Start 1 Lane	EB	Joint	2	2	75	150	17
		EB	Joint	2	300	600	67
		EB	EB	6	50	300	33
		EB	EB	4	15	60	7
		EB	EB	4	100	400	44
		EB	EB	2	50	100	11
IL. 83	York Rd.	EB	EB	4	15	60	7
York Rd	Cambridge	NONE					
Cambridge	Saylor	WB	1	12	4	48	5
		WB	2	12	4	48	5
		WB	1	12	20	240	27
Start 1 Lane		WB	Joint	2	50	100	11
		WB	Joint	2	100	200	22
		WB	WB	4	30	120	13
		WB	WB	6	20	120	13
		WB	WB	6	25	150	17
Cambridge	Saylor	WB	WB	4	100	400	44
Start 2 Lanes		WB	1 & 2	4	30	120	13
		WB	2	12	6	72	8
		WB	2	6	30	180	20
		WB	1	12	6	72	8
Saylor	IL. 38	WB	2	12	6	72	8
IL. 38	IL. 83	NONE					
TOTALS:						1410	511
						FT	SY

ROUTE: IL 56 (WB to WB IL 38 Entrance Ramp) - HMA Section							
CROSS STREETS		DIRECTION	LANE	PAVEMENT	PAVEMENT	REPAIR	REPAIR
FROM	TO	(EB/WB) (NB/SB)	NO. (1, 2, 3)	PATCH WIDTH	PATCH LENGTH	AREA (SQ FT)	AREA (SQ YD)
WB IL 56 to WB 38		WB	Ramp	2	200	400	44
WB IL 56 to WB 38		WB	Ramp	2	30	60	7
WB IL 56 to WB 38		WB	Ramp	6	16	96	11
WB IL 56 to WB 38		WB	Ramp	6	16	96	11
WB IL 56 to WB 38		WB	Ramp	10	16	160	18
WB IL 56 to WB 38		WB	Ramp	10	16	160	18
WB IL 56 to WB 38		WB	Ramp	5	16	80	9
WB IL 56 to WB 38		WB	Ramp	6	16	96	11
WB IL 56 to WB 38		WB	Ramp	6	16	96	11
WB IL 56 to WB 38		WB	Ramp	2	460	920	102
TOTALS:						802	240
						FT	SY

ROUTE: IL 56 EB (E/O Briarcliff Rd. to Esplanade Rd.)							
CROSS STREETS		DIRECTION	LANE	PAVEMENT	PAVEMENT	REPAIR	REPAIR
FROM	TO	(EB/WB) (NB/SB)	NO. (1, 2, 3)	PATCH WIDTH	PATCH LENGTH	AREA (SQ FT)	AREA (SQ YD)
Briar Cliff Road	Raider Lane	EB	Joint	2	400	800	89
		EB Turn	Joint	2	250	500	56
		EB	Joint	2	200	400	44
Briar Cliff Road	Raider Lane	EB	Joint	2	200	400	44
Raider Lane	Park Blvd.	EB	1	12	4	48	5
		EB	Joint	2	100	200	22
Raider Lane	Park Blvd	EB	Joint	2	200	400	44
Park Blvd	ILL. 53	EB	Joint	2	75	150	17
		EB	Joint	2	100	200	22
		EB	Joint	2	50	100	11
		EB	Joint	2	100	200	22
Park Blvd.	IL. 53	EB	Joint	2	50	100	11
IL. 53	Gary	NONE					
Gary	Wood Creek	EB	2	12	4	48	5
		EB	3	12	4	48	5
		EB	Rt Turn	12	4	48	5
		EB	2	12	4	48	5
		EB	3	12	4	48	5
		EB	Lt Turn	12	4	48	5
		EB	1	12	6	72	8
		EB	Lt Turn	12	20	240	27
		EB	Lt Turn	12	4	48	5
		EB	1	12	4	48	5
		EB	2	12	4	48	5
		EB	Rt Turn	12	6	72	8
		EB	Lt Turn	12	6	72	8
		EB	1	12	4	48	5
		EB	2	12	4	48	5
		EB	2	12	4	48	5
		EB	3	12	4	48	5
		EB	2	12	4	48	5
		EB	3	12	4	48	5
		EB	Lt Turn	12	6	72	8
		EB	Lt Turn	12	6	72	8
		EB	1	12	6	72	8
		EB	2	12	6	72	8
Gary	Wood Creek	EB	3	12	4	48	5
Wood Creek	Esplanade	EB	2	12	4	48	5
		EB	1	12	10	120	13
Wood Creek	Esplanade Rd	EB	2	12	10	120	13
TOTALS:						1879	588
						FT	SY

ROUTE: IL 56 (West Branch DuPage River to IL 53)								
CROSS STREETS		DIRECTION	LANE	PAVEMENT	PAVEMENT	REPAIR	REPAIR	
FROM	TO	(EB/WB) (NB/SB)	NO. (1, 2, 3)	PATCH WIDTH	PATCH LENGTH	AREA (SQ FT)	AREA (SQ YD)	
Batavia RD								
West Branch of the Dupage River		EB	1	4	12	48	5	
		EB,MED,WB	1	4	36	144	16	
		EB,MED,WB	1	4	36	144	16	
		EB/WB	1	4	24	96	11	
		EB/WB	1	4	24	96	11	
		EB/WB	1	4	24	96	11	
		EB/WB	1	4	24	96	11	
		EB/WB	1	4	24	96	11	
		EB/WB	1	4	24	96	11	
Blackwell Forest Preserve Entrance		EB/WB	1	4	24	96	11	
		EB/WB	1	4	24	96	11	
		EB/WB	1	4	36	144	16	
		EB/WB	1	4	24	96	11	
		EB/WB	1	4	24	96	11	
		EB/WB	1	6	24	144	16	
		EB/WB	1	4	24	96	11	
		EB/WB	1	6	24	144	16	
		EB/WB	1	4	24	96	11	
		EB/WB	1	6	24	144	16	
		EB/WB	1	4	24	96	11	
		EB/WB	1	4	24	96	11	
		EB/WB	1	4	24	96	11	
		EB/WB	1	4	24	96	11	
	Winfield		EB/WB	1	4	36	144	16
		EB/WB	1	10	12	120	13	
		EB/WB	1	4	12	48	5	
Madison St.		WB	1	4	12	48	5	
		EB/WB	1	4	24	96	11	
Herick Rd.		EB/WB	1	6	24	144	16	
		EB/WB	1	6	24	144	16	
		EB/WB	1	4	24	96	11	
		EB/WB	1	4	24	96	11	
		EB/WB	1	4	24	96	11	
		EB/WB	1	4	24	96	11	
		EB/WB	1	4	24	96	11	
		EB/WB	1	4	24	96	11	
		EB/WB	1	4	24	96	11	
		EB/WB	1	4	24	96	11	
		EB/WB	1	4	24	96	11	
		EB/WB	1	4	24	96	11	
		EB/WB	1	4	24	96	11	
		EB/WB	1	4	24	96	11	
		EB/WB	1	4	24	96	11	
	Herick Forest Preserve Entrance		WB/MED	1	4	24	96	11
			WB/MED	1	4	24	96	11
		WB/Med/EB	1	4	36	144	16	
		WB/Med/EB	1	4	36	144	16	
		WB/EB	1	4	24	96	11	
Arrow Head		WB/EB	1	4	24	96	11	
		WB/EB	1	4	24	96	11	
		WB/EB	1	4	24	96	11	
		WB/EB	1	4	24	96	11	
		WB/EB	1	4	24	96	11	
		WB/EB	1	4	24	96	11	
		WB/EB	1	4	24	96	11	
		WB/EB	1	4	24	96	11	
		WB/EB	1	4	24	96	11	
		WB/EB	1	4	24	96	11	
		EB	1	4	500	2000	222	
		EB	1	4	24	96	11	

ROUTE: IL 56 (West Branch DuPage River to IL 53)								
CROSS STREETS		DIRECTION	LANE	PAVEMENT	PAVEMENT	REPAIR	REPAIR	
FROM	TO	(EB/WB) (NB/SB)	NO. (1, 2, 3)	PATCH WIDTH	PATCH LENGTH	AREA (SQ FT)	AREA (SQ YD)	
Weildelin		EB/WB	1	4	24	96	11	
		EB/WB	1	4	24	96	11	
		EB/WB	1	4	24	96	11	
		EB/WB	1	4	24	96	11	
		EB/WB	1	4	24	96	11	
		EB/WB	1	4	24	96	11	
		EB/WB	1	4	24	96	11	
		EB	1	4	1000	4000	444	
		WB	1	4	24	96	11	
		WB	1	4	24	96	11	
		WB	1	4	24	96	11	
	Orchard		WB/MED	1	4	24	96	11
			WB/MED	1	4	24	96	11
			WB/MED	1	4	24	96	11
			WB/MED	1	4	24	96	11
			WB/MED/EB	1	4	36	144	16
		WB/MED/EB	1	4	36	144	16	
		WB	1	4	12	48	5	
		WB	1	4	12	48	5	
		WB/MED	1	4	24	96	11	
		WB/MED	1	4	24	96	11	
		WB	1	12	4	48	5	
		WB/MED/EB	1	4	36	144	16	
		WB/MED/EB	1	4	36	144	16	
		WB	1	4	12	48	5	
		WB	1	4	12	48	5	
		EB/WB	1	4	24	96	11	
		EB/WB	1	4	24	96	11	
Cromwell Dr.			EB/WB	1	4	24	96	11
			EB/WB	1	4	24	96	11
		EB/WB	1	4	24	96	11	
		EB/WB	1	4	24	96	11	
		EB/WB	1	4	24	96	11	
		EB/WB	1	4	24	96	11	
		EB/WB	1	4	24	96	11	
		EB/WB	1	4	36	144	16	
		EB/WB	1	4	36	144	16	
		EB/WB	1	4	36	144	16	
		EB/WB	1	4	36	144	16	
		EB/WB	1	4	36	144	16	
		EB/WB	1	4	36	144	16	
		EB/WB	1	4	36	144	16	
		EB/WB	1	4	36	144	16	
		EB/WB	1	4	24	96	11	
		EB/MED/WB	1	4	36	144	16	
		EB/MED/WB	1	4	36	144	16	
		EB/MED/WB	1	4	36	144	16	
Naperville		EB/MED/WB	1	4	36	144	16	
		EB/MED/WB	1	4	36	144	16	
		EB/MED/WB	1	4	36	144	16	
		EB/MED/WB	1	4	36	144	16	
		EB/MED/WB	1	4	36	144	16	
		EB/MED/WB	1	4	36	144	16	
		EB/MED/WB	1	4	36	144	16	
		EB/MED/WB	1	4	36	144	16	
		EB/MED/WB	1	4	36	144	16	
		EB/MED/WB	1	6	36	216	24	
Leask Lane						0	0	
Bradford Dr						0	0	
Lambert Road						0	0	
Park Blvd						0	0	
ILL 53						0	0	

CONTINUED ON NEXT SHEET

FILE NAME =	USER NAME = wlgreendp	DESIGNED -	REVISED -	STATE OF ILLINOIS DEPARTMENT OF TRANSPORTATION	PATCHING SCHEDULE IL 56				F.A. RTE.	SECTION	COUNTY	TOTAL SHEETS	SHEET NO.
es:\pwork\p1dot\wlgreendp\08183689\08183689.dgn	DRAWN -	REVISED -	REVISED -		SCALE:	SHEET NO.	OF	SHEETS	STA.	TO STA.	ILLINOIS	47	20
	CHECKED -	REVISED -	REVISED -		FED. ROAD DIST. NO. 1	FED. AID PROJECT							
	DATE -	REVISED -	REVISED -		CONTRACT NO. 60K29								

Design.dgn 2/20/2010 2:11:10 PM User=wlgreendp

ROUTE: IL 56 (West Branch DuPage River to IL 53)							
CROSS FROM	STREETS TO	DIRECTION (EB/WB) (NB/SB)	LANE NO. (1, 2, 3)	PAVEMENT		REPAIR	
				PATCH WIDTH	PATCH LENGTH	AREA (SQ FT)	AREA (SQ YD)
IL53 (WB)			Joint	2	120	240	27
			Joint	2	200	400	44
			Joint	2	200	400	44
			Joint	2	120	240	27
			Joint	2	360	720	80
			Joint	2	80	160	18
			Joint	2	80	160	18
			Joint	2	80	160	18
Park			Joint	2	80	160	18
			Joint	2	80	160	18
			Joint	2	80	160	18
			Joint	2	80	160	18
Lambert/Scottdale			Joint	2	80	160	18
			Joint	2	80	160	18
			Joint	2	80	160	18
			Joint	2	120	240	27
			Joint	2	80	160	18
			Joint	2	120	240	27
Bradford Dr.			Joint	2	120	240	27
			Joint	2	200	400	44
			Joint	2	40	80	9
			Joint	2	120	240	27
			Joint	2	120	240	27
Naperville							
Westbrook			Joint	2	120	240	27
Winfield			Joint	2	120	240	27
Batavia							
West of DuPage River							
Naperville			Joint	2	160	320	36
			Joint	2	160	320	36
			Joint	2	160	320	36
East Loop Rd.			Joint	2	160	320	36
Leask Ln.			Joint	2	120	240	27
			Joint	2	120	240	27
			Joint	2	160	320	36
			Joint	2	160	320	36
Bradford Dr.			Joint	2	120	240	27
			Joint	2	160	320	36
			Joint	2	120	240	27
			Joint	2	120	240	27
Lambert/Scottdale			Joint	2	120	240	27
Park Blvd.			Joint	2	320	640	71
			Joint	2	40	80	9
			Joint	2	120	240	27
			Joint	2	120	240	27
IL 53							
			TOTALS:			10248	3393
						FT	SY

FILE NAME =	USER NAME = wilgreendp	DESIGNED -	REVISED -
ct:\pw\work\p\d0183609\Design.dgn		DRAWN -	REVISED -
		CHECKED -	REVISED -
		DATE -	REVISED -

**STATE OF ILLINOIS
DEPARTMENT OF TRANSPORTATION**

PATCHING SCHEDULE IL 56			
SCALE:	SHEET NO.	OF SHEETS	STA. TO STA.

F.A. RTE.	SECTION	COUNTY	TOTAL SHEETS	SHEET NO.
VAR.	2010-010 RS	DUPAGE	47	21
FED. ROAD DIST. NO. 1 (ILLINOIS) FED. AID PROJECT			CONTRACT NO. 60K29	

ROUTE: IL 64 (I-290 WB Ramp to Berteau)									
CROSS STREETS		DIRECTION	LANE	PAVEMENT	PAVEMENT	REPAIR	REPAIR		
FROM	TO	(EB/WB) (NB/SB)	NO. (1, 2, 3)	PATCH WIDTH	PATCH LENGTH	AREA (SQ FT)	AREA (SQ YD)		
Berteau	EB butt joint (IL 64)	EB	2	14	50	700	78		
		EB	2	12	6	72	8		
			2	12	6	72	8		
			2	12	6	72	8		
			2	12	6	72	8		
			2	12	8	96	11		
			2	16	6	96	11		
WB butt joint (IL 64)	Berteau	WB	1,2*	4	50	200	22		
			1	12	6	72	8		
			1	12	6	72	8		
			1	12	6	72	8		
			1	12	6	72	8		
			1	12	6	72	8		
			1	12	6	72	8		
			1	12	60	720	80		
		Berteau	EB butt joint (IL 64)	EB	1	10	60	600	67
					1	12	6	72	8
					1	12	6	72	8
	1,2*			4	40	160	18		
	1			11	10	110	12		
	1			11	10	110	12		
	1			12	12	144	16		
	1	12	6	72	8				
	1	12	6	72	8				
WB butt joint (IL 64)	Berteau	WB	2	12	6	72	8		
			2	12	6	72	8		
			2,3*	4	40	160	18		
			2	12	6	72	8		
			2	12	6	72	8		
			2	12	6	72	8		
			2	12	6	72	8		
			2	12	6	72	8		
			2	12	6	72	8		
			2	12	6	72	8		
			2,3*	6	80	480	53		
			2	12	6	72	8		
			2	12	6	72	8		
			2	12	6	72	8		
			2	12	6	72	8		
			2	12	6	72	8		
			2	12	8	96	11		
			2	12	6	72	8		
			2	12	6	72	8		
		Berteau	EB I290 Ramp	EB	3,rmp*	6	100	600	67
WB butt joint (IL 64)	Berteau	WB	3	12	8	96	11		
			3	12	8	96	11		
			3,rmp*	6	80	480	53		
			3	12	6	72	8		
			3	12	6	72	8		
TOTALS:						906	878		
						FT	SY		

ROUTE: IL 64 (Broadview Ave. to East of I-355)							
CROSS STREETS		DIRECTION	LANE	PAVEMENT	PAVEMENT	REPAIR	REPAIR
FROM	TO	(EB/WB) (NB/SB)	NO. (1, 2, 3)	PATCH WIDTH	PATCH LENGTH	AREA (SQ FT)	AREA (SQ YD)
West of Broadview		WB	3	12	100	1200	133
		WB	1,2,3	36	60	2160	240
East of I-355		WB	1,2,3	36	60	2160	240
		EB	3	12	30	360	40
		EB	2	12	40	480	53
		EB	1,2,3	36	60	2160	240
	At Broadview	EB	1,2,3	36	60	2160	240
	East of IL 53	WB	1,2	24	300	7200	800
	West of IL 53	WB	1,2,3	36	200	7200	800
TOTALS:						910	2786
						FT	SY

ROUTE: IL 83 SB (67th St. to Plainfield Rd.)							
CROSS STREETS		DIRECTION	LANE	PAVEMENT	PAVEMENT	REPAIR	REPAIR
FROM	TO	(EB/WB)	NO.	PATCH	PATCH	AREA	AREA
		(NB/SB)	(1, 2, 3)	WIDTH	LENGTH	(SQ FT)	(SQ YD)
67th		SB	2	12	10	120	13
		SB	1	12	4	48	5
		SB	2	12	4	48	5
		SB	Joint	2	40	80	9
		SB	2	12	6	72	8
		SB	Joint	2	30	60	7
		SB	1	12	5	60	7
		SB	2	12	5	60	7
		SB	Joint	2	40	80	9
		SB	Joint	2	60	120	13
		SB	1	12	6	72	8
		SB	2	12	6	72	8
		SB	2	12	4	48	5
		SB	1	12	3	36	4
		SB	1	12	3	36	4
		SB	2	12	7	84	9
		SB	2	12	3	36	4
	Plainfield Rd	SB	2	12	560	6720	747
TOTALS:						796	872
						FT	SY

ROUTE: IL 83 SB (74th St. to 75th St.)							
CROSS STREETS		DIRECTION	LANE	PAVEMENT	PAVEMENT	REPAIR	REPAIR
FROM	TO	(EB/WB)	NO.	PATCH	PATCH	AREA	AREA
		(NB/SB)	(1, 2, 3)	WIDTH	LENGTH	(SQ FT)	(SQ YD)
74th St	75th St	SB	Joint	2	260	520	58
TOTALS:						260	58
						FT	SY

ROUTE: IL 83 (Hawthorn Ave. to Foster Ave.)							
CROSS STREETS		DIRECTION	LANE	PAVEMENT	PAVEMENT	REPAIR	REPAIR
FROM	TO	(EB/WB)	NO.	PATCH	PATCH	AREA	AREA
		(NB/SB)	(1, 2, 3)	WIDTH	LENGTH	(SQ FT)	(SQ YD)
Hawthorne		SB	2	12	4	48	5
		SB	3	12	4	48	5
		SB	2	12	4	48	5
		SB	3	12	4	48	5
		SB	1	12	4	48	5
		SB	2	12	4	48	5
		SB	2	12	4	48	5
		SB	3	12	12	144	16
		SB	1	12	4	48	5
		SB	2	12	4	48	5
		SB	3	12	8	96	11
		SB	2	12	4	48	5
		SB	3	12	4	48	5
		SB	2	12	4	48	5
		SB	3	12	4	48	5
		SB	1	12	4	48	5
		SB	2	12	10	120	13
		SB	3	12	12	144	16
		SB	1	12	4	48	5
	Foster	SB	Lt Turn Ln	12	4	48	5
TOTALS:					106		141
					FT		SY

ROUTE: IL 83 (At IL 38 Exit Ramps)							
CROSS STREETS		DIRECTION	LANE	PAVEMENT	PAVEMENT	REPAIR	REPAIR
FROM	TO	(EB/WB)	NO.	PATCH	PATCH	AREA	AREA
		(NB/SB)	(1, 2, 3)	WIDTH	LENGTH	(SQ FT)	(SQ YD)
SB IL 83 to WB IL 38 ramp		SB	Ramp	26	45	1170	130
SB IL 83 to WB IL 38 ramp		SB	Ramp	3	16	48	5
SB IL 83 to WB IL 38 ramp		SB	Ramp	2	450	900	100
NB IL 83 to WB IL 38 ramp		NB	Ramp	2	50	100	11
NB IL 83 to WB IL 38 ramp		NB	Ramp	16	55	880	98
NB IL 83 to WB IL 38 ramp		NB	Ramp	10	16	160	18
NB IL 83 to WB IL 38 ramp		NB	Ramp	2	120	240	27
NB IL 83 to WB IL 38 ramp		NB	Ramp	10	15	150	17
TOTALS:					767		405
					FT		SY

ROUTE: IL 83 NB (South of Plainfield Rd. to 69th St.)							
CROSS STREETS		DIRECTION	LANE	PAVEMENT	PAVEMENT	REPAIR	REPAIR
FROM	TO	(EB/WB)	NO.	PATCH	PATCH	AREA	AREA
		(NB/SB)	(1, 2, 3)	WIDTH	LENGTH	(SQ FT)	(SQ YD)
Plainfield Rd		NB	1	12	3	36	4
		NB	2	12	3	36	4
		NB	1	12	3	36	4
		NB	2	12	3	36	4
		NB	Joint	2	40	80	9
		NB	1	12	3	36	4
		NB	2	12	3	36	4
		NB	1	12	3	36	4
		NB	2	12	6	72	8
		NB	1	12	3	36	4
		NB	2	12	3	36	4
		NB	2	12	120	1440	160
		NB	1	12	3	36	4
		NB	2	12	8	96	11
		NB	1	12	50	600	67
		NB	2	12	10	120	13
		NB	Joint	2	80	160	18
		NB	Joint	2	60	120	13
		NB	1	12	3	36	4
		NB	1	12	3	36	4
	69th St	NB	Joint	2	40	80	9
		TOTALS:				450	356
						FT	SY

ROUTE: IL 83 NB (Bluff Rd. to Nielson Rd.)							
CROSS STREETS		DIRECTION	LANE	PAVEMENT	PAVEMENT	REPAIR	REPAIR
FROM	TO	(EB/WB)	NO.	PATCH	PATCH	AREA	AREA
		(NB/SB)	(1, 2, 3)	WIDTH	LENGTH	(SQ FT)	(SQ YD)
Bluff Road	Nielson Road	NB	1	12	6	72	8
		NB	2	12	6	72	8
		NB	2	12	6	72	8
		NB	LL	2	200	400	44
		NB	2	12	30	360	40
		NB	1	12	6	72	8
		NB	2	12	6	72	8
		NB	1	12	6	72	8
		NB	2	12	6	72	8
		NB	2	12	6	72	8
		NB	1	12	6	72	8
		NB	LL	3	75	225	25
		NB	2	12	120	1440	160
		NB	1	12	6	72	8
		NB	LL	2	50	100	11
		NB	LL	2	150	300	33
		NB	2	3	250	750	83
		NB	LL	2	300	600	67
		NB	1	6	12	72	8
		TOTALS:				1247	551
						FT	SY

ROUTE: IL 83 NB (Cascade Circle to Timberlake Dr.)							
CROSS STREETS	DIRECTION	LANE	PAVEMENT	PAVEMENT	REPAIR	REPAIR	
FROM TO	(EB/WB)	NO.	PATCH	PATCH	AREA	AREA	
	(NB/SB)	(1, 2, 3)	WIDTH	LENGTH	(SQ FT)	(SQ YD)	
Cascade Circle	NB	LL	2	1000	2000	222	
	NB	2	12	70	840	93	
	NB	1	12	6	72	8	
	NB	2	12	6	72	8	
	NB	1	12	6	72	8	
	NB	2	12	6	72	8	
	NB	2	12	6	72	8	
	NB	1	12	6	72	8	
	NB	LL	2	200	400	44	
	NB	1	12	12	144	16	
	NB	2	12	12	144	16	
	NB	1	12	6	72	8	
	NB	2	12	6	72	8	
	NB	LL	2	40	80	9	
	NB	1	12	6	72	8	
	NB	2	12	6	72	8	
	NB	2	12	6	72	8	
	NB	LL	2	100	200	22	
	NB	2	12	6	72	8	
	NB	2	12	6	72	8	
	NB	1	12	10	120	13	
	NB	2	12	10	120	13	
TOTALS:					1532	552	
					FT	SY	

FILE NAME =	USER NAME = wilgreendp	DESIGNED -	REVISED -	STATE OF ILLINOIS DEPARTMENT OF TRANSPORTATION	PATCHING SCHEDULE IL 83			F.A. RTE.	SECTION	COUNTY	TOTAL SHEETS	SHEET NO.
ct:\pwork\pwork\wilgreendp\d0183689\Design.dgn	DRAWN -	REVISED -	VAR.					2010-010 RS	DUPAGE	47	27	
PLOT SCALE = 100.0000' / IN.	CHECKED -	REVISED -	SCALE: SHEET NO. OF SHEETS STA. TO STA.			FED. ROAD DIST. NO. 1 ILLINOIS FED. AID PROJECT						
PLOT DATE = 2/20/2010	DATE -	REVISED -				CONTRACT NO. 60K29						

ROUTE: IL 83 (Devon Ave. and Tower Ln.)									
CROSS STREETS		DIRECTION	LANE	PAVEMENT	PAVEMENT	REPAIR	REPAIR		
FROM	TO	(EB/WB)	NO.	PATCH	PATCH	AREA	AREA		
		(NB/SB)	(1, 2, 3)	WIDTH	LENGTH	(SQ FT)	(SQ YD)		
Devon Ave	Indian Hill	SB	1	12	4	48	5		
		SB	1	12	4	48	5		
		SB	1	12	4	48	5		
		SB	2	12	4	48	5		
		SB	3	12	4	48	5		
		SB	1	12	12	144	16		
		SB	2	12	4	48	5		
		SB	3	12	4	48	5		
		SB	1	12	4	48	5		
		SB	2	12	4	48	5		
		SB	3	12	4	48	5		
		SB	1	12	10	120	13		
		SB	2	12	10	120	13		
		SB	3	12	10	120	13		
		SB	1	12	7	84	9		
		SB	2	12	6	72	8		
		SB	3	12	5	60	7		
		Indian Hill	Mark St.	SB	1	12	4	48	5
				SB	2	12	4	48	5
				SB	3	12	4	48	5
SB	3			12	4	48	5		
SB	1			12	4	48	5		
SB	2			12	4	48	5		
SB	3			12	4	48	5		
SB	1			12	10	120	13		
SB	2			12	10	120	13		
SB	3			12	10	120	13		
SB	1			12	10	120	13		
SB	2			12	10	120	13		
SB	3			12	10	120	13		
SB	3			12	5	60	7		
SB	1			12	20	240	27		
SB	2			12	20	240	27		
SB	3			12	20	240	27		
SB	3			12	160	1920	213		
SB	1			12	14	168	19		
SB	3			12	5	60	7		
SB	2			12	4	48	5		
SB	1			12	5	60	7		
SB	2			12	4	48	5		
SB	Lt Turn Ln			6	4	24	3		
SB	1			12	4	48	5		
SB	2			12	7	84	9		
SB	2			12	4	48	5		
SB	Lt Turn Ln	10	4	40	4				
SB	3	12	4	48	5				
SB	3	12	160	1920	213				
SB	Lt Turn Ln	10	6	60	7				
SB	1	12	4	48	5				
SB	2	12	4	48	5				
SB	1	12	4	48	5				
SB	2	12	4	48	5				
SB	Lt Turn Ln	10	4	40	4				
SB	1	12	4	48	5				
SB	2	12	25	300	33				
SB	1	12	4	48	5				
SB	2	12	10	120	13				
SB	1	12	4	48	5				
SB	2	12	4	48	5				

ROUTE: IL 83 (Devon Ave. and Tower Ln.)							
CROSS STREETS		DIRECTION	LANE	PAVEMENT	PAVEMENT	REPAIR	REPAIR
FROM	TO	(EB/WB)	NO.	PATCH	PATCH	AREA	AREA
		(NB/SB)	(1, 2, 3)	WIDTH	LENGTH	(SQ FT)	(SQ YD)
Mark St.	Tower Ln.	SB	1	12	4	48	5
		SB	1	12	4	48	5
		SB	2	12	4	48	5
Mark St.	Tower Ln.	SB	3	12	4	48	5
		SB	3	12	4	48	5
		SB	1	12	4	48	5
		SB	2	12	4	48	5
		SB	3	12	4	48	5
		SB	3	12	4	48	5
		SB	2	12	10	120	13
		SB	3	12	10	120	13
		SB	1	12	4	48	5
		SB	2	12	4	48	5
		SB	3	12	4	48	5
		SB	1	12	10	120	13
		SB	1	12	10	120	13
		SB	1	12	4	48	5
		SB	1	12	4	48	5
		SB	1	12	5	60	7
		SB	2 / 3	2	60	120	13
		SB	2	12	4	48	5
		SB	3	12	4	48	5
		SB	3	12	4	48	5
SB	2	12	4	48	5		
SB	3	12	4	48	5		
SB	1	12	4	48	5		
SB	2	12	4	48	5		
SB	3	12	14	168	19		
SB	2	12	4	48	5		
SB	3	12	4	48	5		
SB	1	12	4	48	5		
SB	2	12	4	48	5		
SB	3	12	4	48	5		
SB	3	12	4	48	5		
SB	1	12	4	48	5		
SB	2	12	4	48	5		
SB	3	12	5	60	7		
SB	3	12	4	48	5		
SB	1	12	4	48	5		
SB	2	12	4	48	5		
SB	3	12	4	48	5		
SB	3	12	4	48	5		
SB	3	12	4	48	5		
SB	3	12	5	60	7		
SB	3	12	7	84	9		
SB	3	6	6	36	4		
SB	2	12	4	48	5		
SB	1	12	4	48	5		
SB	2	12	4	48	5		
SB	3	10	10	100	11		
SB	2	12	4	48	5		
SB	3	12	8	96	11		
SB	1	10	4	40	4		
SB	2	12	4	48	5		
SB	3	12	6	72	8		
SB	2	12	6	72	8		
SB	3	12	8	96	11		
SB	1	10	4	40	4		
SB	2	12	10	120	13		
SB	3	12	10	120	13		
Tower Ln.		SB	1	12	4	48	5
		SB	2	12	4	48	5
		SB	3	12	4	48	5

CONTINUED ON NEXT SHEET

FILE NAME =	USER NAME = wilgreendp	DESIGNED -	REVISED -	<p align="center">STATE OF ILLINOIS DEPARTMENT OF TRANSPORTATION</p>	<p align="center">PATCHING SCHEDULE IL 83</p>	F.A. RTE.	SECTION	COUNTY	TOTAL SHEETS	SHEET NO.
et\p\work\p\widot\wilgreendp\d0183689\Design.dgn	DRAWN -	REVISED -	VAR.			2010-010 RS	DUPAGE	47	28	
PLOT SCALE = 100.0000' / IN.	CHECKED -	REVISED -	CONTRACT NO. 60K29							
PLOT DATE = 2/28/2010	DATE -	REVISED -	FED. ROAD DIST. NO. 1 ILLINOIS FED. AID PROJECT							
				SCALE:	SHEET NO. OF SHEETS STA. TO STA.					

ROUTE: IL 83 (Devon Ave. and Tower Ln.)							
CROSS STREETS		DIRECTION	LANE	PAVEMENT	PAVEMENT	REPAIR	REPAIR
FROM	TO	(EB/WB)	NO.	PATCH	PATCH	AREA	AREA
		(NB/SB)	(1, 2, 3)	WIDTH	LENGTH	(SQ FT)	(SQ YD)
	Tower Intersection	SB	3	12	50	600	67
	Tower Intersection	SB	2	12	4	48	5
Tower Lane	Mark St.	NB	1	12	4	48	5
		NB	2	12	4	48	5
		NB	3	12	12	144	16
		NB	1	12	4	48	5
		NB	1	12	4	48	5
		NB	2	12	4	48	5
		NB	3	12	4	48	5
		NB	3	12	4	48	5
		NB	1	12	4	48	5
		NB	2	12	4	48	5
		NB	3	12	4	48	5
		NB	3	12	4	48	5
		NB	3	12	4	48	5
		NB	2	12	4	48	5
		NB	3	12	4	48	5
		NB	3	12	4	48	5
		NB	2	12	4	48	5
		NB	3	12	4	48	5
		NB	1	12	4	48	5
		NB	3	12	4	48	5
		NB	2	12	4	48	5
		NB	1	12	4	48	5
		NB	2	12	4	48	5
		NB	3	12	4	48	5
		NB	1	12	4	48	5
		NB	2	12	4	48	5
		NB	3	12	4	48	5
		NB	1	12	4	48	5
		NB	2	12	4	48	5
		NB	3	12	4	48	5
		NB	3	12	10	120	13
		NB	2	12	4	48	5
		NB	3	12	4	48	5
		NB	2	12	4	48	5
		NB	3	12	4	48	5
		NB	2	12	4	48	5
		NB	3	12	4	48	5
		NB	2	12	4	48	5
		NB	3	12	4	48	5
		NB	2	12	4	48	5

ROUTE: IL 83 (Devon Ave. and Tower Ln.)							
CROSS STREETS		DIRECTION	LANE	PAVEMENT	PAVEMENT	REPAIR	REPAIR
FROM	TO	(EB/WB)	NO.	PATCH	PATCH	AREA	AREA
		(NB/SB)	(1, 2, 3)	WIDTH	LENGTH	(SQ FT)	(SQ YD)
		NB	3	12	7	84	9
		NB	2	12	4	48	5
		NB	3	12	4	48	5
		NB	2	12	4	48	5
		NB	3	12	4	48	5
		NB	2	12	4	48	5
		NB	3	12	4	48	5
		NB	3	12	4	48	5
		NB	2	12	4	48	5
		NB	3	12	4	48	5
		NB	3	12	4	48	5
		NB	2	12	4	48	5
		NB	3	12	4	48	5
		NB	2	12	4	48	5
		NB	3	12	4	48	5
		NB	1	12	4	48	5
		NB	2	12	4	48	5
		NB	3	12	4	48	5
		NB	2	12	4	48	5
		NB	3	12	40	480	53
		NB	2	12	50	600	67
Tower Lane		NB	2 / 3	2	100	200	22
		NB	3	12	4	48	5
		NB	1	12	4	48	5
		NB	2	12	8	96	11
		NB	1	12	4	48	5
		NB	2	12	10	120	13
		NB	3	12	12	144	16
		NB	1	12	7	84	9
		NB	2	12	10	120	13
		NB	2	12	4	48	5
	Mark St.	NB	3	12	4	48	5
		TOTALS:				1673	2039
						FT	SY

ROUTE: IL 83 (Hillside Dr. to Fay Ave.)							
CROSS STREETS		DIRECTION	LANE	PAVEMENT	PAVEMENT	REPAIR	REPAIR
FROM	TO	(EB/WB)	NO.	PATCH	PATCH	AREA	AREA
		(NB/SB)	(1, 2, 3)	WIDTH	LENGTH	(SQ FT)	(SQ YD)
		SB	1	12	4	48	5
		SB	2	12	6	72	8
		SB	3	12	6	72	8
		SB	3	12	4	48	5
		SB	2	12	4	48	5
		SB	3	12	4	48	5
		SB	1	12	4	48	5
		SB	2	12	4	48	5
		SB	3	12	4	48	5
		SB	1	12	4	48	5
		SB	2	12	4	48	5
		SB	3	12	12	144	16
		SB	1	12	4	48	5
		SB	1	12	4	48	5
		SB	2	12	4	48	5
		SB	3	12	6	72	8
		SB	1/2	2	15	30	3
Royal Oaks Drive	Deer Path Rd.	SB	3	12	4	48	5
		SB	1/2	2	25	50	6
		SB	3	12	4	48	5
		SB	1	12	4	48	5
		SB	2	12	4	48	5
		SB	3	12	4	48	5
		SB	3	12	4	48	5
		SB	1/2	2	20	40	4
		SB	1	12	4	48	5
		SB	2	12	4	48	5
		SB	3	12	4	48	5
		SB	3	12	12	144	16
		SB	2	12	9	108	12
		SB	2	12	5	60	7
		SB	3	12	5	60	7
		SB	1	12	4	48	5
		SB	2	12	4	48	5
		SB	3	12	4	48	5
		SB	2	12	4	48	5
		SB	3	12	12	144	16
		SB	2	12	4	48	5
		SB	3	12	5	60	7
		SB	1	12	4	48	5
		SB	2	12	4	48	5
		SB	3	12	4	48	5
		SB	3	12	5	60	7
		SB	1	12	4	48	5
		SB	2	12	4	48	5
		SB	3	12	4	48	5
		SB	3	12	5	60	7
		SB	1/2	2	200	400	44
		SB	1	12	4	48	5
		SB	2	12	4	48	5
		SB	3	12	4	48	5
		SB	2	12	4	48	5
		SB	3	12	12	144	16
		SB	1	12	4	48	5
		SB	1	12	4	48	5
		SB	2	2	4	8	1
		SB	3	12	4	48	5
		SB	1	12	4	48	5
		SB	3	12	4	48	5
		SB	1	12	4	48	5
Royal Oaks Drive	Deer Path Rd.	SB	2	12	4	48	5
		SB	3	12	4	48	5
		SB	3	12	4	48	5
		SB	2	12	4	48	5
		SB	3	12	4	48	5
		SB	1/2	2	10	20	2

ROUTE: IL 83 (Hillside Dr. to Fay Ave.)							
CROSS STREETS		DIRECTION	LANE	PAVEMENT	PAVEMENT	REPAIR	REPAIR
FROM	TO	(EB/WB)	NO.	PATCH	PATCH	AREA	AREA
		(NB/SB)	(1, 2, 3)	WIDTH	LENGTH	(SQ FT)	(SQ YD)
		SB	2	12	4	48	5
		SB	3	12	4	48	5
		SB	1	12	4	48	5
		SB	2	12	4	48	5
		SB	2	12	4	48	5
		SB	2	12	4	48	5
		SB	2	12	4	48	5
		SB	1	12	4	48	5
		SB	2	12	4	48	5
		SB	1	12	4	48	5
		SB	2	12	4	48	5
		SB	1	12	4	48	5
		SB	2	12	4	48	5
		SB	1	12	4	48	5
		SB	2	12	4	48	5
		SB	1	12	4	48	5
		SB	2	12	4	48	5
		SB	1	12	4	48	5
		SB	2	12	4	48	5
		SB	1	12	4	48	5
		SB	1/2	2	250	500	56
		SB	1	12	4	48	5
		SB	2	12	4	48	5
		SB	1	12	4	48	5
		SB	2	12	4	48	5
		SB	1	12	4	48	5
		SB	2	12	4	48	5
		SB	1	12	4	48	5
		SB	2	12	4	48	5
		SB	3	12	12	144	16
		SB	1	12	4	48	5
		SB	3	12	12	144	16
		SB	2	12	4	48	5
		SB	2	12	4	48	5
		SB	3	12	4	48	5
		SB	2	12	4	48	5
		SB	3	12	4	48	5
		SB	1	12	4	48	5
		SB	2	12	4	48	5
		SB	3	12	4	48	5
		SB	1	12	5	60	7
		SB	3	12	4	48	5
		SB	1/2	2	100	200	22
		SB	2	12	4	48	5
		SB	3	12	4	48	5
		SB	3	12	4	48	5
		SB	3	12	4	48	5
		SB	2	12	4	48	5
		SB	3	12	4	48	5
		SB	1	12	4	48	5
		SB	2	12	4	48	5
		SB	3	12	4	48	5
		SB	1	12	4	48	5
		SB	2	12	4	48	5
		SB	3	12	4	48	5
		SB	1	12	4	48	5
		SB	2	12	4	48	5
		SB	3	12	4	48	5
		SB	1	12	4	48	5
		SB	2	12	4	48	5
		SB	3	12	4	48	5
		SB	1	12	4	48	5
		SB	2	12	4	48	5
		SB	3	12	4	48	5
		SB	1	12	4	48	5
		SB	2	12	4	48	5
		SB	3	12	4	48	5
		SB	1	12	4	48	5
		SB	2	12	4	48	5
		SB	3	12	4	48	5
		SB	1	12	4	48	5
		SB	2	12	4	48	5
		SB	3	12	4	48	5
		SB	1	12	4	48	5
		SB	2	12	4	48	5
		SB	3	12	4	48	5
		SB	1	12	4	48	5
		SB	2	12	4	48	5
		SB	3	12	4	48	5
		SB	1	12	4	48	5
		SB	2	12	4	48	5
		SB	3	12	4	48	5
		SB	1	12	4	48	5
		SB	2	12	4	48	5
		SB	3	12	4	48	5
		SB	1	12	4	48	5
		SB	2	12	4	48	5
		SB	3	12	4	48	5
		SB	1	12	4	48	5
		SB	2	12	4	48	5
		SB	3	12	4	48	5
		SB	1	12	4	48	5
		SB	2	12	4	48	5
		SB	3	12	4	48	5
		SB	1	12	4	48	5
		SB	2	12	4	48	5
		SB	3	12	4	48	5
		SB	1	12	4	48	5
		SB	2	12	4	48	5
		SB	3	12	4	48	5
		SB	1	12	4	48	5
		SB	2	12	4	48	5
		SB	3	12	4	48	5
		SB	1	12	4	48	5
		SB	2	12	4	48	5
		SB	3	12	4	48	5
		SB	1	12	4	48	5
		SB	2	12	4	48	5
		SB	3	12	4	48	5
		SB	1	12	4	48	5
		SB	2	12	4	48	5
		SB	3	12	4	48	5
		SB	1	12	4	48	5
		SB	2	12	4	48	5
		SB	3	12	4	48	5
		SB	1	12	4	48	5
		SB	2	12	4	48	5
		SB	3	12	4	48	5
		SB	1	12	4	48	5
		SB	2	12	4	48	5
		SB	3	12	4	48	5
		SB	1	12	4	48	5
		SB	2	12	4	48	5
		SB	3	12	4	48	5
		SB	1	12	4	48	5
		SB	2	12	4	48	5
		SB	3	12	4	48	5
		SB	1	12	4	48	5
		SB	2	12	4	48	5
		SB	3	12	4	48	5
		SB	1	12	4	48	5
		SB	2	12	4	48	5
		SB	3	12	4	48	5
		SB	1	12	4	48	5
		SB	2	12	4	48	5
		SB	3	12	4	48	5
		SB	1	12	4	48	5
		SB	2	12	4	48	5
		SB	3	12	4	48	5
		SB	1	12	4	48	5
		SB	2	12	4	48	5
		SB	3	12	4	48	5
		SB	1	12	4	48	5
		SB	2	12	4	48	5
		SB	3	12	4	48	5
		SB	1	12	4	48	5
		SB	2	12	4	48	5
		SB	3	12	4	48	5
		SB	1	12	4	48	5
		SB	2	12	4	48	5
		SB	3	12	4	48	5
		SB	1	12	4	48	5
		SB	2	12	4	48	5
		SB	3	12	4	48	5
		SB	1	12	4	48	5
		SB	2	12	4	48	5
		SB	3	12	4	48	5
		SB	1	12	4	48	5
		SB	2	12	4	48	5
		SB	3	12	4	48	5
		SB	1	12	4	48	5
		SB	2	12	4	48	5
		SB	3	12	4	48	5
		SB	1	12	4	48	5
		SB	2				

ROUTE: IL 83 (Hillside Dr. to Fay Ave.)							
CROSS STREETS		DIRECTION	LANE	PAVEMENT	PAVEMENT	REPAIR	REPAIR
FROM	TO	(EB/WB) (NB/SB)	NO. (1, 2, 3)	PATCH WIDTH	PATCH LENGTH	AREA (SQ FT)	AREA (SQ YD)
		SB	3	12	4	48	5
		SB	2	12	4	48	5
		SB	3	12	4	48	5
		SB	2	12	4	48	5
		SB	3	12	4	48	5
		SB	2	12	4	48	5
		SB	3	12	4	48	5
		SB	1	12	4	48	5
		SB	2	12	4	48	5
		SB	3	12	6	72	8
		SB	3	12	4	48	5
		SB	Lt. Tum	12	4	48	5
		SB	2	12	4	48	5
Oak Meadows	Frontage Road	SB	1/2	2	220	440	49
		SB	1	12	4	48	5
		SB	2	12	4	48	5
		SB	1	12	4	48	5
		SB	2	12	4	48	5
		SB	1	12	4	48	5
		SB	1	12	4	48	5
		SB	1/2	2	30	60	7
		SB	1	12	4	48	5
		SB	1	12	4	48	5
		SB	1	12	4	48	5
		SB	2	12	4	48	5
		SB	1	12	4	48	5
		SB	2	12	4	48	5
		SB	1	12	4	48	5
		SB	3	12	6	72	8
		SB	1	12	4	48	5
		SB	1/2	2	500	1000	111
		SB	1	12	4	48	5
		SB	1	12	4	48	5
		SB	1	12	4	48	5
		SB	1	12	4	48	5
		SB	2/3	2	100	200	22
		SB	Lt. Tum	12	4	48	5
		SB	1	12	4	48	5
		SB	2/3	2	50	100	11
		SB	Lt. Tum	12	15	180	20
		SB	2	12	4	48	5
		SB	1	12	4	48	5
		SB	1	12	4	48	5
		SB	1	12	5	60	7
		SB	1	12	5	60	7
Frontage Road	290 Overpass	SB	1	12	4	48	5
		SB	1	12	4	48	5
		SB	1	12	4	48	5
		SB	1	12	4	48	5
		SB	1	12	4	48	5
		SB	1	12	4	48	5
		SB	1	12	4	48	5
		SB	1	12	4	48	5
		SB	1	12	4	48	5
		SB	1	12	4	48	5
		SB	1	12	4	48	5
		SB	1	12	4	48	5
		SB	1	12	4	48	5
		SB	1	12	4	48	5
		SB	1	12	4	48	5
		SB	1	12	4	48	5
		SB	1	12	4	48	5
		SB	1	12	4	48	5
		SB	1	12	4	48	5
		SB	1	12	4	48	5
		SB	1	12	4	48	5
		SB	1	12	4	48	5
Frontage Road	290 Overpass	SB	2	12	12	144	16
		SB	2	12	6	72	8
		SB	3	12	4	48	5
		SB	2/3	2	100	200	22
		SB	1	12	4	48	5
		SB	2	12	4	48	5
		SB	1	12	4	48	5
		SB	1	12	4	48	5

ROUTE: IL 83 (Hillside Dr. to Fay Ave.)							
CROSS STREETS		DIRECTION	LANE	PAVEMENT	PAVEMENT	REPAIR	REPAIR
FROM	TO	(EB/WB) (NB/SB)	NO. (1, 2, 3)	PATCH WIDTH	PATCH LENGTH	AREA (SQ FT)	AREA (SQ YD)
		SB	1	12	4	48	5
		SB	1	12	4	48	5
		SB	1	12	4	48	5
		SB	1	12	4	48	5
		SB	1	12	4	48	5
		SB	1	12	4	48	5
		SB	1/2	2	35	70	8
		SB	1	12	4	48	5
		SB	1	12	10	120	13
		SB	2	12	4	48	5
		SB	1	12	9	108	12
		SB	1	12	9	108	12
		SB	2	12	7	84	9
		SB	2	12	4	48	5
		SB	3	12	7	84	9
		SB	1	12	6	72	8
		SB	Merge Ln	12	5	60	7
		SB	1/2	2	30	60	7
		SB	2	12	20	240	27
		SB	1	12	4	48	5
		SB	1	12	25	300	33
		SB	2	12	12	144	16
		SB	1	12	12	144	16
		SB	2	12	12	144	16
		SB	1/2	2	30	60	7
		SB	2	12	20	240	27
		SB	1	12	10	120	13
		SB	2	12	10	120	13
		SB	1	12	5	60	7
		SB	2/Shld	2	100	200	22
		SB	1	12	4	48	5
		SB	2	12	4	48	5
		SB	1	12	4	48	5
		SB	2	12	4	48	5
		SB	2	12	4	48	5
		SB	1/2	2	50	100	11
		SB	1/Shld	2	200	400	44
		SB	2	12	30	360	40
290 Overpass	Sunrise	SB	1/2	2	50	100	11
		SB	2	12	4	48	5
		SB	1/Shld	2	150	300	33
		SB	2	12	12	144	16
		SB	1/2	2	50	100	11
		SB	1	12	30	360	40
		SB	2	12	25	300	33
		SB	2	12	4	48	5
		SB	1/Shld	2	150	300	33
Sunrise	Fay	SB	2/Shld	2	200	400	44
		SB	2/3	2	50	100	11
		SB	2	12	4	48	5
		SB	3	12	6	72	8
		SB	3	12	6	72	8
		SB	3	12	6	72	8
		SB	1	12	6	72	8
		SB	2	12	6	72	8
		SB	3	12	6	72	8
Fay	290 Overpass	NB	1	12	6	72	8
		NB	2	12	6	72	8
		NB	3	12	6	72	8
		NB	2/3	2	50	100	11
		NB	1	12	4	48	5
		NB	1	12	4	48	5
		NB	1	12	4	48	5
		NB	1	12	4	48	5
		NB	1	12	4	48	5
		NB	3/Shld	2	75	150	17
		NB	2/Shld	2	100	200	22

CONTINUED ON NEXT SHEET

FILE NAME =
c:\pwwork\pwwork\wilg-eendp\d0183689\Design.dgn

USER NAME = wilg-eendp
DESIGNED -
DRAWN -
PLOT SCALE = 100.0000 * / IN.
CHECKED -
PLOT DATE = 2/20/2010

REVISOR -
REVISED -
REVISED -
REVISED -
REVISED -

STATE OF ILLINOIS
DEPARTMENT OF TRANSPORTATION

PATCHING SCHEDULE
IL 83

SCALE: SHEET NO. OF SHEETS STA. TO STA.

F.A. RTE.	SECTION	COUNTY	TOTAL SHEETS	SHEET NO.
VAR.	2010-010 RS	DUPAGE	47	32
CONTRACT NO. 60K29				FED. ROAD DIST. NO. 1 ILLINOIS FED. AID PROJECT

ROUTE: US 20 (W. Branch DuPage River to Gary Ave.)							
CROSS STREETS		DIRECTION	LANE	PAVEMENT	PAVEMENT	REPAIR	REPAIR
FROM	TO	(EB/WB)	NO.	PATCH	PATCH	AREA	AREA
		(NB/SB)	(1, 2, 3)	WIDTH	LENGTH	(SQ FT)	(SQ YD)
Gary Ave.	Thorn Rd.	WB	1	12	6	72	8
Thorn Rd.	Cloverdale Rd.	WB	1	12	10	120	13
		WB	1	12	10	120	13
		WB	1	12	10	120	13
		WB	1	3	100	300	33
		WB	1	12	6	72	8
		WB	1	12	6	72	8
		WB	1	12	6	72	8
Cloverdale Rd.	Bartels Rd.	WB	1	12	6	72	8
		WB	1	12	6	72	8
		WB	1	12	6	72	8
		WB	1	12	6	72	8
		WB	1	12	30	360	40
		WB	1	12	6	72	8
		WB	2	12	6	72	8
		WB	1	12	6	72	8
		WB	1	12	40	480	53
Bartels Rd.	DuPage River	WB	1	12	6	72	8
		WB	1	12	6	72	8
		WB	1	12	6	72	8
		WB	1	3	150	450	50
		WB	1	12	15	180	20
		WB	1	12	6	72	8
		WB	1	12	6	72	8
		WB	1	12	15	180	20
		WB	2	12	15	180	20
		EB/WB	CL	12	15	180	20
DuPage River	Arlington Rd.	EB	1	12	15	180	20
		EB	2	12	15	180	20
		EB	1	12	20	240	27
		EB	1	3	30	90	10
		EB	1	12	50	600	67
		EB	1	12	6	72	8
		EB	1	12	20	240	27
		EB	2	12	30	360	40
		EB	2	12	30	360	40
		EB	2	12	50	600	67
		EB	2	3	50	150	17
		EB	2	3	200	600	67
		EB	2	12	6	72	8
		EB	2	3	200	600	67
		EB	2	12	20	240	27
TOTALS:						1242	926
						FT	SY

ROUTE: US 20 (End of I-290 Exit Ramp to Walnut St.)							
CROSS STREETS		DIRECTION	LANE	PAVEMENT	PAVEMENT	REPAIR	REPAIR
FROM	TO	(EB/WB)	NO.	PATCH	PATCH	AREA	AREA
		(NB/SB)	(1, 2, 3)	WIDTH	LENGTH	(SQ FT)	(SQ YD)
I-290 Exit Ramp	Walnut St.	WB	ALL	24	300	7200	800
Walnut St.	I-290 Exit Ramp	EB	All	24	200	4800	533
TOTALS:						500	1333
						FT	SY

ROUTE: US 20 (York Rd. to 100' West of York Rd.)							
CROSS STREETS		DIRECTION	LANE	PAVEMENT	PAVEMENT	REPAIR	REPAIR
FROM	TO	(EB/WB)	NO.	PATCH	PATCH	AREA	AREA
		(NB/SB)	(1, 2, 3)	WIDTH	LENGTH	(SQ FT)	(SQ YD)
York Rd.	100' West of York Rd.	EB	1	12	6	72	8
		EB	2	12	6	72	8
		EB	1	12	6	72	8
		EB	2	12	50	600	67
		EB	Intersection	20	50	1000	111
		NB	Intersection	6	20	120	13
		WB	Intersection	20	20	400	44
		WB	1	12	20	240	27
		WB	2	12	20	240	27
		WB	2	12	6	72	8
		WB	1	12	15	180	20
		WB	2	12	15	180	20
		WB	3	12	50	600	67
		WB	1, 2, 3	25	36	900	100
TOTALS:						320	528
						FT	SY

ROUTE: US 34 (North Aurora Rd. to Belmont Rd.)								
CROSS STREETS		DIRECTION	LANE	PAVEMENT	PAVEMENT	REPAIR	REPAIR	
FROM	TO	(EB/WB)	NO.	PATCH	PATCH	AREA	AREA	
		(NB/SB)	(1, 2, 3)	WIDTH	LENGTH	(SQ FT)	(SQ YD)	
NORTH AURORA RD		EB	1,2	24	12	288	32	
		EB	1,2	24	12	288	32	
		WB	1,2	24	12	288	32	
		WB	2	12	12	144	16	
EAGLE	EAGLE ST		MIDDLE	12	60	720	80	
		WB	1,2	24	10	240	27	
		WB	1,2	24	10	240	27	
		WB	1,2	24	10	240	27	
		EB	1,2	24	10	240	27	
		EB	1,2	24	10	240	27	
		EB	1	12	10	120	13	
		EB	2	12	10	120	13	
		WB	1,2	24	8	192	21	
		WB	1,2,3	36	10	360	40	
	WASHINGTON	WASHINGTON	EB	1	12	10	120	13
			EB	2	12	10	120	13
		WB	1,2	24	8	192	21	
		WB	1,2,3	36	10	360	40	
		WB	1,2,3	36	10	360	40	
		EB	1,2	24	8	192	21	
		WB	1,2,3	36	10	360	40	
		EB	1,2	24	8	192	21	
		WB	1,2	24	8	192	21	
		WB	1,2	24	8	192	21	
		WB	1,2	24	8	192	21	
LOOMIS ST		LOOMIS ST	WB	1,2	24	8	192	21
	WB		1,2,3	36	8	288	32	
		WB	1,2,3	36	10	360	40	
		EB	1,2	24	10	240	27	
		WB	1,2	24	10	240	27	
			MIDDLE	12	10	120	13	
		WB	1,2	24	10	240	27	
		WB	1,2,3	36	10	360	40	
		EB	1,2,3	36	12	432	48	
		WB	1,2,3	36	12	432	48	
		EB	1,2	24	10	240	27	
		WB	1,2,3	36	10	360	40	
	EB	1,2	24	10	240	27		
	EB	1,2	24	10	240	27		
	EB	1,2	24	10	240	27		
	EB	1,2	24	10	240	27		
	WB	1,2	24	10	240	27		
	WB	1,2	24	10	240	27		
	WB	1,2	24	10	240	27		
	WB	1,2,3	36	10	360	40		
	WB	1,2,3	36	10	360	40		
	EB	1,2	24	10	240	27		
	WB	1,2,3	36	10	360	40		
	EB	1,2	24	10	240	27		
	WB	1,2,3	36	10	360	40		
	EB	1,2	24	10	240	27		
	WB	1,2,3	36	10	360	40		
	WB	1,2,3	36	8	288	32		

ROUTE: US 34 (North Aurora Rd. to Belmont Rd.)							
CROSS STREETS		DIRECTION	LANE	PAVEMENT	PAVEMENT	REPAIR	REPAIR
FROM	TO	(EB/WB)	NO.	PATCH	PATCH	AREA	AREA
		(NB/SB)	(1, 2, 3)	WIDTH	LENGTH	(SQ FT)	(SQ YD)
		EB	1	12	10	120	13
		EB	1,2	24	8	192	21
		WB	1,2,3	36	10	360	40
		WB	1,2,3	36	10	360	40
		WB	1,2,3	36	10	360	40
		EB	1,2	24	10	240	27
		WB	1,2	24	10	240	27
		WB	2	12	50	600	67
		WB	1,2,3	36	10	360	40
NAPERVILLE RD	NAPERVILLE RD	EB	1,2	24	12	288	32
		EB	1,2	24	40	960	107
		EB	1,2	24	20	480	53
		WB	1,2	24	20	480	53
		EB	2	12	30	360	40
		EB	1,2	24	20	480	53
		WB	1,2,3	36	20	720	80
		WB	1,2,3	36	30	1080	120
		WB	1,2,3	36	10	360	40
		EB	1,2	24	10	240	27
		WB	1,2,3	36	20	720	80
		EB	1,2	24	20	480	53
	WB	1,2,3	36	12	432	48	
	EB	1,2	24	20	480	53	
	EB	2	12	40	480	53	
	EB	1	12	10	120	13	
	WB	1,2,3	36	10	360	40	
	WB	1,2,3	36	10	360	40	
	EB	1,2	24	10	240	27	
	WB	1,2	24	60	1440	160	
	EB	2	12	80	960	107	
	WB	1,2	24	10	240	27	
	EB	1,2,3	36	40	1440	160	
	WB	1,2	24	20	480	53	
	WB	2	12	40	480	53	
	EB	2	12	60	720	80	
LOOMIS ST	LOOMIS ST	EB	1,2	24	40	960	107
		EB	1,2	24	60	1440	160
		WB	1,2,3	36	40	1440	160
		EB	2	12	80	960	107
		WB	2	12	100	1200	133
		EB	1	12	100	1200	133
		EB	2	12	100	1200	133
		WB	2	12	20	240	27
		EB	2	12	100	1200	133
		WB	1,2	24	60	1440	160
		WB	2	12	40	480	53
	YACKLEY	YACKLEY	EB	2	12	50	600
WB			1,2	24	12	288	32
		EB	2	12	60	720	80
		EB	2	24	10	240	27
		WB	2	12	60	720	80
		WB	1	12	12	144	16
		WB	2	12	30	360	40
			MIDDLE	12	400	4800	533
		EB	2	12	40	480	53

CONTINUED ON NEXT SHEET

FILE NAME =	USER NAME = wilgreendp	DESIGNED -	REVISED -	STATE OF ILLINOIS DEPARTMENT OF TRANSPORTATION	PATCHING SCHEDULE US 34			F.A. RTE.	SECTION	COUNTY	TOTAL SHEETS	SHEET NO.	
es:\pwork\p\dot\wilgreendp\d0183689\Design.dgn	DRAWN -	REVISED -	SCALE:		SHEET NO.	OF	SHEETS	STA.	TO STA.	2010-010 RS	DUPAGE	47	38
PLOT SCALE = 100.0000' / IN.	CHECKED -	REVISED -						CONTRACT NO. 60K29					
PLOT DATE = 2/28/2010	DATE -	REVISED -	FED. ROAD DIST. NO. 1 ILLINOIS FED. AID PROJECT										

ROUTE: US 34 (North Aurora Rd. to Belmont Rd.)							
CROSS STREETS		DIRECTION	LANE	PAVEMENT	PAVEMENT	REPAIR	REPAIR
FROM	TO	(EB/WB)	NO.	PATCH	PATCH	AREA	AREA
		(NB/SB)	(1, 2, 3)	WIDTH	LENGTH	(SQ FT)	(SQ YD)
YACKLEY		WB	2	12	30	360	40
		EB	2	12	200	2400	267
		WB	1,2	24	12	288	32
		WB	2	12	40	480	53
		WB	2	12	40	480	53
		EB	1,2	24	100	2400	267
		WB	1,2	24	40	960	107
		EB	2	12	30	360	40
		EB	1,2	24	30	720	80
		WB	1,2	24	30	720	80
		EB	1,2	24	30	720	80
		WB	1,2	24	30	720	80
		EB	3	12	100	1200	133
		WB	2	12	12	144	16
		WB	2	12	40	480	53
		WB	3	12	50	600	67
		EB	1,2	24	30	720	80
		WB	1,2	24	30	720	80
		EB	1,2	24	12	288	32
		WB	1,2,3	36	12	432	48
		WB	1,2	24	10	240	27
		EB	2	12	40	480	53
		EB	2	12	30	360	40
		WB	2	12	30	360	40
		EB	2	12	40	480	53
			MIDDLE	12	200	2400	267
		EB	1,2	24	12	288	32
		WB	1,2,3	36	12	432	48
			MIDDLE	12	300	3600	400
		EB	1	12	160	1920	213
		EB	1	12	40	480	53
		WB	2	12	20	240	27
		WB	2	12	60	720	80
		EB	2	12	60	720	80
		WB	2	12	40	480	53
		EB	2	12	100	1200	133
		EB	2	12	200	2400	267
		WB	2	12	100	1200	133
		TOTALS:				5148	9475
						FT	SY

ROUTE: US 34 (Blackhawk Dr. to Salt Creek Ln.)							
CROSS STREETS		DIRECTION	LANE	PAVEMENT	PAVEMENT	REPAIR	REPAIR
FROM	TO	(EB/WB)	NO.	PATCH	PATCH	AREA	AREA
		(NB/SB)	(1, 2, 3)	WIDTH	LENGTH	(SQ FT)	(SQ YD)
Blackhawk Dr.	Oxford Ave.	WB	1	12	6	72	8
		EB/WB	CL	6	200	1200	133
Oxford Ave.	Coe Rd.	WB	2	12	6	72	8
		EB	1, 2	24	6	144	16
		EB	1	12	20	240	27
		EB	2	12	30	360	40
		EB	1, 2	24	6	144	16
		EB	1	12	6	72	8
		EB	1, 2	24	6	144	16
At Adams St. Intersection		EB/WB	1, 2, 3, 4	48	10	480	53
Madison St. to Lincoln St. (EB) - No Patching							
Salt Creek Ln.	Madison St.	WB	1	12	6	72	8
		WB	1	8	6	48	5
		WB	2	8	6	48	5
		WB	1, 2	24	6	144	16
		WB	1	20	20	400	44
		TOTALS:				340	404
						FT	SY

ROUTE: York Rd. (South of Bridge to Frontage Rd.)							
CROSS STREETS		DIRECTION	LANE	PAVEMENT	PAVEMENT	REPAIR	REPAIR
FROM	TO	(EB/WB)	NO.	PATCH	PATCH	AREA	AREA
		(NB/SB)	(1, 2, 3)	WIDTH	LENGTH	(SQ FT)	(SQ YD)
South Of Bridge	Frontage Road	SB	1	12	6	72	8
		SB	1	12	12	144	16
		SB	2	12	12	144	16
		SB	1	12	50	600	67
		SB	2	12	6	72	8
		SB	2	12	20	240	27
		SB	1	12	6	72	8
		SB	2	12	6	72	8
Frontage Road	South Of Bridge	NB	1	12	4	48	5
		NB	2	12	4	48	5
		NB	1	12	12	144	16
		NB	2	12	12	144	16
		NB	1	12	12	144	16
		NB	1	6	50	300	33
Frontage Road	South Of Bridge	NB	2	6	12	72	8
TOTALS:						224	257
						FT	SY

FILE NAME =	USER NAME = wilgreendp	DESIGNED -	REVISED -	STATE OF ILLINOIS DEPARTMENT OF TRANSPORTATION	PATCHING SCHEDULE YORK RD.			F.A. RTE.	SECTION	COUNTY	TOTAL SHEETS	SHEET NO.	
cd:\pw\work\pwidot\wilgreendp\0183609\Design.dgn	DRAWN -	REVISED -	SCALE:		SHEET NO.	OF	SHEETS	STA.	TO STA.	VAR.	2010-010 RS	DUPAGE	47 40
PLOT SCALE = 100.0000' / IN.	CHECKED -	REVISED -											
PLOT DATE = 2/20/2010	DATE -	REVISED -											
FED. ROAD DIST. NO. 1 ILLINOIS FED. AID PROJECT													

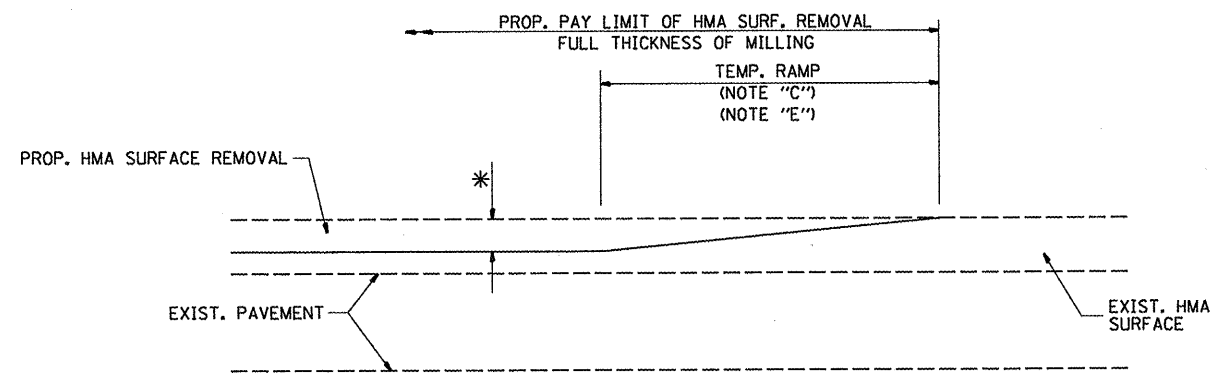

MILLED TEMPORARY RAMP
(FOR BUTT JOINT AND HMA TAPER SEE DETAIL BELOW)

OPTION 1

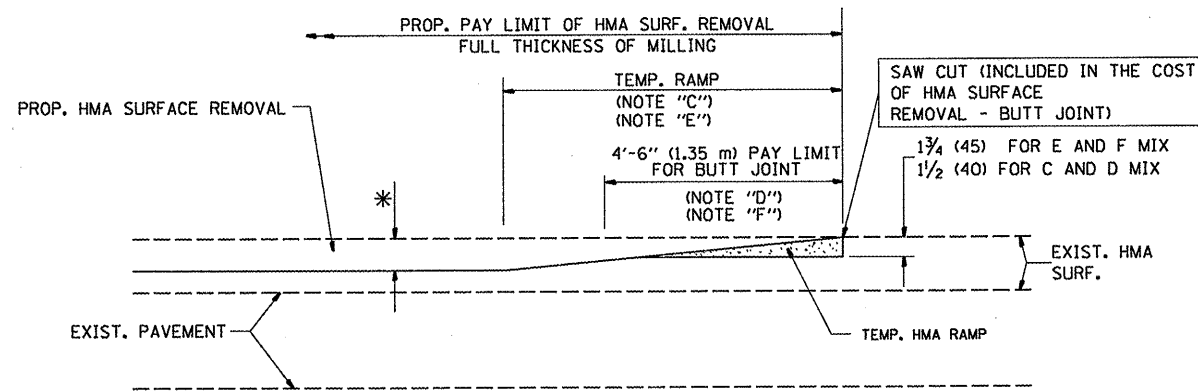

HMA CONSTRUCTED TEMPORARY RAMP
(FOR BUTT JOINT AND HMA TAPER SEE DETAIL BELOW)

OPTION 2
TYPICAL TEMPORARY RAMP

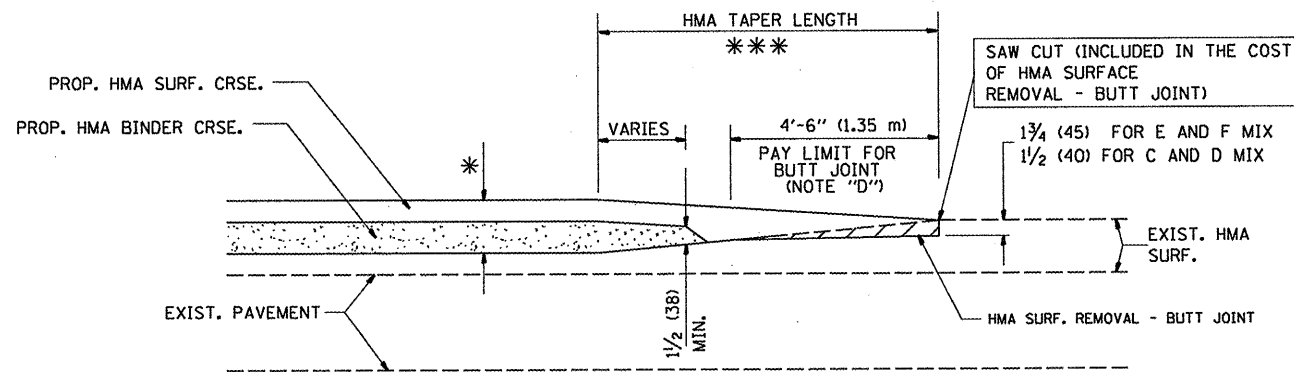

BUTT JOINT AND
HMA TAPER

**TYPICAL BUTT JOINT AND HMA TAPER
FOR MILLING AND RESURFACING**

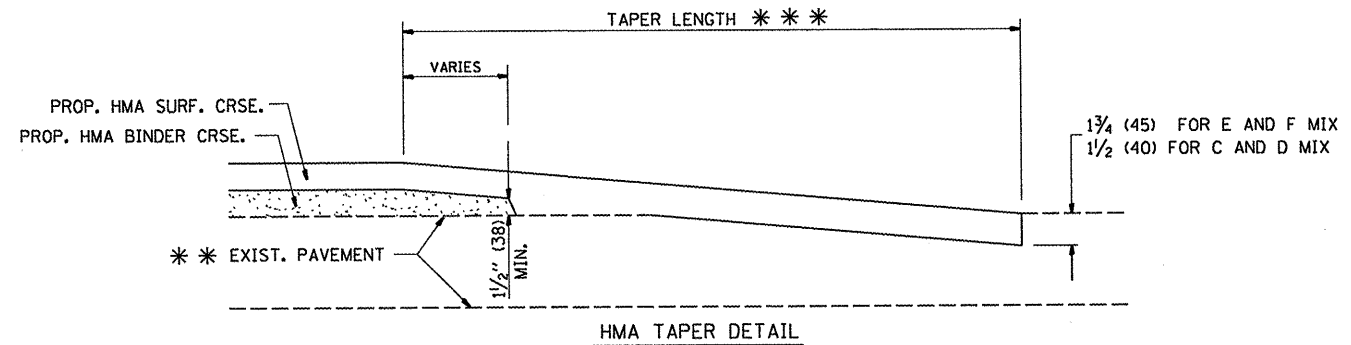
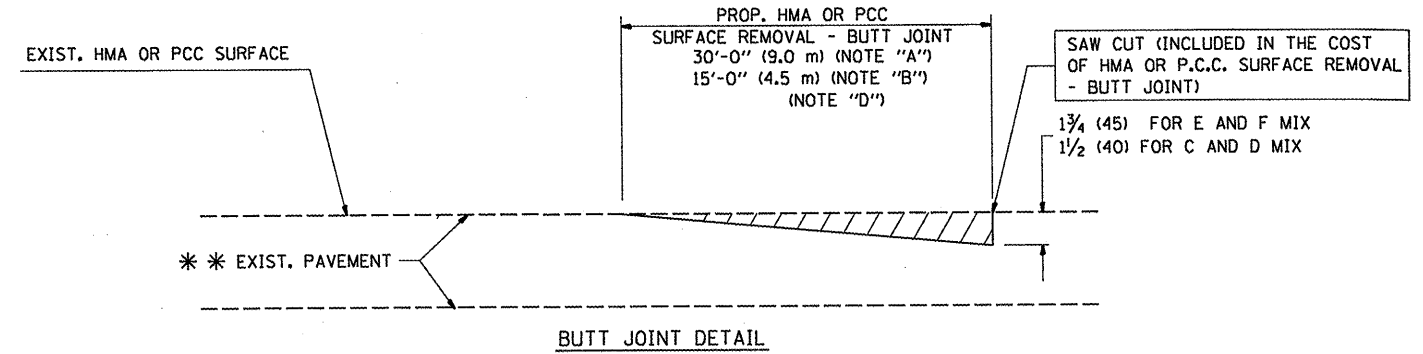

**TYPICAL BUTT JOINT AND HMA TAPER
FOR RESURFACING ONLY**

** PC CONCRETE, HMA OR HMA RESURFACED PAVEMENT.

NOTES

- A: MAINLINE ROADWAYS AND MAJOR SIDE ROADS.
- B: MINOR SIDE ROADS.
- C: THE TEMP. RAMP SHALL BE CONSTRUCTED IMMEDIATELY UPON REMOVAL OF THE EXISTING HMA SURFACE.
- D: THE BUTT JOINT SHALL BE CONSTRUCTED IMMEDIATELY PRIOR TO PLACING THE PROPOSED HMA COURSES.
- E: TAPER THE TEMP. RAMP AT A RATE OF 3'-0" (900 mm) PER 1 INCH (25 mm) OF MILLING THICKNESS.
- F: INSTALLATION AND REMOVAL OF THE 4'-6" (1.35 m) TEMP. RAMP IS INCLUDED IN COST OF HMA SURFACE REMOVAL - BUTT JOINT
- G: SEE ARTICLE 406.08 AND 406.14 OF THE STANDARD SPECIFICATIONS FOR "HMA AND/OR PCC SURFACE REMOVAL, BUTT JOINT".

* SEE TYPICAL SECTIONS FOR MILLING THICKNESS.

*** 20'-0" (6.1 m) PER 1 (25) RESURFACING (NOTE "A")
10'-0" (3.0 m) PER 1 (25) RESURFACING (NOTE "B")

BASIS OF PAYMENT:

THE BUTT JOINT WILL BE PAID FOR AT THE CONTRACT UNIT PRICE PER SQUARE YARD (SQUARE METER) FOR "HOT-MIX ASPHALT SURFACE REMOVAL - BUTT JOINT" OR FOR "PORTLAND CEMENT CONCRETE SURFACE REMOVAL - BUTT JOINT".

ALL DIMENSIONS ARE IN INCHES (MILLIMETERS) UNLESS OTHERWISE SHOWN.

FILE NAME =	USER NAME = wilgreendp	DESIGNED - M. DE YONG	REVISED - R. SHAH 10-25-94
est\pw_work\PWIDOT\WILGREENDP\0183609\estStd.dgn		DRAWN -	REVISED - A. ABBAS 03-21-97
PLOT SCALE = 100.0000 ' / IN.		CHECKED -	REVISED - M. GOMEZ 04-06-01
PLOT DATE = 2/22/2010		DATE - 06-13-90	REVISED - R. BORO 01-01-07

**STATE OF ILLINOIS
DEPARTMENT OF TRANSPORTATION**

BUTT JOINT AND HMA TAPER DETAILS			
SCALE: NONE	SHEET NO. 1 OF 1 SHEETS	STA.	TO STA.

F.A. RTE.	SECTION	COUNTY	TOTAL SHEETS	SHEET NO.
VAR.	2010-010 RS	DUPAGE	47	41
BD400-05 BD32		CONTRACT NO. 60K29		
FED. ROAD DIST. NO. 1 [ILLINOIS] FED. AID PROJECT				

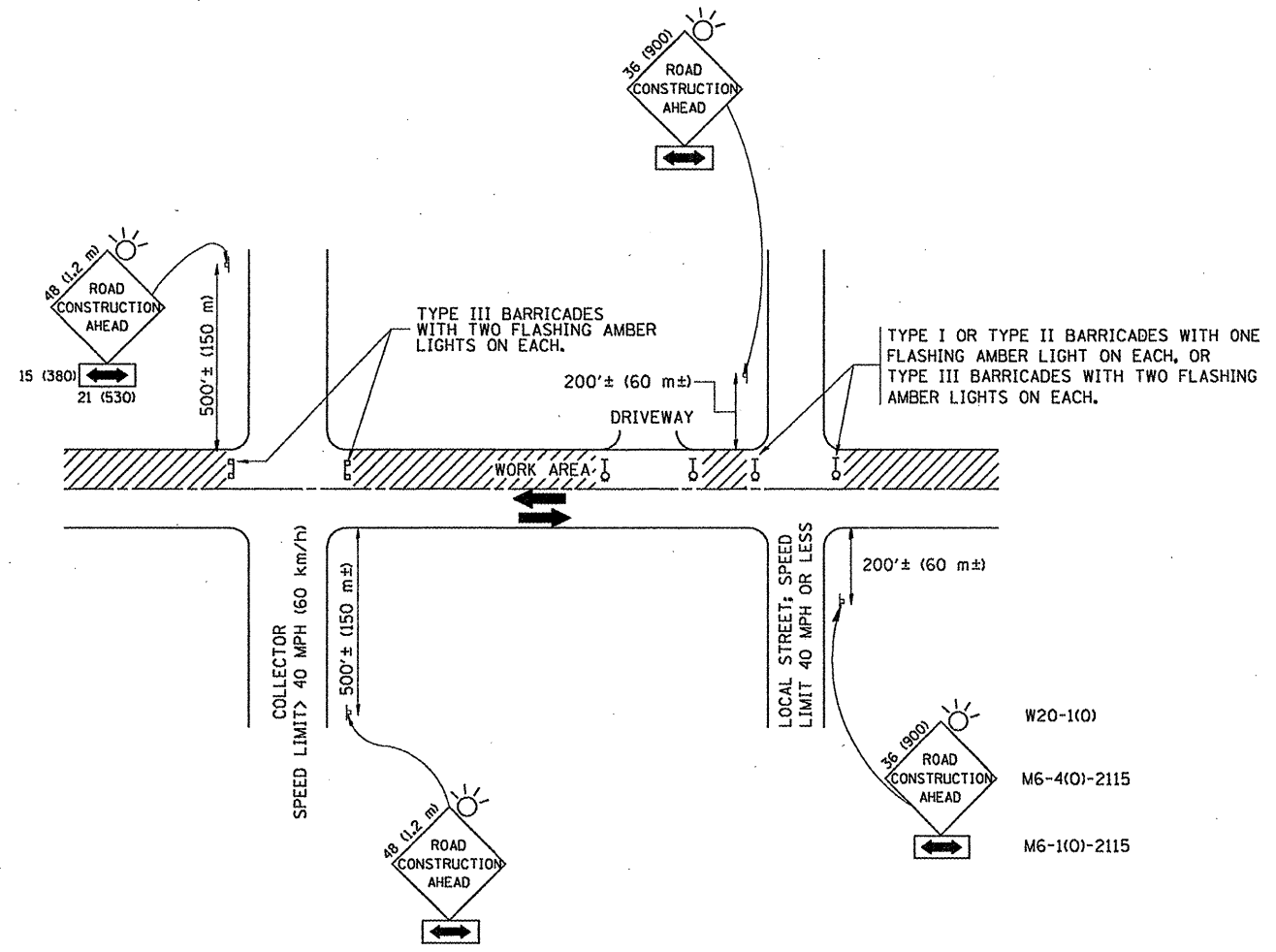

TRAFFIC CONTROL AND PROTECTION FOR SIDE ROADS, INTERSECTIONS, AND DRIVEWAYS

NOTES:

- A. FOR NO LANE RESTRICTION ON THE SIDE ROAD OR DRIVEWAYS
- SIDE ROAD WITH A SPEED LIMIT OF 40 MPH (60 km/h) OR LESS AS SHOWN ON THE DRAWING AND AS DIRECTED BY THE ENGINEER:
 - ONE ROAD CONSTRUCTION AHEAD SIGN 36 x 36 (900x900) WITH A FLASHER AND FLAG MOUNTED ON IT APPROXIMATELY 200' (60 m) IN ADVANCE OF THE MAIN ROUTE.
 - THE CLOSED PORTION OF THE MAIN ROUTE SHALL BE PROTECTED BY BLOCKING WITH TYPE I, TYPE II OR TYPE III BARRICADES, 1/3 OF THE CROSS SECTION OF THE CLOSED PORTION.
 - SIDE ROAD WITH A SPEED LIMIT GREATER THAN 40 MPH (60 km/h) AS SHOWN ON THE DRAWING AND AS DIRECTED BY THE ENGINEER:
 - ONE ROAD CONSTRUCTION AHEAD SIGN 48 x 48 (1.2 m x 1.2 m) WITH A FLASHER MOUNTED ON IT APPROXIMATELY 500' (150 m) IN ADVANCE OF THE MAIN ROUTE.
 - THE CLOSED PORTION OF THE MAIN ROUTE SHALL BE PROTECTED BY BLOCKING WITH TYPE III BARRICADES, 1/2 OF THE CROSS SECTION OF THE CLOSED PORTION.
3. WHEN THE SIDE ROAD LIES BETWEEN THE BEGINNING OF THE MAINLINE SIGNING AND THE WORK ZONE, A SINGLE HEADED ARROW (M6-1) SHALL BE USED IN LIEU OF THE DOUBLE HEADED ARROW (M6-4).
- B. FOR A LANE CLOSURE ON A SIDE ROAD OR DRIVEWAY:
USE APPLICABLE PORTIONS OF THE TYPICAL APPLICATION OF TRAFFIC CONTROL DEVICES (STD. 701501, STD. 701606 OR THE APPROPRIATE STANDARD). THE SPACING OF SIGNS AND BARRICADES SHALL BE ADJUSTED FOR FIELD CONDITIONS AS DIRECTED BY THE ENGINEER. THE DIRECTIONAL ARROW SHALL BE COVERED OR REMOVED WHEN NO LONGER CONSISTENT WITH THE SIDE ROAD LANE CLOSURE.
- C. ADVANCE WARNING SIGNS ARE TO BE OMITTED ON DRIVEWAY UNLESS OTHERWISE NOTED.
- D. THE TRAFFIC CONTROL AND PROTECTION FOR SIDE ROADS, INTERSECTIONS, AND DRIVEWAYS SHALL BE INCIDENTAL TO THE COST OF SPECIFIED TRAFFIC CONTROL STANDARDS OR ITEMS.

All dimensions are in millimeters (inches) unless otherwise shown.

FILE NAME =	USER NAME = whltatar	DESIGNED - LHA	REVISED - J. OBERLE 10-18-95
cr:\pwwork\VP\WIDOT\WHILTATAR\0175544\01s	Std.dgn	DRAWN -	REVISED - A. HOUSEH 03-06-96
	PLOT SCALE = 100.0000' / IN.	CHECKED -	REVISED - A. HOUSEH 10-15-96
	PLOT DATE = 2/10/2010	DATE - 06-89	REVISED - T. RAMMACHER 01-06-00

STATE OF ILLINOIS
DEPARTMENT OF TRANSPORTATION

TRAFFIC CONTROL AND PROTECTION FOR
SIDE ROADS, INTERSECTIONS, AND DRIVEWAYS

SCALE: NONE SHEET NO. 1 OF 1 SHEETS STA. TO STA.

F.A. RTE.	SECTION	COUNTY	TOTAL SHEETS	SHEET NO.
	2010-010 RS	DUPAGE	47	42
TC-10			CONTRACT NO. 60K29	
FED. ROAD DIST. NO. 1 ILLINOIS FED. AID PROJECT				

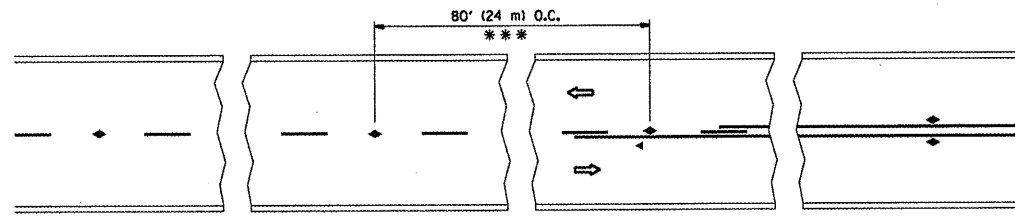

*** REDUCE TO 40' (12 m) O.C. ON CURVES WITH POSTED OR ADVISORY SPEED 45 M.P.H. (70 km/h) OR LESS.

TWO-LANE/TWO-WAY

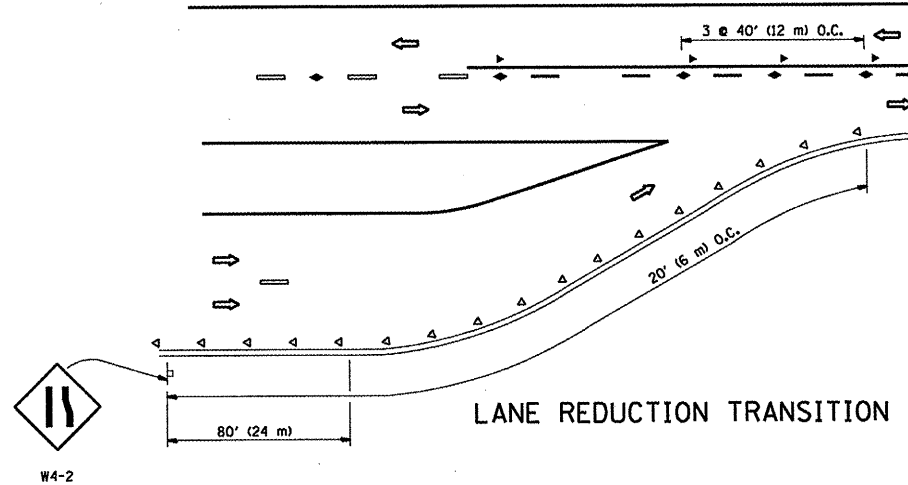

LANE REDUCTION TRANSITION

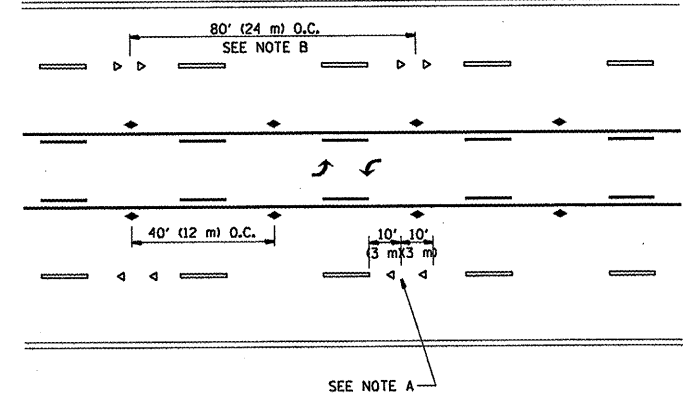

TWO-WAY LEFT TURN

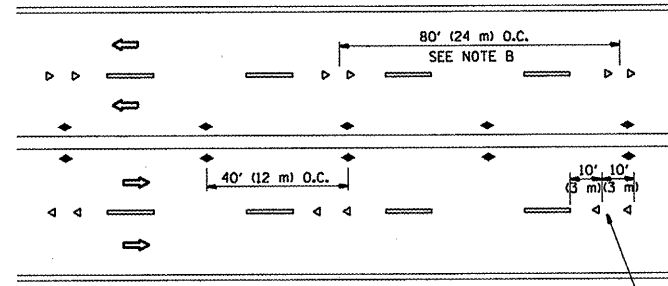

MULTI-LANE/UNDIVIDED

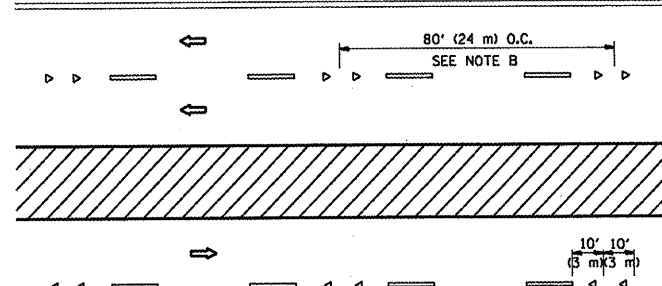

MULTI-LANE/DIVIDED

GENERAL NOTES

1. MARKERS USED WITH DASHED LINES SHALL BE CENTERED IN THE GAP BETWEEN SEGMENTS.
2. MARKERS USED ADJACENT TO SOLID LINES SHALL BE OFFSET 2 TO 3 (50 TO 75) TOWARD TRAFFIC AS SHOWN.
3. MARKERS THROUGH TANGENTS LESS THAN 500' (150 m) IN LENGTH BETWEEN CURVES SHALL BE INSTALLED AT THE LESSER OF THE TWO CURVE SPACINGS.

SYMBOLS

- YELLOW STRIPE
- WHITE STRIPE
- ◀ ONE-WAY AMBER MARKER
- ◀ ONE-WAY CRYSTAL MARKER (W/O)
- ◀ TWO-WAY AMBER MARKER

LANE MARKER NOTES

- A. USE DOUBLE LANE LINE MARKERS SPACED AS SHOWN.
- B. REDUCE TO 40' (12 m) O.C. ON CURVES WHERE ADVISORY SPEEDS ARE 10 M.P.H (20 km/h) LOWER THAN POSTED SPEEDS.

DESIGN NOTES

1. DOUBLE LANE LINE MARKERS SHALL BE USED UNLESS SPECIFIED OTHERWISE.
2. EXCEPT AS SHOWN ON THE LANE REDUCTION TRANSITION AND FREEWAY EXIT RAMP DETAIL, MARKERS ARE NOT TO BE SPECIFIED ON RIGHT EDGE LINES.
3. THE EXACT MARKER LIMITS, SPACING, AND COLOR SHOULD BE INCLUDED IN THE PLANS.
4. MARKERS SHOULD NOT BE USED ALONGSIDE CURBS EXCEPT FOR EXTREMELY SHORT SECTIONS OF CURBS WHERE NOT MORE THAN TWO MARKERS WOULD BE INVOLVED.

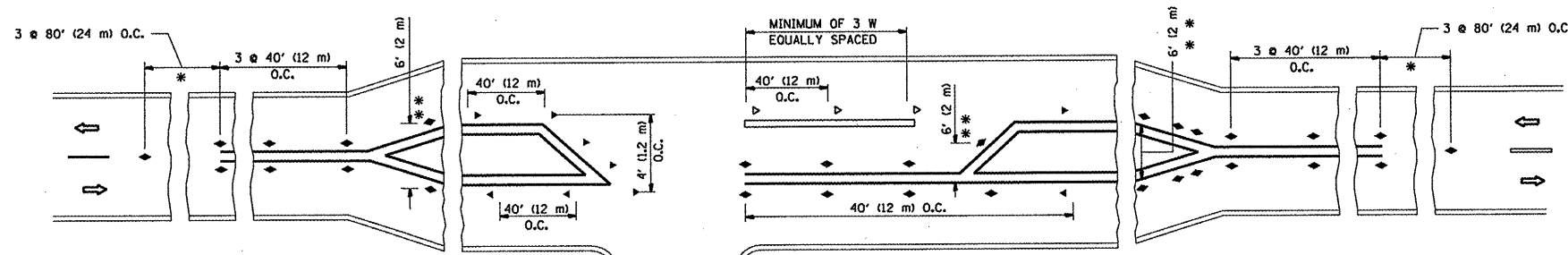

LEFT TURN

* SEE TWO-LANE/TWO-WAY WHERE MARKERS CONTINUE
 ** WHERE THE MEDIAN WIDTH IS 6' (2 m) OR LESS USE TWO-WAY MARKERS.

All dimensions are in inches (millimeters) unless otherwise shown.

FILE NAME =	USER NAME = wilgreendp	DESIGNED -	REVISED - T. RAMMACHER 09-19-94
cat\pwwork\pwidot\WILGREENDP\d0183609\stStd.dgn	stStd.dgn	DRAWN -	REVISED - T. RAMMACHER 03-12-99
PLOT SCALE = 100.0000' / IN.	CHECKED -	REVISED - T. RAMMACHER 01-06-00	
PLOT DATE = 2/22/2010	DATE -	REVISED - C. JUCIUS 09-09-09	

STATE OF ILLINOIS
DEPARTMENT OF TRANSPORTATION

TYPICAL APPLICATIONS			
RAISED REFLECTIVE PAVEMENT MARKERS (SNOW-PLOW RESISTANT)			
SCALE: NONE	SHEET NO. 1 OF 1 SHEETS	STA.	TO STA.

F.A. RTE.	SECTION	COUNTY	TOTAL SHEETS	SHEET NO.
VAR.	2010-010 RS	DUPAGE	47	43
TC-11			CONTRACT NO. 60K29	
FED. ROAD DIST. NO. 1 ILLINOIS FED. AID PROJECT				

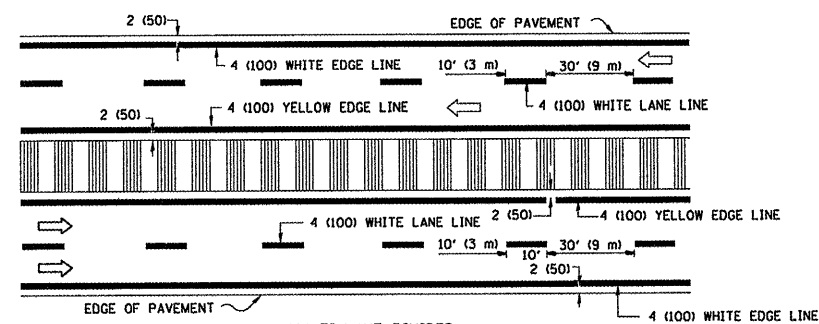
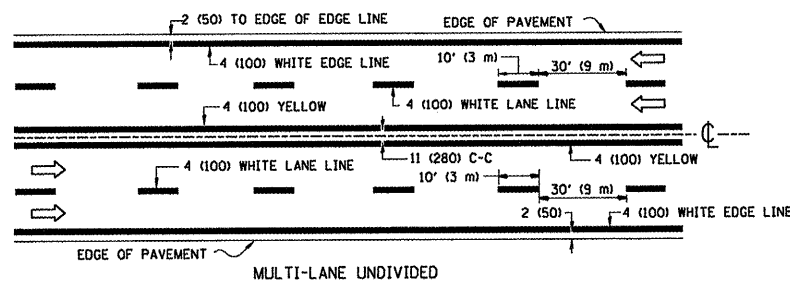
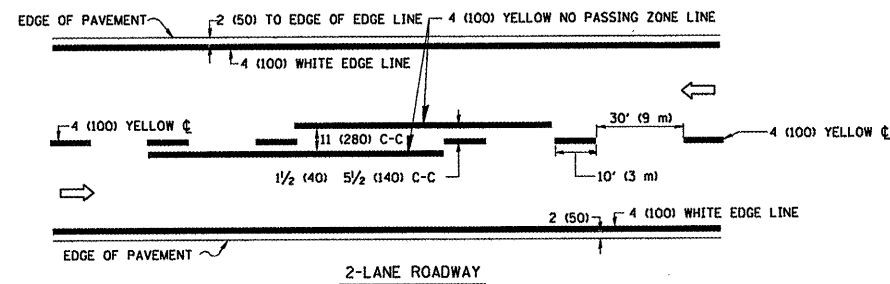

NOTE: MEDIANS WITH BARRIER CURB DO NOT REQUIRE AN EDGE LINE

TYPICAL LANE AND EDGE LINE MARKING

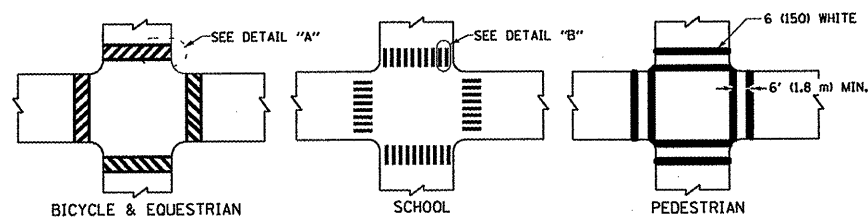

TYPICAL CROSSWALK MARKING

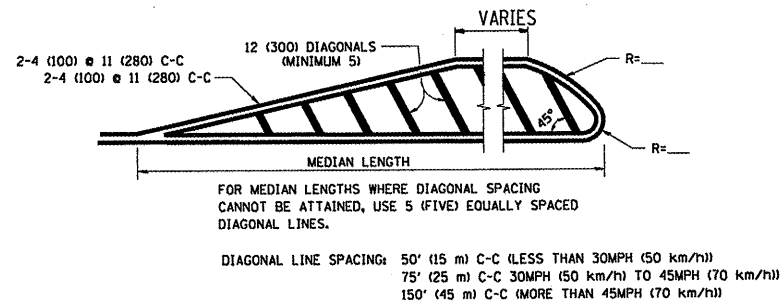
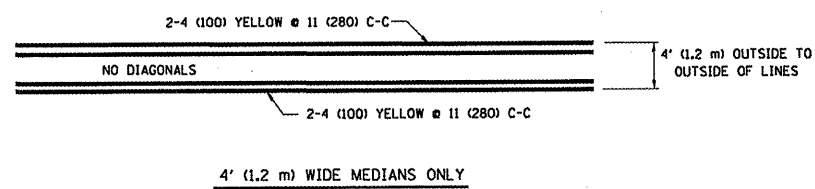

MEDIANS OVER 4' (1.2 m) WIDE

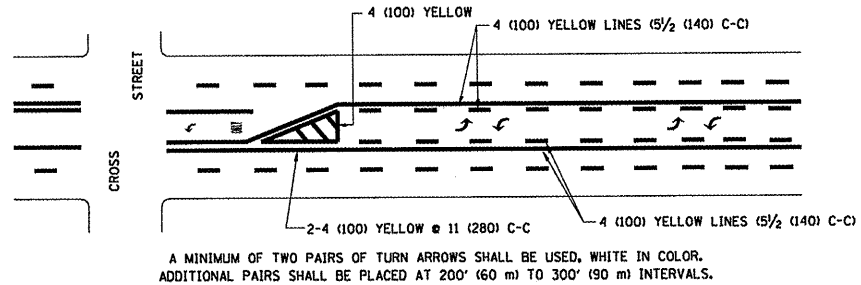

TYPICAL PAINTED MEDIAN MARKING

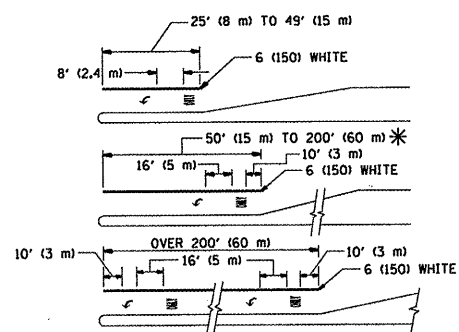

FULL SIZE LETTERS 8' (2.4 m) AND ARROWS SHALL BE USED.
 AREA = 15.6 SQ. FT. (1.5 m²) AREA = 20.8 SQ. FT. (1.9 m²)
 * TURN LANES IN EXCESS OF 400' (120 m) IN LENGTH MAY HAVE AN ADDITIONAL SET OF ARROW - "ONLY" INSTALLED MIDWAY BETWEEN THE OTHER TWO SETS OF ARROW - "ONLY".

TYPICAL TURN LANE MARKING

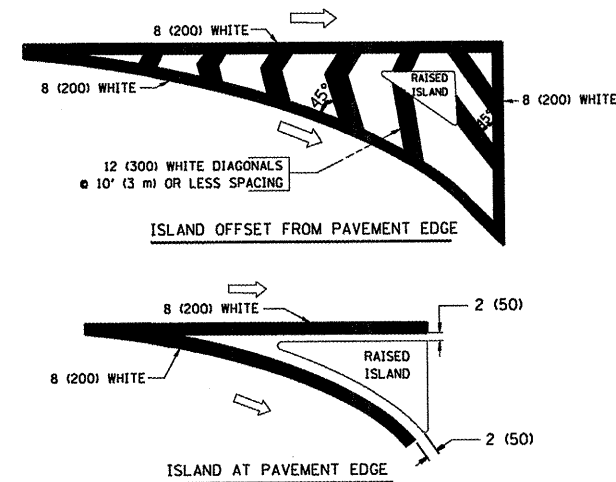

TYPICAL ISLAND MARKING

TYPE OF MARKING	WIDTH OF LINE	PATTERN	COLOR	SPACING / REMARKS
CENTERLINE ON 2 LANE PAVEMENT	4 (100)	SKIP-DASH	YELLOW	10' (3 m) LINE WITH 30' (9 m) SPACE
CENTERLINE ON MULTI-LANE UNDIVIDED PAVEMENT	2 @ 4 (100)	SOLID	YELLOW	11 (280) C-C
NO PASSING ZONE LINES FOR ONE DIRECTION FOR BOTH DIRECTIONS	4 (100) 2 @ 4 (100)	SOLID SOLID	YELLOW YELLOW	5/2 (140) C-C FROM SKIP-DASH CENTERLINE 11 (280) C-C OMIT SKIP-DASH CENTERLINE BETWEEN
LANE LINES	4 (100) 5 (125)	SKIP-DASH SKIP-DASH	WHITE WHITE	10' (3 m) LINE WITH 30' (9 m) SPACE
DOTTED LINES (EXTENSIONS OF CENTER, LANE OR TURN LANE MARKINGS)	SAME AS LINE BEING EXTENDED	SKIP-DASH	SAME AS LINE BEING EXTENDED	2' (600) LINE WITH 6' (1.8 m) SPACE
EDGE LINES	4 (100)	SOLID	YELLOW-LEFT WHITE-RIGHT	OUTLINE MOUNTABLE MEDIANS IN YELLOW; EDGE LINES ARE NOT USED NEXT TO BARRIER CURB
TURN LANE MARKINGS	6 (150) LINE; FULL SIZE LETTERS & SYMBOLS (8' (2.4m))	SOLID	WHITE	SEE TYPICAL TURN LANE MARKING DETAIL
TWO WAY LEFT TURN MARKING	2 @ 4 (100) EACH DIRECTION 8' (2.4m) LEFT ARROW	SKIP-DASH AND SOLID IN PAIRS	YELLOW WHITE	10' (3 m) LINE WITH 30' (9 m) SPACE FOR SKIP-DASH; 5/2 (140) C-C BETWEEN SOLID LINE AND SKIP-DASH LINE SEE TYPICAL TWO-WAY LEFT TURN MARKING DETAIL
CROSSWALK LINES (PEDESTRIAN) A. DIAGONALS (BIKE & EQUESTRIAN) B. LONGITUDINAL BARS (SCHOOL)	2 @ 6 (150) 12 (300) @ 45° 12 (300) @ 90°	SOLID SOLID SOLID	WHITE WHITE WHITE	NOT LESS THAN 6' (1.8 m) APART 2' (600) APART SEE TYPICAL CROSSWALK MARKING DETAILS.
STOP LINES	24 (600)	SOLID	WHITE	PLACE 4' (1.2 m) IN ADVANCE OF AND PARALLEL TO CROSSWALK, IF PRESENT. OTHERWISE, PLACE AT DESIRED STOPPING POINT, PARALLEL TO CROSSROAD CENTERLINE, WHERE POSSIBLE.
PAINTED MEDIANS	2 @ 4 (100) WITH 12 (300) DIAGONALS @ 45° NO DIAGONALS USED FOR 4' (1.2 m) WIDE MEDIANS	SOLID	YELLOW: TWO WAY TRAFFIC WHITE: ONE WAY TRAFFIC	11 (280) C-C FOR THE DOUBLE LINE SEE TYPICAL PAINTED MEDIAN MARKING.
GORE MARKING AND CHANNELIZING LINES	8 (200) WITH 12 (300) DIAGONALS @ 45°	SOLID	WHITE	DIAGONALS: 15' (4.5 m) C-C (LESS THAN 30MPH (50 km/h)) 20' (6 m) C-C (30MPH (50 km/h) TO 45MPH (70 km/h)) 30' (9 m) C-C (OVER 45MPH (70 km/h))
RAILROAD CROSSING	24 (600) TRANSVERSE LINES; "RR" IS 6' (1.8 m) LETTERS; 16 (400) LINE FOR "X"	SOLID	WHITE	SEE STATE STANDARD 780001 AREA OF: "R"=3.6 SQ. FT. (0.33 m ²) EACH "X"=54.0 SQ. FT. (5.0 m ²)
SHOULDER DIAGONALS	12 (300) @ 45°	SOLID	WHITE - RIGHT YELLOW - LEFT	50' (15 m) C-C (LESS THAN 30MPH (50 km/h)) 75' (25 m) C-C (30 MPH (50 km/h) TO 45MPH (70 km/h)) 150' (45 m) C-C (OVER 45MPH (70 km/h))

FOR FURTHER DETAILS ON PAVEMENT MARKING REFER TO STANDARD SPECIFICATIONS FOR ROAD AND BRIDGE CONSTRUCTION AND STATE STANDARD 780001.

All dimensions are in inches (millimeters) unless otherwise shown.

FILE NAME =	USER NAME = wilgreendp	DESIGNED - EVERS	REVISED - T. RAMMACHER 10-27-94
cr:\pw\work\VPWIDOT\WILGREENDP\d0183689\ststd.dgn		DRAWN -	REVISED - C. JUCIUS 09-09-09
	PLOT SCALE = 1/8" = 1'-0"	CHECKED -	REVISED -
	PLOT DATE = 2/22/2010	DATE - 03-19-90	REVISED -

**STATE OF ILLINOIS
DEPARTMENT OF TRANSPORTATION**



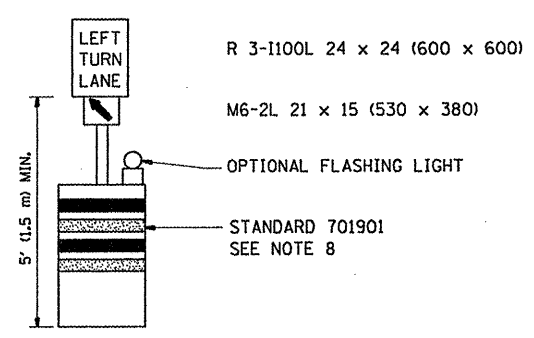
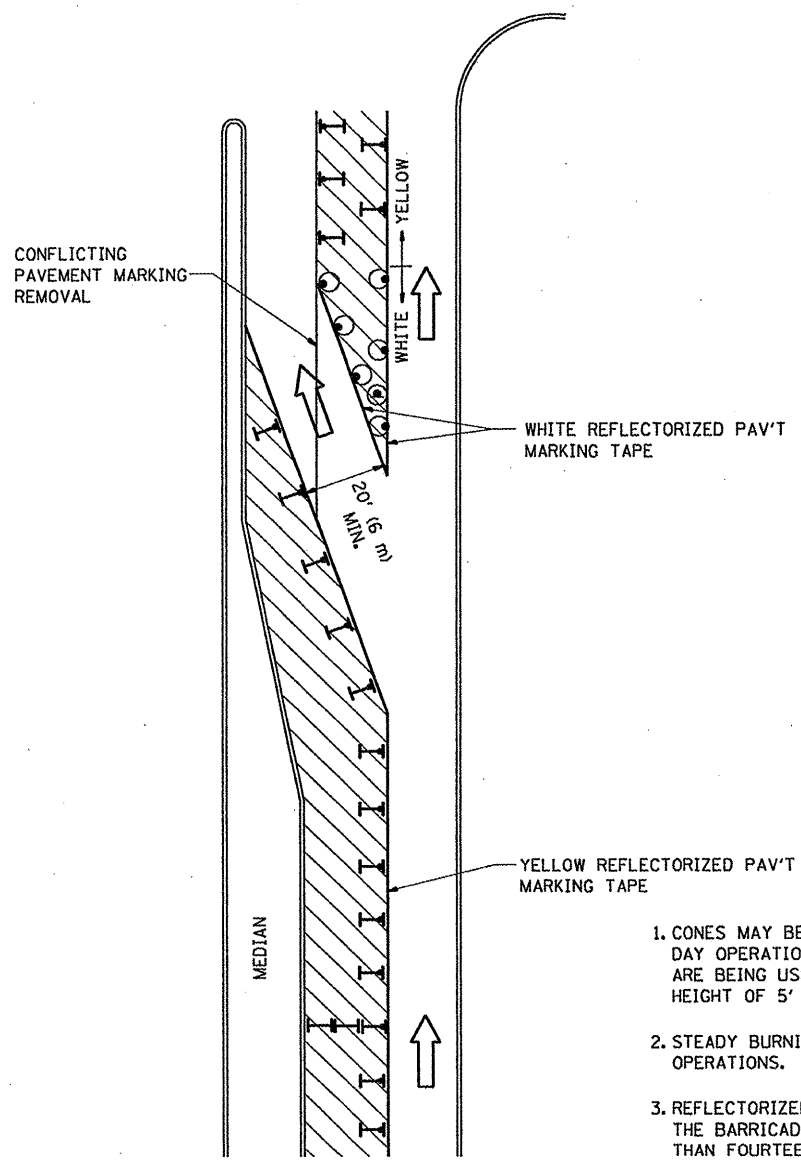

DISTRICT ONE		F.A. RTE. *	SECTION	COUNTY	TOTAL SHEETS	SHEET NO.
TYPICAL PAVEMENT MARKINGS		VAR.	2010-010 RS	DUPAGE	47	44
SCALE: NONE		TC-13		CONTRACT NO. 60K29		
SHEET NO. 1 OF 1 SHEETS		STA. TO STA.		FED. ROAD DIST. NO. 1 ILLINOIS FED. AID PROJECT		

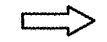

GENERAL NOTES

1. CONES MAY BE SUBSTITUTED FOR BARRICADES OR DRUMS AT HALF THE SPACING DURING DAY OPERATIONS. CONES SHALL BE A MINIMUM OF 28 (710) IN HEIGHT. WHEN CONES ARE BEING USED, THE "LEFT TURN LANE" SIGN MAY BE SKID MOUNTED AT A MINIMUM HEIGHT OF 5' (1.5 m).
2. STEADY BURNING LIGHTS WILL NOT BE REQUIRED ON BARRICADES OR DRUMS FOR DAY OPERATIONS. ALL LIGHTS SHALL BE MONODIRECTIONAL.
3. REFLECTORIZED TEMPORARY PAVEMENT MARKING TAPE SHALL BE PLACED THROUGHOUT THE BARRICADED AREA OF EACH TURN BAY WHERE THE CLOSURE TIME IS GREATER THAN FOURTEEN DAYS.
4. THIS APPLICATION ALSO APPLIES WHEN WORK IS BEING PERFORMED IN THE RIGHT LANE(S) AND THE RIGHT TURN BAY IS TO REMAIN OPEN. UNDER THIS CONDITION, "RIGHT TURN LANE" R3-100 24 x 24 (600 x 600) AND M6-2R 21 x 15 (530 x 380) SHALL BE USED.
5. THESE CONTROLS SHALL SUPPLEMENT MAINLINE TRAFFIC CONTROL FOR LANE CLOSURES.
6. LONGITUDINAL DIMENSIONS MAY BE ADJUSTED TO FIT FIELD CONDITIONS.
7. FORM OPER 725 IS REQUIRED.
8. IF A DRUM OR TYPE II BARRICADE WITH AN ATTACHED SIGN PANEL WHICH MEETS NCHRP 350 REQUIREMENTS IS NOT AVAILABLE, THE SIGNS SHALL BE MOUNTED, ABOVE THE BARRICADES, ON SEPARATE SIGNS SUPPORTS THAT MEET NCHRP 350 REQUIREMENTS.
9. TRAFFIC CONTROL AND PROTECTION AT TURN BAYS (TO REMAIN OPEN TO TRAFFIC) SHALL BE INCLUDED IN THE COST SPECIFIED TRAFFIC CONTROL STANDARDS OR ITEMS.

LEGEND

-  WORK AREA
-  LANE OPEN TO TRAFFIC
-  TYPE I OR II BARRICADE WITH STEADY BURN LIGHT
-  DRUM WITH STEADY BURN LIGHT
-  DRUM WITH SIGN (WITH OPTIONAL FLASHING LIGHT) SEE DETAIL
-  TYPE I OR II CHECK BARRICADE WITH FLASHING LIGHT

All dimensions are in inches (millimeters) unless otherwise shown.

FILE NAME =	USER NAME = whtatar	REVISED - T. RAMMACHER 09-08-94	REVISED - R. BORO 09-14-09	STATE OF ILLINOIS DEPARTMENT OF TRANSPORTATION	TRAFFIC CONTROL AND PROTECTION AT TURN BAYS (TO REMAIN OPEN TO TRAFFIC)			F.A. RTE.	SECTION	COUNTY	TOTAL SHEETS	SHEET NO.
alpha_work\PWIDOT\WHITETAR\d0175544\01s	Std.dgn	REVISED - A. HOUSEH 11-07-95	REVISED -		SCALE: NONE	SHEET NO. 1 OF 1 SHEETS	STA.	TO STA.	2010-010 RS	DUPAGE	47	45
	PLOT SCALE = 100.0000' / IN.	REVISED - A. HOUSEH 10-12-96	REVISED -					TC-14		CONTRACT NO. 60K29		
	PLOT DATE = 2/10/2010	REVISED - T. RAMMACHER 01-06-00	REVISED -					FED. ROAD DIST. NO. 1 ILLINOIS FED. AID PROJECT				

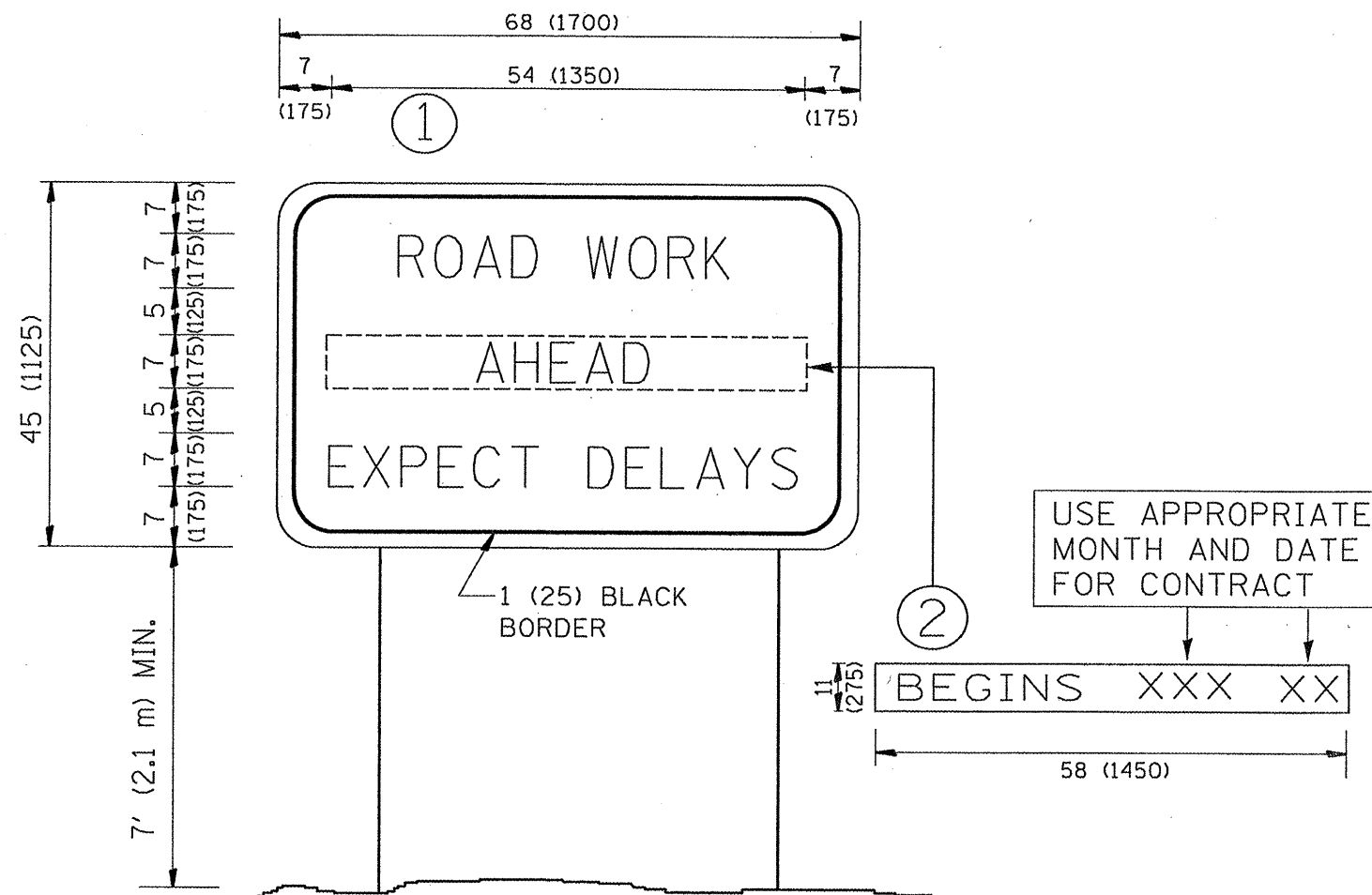

NOTES:

1. USE BLACK LETTERING ON ORANGE BACKGROUND.
2. ERECT SIGNS IN ADVANCE OF THE LOCATION FOR THE "ROAD CONSTRUCTION AHEAD" SIGN AT LOCATIONS AS DIRECTED BY THE ENGINEER.
3. ERECT SIGN ① WITH INSTALLED PANEL ② ONE WEEK PRIOR TO THE START OF CONSTRUCTION.
4. REMOVE PANEL ② SOON AFTER THE START OF CONSTRUCTION.
5. SEE SPECIAL PROVISION FOR "TEMPORARY INFORMATION SIGNING" FOR ADDITIONAL INFORMATION.
6. ONE SIGN ASSEMBLY EQUALS 25.70 SQ. FT. (2.3 SQ. M.)
7. SHALL BE PAID FOR AS TEMPORARY INFORMATION SIGNING.

ALL DIMENSIONS ARE IN INCHES (MILLIMETERS) UNLESS OTHERWISE SHOWN.

FILE NAME =	USER NAME = whitestar	DESIGNED -	REVISED - R. MIRS 09-15-97
ce:\p\work\PMIDOT\WHITETAR\d0175544\Di	Std.dgn	DRAWN -	REVISED - R. MIRS 12-11-97
	PLOT SCALE = 100.0000' / IN.	CHECKED -	REVISED - T. RAMMACHER 02-02-99
	PLOT DATE = 2/10/2010	DATE -	REVISED - C. JUICIUS 01-31-07

**STATE OF ILLINOIS
DEPARTMENT OF TRANSPORTATION**

**ARTERIAL ROAD
INFORMATION SIGN**

SCALE: NONE SHEET NO. 1 OF 1 SHEETS STA. TO STA.

F.A. -	SECTION	COUNTY	TOTAL SHEETS	SHEET NO.
VAR	2010-010 RS	DUPAGE	47	46
TC-22			CONTRACT NO. 60K29	
FED. ROAD DIST. NO. 1 ILLINOIS FED. AID PROJECT				

LOOPS NEXT TO SHOULDERS

PROVIDE A PAVEMENT REPLACEMENT NOTE WHICH SHOULD EQUAL 3' (900 mm) X WIDTH OF PAVED SHOULDER.

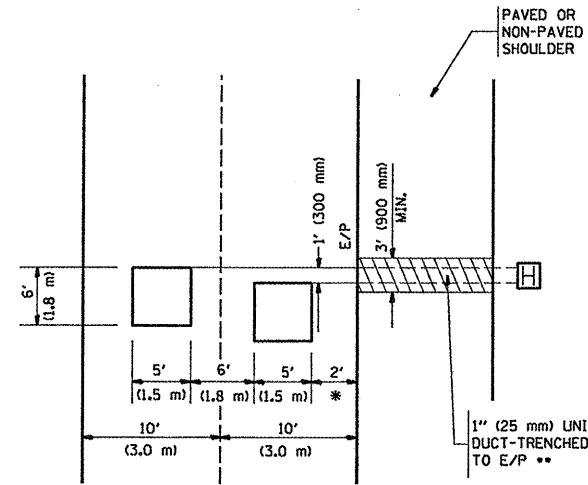

* = (600 mm)

** UNIT DUCT IS TO BE SHOWN ON PLAN SHEETS BUT SHALL NOT BE INCLUDED IN THE PAY ITEMS.

**LEFT TURN LANES WITH MEDIANS
VOLUME DENSITY ("FAR OUT" DETECTION)
ON SAME APPROACH
(PROTECTED / PERMITTED LEFT TURN PHASING)**

HANDHOLE LOCATION MAY VARY DEPENDING ON GEOMETRICS AND DESIGN OF TRAFFIC SIGNALS. HEAVY-DUTY HANDHOLES TO BE USED WHEN THE MEDIAN IS MOUNTABLE. REFER TO STANDARD 814001 TO ENSURE THAT HANDHOLE FITS IN MEDIAN.

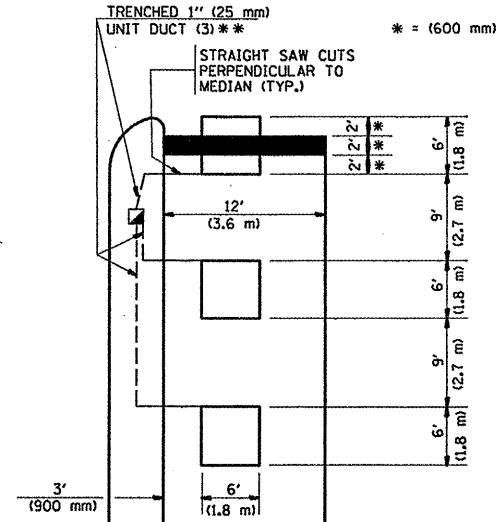

** UNIT DUCT IS TO BE SHOWN ON PLAN SHEETS BUT SHALL NOT BE INCLUDED IN THE PAY ITEMS.

NOTE: DUAL LEFT TURNS NOT SHOWN REFER TO PLAN SHEET FOR DETECTOR LOOP REPLACEMENT

**LEFT TURN LANES WITHOUT MEDIANS
VOLUME DENSITY ("FAR OUT" DETECTION)
ON SAME APPROACH
(PROTECTED / PERMITTED LEFT TURN PHASING)**

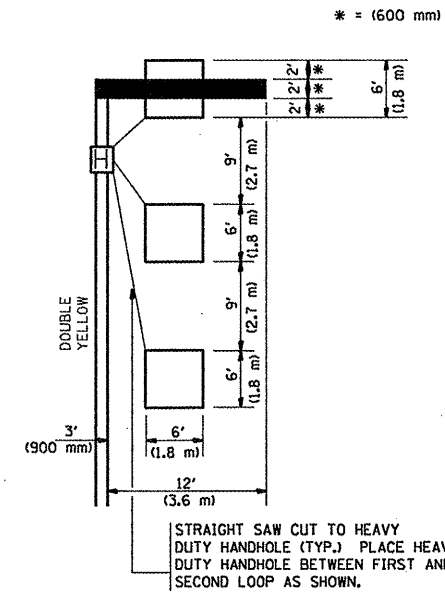

NOTE: DUAL LEFT TURNS NOT SHOWN REFER TO PLAN SHEET FOR DETECTOR LOOP REPLACEMENT.

**ARTERIAL-VOLUME DENSITY ("FAR OUT" DETECTION)
CROSS STREET-VOLUME DENSITY ("FAR OUT" DETECTION)**

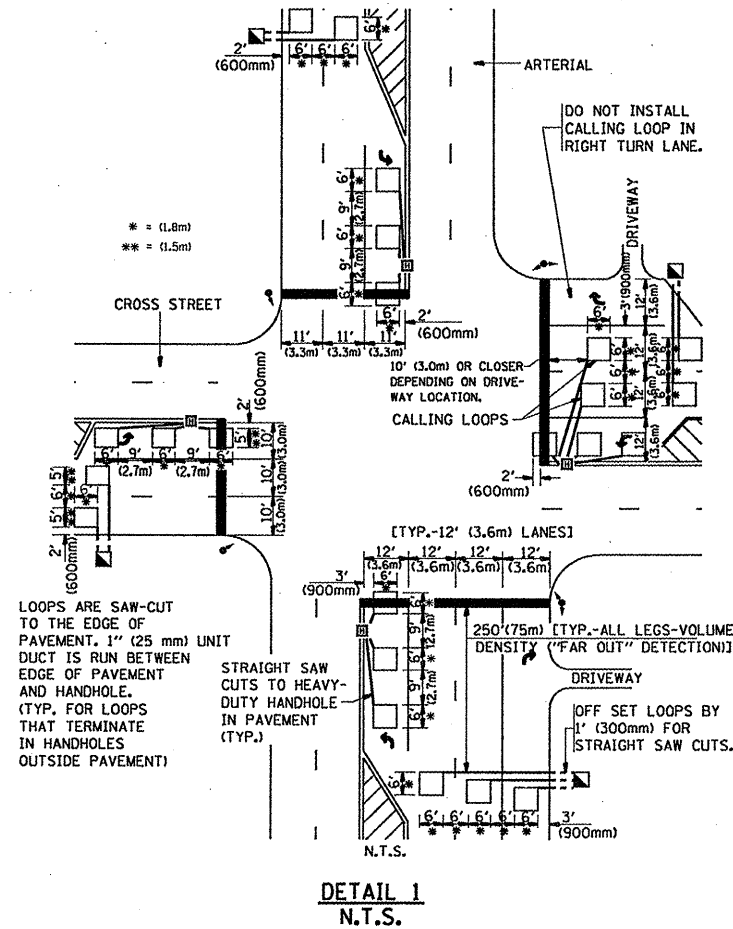

DETAIL 1
N.T.S.

**ARTERIAL-VOLUME DENSITY ("FAR OUT" DETECTION)
CROSS STREET-NON VOLUME DENSITY ("UPTIGHT" PRESENCE DETECTION)**

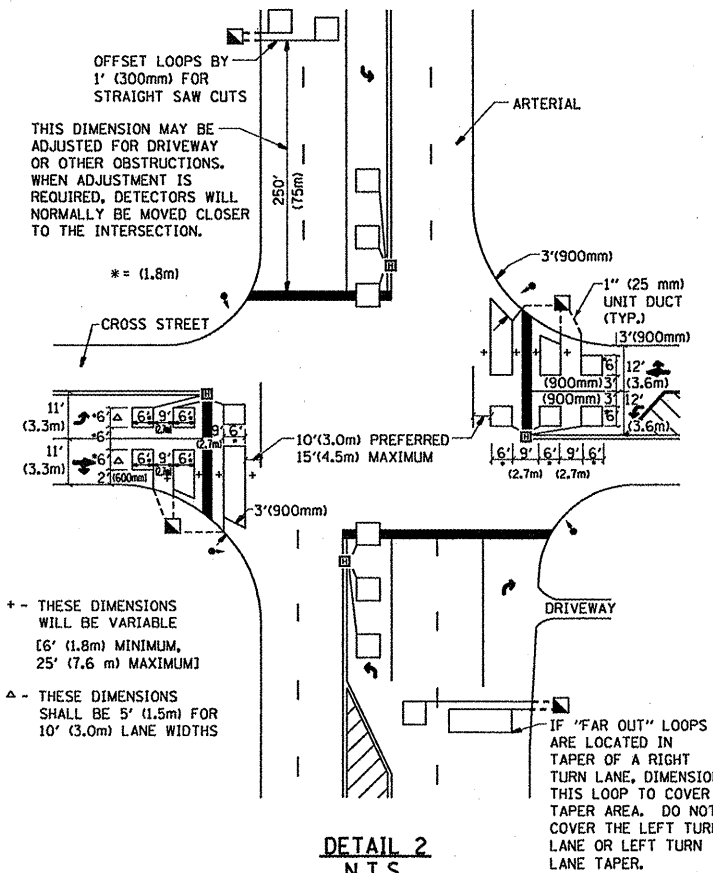

DETAIL 2
N.T.S.

NOTES:

VEHICLES LOOP DETECTORS

- * ALL LEAD IN CABLE SHALL BE TWO CONDUCTOR NO. 14 TWISTED, SHIELDED.
- * EACH DETECTOR LOOP SHALL HAVE ITS OWN SAW CUT FROM THE LOOP TO THE EDGE OF PAVEMENT OR TO A HANDHOLE IN THE PAVEMENT.
- * EACH DETECTOR LOOP SHALL HAVE ITS OWN ONE INCH (25 mm) UNIT DUCT BETWEEN THE EDGE OF PAVEMENT AND THE FIRST HANDHOLE OR JUNCTION BOX. EACH UNIT DUCT RUN SHALL BE SHOWN ON THE PLANS BY THE DESIGNER, BUT SHALL NOT BE PAID FOR SEPARATELY. THIS ITEM IS INCIDENTAL TO THE PAY ITEM FOR DETECTOR LOOPS.
- * ONE DIMENSION OF ALL DETECTOR LOOPS SHALL BE SIX FEET (1.8 m)
- * EACH LANE OF NON-LOCKING, PRESENCE DETECTION AND EACH LANE OF A DOUBLE LEFT TURN LANE REQUIRES A SEPARATE INDUCTIVE LOOP DETECTOR AND LEAD IN CABLE.
- * WHEN NON-LOCKING, PRESENCE DETECTION IS USED, MORE THAN ONE LOOP PER LANE IS REQUIRED BEHIND THE STOP BAR (i.e. 1-1/2, 1-3/4, 2).
- * WHEN SYSTEM LOOPS ARE REQUIRED ON AN APPROACH OF AN INTERSECTION, THE LOOPS USED FOR VOLUME DENSITY AND INTERSECTION TIMING SHALL ALSO BE USED AS SYSTEM DETECTORS. EACH ONE OF THESE TYPES OF LOOPS REQUIRES A SEPARATE TWO CONDUCTOR NO. 14 TWISTED SHIELDED CABLE AND A SEPARATE INDUCTIVE LOOP DETECTOR WHEN NEW CONTROLLERS ARE UTILIZED. THE DESIGNER SHALL LABEL THESE TYPES OF LOOPS AS "INTERSECTION AND SAMPLING (SYSTEM) DETECTORS" ON THE SIGNAL LAYOUT, THE INTERCONNECT PLAN AND THE SYSTEM CABLE PLAN. WHEN AN EXISTING CONTROLLER IS UTILIZED FOR THIS TYPE OF DETECTION, THE PAY ITEM "INDUCTIVE LOOP DETECTOR WITH SYSTEM OUTPUT" SHOULD BE USED.

PLACEMENT OF DETECTORS

THE FOLLOWING FIGURES REPRESENT THE MOST COMMON DETECTOR LOOP LOCATIONS AND SIZES. ADJUSTMENTS WILL BE NECESSARY FOR SPECIFIC GEOMETRIC CONSIDERATIONS.

LOCATIONS AND DEMENSIONS OF DETECTOR LOOPS ARE REQUIRED ON ALL SIGNAL LAYOUT PLAN SHEETS.

"FAR OUT" DETECTION REFERS TO LOCKING, PRESENCE TYPE DETECTION LOCATED IN THRU LANES, RIGHT TURN LANES, AND RIGHT TURN LANE TAPER AREAS (IF APPLICABLE), USUALLY 250' (75 m) IN ADVANCE OF STOP BARS. "UPTIGHT" DETECTION REFERS TO NON-LOCKING PRESENCE TYPE DETECTION LOCATED IN ALL LANES AND 10'-15' (3.0 m-4.5 m) BEHIND THE CROSSING STREET'S EDGE OF PAVEMENT EXTENDED.

NOTE:

ALL DETAILS AND NOTES SHOWN ARE FROM THE I.D.O.T. DISTRICT 1 TRAFFIC SIGNAL DESIGN GUIDELINES DATED JANUARY 1995

THIS DRAWING HAS BEEN PREPARED TO ASSIST THE RESIDENT ENGINEER FOR ALL ROADWAY RESURFACING OR S.M.A.R.T. PROJECTS WHERE THE DIMENSIONS ARE NOT SHOWN ON THE PLANS AND THE FINAL LOCATIONS FOR CROSSWALKS OR STOP BARS ARE NOT DETERMINED.

FILE NAME =	USER NAME = whitetar	DESIGNED -	REVISED -
ca:\pwwork\p\WIDOT\WHITETAR\d0175544\Di	Std.dgn	DRAWN -	REVISED -
		CHECKED - R.K.F.	REVISED -
		DATE -	REVISED -

STATE OF ILLINOIS DEPARTMENT OF TRANSPORTATION	
---	--

DISTRICT 1 - DETECTOR LOOP INSTALLATION			
DETAILS FOR ROADWAY RESURFACING			
SCALE: NONE	SHEET NO. 1 OF 1 SHEETS	STA.	TO STA.

F.A. RTE.	SECTION	COUNTY	TOTAL SHEETS	SHEET NO.
VAR	2010-010 RS	DUPAGE	47	47
TS-07			CONTRACT NO.	60K29
FED. ROAD DIST. NO. 1 ILLINOIS FED. AID PROJECT				