

TYPICAL SECTION - STAGE II
SOUTH BOUND
(SECTION LOOKING NORTH)
STA. 42+50 TO STA. 76+50

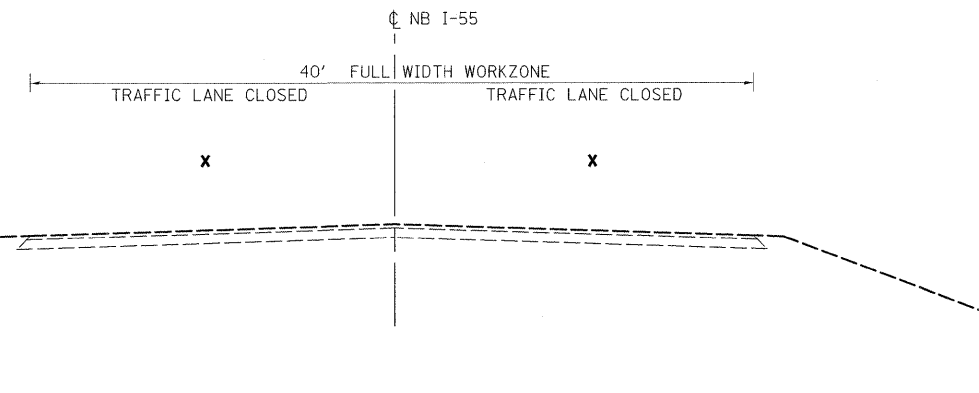

TYPICAL SECTION - STAGE II
(SECTION LOOKING NORTH)
STA. 42+50 TO STA. 76+50

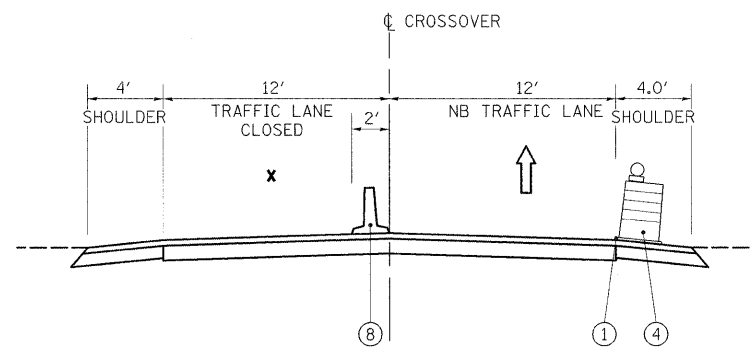

CROSSOVER TYPICAL SECTION - STAGE II
SOUTH BOUND PEAK
(SECTION LOOKING NORTH)
STA. 33+50 TO STA. 42+50
STA. 76+50 TO STA. 87+50

STAGE II (FOR WORK AT NB I-55 BRIDGE)

1. USING DAY LANE CLOSURE, PATCH AND REPAIR ANY NEEDED AREAS OF SOUTHBOUND BRIDGE DECK OR AS DIRECTED BY THE ENGINEER. THIS WORK WILL BE PAID FOR AS BITUMINOUS CONCRETE REMOVAL (DECK) (1 1/2 INCH), BITUMINOUS MATERIALS (PRIME COAT) AND INCIDENTAL BITUMINOUS SURFACING.
2. SHIFT TRAFFIC ONTO SOUTHBOUND PAVEMENT IN ACCORDANCE WITH TRAFFIC PLAN AND DISTRICT ONE STANDARD TC-09 "FREEWAY SINGLE AND MULTILANE WEAVE".
3. PERFORM STRUCTURAL REHABILITATION ON NB 1-55 BRIDGE.
4. LANDSCAPE RESTORATION.
5. TEMPORARY STRIPE PAVEMENT.

LEGEND

- ① WET REFLECTIVE TEMPORARY TAPE TYPE III, 4" WHITE EDGE LINE
- ② WET REFLECTIVE TEMPORARY TAPE TYPE III, 4" YELLOW EDGE LINE
- ③ PAVEMENT MARKING REMOVAL
- ④ DRUMS WITH STEADY BURNING MONODIRECTIONAL LIGHT
- ⑤ EXISTING PAVEMENT MARKING, WHITE EDGE LINE
- ⑥ EXISTING PAVEMENT MARKING, YELLOW EDGE LINE
- ⑦ VERTICAL PANELS (BACK TO BACK)
- ⑧ TEMPORARY CONCRETE BARRIER
- ⑨ WET REFLECTIVE TEMPORARY TAPE TYPE III, 4" WHITE (10' LINE, 30' SPACE) LINE
- ⑩ EXISTING PAVEMENT MARKING, WHITE LANE LINE (10' LINE, 30' SKIP)

DESIGNED - KSD	REVISED -
DRAWN - KSD	REVISED -
CHECKED - CMJ	REVISED -
DATE - 03-04-09	REVISED -

F.A.J. RTE.	SECTION	COUNTY	TOTAL SHEETS	SHEET NO.
55	88 (B&B-1) BR	WILL	72	11
FED. ROAD DIST. NO. 1 ILLINOIS FED. AID PROJECT			CONTRACT NO. 62930	