

- LEGEND**
- ① WET REFLECTIVE TEMPORARY TAPE TYPE III, 4" WHITE EDGE LINE
  - ② WET REFLECTIVE TEMPORARY TAPE TYPE III, 4" YELLOW EDGE LINE
  - ③ NOT USED
  - ④ DRUMS WITH STEADY BURNING MONODIRECTIONAL LIGHT
  - ⑤ NOT USED
  - ⑥ NOT USED
  - ⑦ VERTICAL PANELS (BACK TO BACK)
  - ⑧ TEMPORARY CONCRETE BARRIER
  - ⑨ WET REFLECTIVE TEMPORARY TAPE TYPE III, 4" WHITE (10' LINE, 30' SPACE) LINE
- TEMPORARY CONCRETE BARRIER  
 TEMPORARY CONCRETE BARRIER WITH MODULAR GLARE SCREEN

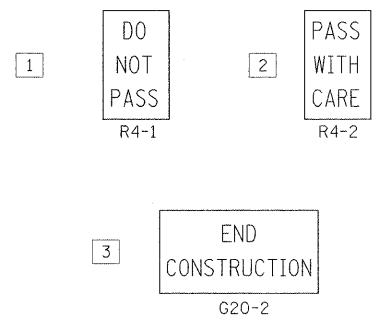

← ADVANCED LANE CLOSURE SIGNING TO BE IN ACCORDANCE WITH STANDARD 701400-03 → LANE CLOSURE TRAFFIC CONTROL (INCLUDING SIGNING) TO BE IN ACCORDANCE WITH STANDARD 701416-06 →

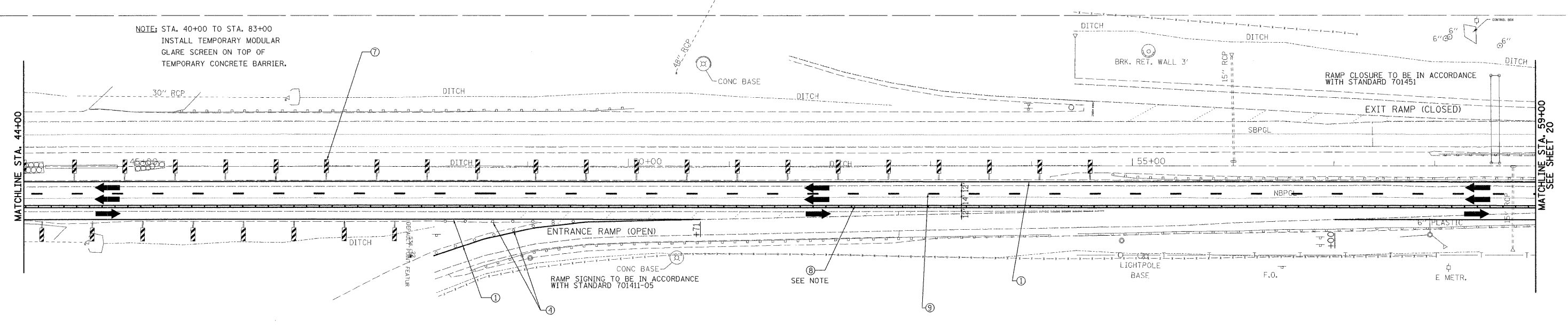
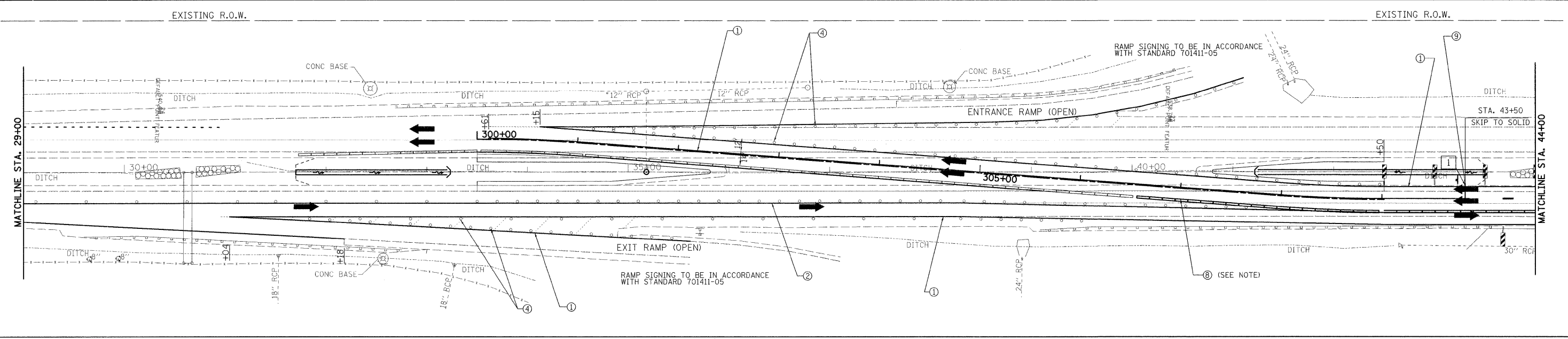

<p>200 West Front Street Wheaton, IL 60187</p>	DESIGNED - KSD	REVISED -	<b>STATE OF ILLINOIS</b> <b>DEPARTMENT OF TRANSPORTATION</b>	<b>I-55 OVER THE KANKAKEE RIVER</b> <b>TRAFFIC CONTROL PLAN STAGE III</b>		F.A.I. RTE. 55	SECTION 88 (B&B-1) BR	COUNTY WILL	TOTAL SHEETS 72	SHEET NO. 15		
	DRAWN - KSD	REVISED -		SCALE: 1" = 50'	SHEET NO. 1 OF 2 SHEETS	STA. 29+00.00 TO STA. 59+00.00	FED. ROAD DIST. NO. 1 ILLINOIS FED. AID PROJECT					
	CHECKED - CMJ	REVISED -										
	DATE - 03-04-09	REVISED -		CONTRACT NO. 62930								