

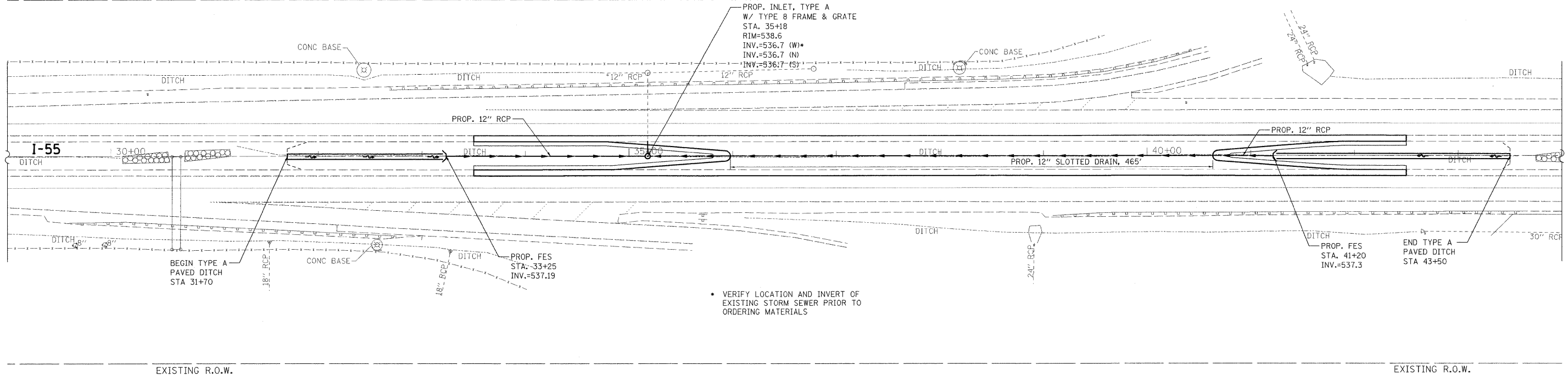

EXISTING R.O.W.

EXISTING R.O.W.



• VERIFY LOCATION AND INVERT OF EXISTING STORM SEWER PRIOR TO ORDERING MATERIALS

EXISTING R.O.W.

EXISTING R.O.W.

PLAN	SURVEYED	DATE
	PLOTTED	BY
	CHECKED	
	RT. OF WAY CHECKED	
	PAID FILE NAME	

PROFILE	SURVEYED	DATE
	PLOTTED	BY
	CHECKED	
	STRUCTURE NOTATIONS CHK'D	

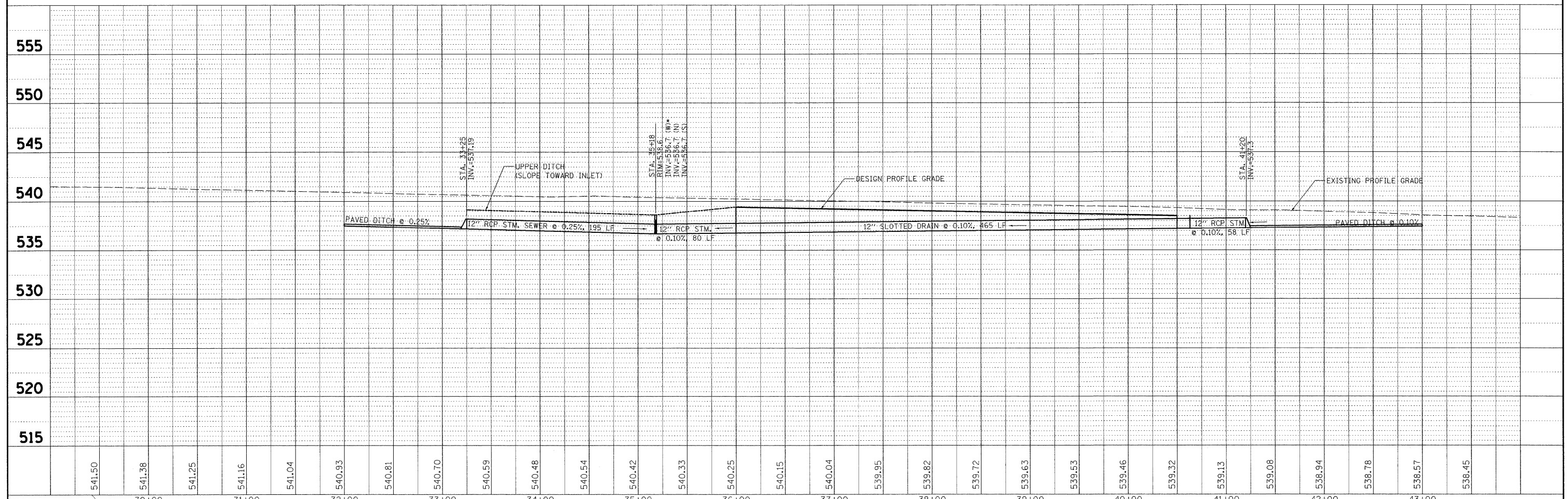

541.50	541.38	541.25	541.16	541.04	540.93	540.81	540.70	540.59	540.48	540.54	540.42	540.33	540.25	540.15	540.04	539.95	539.82	539.72	539.63	539.53	539.46	539.32	539.13	539.08	538.94	538.78	538.57	538.45
	30+00	31+00	32+00	33+00	34+00	35+00	36+00	37+00	38+00	39+00	40+00	41+00	42+00	43+00														



200 West Front Street
Wheaton, IL 60187

DESIGNED	-	REVISED	-
DRAWN	-	REVISED	-
CHECKED	-	REVISED	-
DATE	-	REVISED	-

STATE OF ILLINOIS
DEPARTMENT OF TRANSPORTATION

**SOUTH CROSSOVER
DRAINAGE PLAN & PROFILE**

SCALE: 1" = 50' SHEET NO. 1 OF 2 SHEETS STA. 29+00.00 TO STA. 44+00.00

F.A.I. RTE.	SECTION	COUNTY	TOTAL SHEETS	SHEET NO.
55	BB (B&B-1) BR	WILL	72	22
CONTRACT NO. 62930				
ILLINOIS FED. AID PROJECT				