

F.A.P. RTE.	SECTION	COUNTY	TOTAL SHEETS	SHEET NO.
1285	02-00075-00-PV	COOK	161	30
STA. _____ TO STA. _____				
FED. ROAD DIST. NO. - ILLINOIS FED. AID PROJECT				
CONTRACT NO. 63083				

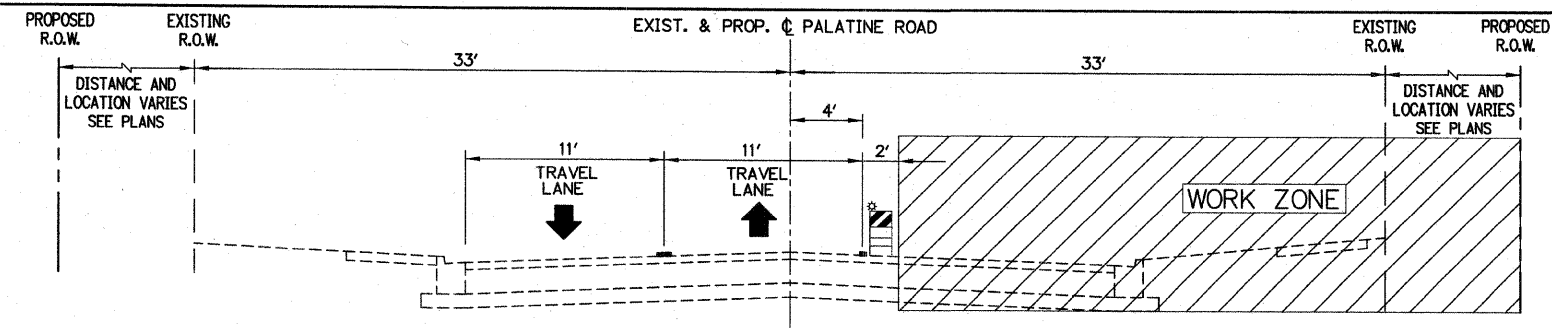

STA. 203+00.00 TO STA. 215+90.00
PALATINE ROAD - S T A G E I

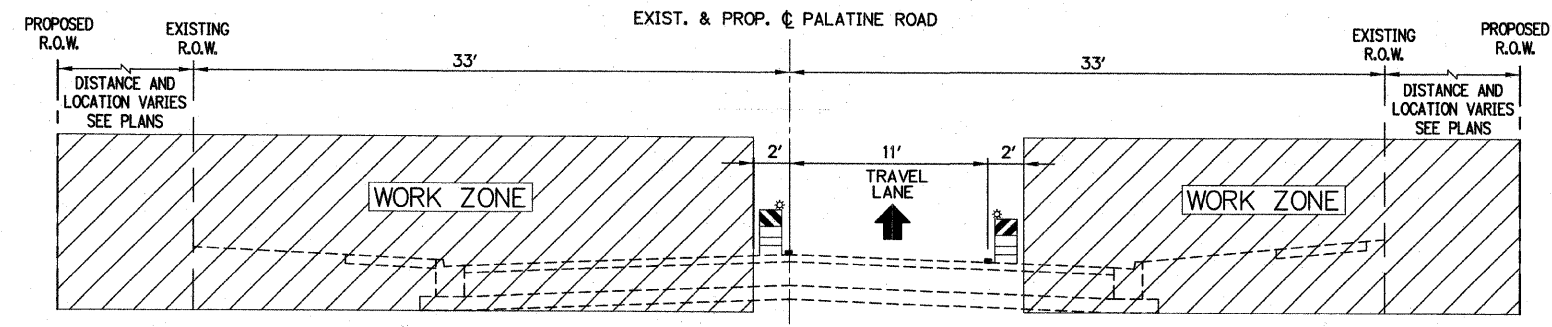

STA. 216+25.00 TO STA. 222+30.00
PALATINE ROAD - S T A G E I

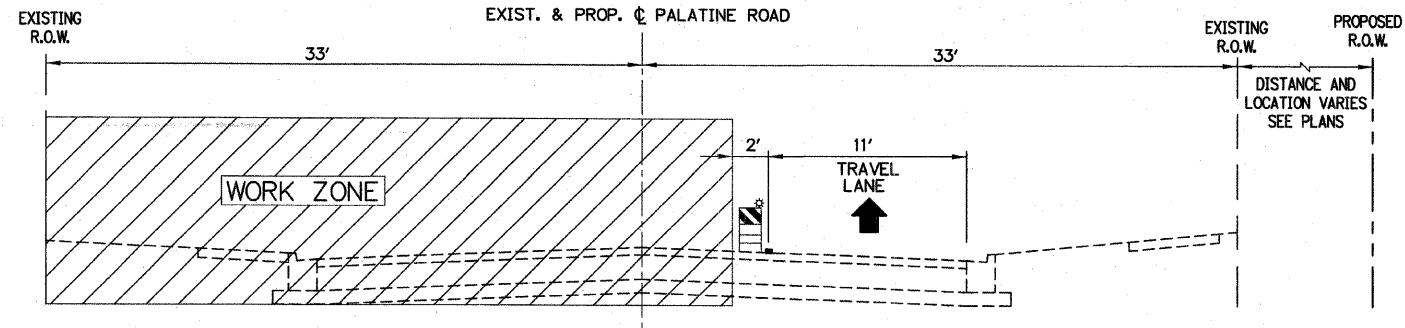

STA. 222+75.00 TO STA. 239+03.00
PALATINE ROAD - S T A G E I

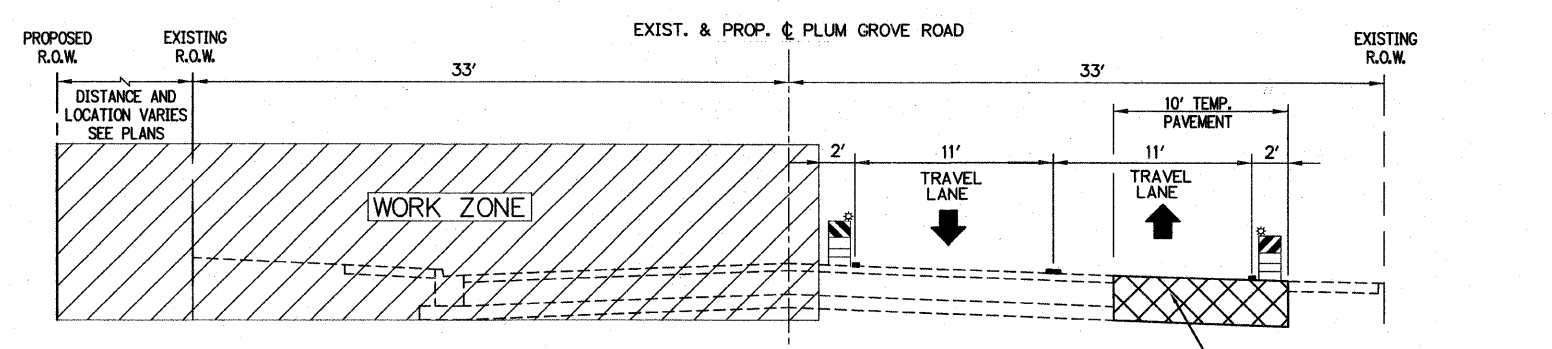

STA. 51+75.00 TO STA. 57+90.00
PLUM GROVE ROAD - S T A G E I

HOT-MIX ASPHALT BINDER,
IL-19.0 mm, 10"

TRAFFIC STAGING SEQUENCE NOTES

PALATINE ROAD
SMITH STREET TO KERWOOD STREET

PLUM GROVE ROAD
WASHINGTON STREET TO SLADE STREET

DETOUR FOR THE PROJECT:

- CONTRACTOR SHALL IMPLEMENT THE DETOUR ROUTE AND AS PERTINANT SIGNAGE FOR THE WESTBOUND TRAFFIC PRIOR TO START OF STAGE ONE CONSTRUCTION.

PRE-STAGE ON PLUM GROVE ROAD SOUTH LEG:

- RELOCATE ALL UTILITY POLES TO THE BACK OF R.O.W.
- RELOCATE/REMOVE LIGHT POLES, RETAINING WALLS AND SIGN POSTS.
- REMOVE EXISTING CURB AND CURB & GUTTER.
- CONSTRUCT 10' WIDE TEMPORARY PAVEMENT FROM STA. 51+40 TO STA. 57+80 ON THE EAST SIDE OF PLUM GROVE ROAD.

S T A G E I

PALATINE ROAD

- SHIFT TRAFFIC TO THE NORTH SIDE OF PALATINE ROAD
- MAINTAIN ONE 11 FEET LANES IN EACH DIRECTION FROM THE BEGINNING OF THE PROJECT TO PLUM GROVE ROAD.
- IMPLEMENT ONE-WAY TRAFFIC EASTBOUND ON PALATINE ROAD. THE WESTBOUND TRAFFIC WILL BE DETOURED AS SHOWN ON PLAN SHEET MT-7.
- CONSTRUCT CURB AND GUTTER ON EASTBOUND LANE
- CONSTRUCT MAIN LINE STORM SEWER & WATER MAIN
- RECONSTRUCT SIDE STREETS INCLUDING CURB AND GUTTER. SUB-STAGING WILL BE REQUIRED. THE CONTRACTOR SHALL KEEP A MINIMUM OF ONE LANE OPEN AT ALL TIMES.

S T A G E I

PLUM GROVE ROAD SOUTH LEG:

- SHIFT TRAFFIC ONTO TEMPORARY PAVEMENT ON THE EAST SIDE OF PLUM GROVE ROAD AND MAINTAIN TWO 11-FOOT LANES IN EACH DIRECTION.
- RECONSTRUCT PAVEMENT ON THE WEST SIDE PLUM GROVE ROAD
- CONSTRUCT CURB AND GUTTER ON WEST SIDE OF THE ROAD.
- CONSTRUCT MAIN LINE STORM SEWER & WATER MAIN
- RECONSTRUCT SIDE STREETS INCLUDING CURB AND GUTTER. SUB-STAGING WILL BE REQUIRED. THE CONTRACTOR SHALL KEEP A MINIMUM OF ONE LANE OPEN AT ALL TIMES.

CONSTRUCTION TRAFFIC CONTROL GENERAL NOTES

1. TRAFFIC CONTROL SHALL BE PERFORMED IN ACCORDANCE WITH THE STANDARD SPECIFICATIONS FOR ROAD AND BRIDGE CONSTRUCTION, THE ILLINOIS MANUAL ON UNIFORM TRAFFIC CONTROL DEVICES AND THE APPLICABLE HIGHWAY STANDARDS OR AS HEREIN SPECIFIED.
2. THE WORK ZONE WILL BE DELINEATED AT ALL TIMES THROUGHOUT CONSTRUCTION BY TYPE II BARRICADES WITH MONODIRECTIONAL STEADY BURN LIGHTS. THE BARRICADES SHALL BE PLACED IN EXCAVATED AREAS SHALL HAVE LEG EXTENSIONS INSTALLED SUCH THAT THE TOP OF THE BARRICADE IS IN COMPLIANCE WITH THE HEIGHT REQUIREMENTS OF STANDARD 701901.
3. OPPOSING LANES OF TRAFFIC WILL BE DELINEATED AT ALL TIMES THROUGHOUT CONSTRUCTION BY TWO 4 INCHES YELLOW TEMPORARY PAVEMENT MARKING LINES AT 11 INCHES CENTERS.
4. THE COST OF FURNISHING, INSTALLING, MAINTAINING, RELOCATING AND REMOVING ALL TRAFFIC CONTROL DEVICES INCLUDING BUT NOT LIMITED TO: BARRICADES, VERTICAL PANELS, FLEXIBLE DELINEATORS, CONSTRUCTION SIGNS, WARNING LIGHTS, FLAGMEN, AND ALL OTHER MISCELLANEOUS DEVICES USED FOR THE PURPOSE OF RELOCATING OR DIRECTING TRAFFIC DURING CONSTRUCTION OF THIS IMPROVEMENT WILL BE INCLUDED IN THE CONTRACT LUMP SUM PRICE FOR TRAFFIC CONTROL AND PROTECTION (SPECIAL).
5. WHERE PROVIDED, EXISTING TRAFFIC SIGNS SHALL BE RELOCATED FOR EACH CONSTRUCTION STAGE.
6. ACCESS TO DRIVEWAYS AND SIDE ROADS IS TO BE MAINTAINED DURING CONSTRUCTION. ANY DELAYS OR INCONVENIENCE CAUSED BY THE CONTRACTOR BY COMPLYING WITH THESE REQUIREMENTS SHALL BE CONSIDERED AS INCIDENTAL TO THE CONTRACT AND NO ADDITIONAL COMPENSATION WILL BE ALLOWED.
7. ALL APPLICABLE PORTIONS OF TRAFFIC CONTROL STANDARDS 701301, 701311, 701501, 701502, 701601, 701602, 701606, 701701, 701801, 701901 AND IDOT DISTRICT ONE STANDARDS TC-10 AND TC-16 SHALL APPLY DURING ALL STAGES AND ALL SUB STAGES THAT ARE NOT SPECIFIED.
8. A SINGLE LANE CLOSURE WITH FLAGMEN AT WORK ZONES WILL ONLY BE ALLOWED BETWEEN 9:00AM AND 3:00 PM.

REVISIONS	
NAME	DATE

ILLINOIS DEPARTMENT OF TRANSPORTATION
VILLAGE OF PALATINE
PALATINE ROAD & PLUM GROVE ROAD RECONSTRUCTION
SMITH STREET TO US 14 (NORTHWEST HIGHWAY)
**PALATINE ROAD & PLUM GROVE ROAD
MAINTENANCE OF TRAFFIC SECTION
STAGE I**

SCALE: VERT. N.T.S. DRAWN BY JPW
 HORIZ. N.T.S. CHECKED BY BA
DATE: OCTOBER 19, 2009