

F.A.P. RTE.	SECTION	COUNTY	TOTAL SHEETS	SHEET NO.
1285	02-00075-00-PV	COOK	161	31
STA. _____ TO STA. _____		FED. ROAD DIST. NO. - ILLINOIS FED. AID PROJECT		
CONTRACT NO. 63083				

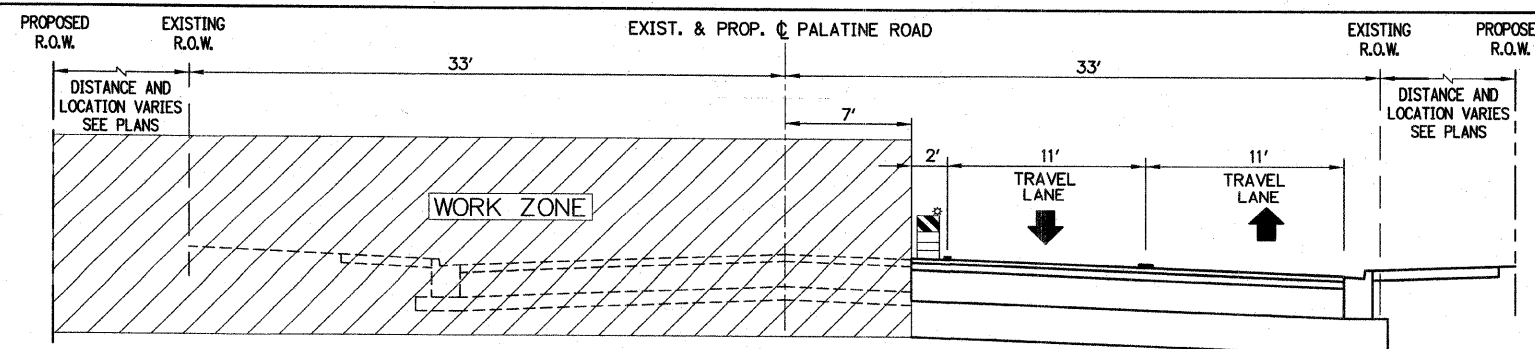

STA. 203+00.00 TO STA. 215+90.00  
PALATINE ROAD - STAGE I

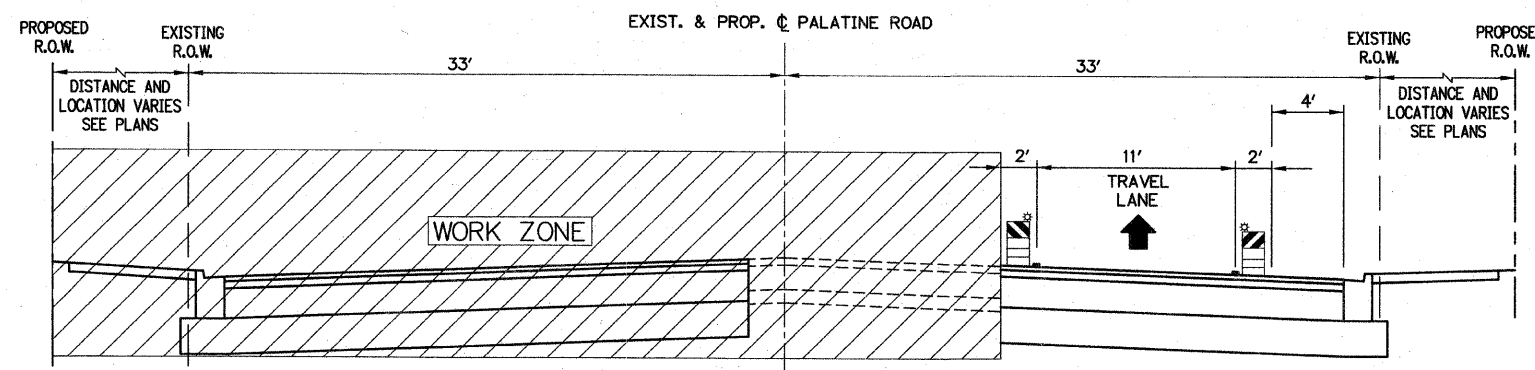

STA. 216+25.00 TO STA. 222+30.00  
PALATINE ROAD - STAGE II

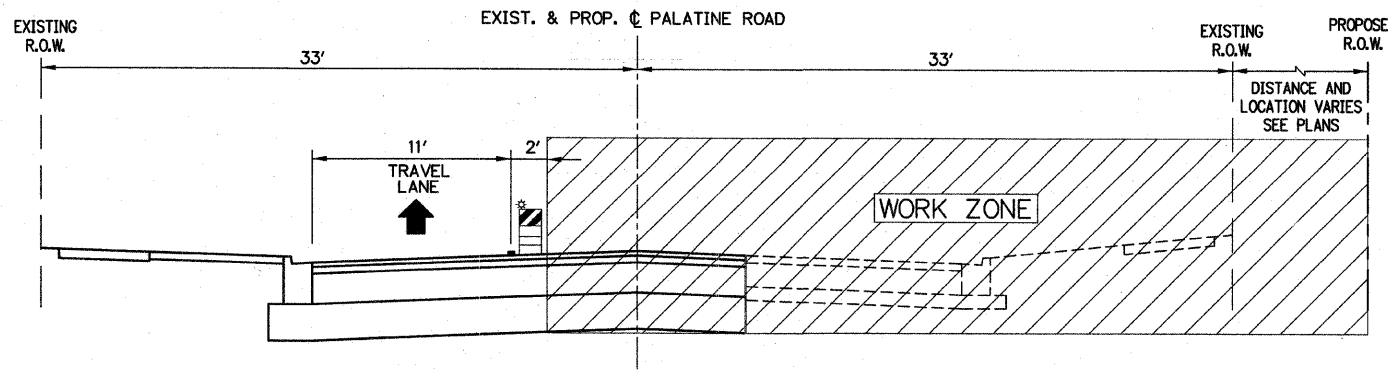

STA. 222+75.00 TO STA. 239+03.00  
PALATINE ROAD - STAGE II

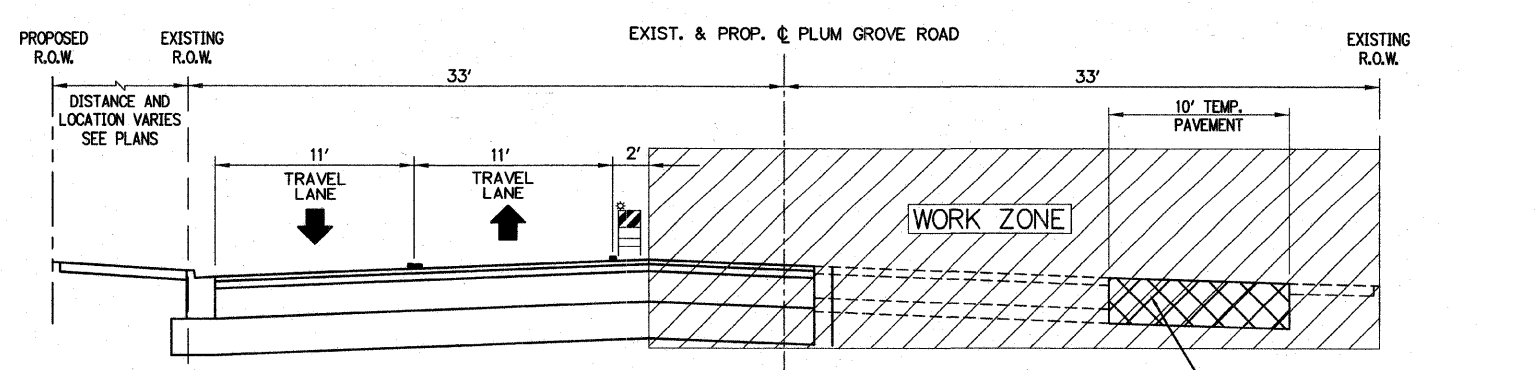

STA. 51+75.00 TO STA. 57+90.00  
PLUM GROVE ROAD - STAGE II

HOT-MIX ASPHALT BINDER, IL-19.0 mm, 10"

**TRAFFIC STAGING SEQUENCE NOTES**

PALATINE ROAD  
SMITH STREET TO KERWOOD STREET

PLUM GROVE ROAD  
WASHINGTON STREET TO SLADE STREET

**PRE-STAGE ON PLUM GROVE ROAD NORTH LEG:**

- CLOSE NORTH LEG OF PLUM GROVE ROAD FROM PALATINE ROAD TO SOUTH OF SLADE STREET FOR THE DURATION SPECIFIED BY THE UNION PACIFIC RAILROAD AUTHORITIES. THE SOUTHBOUND TRAFFIC ON PLUM GROVE ROAD WILL BE DETOURED AS SHOWN ON PLAN SHEET MT-8.

**STAGE II**

PALATINE ROAD

- SHIFT TRAFFIC TO THE SOUTH SIDE OF PALATINE ROAD
- MAINTAIN ONE 11 FEET LANES IN EACH DIRECTION FROM THE BEGINNING OF THE PROJECT TO PLUM GROVE ROAD.
- IMPLEMENT ONE-WAY TRAFFIC EASTBOUND ON PALATINE ROAD FROM EDGE OF PLUM GROVE ROAD. THE WESTBOUND TRAFFIC WILL BE DETOURED AS SHOWN ON PLAN SHEET MT-7.
- CONSTRUCT CURB AND GUTTER ON WESTBOUND LANE
- COMPLETE MAIN LINE STORM SEWER & WATER MAIN
- RECONSTRUCT SIDE STREETS INCLUDING CURB AND GUTTER. SUB-STAGING WILL BE REQUIRED. THE CONTRACTOR SHALL KEEP A MINIMUM OF ONE LANE OPEN AT ALL TIMES.

**STAGE II**

PLUM GROVE ROAD SOUTH LEG:

- SHIFT TRAFFIC ONTO NEWLY CONSTRUCTED PAVEMENT ON THE WEST SIDE OF PLUM GROVE ROAD AND MAINTAIN TWO 11-FOOT LANES IN EACH DIRECTION.
- RECONSTRUCT PAVEMENT ON THE EAST SIDE PLUM GROVE ROAD
- CONSTRUCT CURB AND GUTTER ON EAST SIDE OF THE ROAD.
- COMPLETE MAIN LINE STORM SEWER & WATER MAIN
- RECONSTRUCT SIDE STREETS INCLUDING CURB AND GUTTER. SUB-STAGING WILL BE REQUIRED. THE CONTRACTOR SHALL KEEP A MINIMUM OF ONE LANE OPEN AT ALL TIMES.

**STAGE III (NO PLANS HAVE BEEN SHOWN)**

PALATINE ROAD & PLUM GROVE ROAD

STAGE III CONSTRUCTION WILL ONLY BE APPLICABLE TO PALATINE ROAD FROM STA. 203+00.00 TO STA. 215+90.00

ALL THE OTHER PORTIONS OF THE PALATINE ROAD AND THE PLUM GROVE ROAD WILL BE COMPLETED UNDER STAGE II CONSTRUCTIONS. SEE STAGE II TYPICAL SECTIONS ON THIS SHEET.

- SHIFT TRAFFIC TO THE NEWLY CONSTRUCTED OUTSIDE LANES OF PALATINE ROAD.
- MAINTAIN ONE 12 FEET LANE IN EACH DIRECTION.
- CONSTRUCT THE MEDIAN FROM STA. 214+40 TO STA. 215+22
- COMPLETE STORM SEWER LATERAL CONNECTIONS.
- COMPLETE PAVEMENT AND LEFT-TURN LANES UTILIZING STANDARDS 701502-02 AND 701606-03.

**CONSTRUCTION TRAFFIC CONTROL GENERAL NOTES**

1. TRAFFIC CONTROL SHALL BE PERFORMED IN ACCORDANCE WITH THE STANDARD SPECIFICATIONS FOR ROAD AND BRIDGE CONSTRUCTION, THE ILLINOIS MANUAL ON UNIFORM TRAFFIC CONTROL DEVICES AND THE APPLICABLE HIGHWAY STANDARDS OR AS HEREIN SPECIFIED.
2. THE WORK ZONE WILL BE DELINEATED AT ALL TIMES THROUGHOUT CONSTRUCTION BY TYPE II BARRICADES WITH MONODIRECTIONAL STEADY BURN LIGHTS. THE BARRICADES SHALL BE PLACED AT 50 FEET CENTERS. BARRICADES THAT MUST BE PLACED IN EXCAVATED AREAS SHALL HAVE LEG EXTENSIONS INSTALLED SUCH THAT THE TOP OF THE BARRICADE IS IN COMPLIANCE WITH THE HEIGHT REQUIREMENTS OF STANDARD 701901.
3. OPPOSING LANES OF TRAFFIC WILL BE DELINEATED AT ALL TIMES THROUGHOUT CONSTRUCTION BY TWO 4 INCHES YELLOW TEMPORARY PAVEMENT MARKING LINES AT 11 INCHES CENTERS.
4. THE COST OF FURNISHING, INSTALLING, MAINTAINING, RELOCATING AND REMOVING ALL TRAFFIC CONTROL DEVICES INCLUDING BUT NOT LIMITED TO: BARRICADES, VERTICAL PANELS, FLEXIBLE DELINEATORS, CONSTRUCTION SIGNS, WARNING LIGHTS, FLAGMEN, AND ALL OTHER MISCELLANEOUS DEVICES USED FOR THE PURPOSE OF RELOCATING OR DIRECTING TRAFFIC DURING CONSTRUCTION OF THIS IMPROVEMENT WILL BE INCLUDED IN THE CONTRACT LUMP SUM PRICE FOR TRAFFIC CONTROL AND PROTECTION (SPECIAL).
5. WHERE PROVIDED, EXISTING TRAFFIC SIGNS SHALL BE RELOCATED FOR EACH CONSTRUCTION STAGE.
6. ACCESS TO DRIVEWAYS AND SIDE ROADS IS TO BE MAINTAINED DURING CONSTRUCTION. ANY DELAYS OR INCONVENIENCE CAUSED BY THE CONTRACTOR BY COMPLYING WITH THESE REQUIREMENTS SHALL BE CONSIDERED AS INCIDENTAL TO THE CONTRACT AND NO ADDITIONAL COMPENSATION WILL BE ALLOWED.
7. ALL APPLICABLE PORTIONS OF TRAFFIC CONTROL STANDARDS 701301, 701311, 701501, 701502, 701601, 701602, 701606, 701701, 701801, 701901 AND IDOT DISTRICT ONE STANDARDS TC-10 AND TC-16 SHALL APPLY DURING ALL STAGES AND ALL SUB STAGES THAT ARE NOT SPECIFIED.
8. A SINGLE LANE CLOSURE WITH FLAGMEN AT WORK ZONES WILL ONLY BE ALLOWED BETWEEN 9:00AM AND 3:00 PM.

REVISIONS	
NAME	DATE

ILLINOIS DEPARTMENT OF TRANSPORTATION  
VILLAGE OF PALATINE  
PALATINE ROAD & PLUM GROVE ROAD RECONSTRUCTION  
SMITH STREET TO US 14 (NORTHWEST HIGHWAY)  
**PALATINE ROAD & PLUM GROVE ROAD  
MAINTENANCE OF TRAFFIC  
STAGE II**  
SCALE: VERT. N.T.S.      DRAWN BY J.P.W.  
          HORIZ. N.T.S.      CHECKED BY BA  
DATE: OCTOBER 19, 2009