

F.A.P. RTE.	SECTION	COUNTY	TOTAL SHEETS	SHEET NO.
1285	02-00075-00-PV	COOK	161	40
STA. _____		TO STA. _____		
FED. ROAD DIST. NO. _____ ILLINOIS FED. AID PROJECT				
CONTRACT NO. 63083				

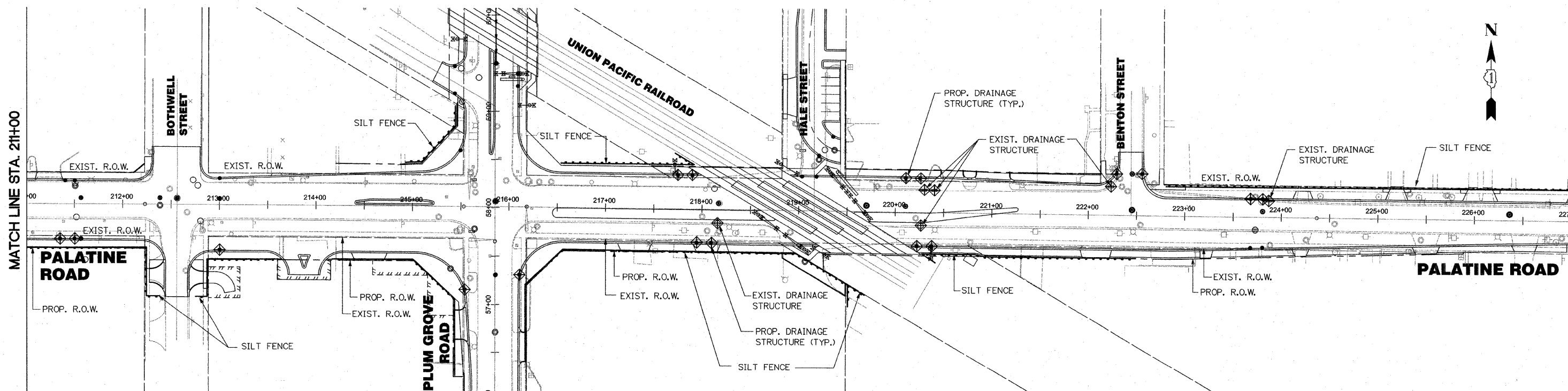
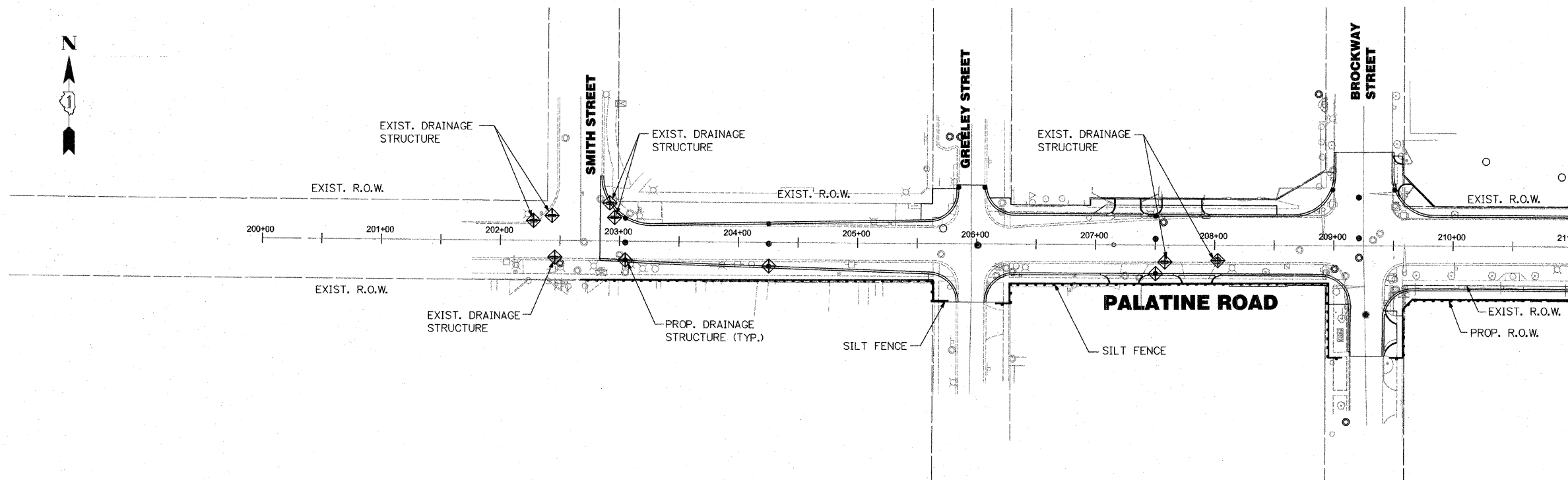

NOTE:

QUANTITIES HAVE BEEN ESTIMATED HEREIN FOR TEMPORARY SEEDING CLASS 7 WHICH WILL BE USED ONLY WHEN DIRECTED BY ENGINEER IN ACCORDANCE WITH ARTICLE 280.04 (F) OF THE STANDARD SPECIFICATIONS, AND EROSION CONTROL BLANKET WILL BE USED TO PROTECT ALL THE SEEDER AREAS.

- SEDIMENT CONTROL, SILT FENCE
- ⊕ INLET FILTERS

REVISIONS	
NAME	DATE

ILLINOIS DEPARTMENT OF TRANSPORTATION
 VILLAGE OF PALATINE
 PALATINE ROAD & PLUM GROVE ROAD RECONSTRUCTION
 SMITH STREET TO US 14 (NORTHWEST HIGHWAY)
PALATINE ROAD
TEMPORARY EROSION CONTROL PLAN
STAGE I
 SCALE: VERT. N.T.S.
 HORIZ. 1" = 50'
 DATE: OCTOBER 19, 2009
 DRAWN BY: BA
 CHECKED BY: RCH