

F.A.U. R.F.E. 2995	SECTION 05-00068-00-FP	COUNTY DUPAGE	TOTAL SHEETS 141	SHEET NO. 1
FED. ROAD DIST. NO. 1	ILLINOIS	CONTRACT NO. 63092		

FOR INDEX OF SHEETS, SEE SHEET NO. 2

FOR LIST OF STATE AND LOCAL STANDARDS, SEE SHEET NO. 2

**PROJECT LOCATED WITHIN THE VILLAGE OF GLEN ELLYN**

**TRAFFIC DATA - RIFORD ROAD**  
 POSTED SPEED: 30MPH  
 DESIGN SPEED: 30MPH  
 CURRENT ADT (2006): 2,800 VPD  
 DESIGN ADT (2030): 3,000 VPD

**DESIGN DESIGNATION**  
 URBAN COLLECTOR

**TRAFFIC DATA - ST. CHARLES ROAD**  
 POSTED SPEED: 35MPH  
 DESIGN SPEED: 40MPH  
 CURRENT ADT (2006): 21,000 VPD  
 DESIGN ADT (2030): 24,000 VPD

**DESIGN DESIGNATION**  
 ARTERIAL

STATE OF ILLINOIS  
 DEPARTMENT OF TRANSPORTATION  
 DIVISION OF HIGHWAYS

**PLANS FOR PROPOSED FEDERAL AID PROJECT**

FAU 2995 (RIFORD ROAD)  
 SECTION NO.: 05-00068-00-FP  
 FAU 1409 (CRESCENT BLVD) TO FAU 1397 (ST. CHARLES RD)  
 ROADWAY RECONSTRUCTION AND WIDENING

PROJECT NO.: M-8003 (588)  
 JOB NO.: C-91-159-06

VILLAGE OF GLEN ELLYN  
 DUPAGE COUNTY

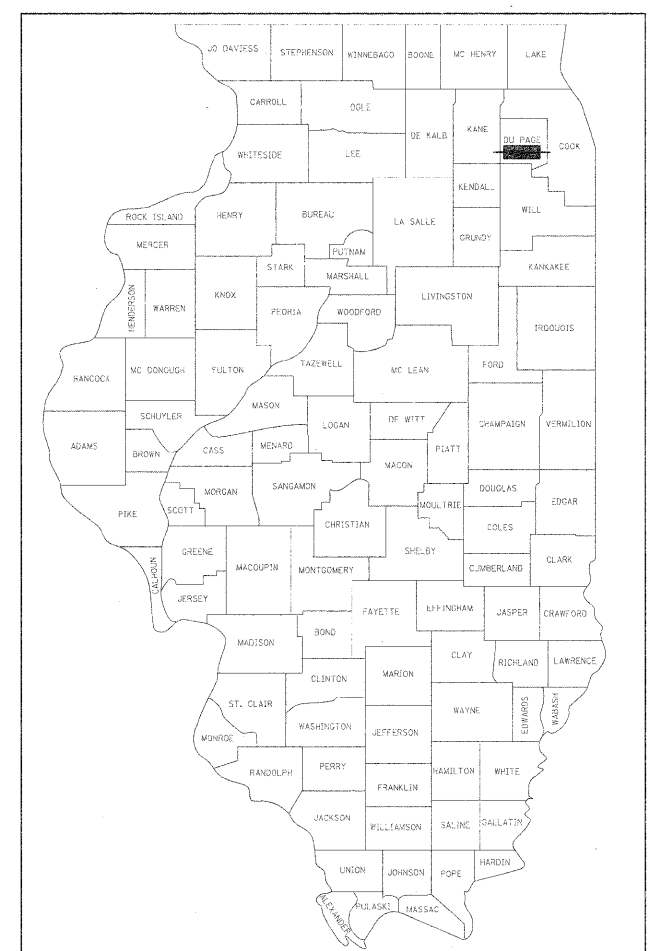

LOCATION OF SECTION INDICATED THIS: - [Symbol] -

STATE OF ILLINOIS  
 DEPARTMENT OF TRANSPORTATION  
 DIVISION OF HIGHWAYS

APPROVED Dec 01 20 09  
*Joseph M. Caracci*  
 GLEN ELLYN DIRECTOR OF PUBLIC WORKS

PASSED DECEMBER 3 20 09  
*Cheryl A. Holt*  
 DISTRICT 1 ENGINEER OF LOCAL ROADS & STREETS

RELEASED FOR BID  
 BASED ON LIMITED  
 REVIEW DECEMBER 11, 20 09  
*Diana M. D'Korff*  
 DEPUTY DIRECTOR OF HIGHWAYS, REGION 1 ENGINEER

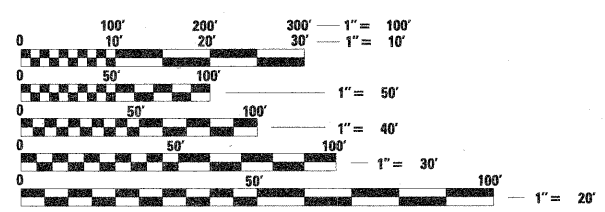

FULL SIZE PLANS HAVE BEEN PREPARED USING STANDARD ENGINEERING SCALES. REDUCED SIZED PLANS WILL NOT CONFORM TO STANDARD SCALES. IN MAKING MEASUREMENTS ON REDUCED PLANS, THE ABOVE SCALES MAY BE USED.

J.U.L.I.E.  
 JOINT UTILITY LOCATION INFORMATION FOR EXCAVATION  
 1-800-892-0123  
 OR 811

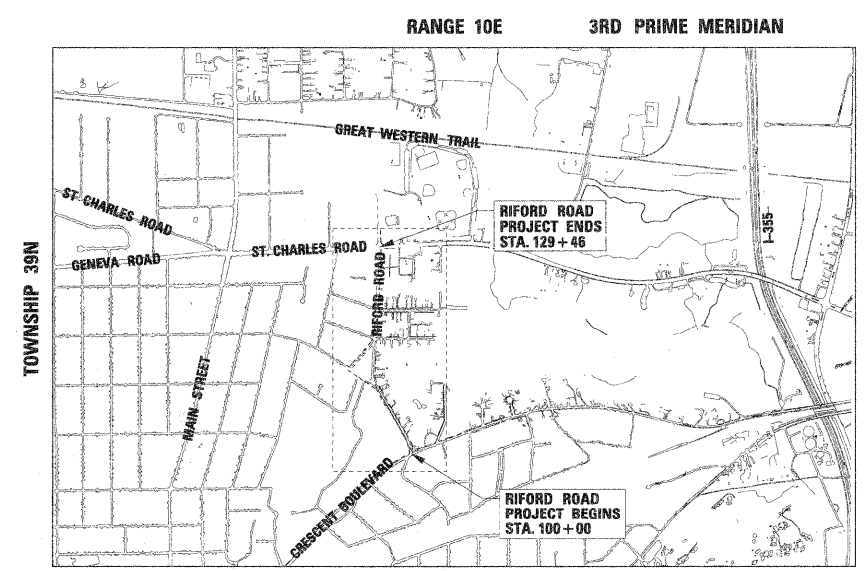

**LOCATION MAP**

SCALE: 1" = 0.2 MILES

MILTON TOWNSHIP  
 TOWNSHIP: 39N  
 RANGE: 10E

GROSS LENGTH OF PROJECT = 2946 LINEAL FEET (0.56 MILES)  
 NET LENGTH OF PROJECT = 2946 LINEAL FEET (0.56 MILES)

IL DESIGN FIRM  
 NO. 184-001310



EXP. 04/30/2011

CONTRACT NO. 63092

ASSOCIATE FIELD ENGINEER: MARLIN SOLOMON, P.E. 847-705-4407



*Matthew A. Papirnik*  
 MATTHEW A. PAPIRNIK, P.E. ENGINEER  
 ILLINOIS REGISTRATION No. 062-052094  
 EXPIRATION DATE: 11/30/2011  
 APPLIES TO ALL SHEETS EXCEPT FOR THOSE LISTED BELOW

*David E. Mertz*  
 DAVID E. MERTZ, P.E. ENGINEER  
 ILLINOIS REGISTRATION No. 062-052068  
 EXPIRATION DATE: 11/30/2011  
 APPLIES TO SHEETS 84-87

**PRINTED BY THE AUTHORITY OF THE STATE OF ILLINOIS**