

PLAN	SURVEYED	DATE
	PLOTTED	
	CHECKED	
	BY	
	NO.	
	DATE	

PROFILE	SURVEYED	DATE
	PLOTTED	
	CHECKED	
	BY	
	NO.	
	DATE	

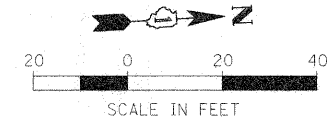
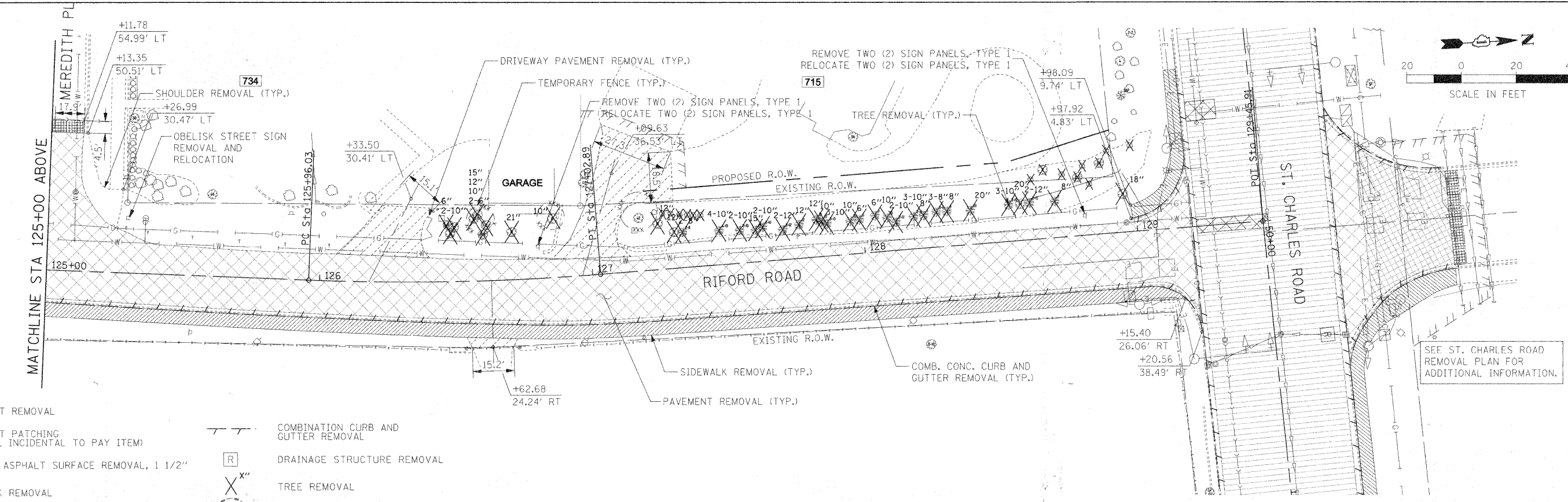
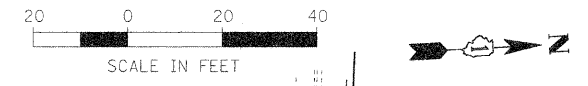
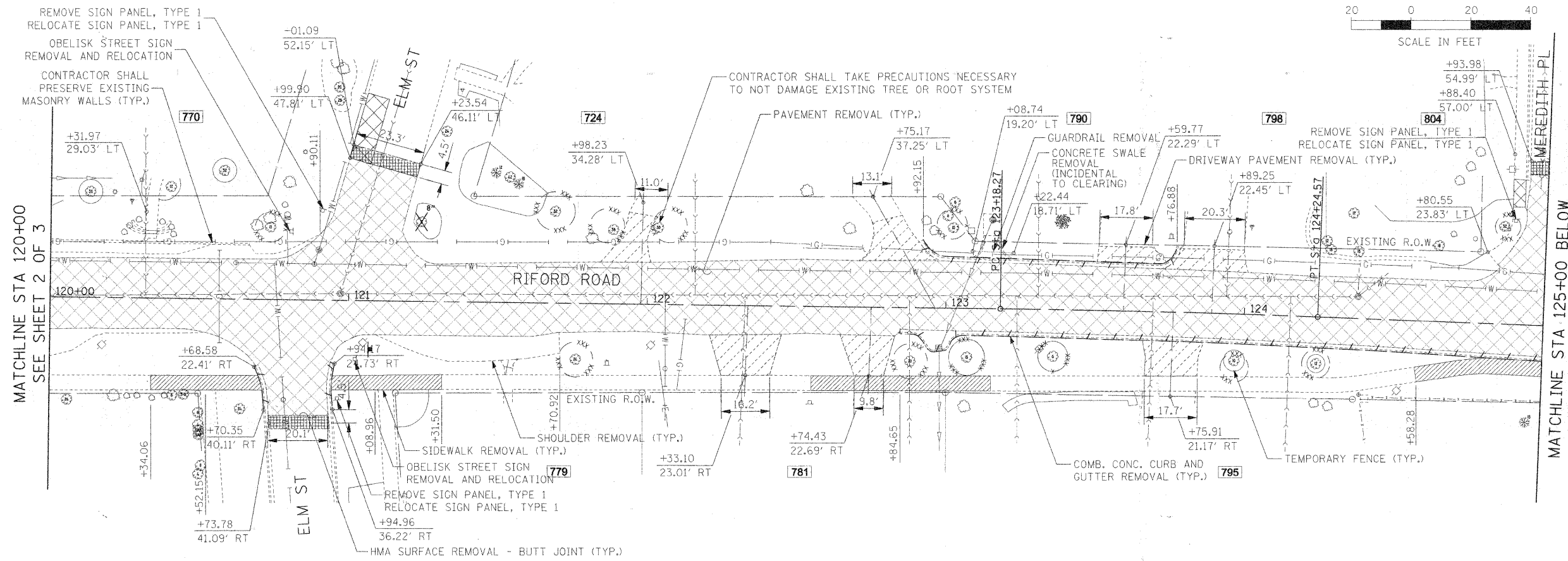

REMOVAL LEGEND:

- PAVEMENT REMOVAL
- PAVEMENT PATCHING (REMOVAL INCIDENTAL TO PAY ITEM)
- HOT-MIX ASPHALT SURFACE REMOVAL, 1 1/2"
- SIDEWALK REMOVAL
- DRIVEWAY PAVEMENT REMOVAL
- HMA SURFACE REMOVAL - BUTT JOINT
- COMBINATION CURB AND GUTTER REMOVAL
- DRAINAGE STRUCTURE REMOVAL
- TREE REMOVAL
- TEMPORARY FENCE (FOR TREE PROTECTION)
- SAPLING (LESS THAN 6" DIA.), SHRUB, AND BUSH REMOVAL; CONSIDERED INCIDENTAL TO CLEARING

FILE NAME #	USER NAME = #USER#	DESIGNED - JAB	REVISED -
#FILEL#		DRAWN - JAB	REVISED -
	PLOT SCALE = #SCALE#	CHECKED -	REVISED -
	PLOT DATE = #DATE#	DATE - 12/01/2009	REVISED -

STATE OF ILLINOIS  
DEPARTMENT OF TRANSPORTATION

RIFORD ROAD REMOVAL PLAN

SCALE: 1"=20' SHEET NO. 3 OF 3 SHEETS STA. 120+00.00 TO STA. 129+44.85

F.A.U. RTE.	SECTION	COUNTY	TOTAL SHEETS	SHEET NO.
2115	05-00068-00-FP	DUPAGE	141	30
RIFORD ROAD RECONSTRUCTION		CONTRACT NO. 63092		
FED. ROAD DIST. NO. 1 ILLINOIS FED. AID PROJECT				

SEE ST. CHARLES ROAD  
REMOVAL PLAN FOR  
ADDITIONAL INFORMATION.