

PLAN	SURVEYED	BY	DATE
	PLOTTED		
	REVISIONS		
	NO. OF REVISIONS		
	DATE		
	CADD FILE NAME		

PROFILE	SURVEYED	BY	DATE
	PLOTTED		
	REVISIONS		
	NO. OF REVISIONS		
	DATE		
	CADD FILE NAME		

**NOTES ON CURB AND GUTTER REPAIRS
BETWEEN STA. 42+76 AND STA. 49+42 RT**

NOMINAL QUANTITIES OF THE FOLLOWING ITEMS ARE PROVIDED FOR REPAIR OF THE EXISTING CURB AND GUTTER ON THE SOUTH SIDE OF ST. CHARLES BETWEEN RIFORD ROAD AND THE WEST PROJECT LIMIT, AT THE DISCRETION AND DIRECTION OF THE ENGINEER:

- COMBINATION CURB AND GUTTER REMOVAL (200 LF)
- COMBINATION CONCRETE CURB AND GUTTER, TYPE B-6.18 (200 LF)

IN ORDER TO AVOID IMPACTS TO ADJACENT RESIDENCES, THE CONTRACTOR SHALL PRESERVE THE ADJACENT EXISTING SIDEWALKS, DRIVEWAYS AND STREETS AS MUCH AS POSSIBLE IN PERFORMING THIS WORK.

REMOVAL AND REPLACEMENT OF SIDEWALK AND DRIVEWAY PAVEMENT IN THE COURSE OF THE CURB AND GUTTER REPAIR SHALL BE PAID FOR AT THE CONTRACT UNIT PRICE FOR THOSE ITEMS ONLY AT THE DIRECTION OF THE ENGINEER THAT SUCH WORK IS NECESSARY -- OTHERWISE, SAID WORK SHALL BE INCIDENTAL TO THE ADJACENT SECTION OF B-6.18 CURB AND GUTTER.

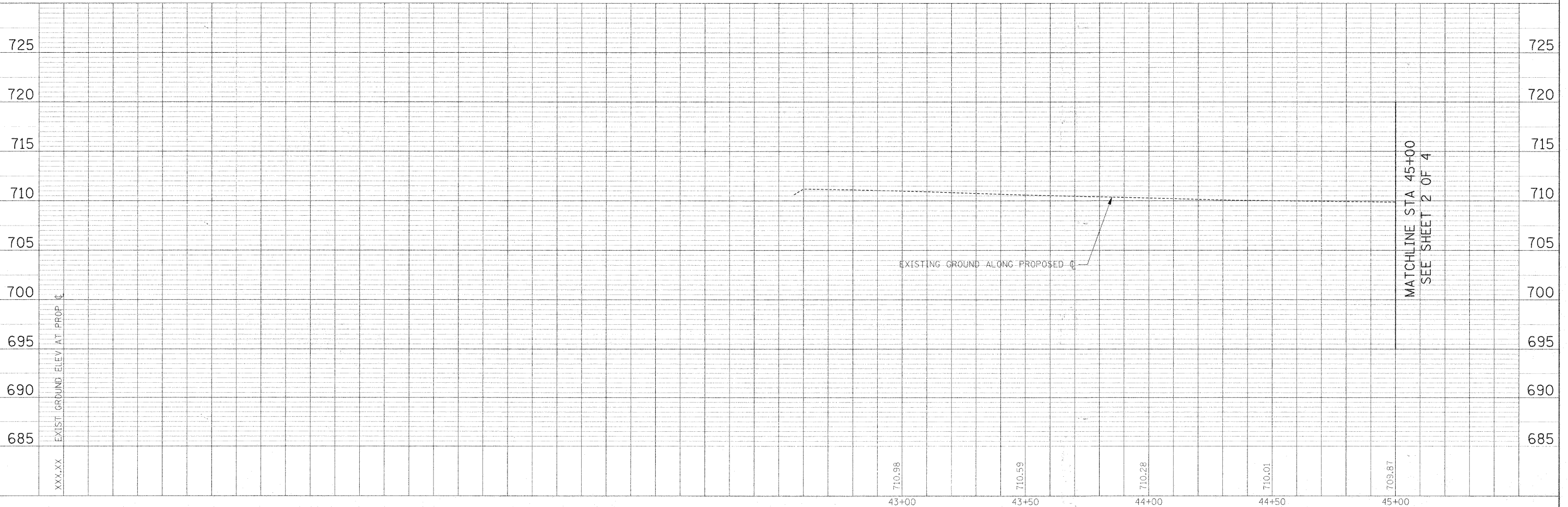
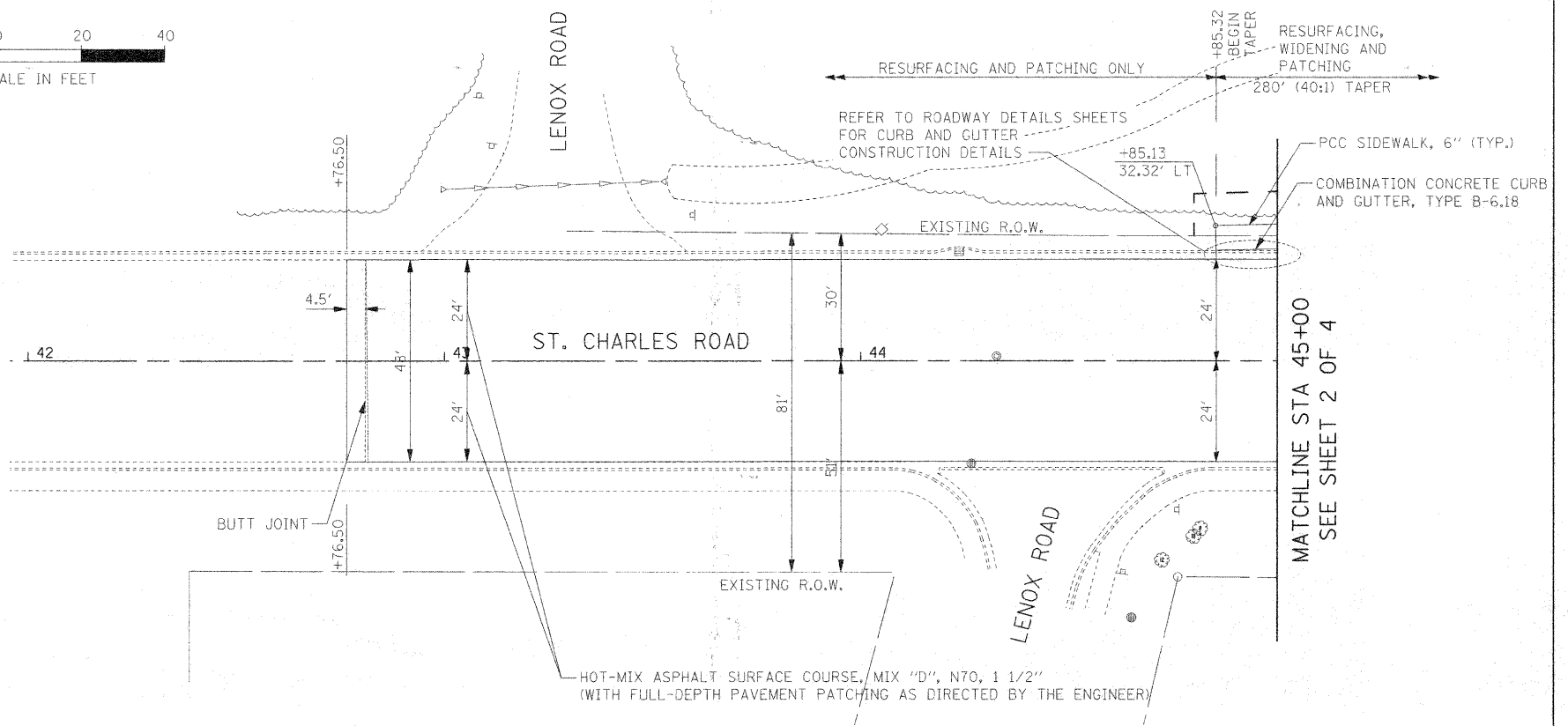
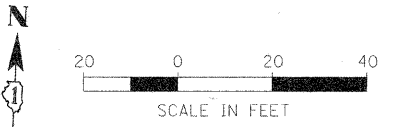

FILE NAME =	USER NAME = #USER#	DESIGNED - JMT	REVISED -	STATE OF ILLINOIS DEPARTMENT OF TRANSPORTATION	ST. CHARLES ROAD PLAN AND PROFILE	F.A.U. R.F.E. =	SECTION	COUNTY	TOTAL SHEETS	SHEET NO.
#FILE#		DRAWN - JAB	REVISED -			419	05-00068-00-FP	DUPAGE	141	39
		CHECKED -	REVISED -			RIFORD ROAD RECONSTRUCTION		CONTRACT NO. 63092		
		DATE - 12/01/2009	REVISED -			FED. ROAD DIST. NO. 1 ILLINOIS FED. AID PROJECT				

SCALE: 1"=20' SHEET NO. 1 OF 4 SHEETS STA. 42+50.00 TO STA. 45+00.00