

DATE	
BY	
REVIEWED	
APPROVED	
PLAN	
NO.	
NOTE BOOK	
NO.	
NO.	
NO.	
NO.	
NO.	

DATE	
BY	
REVIEWED	
APPROVED	
PROFILE	
NO.	
NOTE BOOK	
NO.	
NO.	
NO.	
NO.	
NO.	

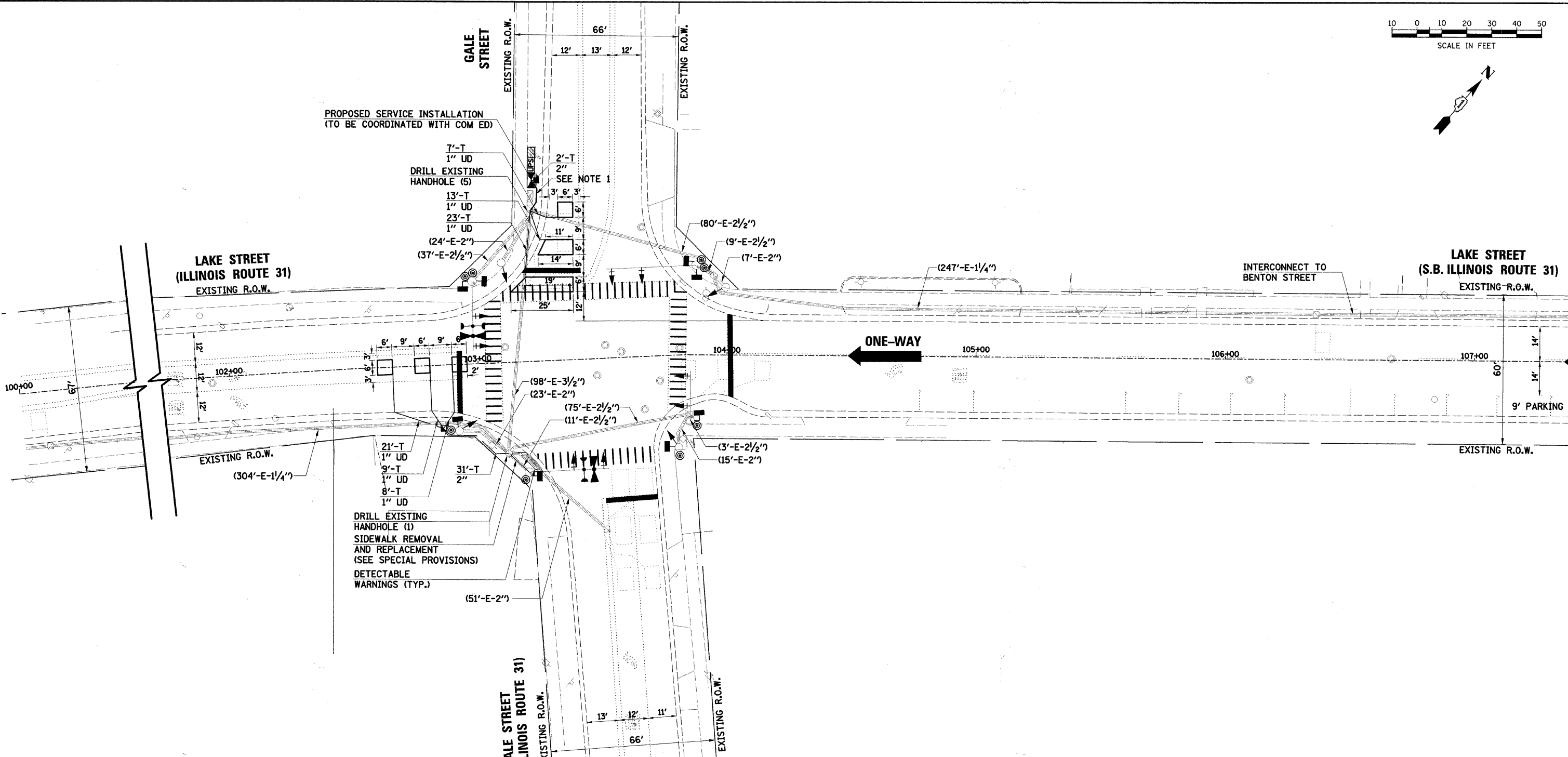

NOTES:
 1. PROVIDE 14' OF CONDUIT IN COMMON TRENCH, 4 AT 4".
 2. A MINIMUM OF ONE EAST-WEST AND ONE NORTH-SOUTH CROSSWALK SHALL REMAIN OPEN AT ALL TIMES IN ORDER TO MAINTAIN PEDESTRIAN ACCESS.

THE TRAFFIC SIGNAL CONTROL EQUIPMENT FOR THIS PROJECT SHALL BE "ECONOLITE" TO MATCH THE EXISTING ADJACENT SYSTEM.

THE EMERGENCY VEHICLE PREEMPTION EQUIPMENT FOR THIS PROJECT SHALL BE OPTICOM AS REQUIRED BY THE CITY OF AURORA.

RESTORATION OF WORK AREA:
 RESTORATION OF THE TRAFFIC SIGNAL WORK AREA SHALL BE INCIDENTAL TO THE RELATED PAY ITEM SUCH AS FOUNDATION, CONDUIT, HANDHOLE, TRENCH AND BACKFILL, ETC., AND NO EXTRA COMPENSATION SHALL BE ALLOWED. ALL ROADWAY SURFACES SUCH AS SHOULDERS, MEDIANS, SIDEWALKS, PAVEMENT, ETC. SHALL BE REPLACED IN KIND. ALL DAMAGE TO MOWED LAWNS SHALL BE REPLACED WITH AN APPROVED SOD, AND ALL DAMAGE TO UNMOWED FIELDS SHALL BE SEEDED IN ACCORDANCE WITH STANDARD SPECIFICATIONS 252 AND 250 RESPECTIVELY.

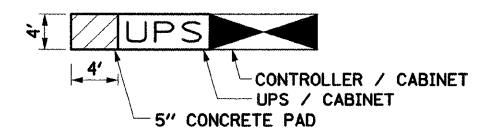
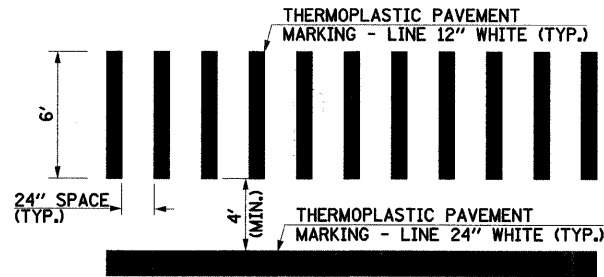

CONCRETE PAD INSTALLATION DETAIL
 NOTE:
 THE CONTRACTOR SHALL INSTALL A 5" CONCRETE MAINTENANCE PAD ADJACENT TO THE PROPOSED TYPE C FOUNDATION (STANDARD 878001). THE COST OF THE PAD WILL NOT BE PAID FOR SEPARATELY, BUT SHALL BE CONSIDERED AS INCLUDED IN THE COST OF THE UPS.

FILE NAME = ...\\fin.dwg\690.2.sig\ib.gale.dgn	USER NAME = .USER.	DESIGNED -	REVISED -	STATE OF ILLINOIS DEPARTMENT OF TRANSPORTATION	TRAFFIC SIGNAL MODIFICATION PLAN GALE STREET	F.A.U. RTE. 3902	SECTION 05-00258-00-TL	COUNTY KANE	TOTAL SHEETS 61	SHEET NO. 12		
PLOT SCALE = #SCALE#	CHECKED JRS	REVISED -	REVISED -			SCALE:	SHEET NO. OF SHEETS	STA. TO STA.	CONTRACT NO. 63251			
PLOT DATE = 3/11/2010	DATE -	REVISED -	REVISED -			FED. ROAD DIST. NO. [ILLINOIS] FED. AID PROJECT						