

PLAN	SURVEYED	DATE
	PLOTTED	
	CHECKED	
	BY	
	NO.	
	FILE NAME	

PROFILE	SURVEYED	DATE
	PLOTTED	
	CHECKED	
	BY	
	NO.	
	FILE NAME	

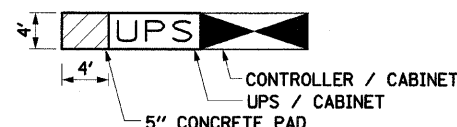
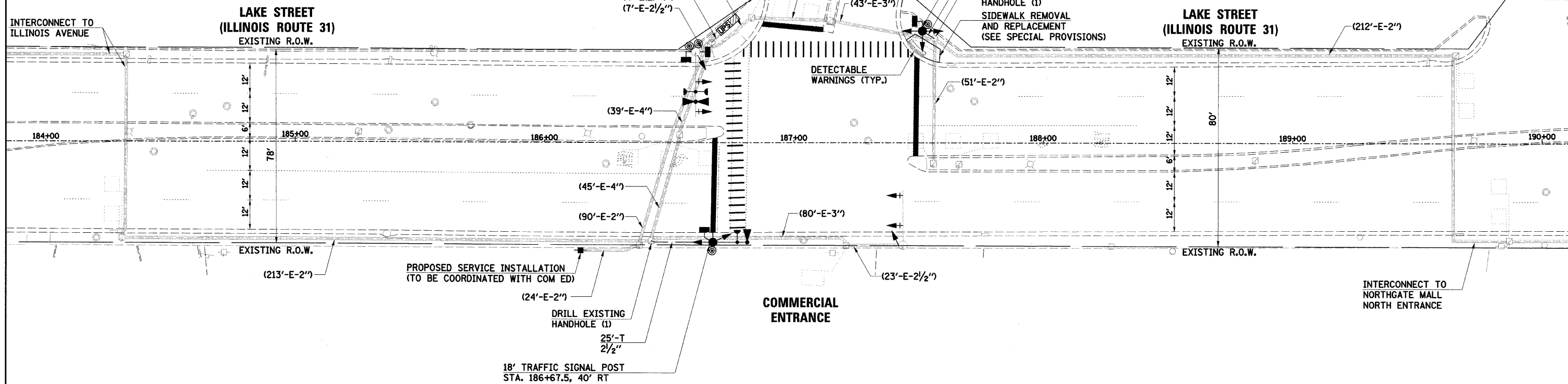

CONCRETE PAD INSTALLATION DETAIL

NOTE:
THE CONTRACTOR SHALL INSTALL A 5" CONCRETE MAINTENANCE PAD ADJACENT TO THE PROPOSED TYPE C FOUNDATION (STANDARD 878001). THE COST OF THE PAD WILL NOT BE PAID FOR SERPARATELY, BUT SHALL BE CONSIDERED AS INCLUDED IN THE COST OF THE UPS.

THE TRAFFIC SIGNAL CONTROL EQUIPMENT FOR THIS PROJECT SHALL BE "ECONOLITE" TO MATCH THE EXISTING ADJACENT SYSTEM.

THE EMERGENCY VEHICLE PREEMPTION EQUIPMENT FOR THIS PROJECT SHALL BE OPTICOM AS REQUIRED BY THE CITY OF AURORA.

RESTORATION OF WORK AREA:
RESTORATION OF THE TRAFFIC SIGNAL WORK AREA SHALL BE INCIDENTAL TO THE RELATED PAY ITEM SUCH AS FOUNDATION, CONDUIT, HANDHOLE, TRENCH AND BACKFILL, ETC., AND NO EXTRA COMPENSATION SHALL BE ALLOWED. ALL ROADWAY SURFACES SUCH AS SHOULDERS, MEDIANS, SIDEWALKS, PAVEMENT, ETC. SHALL BE REPLACED IN KIND. ALL DAMAGE TO MOWED LAWNS SHALL BE REPLACED WITH AN APPROVED SOD, AND ALL DAMAGE TO UNMOWED FIELDS SHALL BE SEEDED IN ACCORDANCE WITH STANDARD SPECIFICATIONS 252 AND 250 RESPECTIVELY.

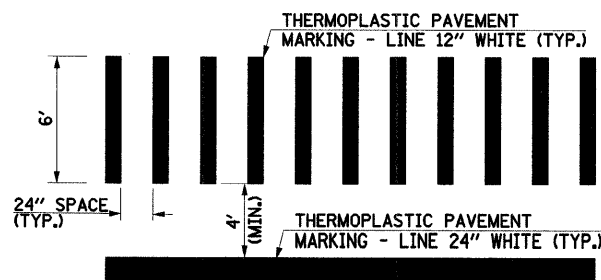

TYPICAL STRIPING DETAIL AT CROSSWALKS

FILE NAME = ...\\690.2.sig08b.com access *1.dgn	USER NAME = _USER_	DESIGNED - DRAWN <i>JMR</i>	REVISED - REVISED -	STATE OF ILLINOIS DEPARTMENT OF TRANSPORTATION	TRAFFIC SIGNAL MODIFICATION PLAN NORTHGATE MALL SOUTH ENTRANCE	F.A.U. RTE. 3902	SECTION 05-00258-00-TL	COUNTY KANE	TOTAL SHEETS 61	SHEET NO. 35	
PLOT SCALE = #SCALE#	CHECKED <i>JRS</i>	DATE -	REVISED -			SCALE:	SHEET NO. OF SHEETS	STA. TO STA.	CONTRACT NO. 63251		
PLOT DATE = 3/11/2010	DATE -	REVISED -	REVISED -			FED. ROAD DIST. NO. ILLINOIS FED. AID PROJECT					