

PLAN	DESIGNED	DATE
	BY	
	CHECKED	
	DATE	
	BY	
	CHECKED	
	DATE	
	BY	
	CHECKED	
	DATE	

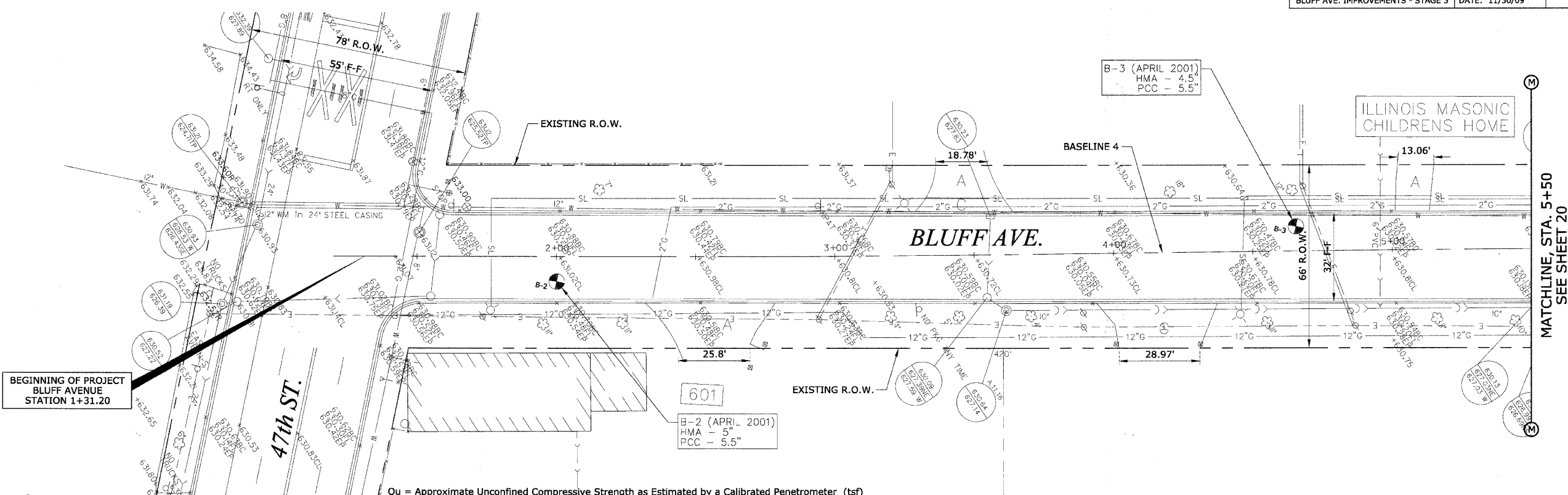

Qu = Approximate Unconfined Compressive Strength as Estimated by a Calibrated Penetrometer (tsf)  
 N = Standard Penetration Test Blow Count (blows / 12 in.)  
 %w = Moisture Content

SCALE:  
 1"=20' H  
 1"=2' V

PROFILE	DESIGNED	DATE
	BY	
	CHECKED	
	DATE	
	BY	
	CHECKED	
	DATE	
	BY	
	CHECKED	
	DATE	

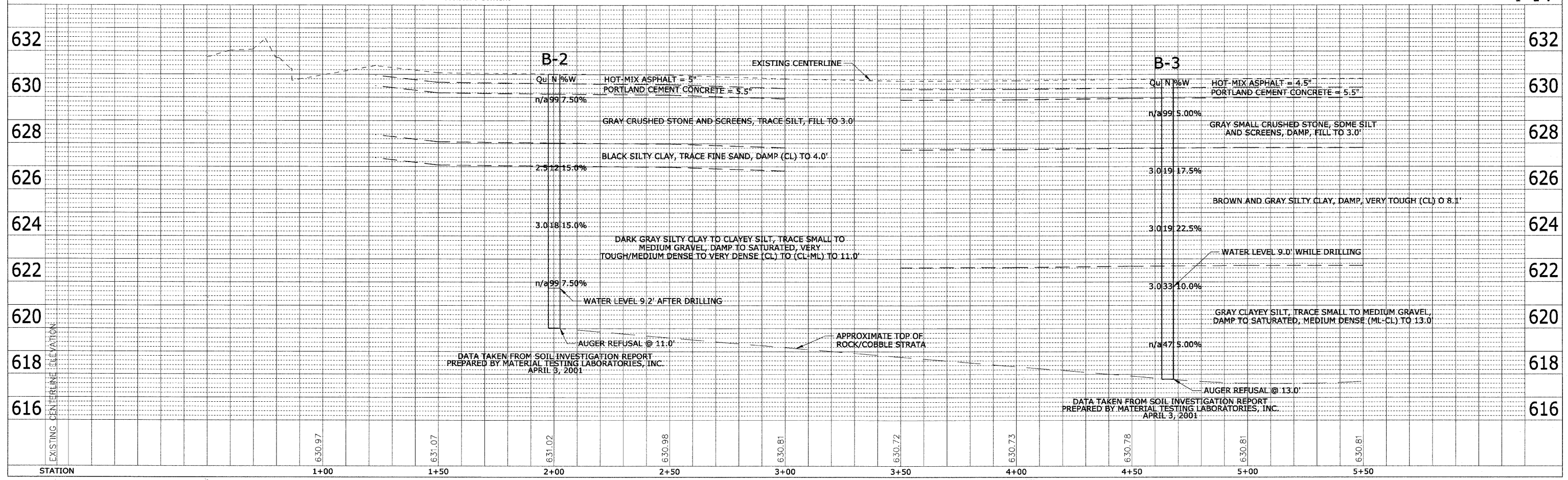

DATA TAKEN FROM SOIL INVESTIGATION REPORT PREPARED BY MATERIAL TESTING LABORATORIES, INC. APRIL 3, 2001

DATA TAKEN FROM SOIL INVESTIGATION REPORT PREPARED BY MATERIAL TESTING LABORATORIES, INC. APRIL 3, 2001

MATCHLINE STA. 5+50  
 SEE SHEET 20