

CONTRACT No. 63353

PLAN	DESIGNED	DATE
	PLOTTED	
	CHECKED	
	BY	
	NO.	

PROFILE	DESIGNED	DATE
	PLOTTED	
	CHECKED	
	BY	
	NO.	

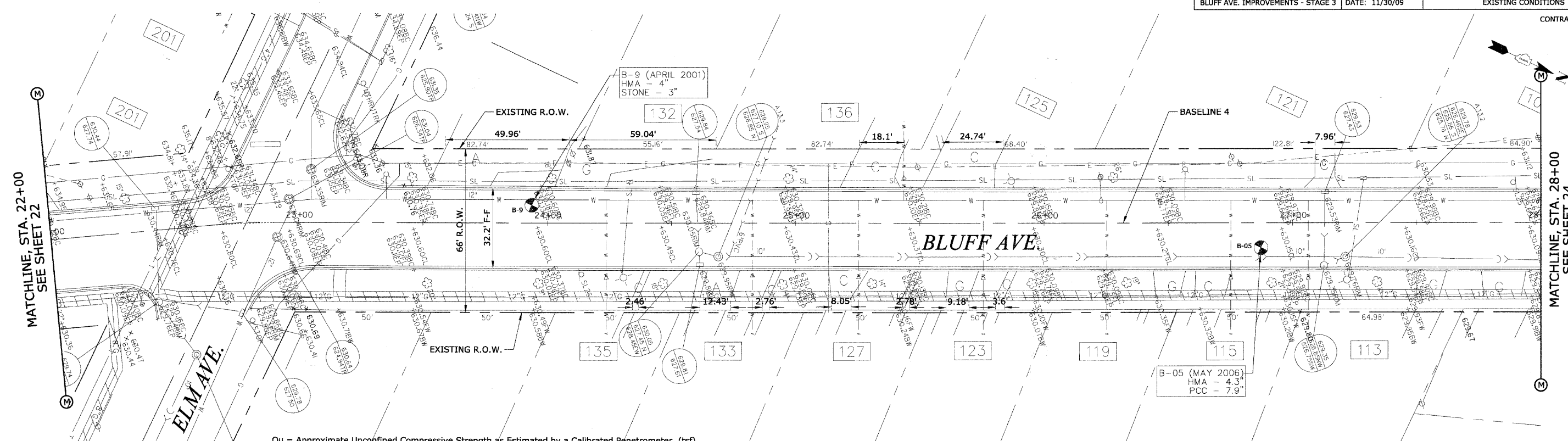

Qu = Approximate Unconfined Compressive Strength as Estimated by a Calibrated Penetrometer (tsf)
 N = Standard Penetration Test Blow Count (blows / 12 in.)
 %w = Moisture Content

SCALE:
 1"=20' H
 1"=2' V

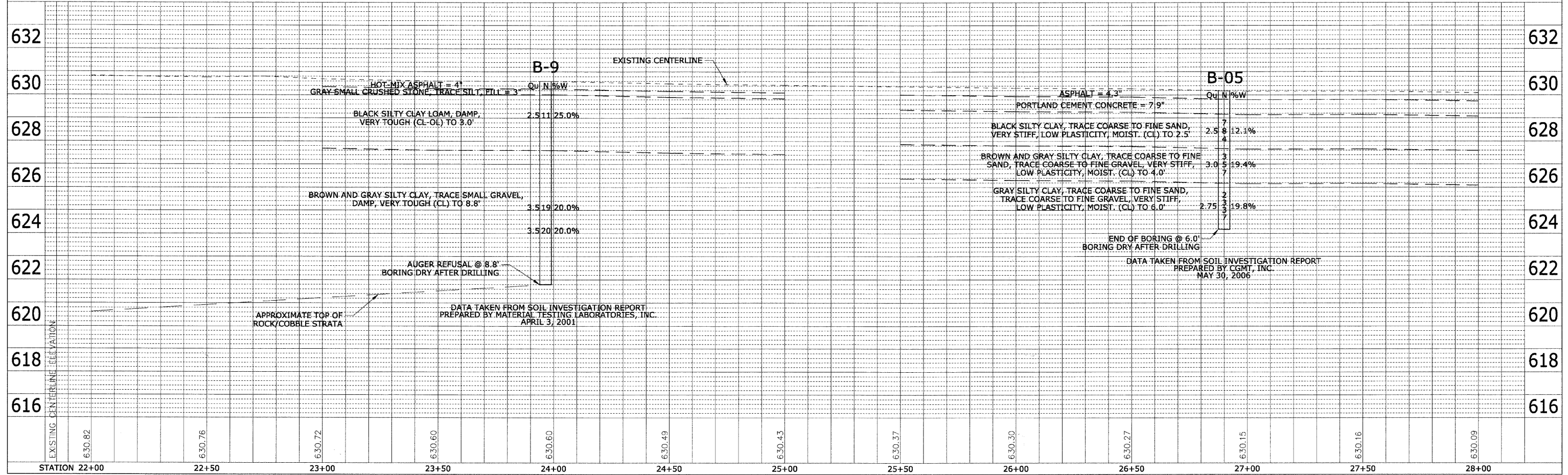

STATION 22+00 22+50 23+00 23+50 24+00 24+50 25+00 25+50 26+00 26+50 27+00 27+50 28+00