

GENERAL NOTES:

- TRENCH BACKFILL REQUIRED UNDER ALL AND WITHIN 2' OF PAVED SURFACES.
- EXISTING SEWER LATERALS DISTURBED DURING WATER MAIN INSTALLATION TO BE RESTORED. THE COST IS TO BE INCLUDED IN THE COST OF THE WATER MAIN.
- CONTRACTOR TO VERIFY LOCATION OF UNDERGROUND UTILITIES PRIOR TO INSTALLATION OF PROPOSED IMPROVEMENTS.
- CONTRACTOR SHALL DELIVER ALL SALVAGEABLE APPURTENANCES TO THE DEPARTMENT OF PUBLIC WORKS GARAGE.

HEUER AND ASSOCIATES		F.A.U. No.	SECTION	COUNTY	TOTAL SHEETS	SHEET No.
Consulting Engineers		1004	08-00079-03-FP	COOK	94	48
2315 Enterprise Drive - Suite 102 Westchester, IL 60154-5811 708-492-1000		STA. 5+50	TO STA. 11+00			
BLUFF AVE. IMPROVEMENTS - STAGE 3		DATE: 11/30/09		FED. ROAD DIST. NO. 1 ILLINOIS		
				FED. AID PROJECT		
				WATER MAIN IMPROVEMENTS		

DATE	BY	REVISION
		1. REVISED
		2. PLOTTED
		3. GRADES CHECKED
		4. STRUCTURE NOTATION CHECKED
PLAN	NO.	FILE NAME

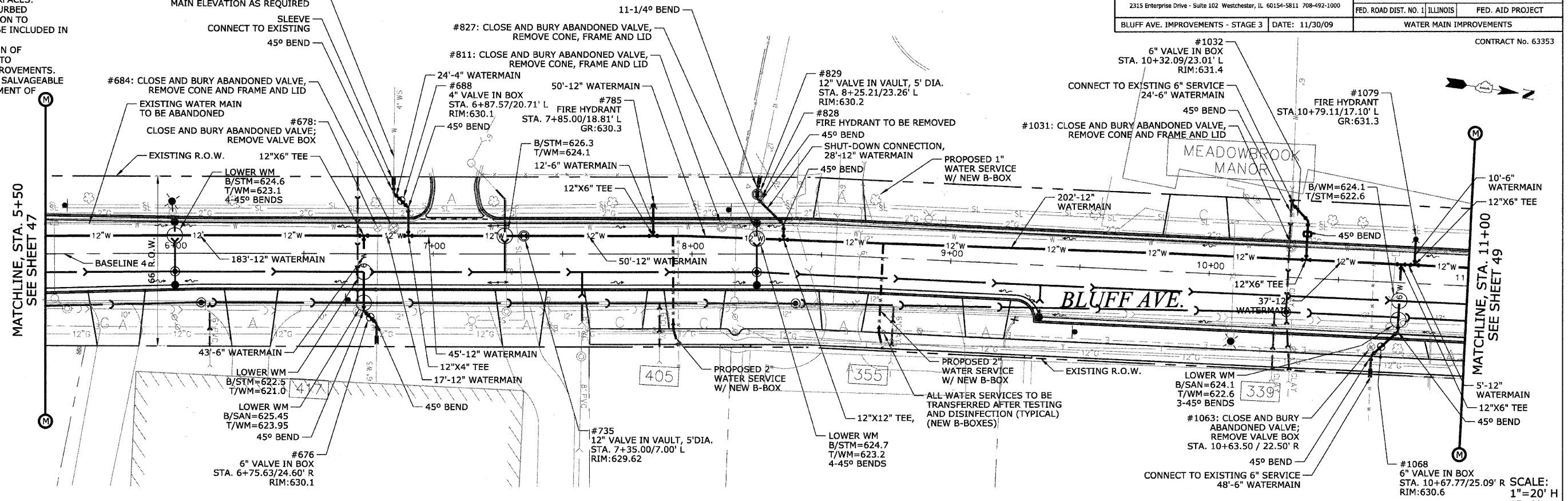

DATE	BY	REVISION
		1. REVISED
		2. PLOTTED
		3. GRADES CHECKED
		4. STRUCTURE NOTATION CHECKED
PROFILE	NO.	FILE NAME

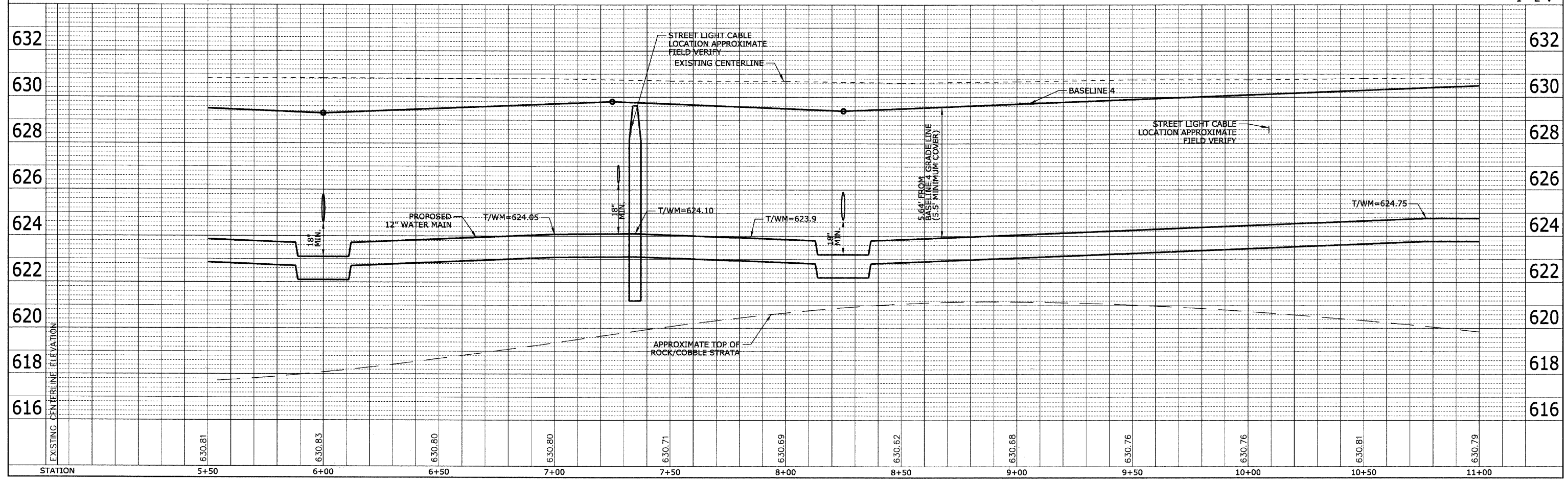

1"=20' H
1"=2' V