

GENERAL NOTES:

1. TRENCH BACKFILL REQUIRED UNDER ALL AND WITHIN 2' OF PAVED SURFACES.
2. EXISTING SEWER LATERALS DISTURBED DURING WATER MAIN INSTALLATION TO BE RESTORED. THE COST IS TO BE INCLUDED IN THE COST OF THE WATER MAIN.
3. CONTRACTOR TO VERIFY LOCATION OF UNDERGROUND UTILITIES PRIOR TO INSTALLATION OF PROPOSED IMPROVEMENTS.
4. CONTRACTOR SHALL DELIVER ALL SALVAGEABLE APPURTENANCES TO THE DEPARTMENT OF PUBLIC WORKS GARAGE.

HEUER AND ASSOCIATES
 Consulting Engineers
 2315 Enterprise Drive - Suite 102 Westchester, IL 60154-5811 708-492-1000
 BLUFF AVE. IMPROVEMENTS - STAGE 3 DATE: 11/30/09

F.A.U. RTE.	SECTION	COUNTY	TOTAL SHEETS	SHEET No.
1004	08-00079-03-FP	COOK	94	49
STA. 11+00	TO STA. 16+50		FED. AID PROJECT	
FED. ROAD DIST. NO. 1 ILLINOIS			WATER MAIN IMPROVEMENTS	

CONTRACT No. 63353

DATE	BY	REVISION

DATE	BY	REVISION

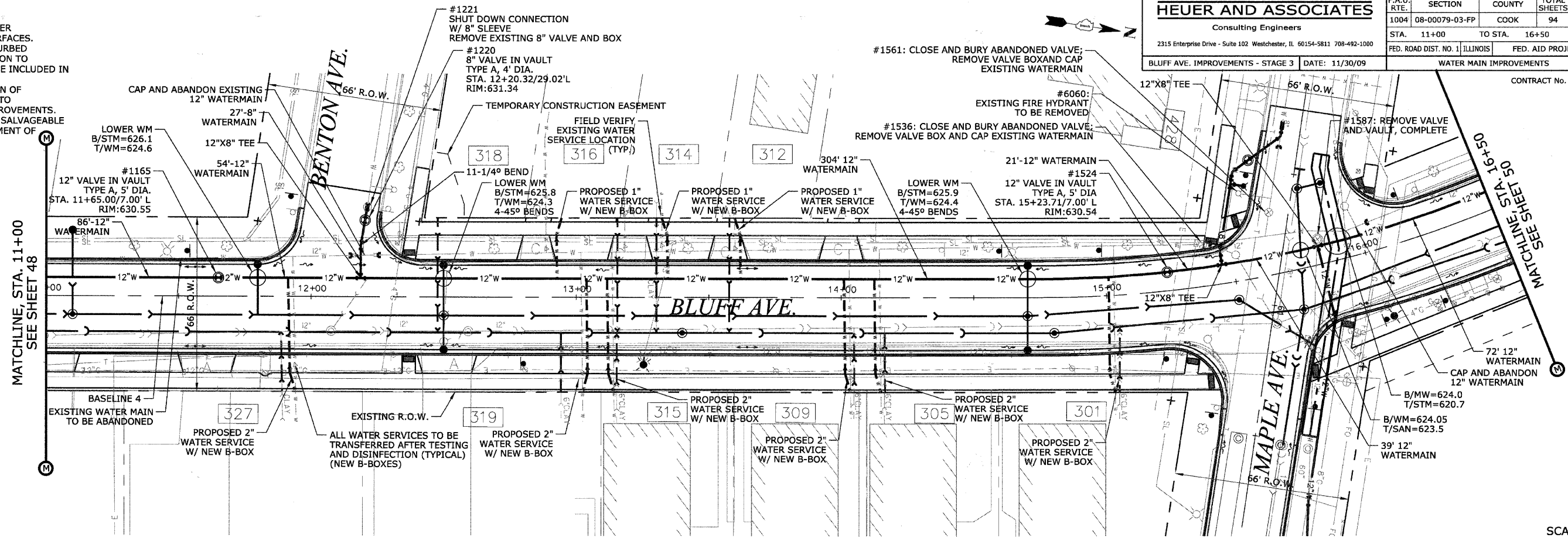

SEE SHEET 53

SCALE:
 1"=20' H
 1"=2' V

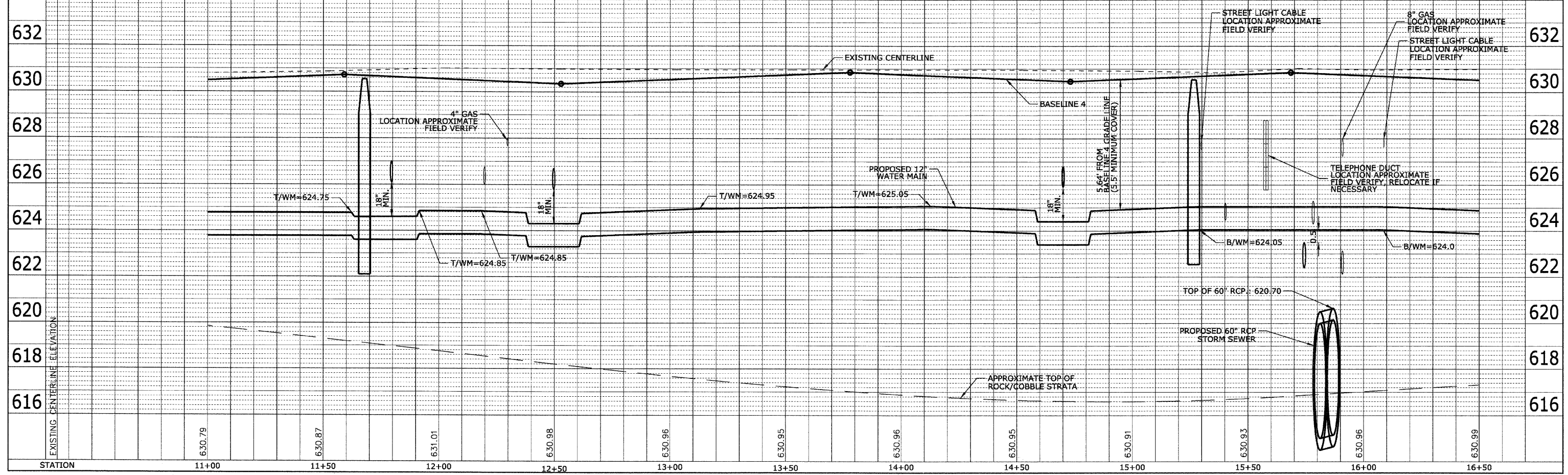

STATION	EXISTING CENTERLINE ELEVATION
11+00	630.79
11+50	630.87
12+00	631.01
12+50	630.98
13+00	630.96
13+50	630.95
14+00	630.96
14+50	630.95
15+00	630.91
15+50	630.93
16+00	630.96
16+50	630.99