

STAGE 1 EROSION AND SEDIMENT CONTROL

RIVERWOODS ROAD  
MATCH LINE STA. 3362+00 (SEE SHEET 30 )

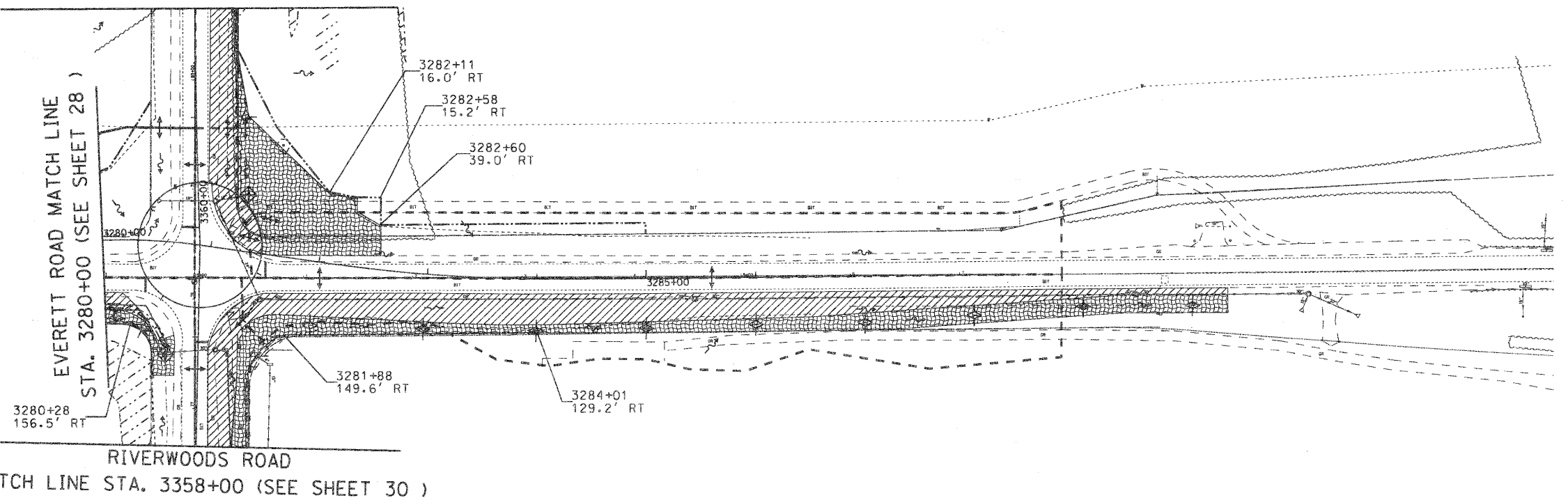

STAGES 2, 3 & 4 EROSION AND SEDIMENT CONTROL

RIVERWOODS ROAD  
MATCH LINE STA. 3362+00 (SEE SHEET 30 )

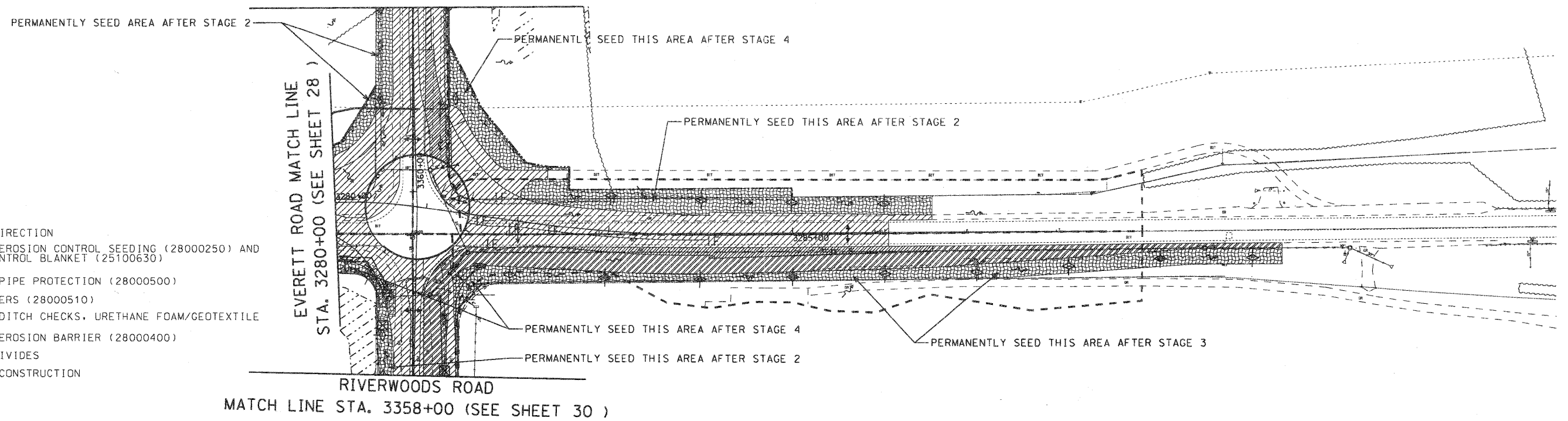

LEGEND

- DRAINAGE DIRECTION
- TEMPORARY EROSION CONTROL SEEDING (28000250) AND EROSION CONTROL BLANKET (25100630)
- INLET AND PIPE PROTECTION (28000500)
- INLET FILTERS (28000510)
- TEMPORARY DITCH CHECKS, URETHANE FOAM/GEOTEXTILE (X2800105)
- PERIMETER EROSION BARRIER (28000400)
- DRAINAGE DIVIDES
- LIMITS OF CONSTRUCTION
- WORK ZONE
- WETLANDS

RIVERWOODS ROAD  
MATCH LINE STA. 3358+00 (SEE SHEET 30 )

REVISIONS / REMARKS				
NO.	DESCRIPTION	DATE	BY	DESIGNED BY:
				JRM
				MPK/JLC
				DATE: 1/22/2010

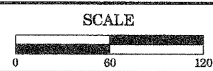

**HDR**  
30 N LaSalle Street, Suite 3220  
Chicago, IL 60602  
312-443-4900  
HDR Engineering, Inc.

**LakeCounty**  
Division of Transportation

EROSION CONTROL AND SEDIMENT CONTROL				ROUTE	SECTION	SECTION NUMBER	SHEET	SHEETS
EVERETT ROAD STAGES 1 - 4				CH	136	04-00136-06-CH	29	107

FILE NAME: