

STAGE 1 EROSION AND SEDIMENT CONTROL

NOTES:

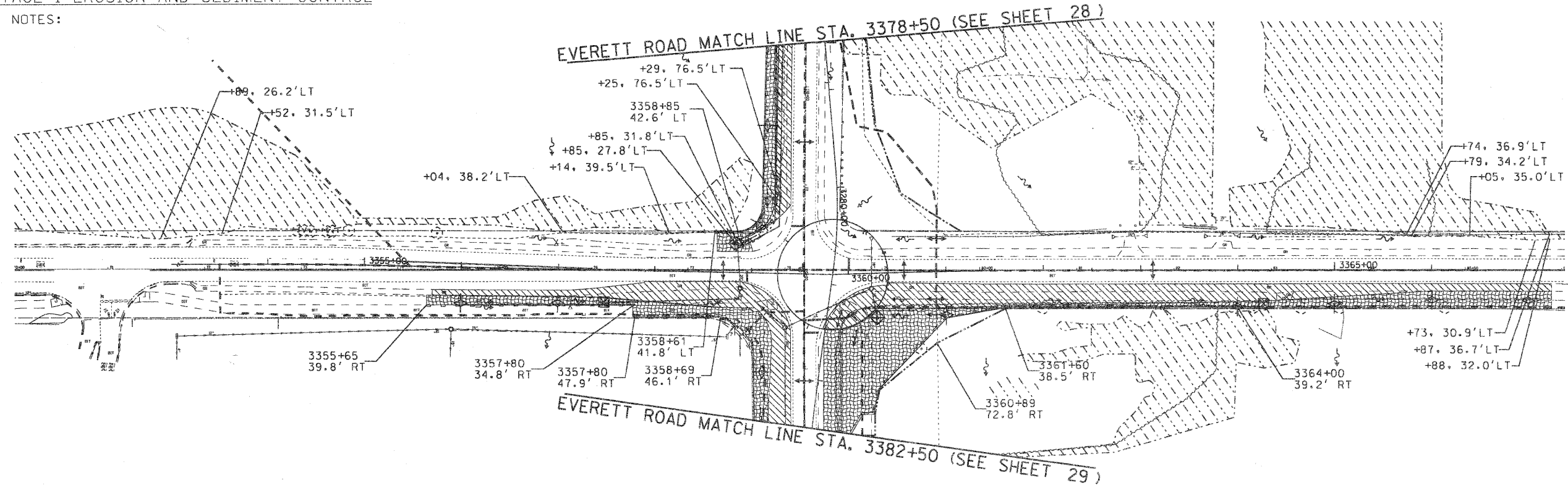

STAGES 2, 3 & 4 EROSION AND SEDIMENT CONTROL

NOTES:

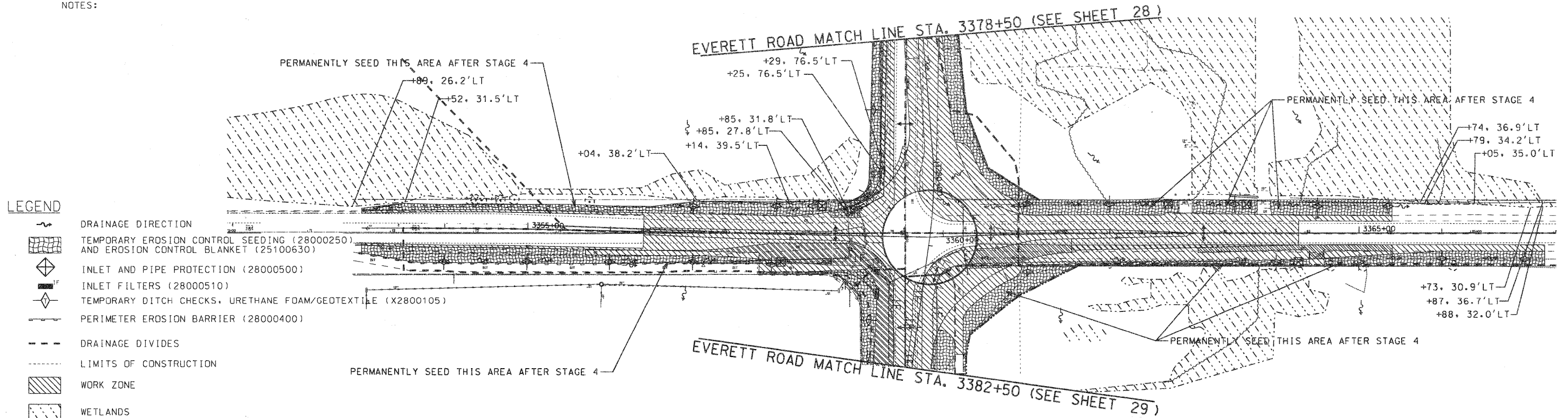

LEGEND

- DRAINAGE DIRECTION
- TEMPORARY EROSION CONTROL SEEDING (28000250) AND EROSION CONTROL BLANKET (25100630)
- INLET AND PIPE PROTECTION (28000500)
- INLET FILTERS (28000510)
- TEMPORARY DITCH CHECKS, URETHANE FOAM/GEOTEXTILE (X2800105)
- PERIMETER EROSION BARRIER (28000400)
- DRAINAGE DIVIDES
- LIMITS OF CONSTRUCTION
- WORK ZONE
- WETLANDS

REVISIONS / REMARKS		DATE	BY	DESIGNED BY:	JRM
NO.	DESCRIPTION	/ /		CHECKED BY:	MPK/JLC
		/ /		DATE:	1/22/2010

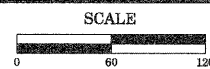

HDR 30 N LaSalle Street, Suite 3220
Chicago, IL 60602
312-443-4900
HDR Engineering, Inc.

LakeCounty
Division of Transportation

EROSION CONTROL AND SEDIMENT CONTROL
RIVERWOODS ROAD STAGES 1 - 4

ROUTE	SECTION	SECTION NUMBER	SHEET	SHEETS
CH	136	04-00136-06-CH	30	107

FILE NAME: