

RIVERWOODS ROAD
MATCH LINE STA. 3363+00

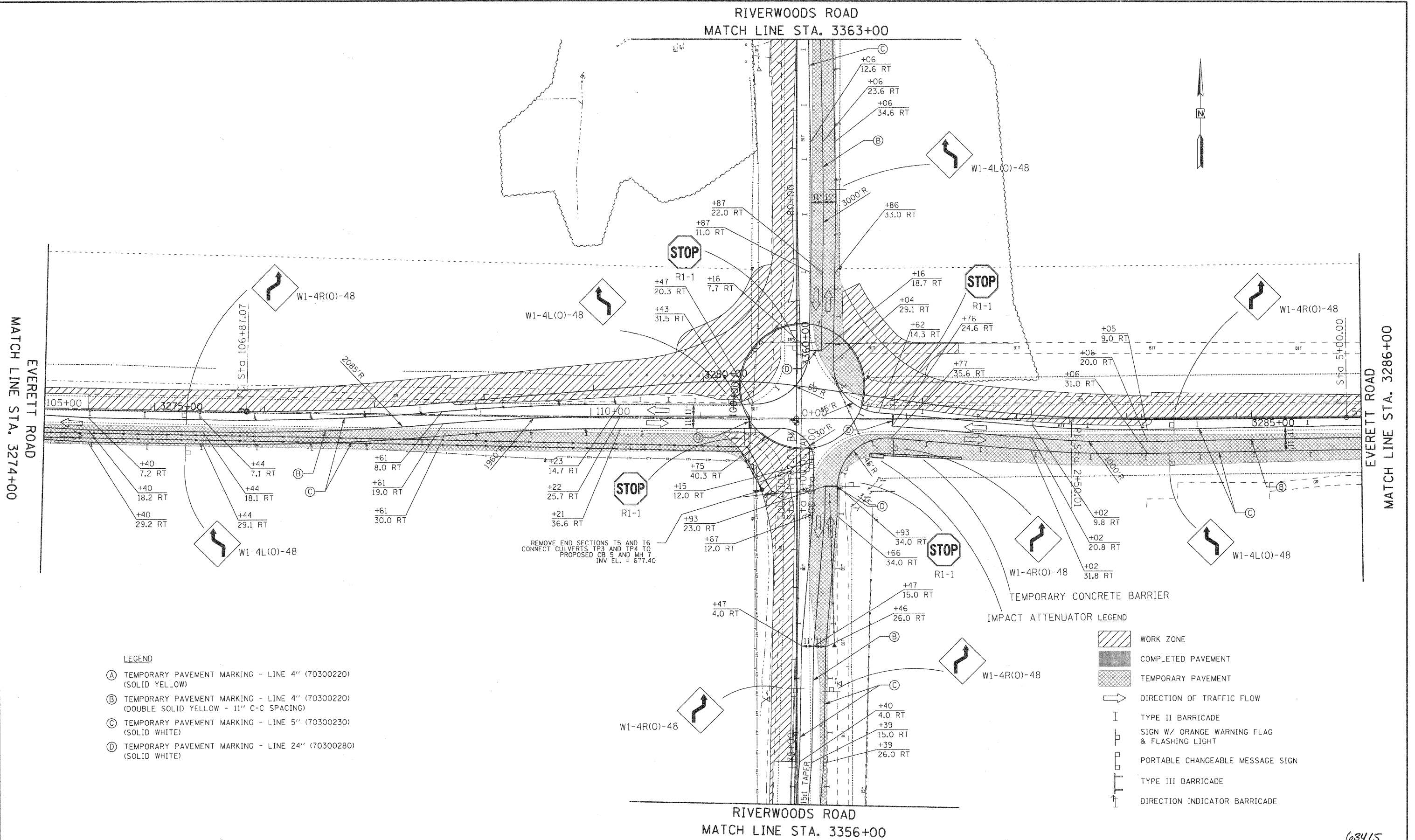

- LEGEND**
- (A) TEMPORARY PAVEMENT MARKING - LINE 4" (70300220) (SOLID YELLOW)
 - (B) TEMPORARY PAVEMENT MARKING - LINE 4" (70300220) (DOUBLE SOLID YELLOW - 11" C-C SPACING)
 - (C) TEMPORARY PAVEMENT MARKING - LINE 5" (70300230) (SOLID WHITE)
 - (D) TEMPORARY PAVEMENT MARKING - LINE 24" (70300280) (SOLID WHITE)

- IMPACT ATTENUATOR LEGEND**
- WORK ZONE
 - COMPLETED PAVEMENT
 - TEMPORARY PAVEMENT
 - DIRECTION OF TRAFFIC FLOW
 - TYPE II BARRICADE
 - SIGN W/ ORANGE WARNING FLAG & FLASHING LIGHT
 - PORTABLE CHANGEABLE MESSAGE SIGN
 - TYPE III BARRICADE
 - DIRECTION INDICATOR BARRICADE

REMOVE END SECTIONS T5 AND T6
CONNECT CULVERTS TP3 AND TP4 TO
PROPOSED CB 5 AND MH 7
INV. EL. = 677.40

REVISIONS / REMARKS		DATE	BY	DESIGNED BY:	JRM
NO.	DESCRIPTION	/ /		CHECKED BY:	MPK/JLC
		/ /		DATE:	1/22/2010

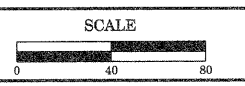

HDR
30 N LaSalle Street, Suite 3220
Chicago, IL 60602
312-443-4900
HDR Engineering, Inc.

LakeCounty
Division of Transportation

ROUNDABOUT - STAGE 2
TRAFFIC CONTROL PLAN

ROUTE	SECTION	SECTION NUMBER	SHEET	SHEETS
58/52	136	04-00136-06-CH	37	107

63415