

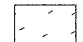

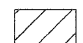



REMOVAL LEGEND

-  PAVEMENT REMOVAL (44000100)
-  AGGREGATE SHOULDER REMOVAL PAID FOR AS EARTH EXCAVATION (20200100)
-  SIDEWALK REMOVAL (44000600)
-  HOT-MIX ASPHALT SURFACE REMOVAL, 2 3/4" (44000160)
-  FIELD ENTRANCE REMOVAL PAID FOR AS EARTH EXCAVATION (20200100)
-  POINT AND LINEAR REMOVAL ITEMS

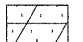

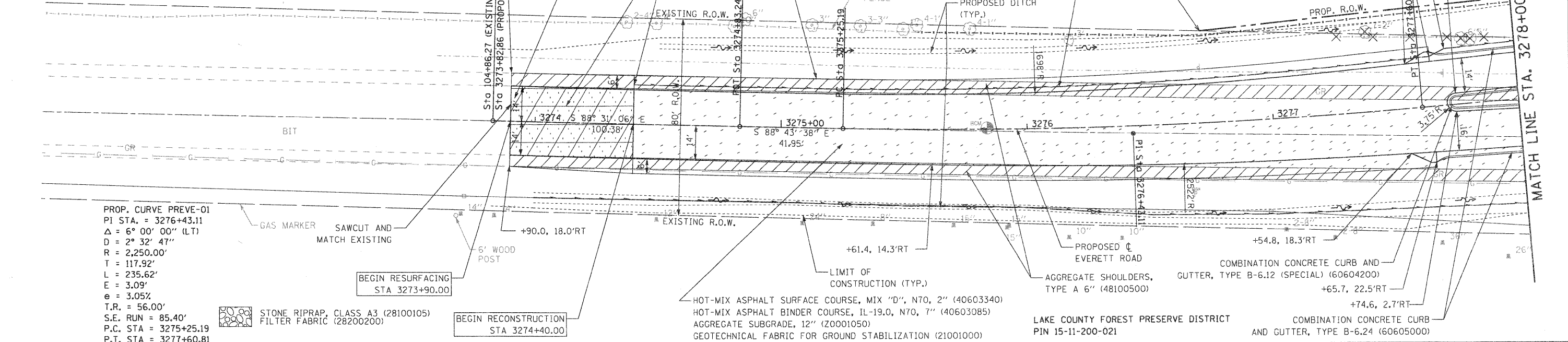
PROP. CURVE PREVE-01
 PI STA. = 3276+43.11
 $\Delta = 6^\circ 00' 00''$ (LT)
 $D = 2^\circ 32' 47''$
 $R = 2,250.00'$
 $T = 117.92'$
 $L = 235.62'$
 $e = 3.09'$
 $T.R. = 56.00'$
 $S.E. RUN = 85.40'$
 $P.C. STA = 3275+25.19$
 $P.T. STA = 3277+60.81$

 STONE RIPRAP, CLASS A3 (28100105)
 FILTER FABRIC (28200200)

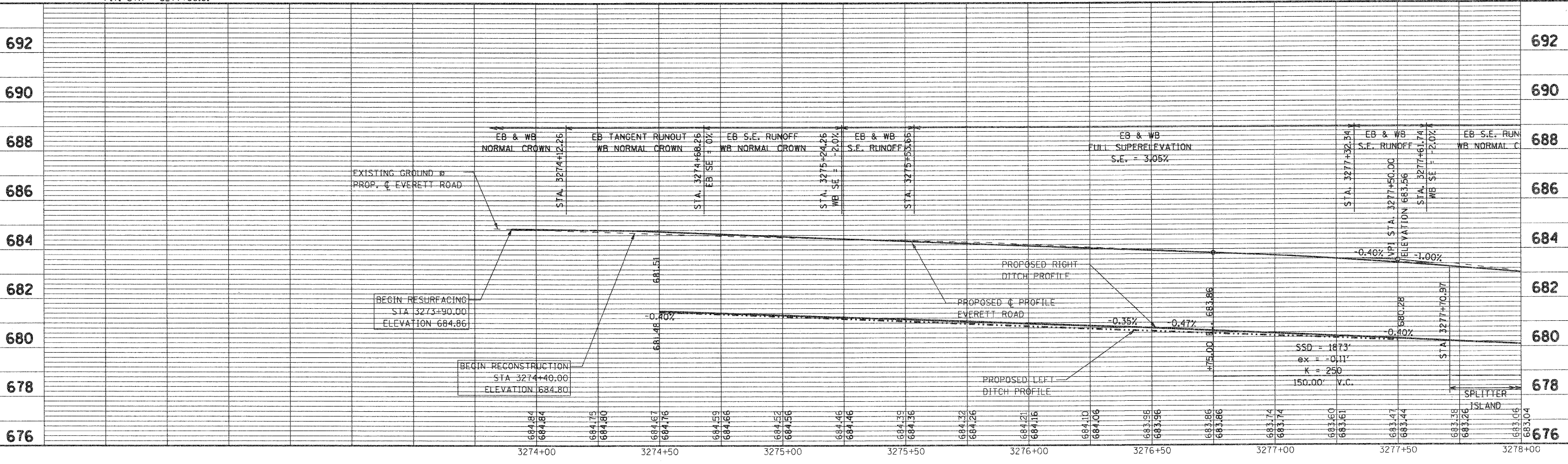

NO.	REVISIONS / REMARKS	DATE	BY	DESIGNED BY:	JRM

HDR 38 N LaSalle Street, Suite 3220
 Chicago, IL 60602
 312-443-4988
 HDR Engineering, Inc.

Lake County
 Division of Transportation

EVERETT ROAD		ROUTE	SECTION	SECTION NUMBER	SHEET	SHEETS
PLAN & PROFILE STA. 3272+00 TO STA. 3278+00		58/52	136	04-00136-06-CH	49	107

63415