

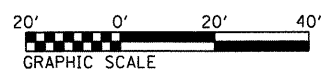

LEGEND:

- GAS PIPE
- ABANDONED GAS PIPE
- ELECTRIC AERIAL CABLE
- ELECTRIC CABLE
- TELEPHONE CABLE
- ABANDONED WATER PIPE
- WATER PIPE
- FIBER OPTIC
- MWRD SEWER
- SANITARY SEWER
- COMBINED SAN SEWER
- STORM SEWER
- STORM SEWER TO BE ABANDONED
- ROW LINE
- CATCH BASIN
- STORM MANHOLE
- STORM SEWER NUMBER
- STORM SEWER LATERAL NUMBER
- CB TO BE REMOVED
- CB TO BE FILLED
- CB TO BE ADJUSTED
- CB TO BE CLEANED
- STRUCTURES TO BE ADJUSTED
- CATCH BASIN
- MANHOLE
- STORM SEWER
- LIGHT POLE (FOR REFERENCE USE ONLY)

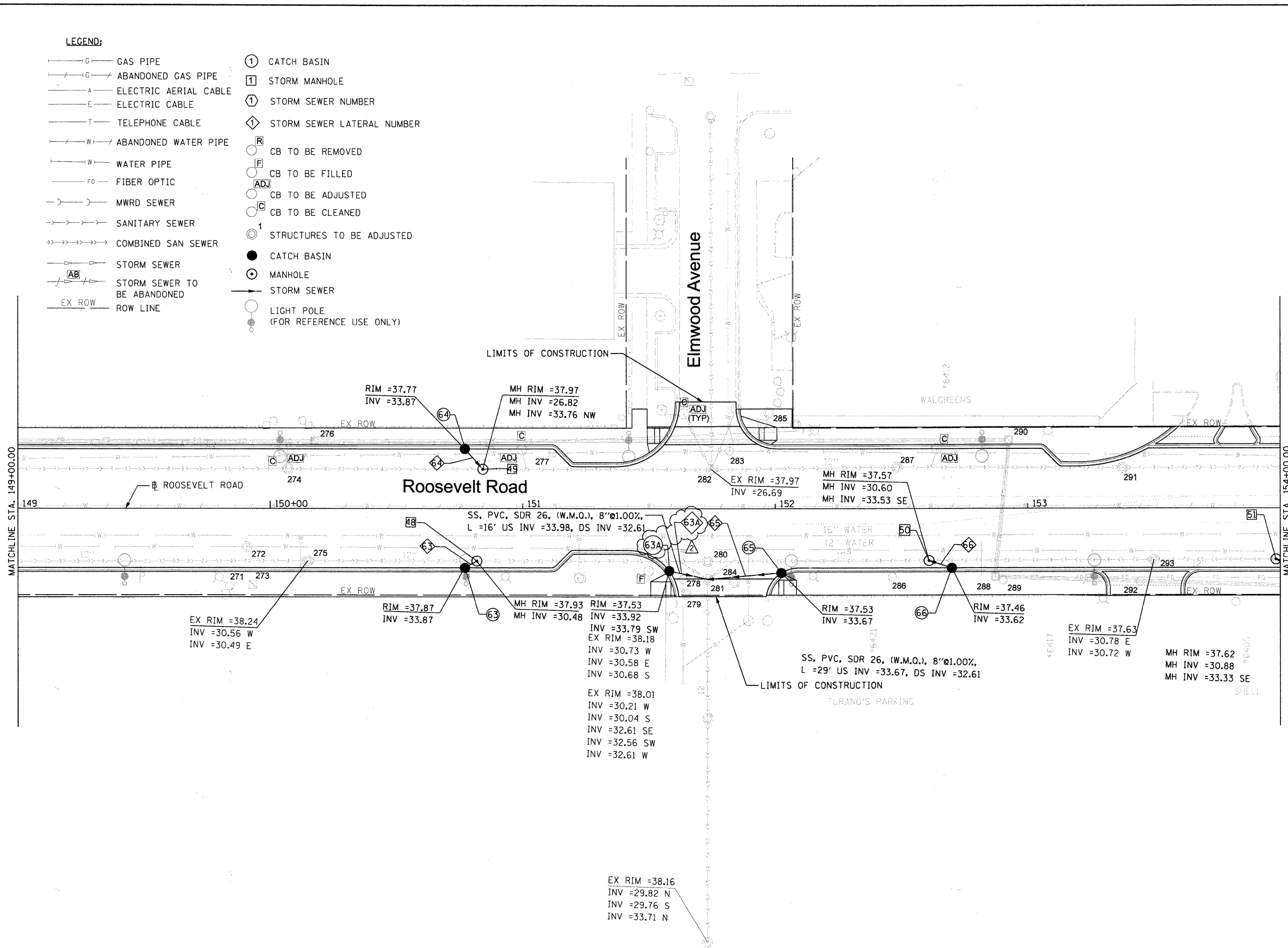

FILE NAME = DIRTE38-shr-drewn10.dgn	USER NAME = IDOT	DESIGNED - DA	REVISED - 04/09/2010	STATE OF ILLINOIS DEPARTMENT OF TRANSPORTATION	DRAINAGE AND UTILITIES PLAN	F.A.P. RTE. 347	SECTION 09-00248-00-RS	COUNTY COOK	TOTAL SHEETS 274	SHEET NO. 103
PLOT SCALE = 20,0000' / IN.	CHECKED - JB	DATE -	REVISED -	SCALE: 1" = 20'		SHEET NO. 10 OF 30 SHEETS		STA. 149+00.00 TO STA. 154+00.00		CONTRACT NO. 63432
PLOT DATE = 4/8/2010	DATE -	REVISED -	REVISED -	ILLINOIS FED. AID PROJECT						