

INDEX OF SHEETS

SHEET NO. DESCRIPTION

1	COVER SHEET
2	GENERAL NOTES AND INDEX OF SHEETS
3-4	SUMMARY OF QUANTITIES
5-8	SCHEDULE OF QUANTITIES
9-13	TYPICAL SECTIONS
14-20	ALIGNMENT, TIES AND BENCHMARKS
21-22	MAINTENANCE OF TRAFFIC GENERAL NOTES
23	MAINTENANCE OF TRAFFIC UTILITY STAGING - STAGE 1
24	MAINTENANCE OF TRAFFIC UTILITY STAGING - STAGE 2
25	MAINTENANCE OF TRAFFIC UTILITY STAGING - STAGE 3
26-29	MAINTENANCE OF TRAFFIC TYPICAL SECTIONS
30-38	MAINTENANCE OF TRAFFIC PLANS - STAGE 1
39-51	MAINTENANCE OF TRAFFIC PLANS - STAGE 2
52-63	MAINTENANCE OF TRAFFIC PLANS - STAGE 3
64-78	REMOVAL PLAN
79-93	DESIGN PLAN AND PROFILE
94-108	DRAINAGE AND UTILITIES PLAN AND PROFILE
109-123	DRAINAGE PROFILE
124-129	DRAINAGE SCHEDULE
130-137	EROSION AND SEDIMENT CONTROL
138-152	PROPOSED AND EXISTING ELEVATIONS
153-157	PAVEMENT MARKING PLAN
158	SIGN LEGEND
159-165	SIGNING PLAN
166	LANDSCAPE PLANTING NOTES
167-181	LANDSCAPING PLAN
182	LANDSCAPE SCHEDULE AND DETAILS
183-193	LANDSCAPE DETAILS
194-220	TRAFFIC SIGNAL PLANS
221	ELECTRICAL NOTES, LEGEND AND ELECTRICAL LOAD SCHEDULE
222-223	VOLTAGE DROP CALCULATION FOR CABINETS
224	WIRING DIAGRAM FOR RECEPTACLE CABINET FOR ONE RECEPTACLE
225	WIRING DIAGRAM FOR RECEPTACLE CABINET FOR TWO RECEPTACLES
226	WIRING DIAGRAM FOR RECEPTACLE CABINET FOR THREE RECEPTACLES
227-242	LIGHTING INSTALLATION AND REMOVAL PLAN
243-245	ELECTRICAL CABINET SINGLE LINE DIAGRAM AND LEGEND
246	LIGHTING POLE, WIRING IN TRENCH, SPlicing ELECTRICAL CABLES AND HANDHOLE DETAILS
247	AUSTIN CABINET WIRING DIAGRAM-EXISTING
248	AUSTIN CABINET WIRING DIAGRAM-REMOVAL
249	AUSTIN CABINET WIRING DIAGRAM-PROPOSED
250-258	PROJECT SPECIFIC DETAILS
259-274	DISTRICT 1 DETAILS

HIGHWAY STANDARDS

000001-05	STANDARD SYMBOLS, ABBREVIATIONS AND PATTERNS
424001-05	CURB RAMPS FOR SIDEWALKS
604001-03	FRAME AND LIDS TYPE 1
606001-04	CONCRETE CURB TYPE B AND COMBINATION CONCRETE CURB AND GUTTER
701501-05	URBAN LANE CLOSURE, 2L, 2W, UNDIVIDED
701502-03	URBAN LANE CLOSURE, 2L, 2W, WITH BIDIRECTIONAL LEFT TURN LANE
701602-04	URBAN LANE CLOSURE, MULTILANE, 2W WITH BIDIRECTIONAL LEFT TURN LANE
701701-06	URBAN LANE CLOSURE, MULTILANE INTERSECTION
701801-04	LANE CLOSURE MULTILANE 1W OR 2W CROSSWALK OR SIDEWALK CLOSURE
701901-01	TRAFFIC CONTROL DEVICES
704001-06	TEMPORARY CONCRETE BARRIER
720001-01	SIGN PANEL MOUNTING DETAILS
720006-02	SIGN PANEL ERECTION DETAILS
720016-02	MAST ARM MOUNTED STREET NAME SIGNS
780001-02	TYPICAL PAVEMENT MARKINGS
814001-01	HANDHOLES

GENERAL NOTES

- THE LOCATION OF DRAINAGE STRUCTURES, STORM SEWERS, WATER MAINS, SANITARY SEWERS, AND OTHER PUBLIC OR PRIVATE UTILITIES AS SHOWN ON THE PLANS IS APPROXIMATE AND THEIR EXACT LOCATION IS TO BE DETERMINED IN THE FIELD BY THE CONTRACTOR. THIS WORK SHALL BE CONSIDERED INCLUDED IN THE COST OF MOBILIZATION UNIT BID PRICE OF THE CONTRACT, AND NO ADDITIONAL COMPENSATION WILL BE ALLOWED.
- ALL AREAS DISTURBED DURING CONSTRUCTION OPERATIONS AND NOT PART OF THE WORK AS SHOWN HEREON SHALL BE RESTORED TO ORIGINAL CONDITION TO THE SATISFACTION OF THE ENGINEER AT NO ADDITIONAL COMPENSATION TO THE CONTRACTOR. IT IS INCUMBENT UPON THE CONTRACTOR TO SHOW THAT DAMAGED AREAS WERE NOT DISTURBED BY CONSTRUCTION OPERATIONS.
- THESE DRAWINGS ASSUME THAT THE CONTRACTOR WILL UTILIZE AN ELECTRONIC DRAWING FILE AND STAKE ALL SITE IMPROVEMENTS USING COORDINATES TIED INTO THE PROVIDED CONTROL POINTS. THE DIMENSIONS INDICATED ON THE DRAWINGS ARE FOR THE CONVENIENCE OF THE CONTRACTOR ONLY.
- THE CONTRACTOR SHALL TAKE ALL NECESSARY SAFETY PRECAUTIONS TO PROTECT ABUTTING PROPERTY, UTILITIES, PEDESTRIANS, AND VEHICULAR TRAFFIC.
- THE CONTRACTOR IS RESPONSIBLE FOR ADJUSTING ALL EXISTING UTILITIES AND STRUCTURES AS NECESSARY TO THE FINAL PROPOSED SURFACE PROFILE GRADES. CONTRACTOR SHALL OBTAIN ALL PERMITS NECESSARY FOR ADJUSTING EXISTING UTILITIES AND STRUCTURES AND ALL COORDINATION WITH CITY AND/OR VILLAGE DEPARTMENTS AND UTILITY OWNERS.
- CONTRACTOR IS RESPONSIBLE FOR REMOVAL, STORAGE, AND RE-INSTALLATION OF ALL EXISTING SIGNAGE, BENCHES, SIDEWALK RAILINGS, AND OTHER ITEMS THAT ARE IMPACTED BY THIS CONTRACT AND ARE NOT SHOWN AS BEING REPLACED. THE CONTRACTOR IS RESPONSIBLE FOR REPLACING ANY OF THESE ITEMS THAT ARE DAMAGED AS A RESULT OF THIS CONTRACT FOR NO ADDITIONAL COST. THE REMOVAL AND RE-INSTALLATION OF THESE ITEMS IS NOT QUANTIFIED SEPARATELY AND ARE INCLUDED IN THE COST OF MOBILIZATION.
- THE CONTRACTOR SHALL MAINTAIN SURFACE DRAINAGE OF THE ROAD DURING CONSTRUCTION.

DISTRICT 1 STANDARD DETAILS

BD500-01 (BD-7)	DETAIL OF STORM SEWER CONNECTION TO EXISTING SEWER
BD600-03 (BD-8)	DETAIL FOR FRAMES AND LIDS ADJUSTMENT WITH MILLING
BD600-05 (BD-16)	DROP MANHOLE DETAILS
BD400-04 (BD-22)	PAVEMENT PATCHING FOR HMA SURFACED PAVEMENT
BD400-05 (BD-32)	BUTT JOINT AND HMA TAPER DETAILS
BD400-06 (BD-33)	HMA TAPER AT EDGE OF P.C.C. PAVEMENT
BD-36	FIRE HYDRANT TO BE MOVED
BE215	LIGHT CONTROLLER SINGLE DOOR
BE300	LIGHT POLE FOUNDATION 30' (9.144 m) TO 35' (10.668 m) M.H. 1 1/2" (292 mm) BOLT CIRCLE
BE305	LIGHT POLE FOUNDATION, METAL
BE702	MISC. ELECTRICAL DETAILS SHEET A
TC-10	TRAFFIC CONTROL AND PROTECTION FOR SIDE ROADS, INTERSECTIONS, AND DRIVEWAYS
TC-11	TYPICAL APPLICATIONS RAISED REFLECTIVE PAVEMENT MARKERS (SNOW-PLOW RESISTANT)
TC-13	DISTRICT ONE TYPICAL PAVEMENT MARKINGS
TC-16	PAVEMENT MARKING LETTERS AND SYMBOLS FOR TRAFFIC STAGING
TC-22	ARTERIAL ROAD INFORMATION SIGN

- THE CONTRACTOR SHALL NOTIFY ALL UTILITY COMPANIES FOR FIELD LOCATIONS OF THEIR FACILITIES PRIOR TO BEGINNING CONSTRUCTION. THE CONTRACTOR WILL BE RESPONSIBLE FOR THE MAINTENANCE AND PRESERVATION OF THESE FACILITIES. ALL UTILITY LOCATIONS SHOWN MUST BE VERIFIED BY THE CONTRACTOR IN THE FIELD.
- CARE MUST BE TAKEN FOR ANY EARTH EXCAVATION NEAR EXISTING TREES SO THAT DAMAGE TO THE TREE ROOTS DOES NOT OCCUR.
- WHEN CONCRETE REMOVAL IS REQUIRED, IT MUST BE ACCOMPLISHED BY SAWCUT, SLEDGES, AND PNEUMATIC HAND TOOLS. EQUIPMENT AND METHODS USED MUST BE SUCH AS TO PREVENT CRACKING, SHATTERING OR SPALLING OF CONCRETE THAT IS TO REMAIN.
- ACCESS MUST BE MAINTAINED TO ALL EXISTING PROPERTIES DURING CONSTRUCTION PER ARTICLE 107.09 UNLESS ARRANGEMENTS ARE MADE IN WRITING BY THE CONTRACTOR WITH THE PROPERTY OWNERS WITH A COPY TO THE ENGINEER FOR SHORT TERM CLOSURES.
- IF THE CONTRACTOR CAUSES DEBRIS TO ENTER THE EXISTING SEWERS, THAT ENTIRE SECTION OF SEWER BETWEEN MANHOLES MUST AT ONCE BE THOROUGHLY CLEANED AND RODDED BY THE CONTRACTOR AT NO ADDITIONAL COST TO THE CONTRACT. ALL SEWER AND WATER STRUCTURES SO CONTAMINATED MUST AT ONCE BE THOROUGHLY CLEANED BY THE CONTRACTOR AT NO ADDITIONAL COST TO THE CONTRACT.
- IN LOCATIONS WHERE THE MAIN STORM SEWER IS NOT BEING REPLACED AND THE EXISTING DRAINAGE FACILITIES ARE DISTURBED OR DAMAGED DURING CONSTRUCTION BY THE CONTRACTOR, THE CONTRACTOR MUST RESTORE AND REPLACE THE DAMAGE AT HIS/HER EXPENSE TO THE SATISFACTION OF THE ENGINEER. THE STORM SEWER FLOW MUST BE MAINTAINED AT ALL TIMES.
- ALL HMA PAVEMENT SURFACE COURSES, CONCRETE BASE COURSES, CONCRETE PAVEMENTS, CURBS, GUTTERS AND SIDEWALKS WHICH ARE TO BE REMOVED MUST BE SAW CUT AT THE LIMITS OF REMOVAL. SAW CUTTING SHALL BE INCLUDED WITHIN THE REMOVAL PAY ITEM FOR WHICH THE SAW CUTTING IS BEING PROVIDED.
- CONTRACTOR MUST SAWCUT AND HAND BREAK FOR SIDEWALK REMOVAL AT THE R.O.W/ BUILDING LINE TO AVOID DAMAGE TO ADJACENT PROPERTIES. SAW CUTTING SHALL BE INCLUDED WITHIN THE REMOVAL PAY ITEM FOR WHICH THE SAW CUTTING IS BEING PROVIDED.
- WHEN PLACING CONCRETE ADJACENT TO PRIVATE PROPERTY, THE CONTRACTOR MUST PROTECT PROPERTY (VISQUEEN, ETC.) TO AVOID CONCRETE SPLATTER AND/OR DAMAGE.
- THE CONTRACTOR SHALL CONTACT THE DISTRICT ONE TRAFFIC CONTROL SUPERVISOR AT (847) 705-4470 A MINIMUM OF 72 HOURS IN ADVANCE OF BEGINING OF WORK FOR LOCATIONS OF UNDERGROUND TRAFFIC SIGNAL LINES AND INTERCONNECT CABLES AND (847) 221-3078 TO LOCATE UNDERGROUND LIGHTING CABLE.
- THE CONTRACTOR SHALL ADVISE THE POLICE AND FIRE DEPARTMENTS DAILY AS TO WHAT STREETS, IF ANY, ARE TO BE CLOSED OR PARTIALLY BLOCKED SO THAT THEY CAN EFFICIENTLY ROUTE THEIR EMERGENCY VEHICLES.

	POLICE DEPARTMENT TELEPHONE NO.	FIRE DEPARTMENT TELEPHONE NO.
VILLAGE OF OAK PARK	(708) 386-3800	(708) 445-3300
CITY OF BERWYN	(708) 795-5600 EXT. 3100	(708) 788-2660 EXT. 3280
TOWN OF CICERO	(708) 652-2130	(708) 652-0174

- THE RESIDENT ENGINEER SHALL CONTACT MS. PATRICE HARRIS, AREA TRAFFIC FIELD TECHNICIAN, AT 708-597-9800 A MINIMUM OF 2 WEEKS PRIOR TO PLACEMENT OF FINAL PAVEMENT MARKINGS.

20. THE GENERAL CONTRACTOR IS REQUIRED TO HIRE AN ENVIRONMENTAL FIRM WITH AT LEAST FIVE (5) DOCUMENTED LEAKING UNDERGROUND STORAGE TANK (LUST) CLEANUPS OR THAT IS PRE-QUALIFIED IN HAZARDOUS WASTE BY THE DEPARTMENT TO REMEDIATE THE SOIL CONTAMINATION AND MONITOR FOR WORKER PROTECTION.

MWRD GENERAL NOTES

- THE MWRD LOCAL SEWER SYSTEMS SECTION FIELD OFFICE MUST BE NOTIFIED AT LEAST TWO (2) WORKING DAYS PRIOR TO THE COMMENCEMENT OF ANY WORK (CALL 708-588-4055).
- ELEVATIONS ARE BASED ON VILLAGE OF OAK PARK DATUM. VILLAGE OF OAK PARK DATUM IS BASED ON CITY OF CHICAGO ELEVATION DATUM WHERE A FACTOR OF 579.48 CAN BE ADDED TO THE ELEVATIONS TO ACHIEVE NGVD 1929 ELEVATIONS.
- NO FLOOR DRAINS EXCEPT AS NOTED.
- NO FOOTING DRAINS AND DOWNSPOUTS.
- ALL SANITARY PIPE MATERIALS AND JOINTS (AND STORM SEWER PIPE MATERIALS AND JOINTS IN A COMBINED SEWER AREA) SHALL CONFORM TO: WATER MAIN QUALITY PVC SDR 26 8" TO 12" DIAMETER PRESSURE PIPE AND FABRICATED FITTINGS IN ACCORDANCE WITH ASTM D 2241. PVC MATERIAL SHALL CONFORM TO NSF STANDARD 14 AND BE DESIGNATED CLASS 12454 C (PVC 1120) IN CONFORMANCE WITH ASTM D 1784. THE SDR RATING SHALL BE LIMITED TO A MINIMUM PRESSURE RATING OF 160 PSI OR GREATER AT 23°C (73.4°F).
- ELASTOMERIC SEALS (GASKETS) USED FOR PUSH-ON JOINTS SHALL COMPLY WITH ASTM STANDARD F477 AND SHALL BE PRESSURE RATED IN ACCORDANCE WITH ASTM D3139.
- ALL SANITARY SEWER CONSTRUCTION (AND STORM SEWER CONSTRUCTION IN COMBINED SEWER AREAS), REQUIRES STONE BEDDING WITH STONE 1/4" TO 1" IN SIZE, WITH MINIMUM BEDDING THICKNESS EQUAL TO 1/4 THE OUTSIDE DIAMETER OF THE SEWER PIPE, BUT NOT LESS THAN FOUR (4) INCHES NOR MORE THAN EIGHT (8) INCHES. MATERIAL SHALL BE CA-11 OR CA-13 AND SHALL BE EXTENDED AT LEAST 12" ABOVE THE TOP OF THE PIPE WHEN USING PVC.
- "BAND SEAL" OR SIMILAR FLEXIBLE-TYPE COUPLINGS SHALL BE USED IN THE CONNECTION OF SEWER PIPES OF DISSIMILAR MATERIALS.
- WHEN CONNECTING TO AN EXISTING SEWER MAIN BY MEANS OTHER THAN AN EXISTING WYE, TEE, OR AN EXISTING MANHOLE, ONE OF THE FOLLOWING METHODS SHALL BE USED:
 - CIRCULAR SAW-CUT OF SEWER MAIN BY PROPER TOOLS ("SEWER-TAP" OR SIMILAR) AND PROPER INSTALLATION OF HUB-WYE SADDLE OR HUB-TEE SADDLE.
 - REMOVE AN ENTIRE SECTION OF PIPE (BREAKING ONLY THE TOP OF ONE BELL) AND REPLACE WITH A WYE OR TEE BRANCH SECTION.
 - WITH PIPE CUTTER, NEATLY AND ACCURATELY CUT OUT DESIRED LENGTH OF PIPE FOR INSERTION OF PROPER FITTING, USING "BAND SEAL" OR SIMILAR COUPLINGS TO HOLD IT FIRMLY IN PLACE.
- WHENEVER A SANITARY/COMBINED SEWER CROSSES UNDER A WATERMAIN, THE MINIMUM VERTICAL DISTANCE FROM THE TOP OF THE SEWER TO THE BOTTOM OF THE WATERMAIN SHALL BE 18 INCHES. FURTHERMORE, A MINIMUM HORIZONTAL DISTANCE OF 10 FEET BETWEEN SANITARY/COMBINED SEWERS AND WATERMANS SHALL BE MAINTAINED UNLESS: THE SEWER IS LAID IN A SEPARATE TRENCH, KEEPING A MINIMUM 18" VERTICAL SEPARATION; OR THE SEWER IS LAID IN THE SAME TRENCH WITH THE WATERMAIN LOCATED AT THE OPPOSITE SIDE ON A BENCH OF UNDISTURBED EARTH, KEEPING A MINIMUM 18" VERTICAL SEPARATION. IF EITHER THE VERTICAL OR HORIZONTAL DISTANCES DESCRIBED ABOVE CAN NOT BE MAINTAINED, OR THE SEWER CROSSES ABOVE THE WATERMAIN, THE SEWER SHALL BE CONSTRUCTED TO WATERMAIN STANDARDS.
- ALL SANITARY MANHOLES, (AND STORM MANHOLES IN COMBINED SEWER AREAS), SHALL HAVE A MINIMUM INSIDE DIAMETER OF 48 INCHES, AND SHALL BE CAST IN PLACE OR PRE-CAST REINFORCED CONCRETE.
- ALL CONNECTIONS TO MANHOLES AND CATCH BASINS SHALL INCORPORATE A RUBBER BOOT CONNECTION CONFORMING TO ASTM C-923.
- MANHOLE, TYPE A AND CATCH BASIN, TYPE A SHALL CONFORM TO THE PROJECT SPECIFIC DETAILS. A "DOGHOUSE MANHOLE" SHALL BE USED FOR MANHOLE, TYPE A 5' DIAMETER FOR THOSE MANHOLES INSTALLED ON EXISTING LIVE SEWERS HAVING A 15" DIAMETER OR GREATER.

TERRA ENGINEERING LTD. 225 W. OHIO ST., FOURTH FL. CHICAGO, IL 60654 (312)467-0123

STATE OF ILLINOIS DEPARTMENT OF TRANSPORTATION

GENERAL NOTES AND INDEX OF SHEETS

FILE NAME = DIRTE38-shr-gemnote01.dgn	USER NAME = IDOT	DESIGNED - TM	REVISED - 04/02/2010	SCALE: 1" = 20'	SHEET NO. OF SHEETS	STA. TO STA.	F.A.P. RTE. 347	SECTION 09-00248-00-RS	COUNTY COOK	TOTAL SHEETS 274	SHEET NO. 2	CONTRACT NO. 63432	ILLINOIS FED. AID PROJECT
---------------------------------------	------------------	---------------	----------------------	-----------------	---------------------	--------------	-----------------	------------------------	-------------	------------------	-------------	--------------------	---------------------------

PAY ITEM CODE NO.	SI	SP	PAY ITEM DESCRIPTION	UNIT	TOTAL	ITEP			IDOT		NON PARTICIPATING			
						LANDSCAPING (80/20)	LIGHTING (80/20)	LIGHTING (50/50)	ROADWAY	TRAFFIC SIGNALS	MAINTENANCE	LANDSCAPING	ROADWAY	LIGHTING
						Y003	YO30-1E	YO30-1E	I000	Y031-1F	Y007			
20100110			TREE REMOVAL (6 TO 15 UNITS DIAMETER)	UNIT	40	40								
20101000			TEMPORARY FENCE	FOOT	39	39								
20101200			TREE ROOT PRUNING	EACH	17	5						12		
20101350			TREE PRUNING (OVER 10 INCH DIAMETER)	EACH	17	5						12		
20800150			TRENCH BACKFILL	CU YD	3,694	2808			762				124	
21101615			TOPSOIL FURNISH AND PLACE, 4"	SQ YD	2,586							2586		
21101810			COMPOST FURNISH AND PLACE, 3"	SQ YD	456	351						105		
25000400			NITROGEN FERTILIZER NUTRIENT	POUND	12	9.60						2.40		
25000500			PHOPHORUS FERTILIZER NUTRIENT	POUND	4	3.20						0.80		
25000600			POTASSIUM FERILIZER NUTRIENT	POUND	8	6.30						1.70		
25200110			SODDING, SALT TOLERANT	SQ YD	2,716							2716		
25400100			PERENNIAL PLANTS	UNIT	16	12.79						3.55		
28000400			PERIMETER EROSION BARRIER	FOOT	117	117								
28000510			INLET FILTERS	EACH	133	65						68		
28200200			FILTER FABRIC	SQ YD	1,742	1633						109		
31101000			SUB-BASE GRANULAR MATERIAL, TYPE B	TON	10,643	6671			2854			792	326	
35200600			EARTH EXCAVATION	CU YD	9,490	6356.0			2353			490.0	291	
35300500			P.C.C. BASE COURSE 10"	SQ YD	1,138	775			363					
35400500			PORTLAND CEMENT CONCRETE BASE COURSE WIDENING 10"	SQ YD	82	82								
40300200			BITUMINOUS MATERIALS (PRIME COAT)	TON	90.2				84.90				5.30	
40600300			AGGREGATE (PRIME COAT)	TON	111				104.00				7.00	
40600525			LEVELING BINDER (HAND METHOD), N50	TON	60				60.00					
40600895			CONSTRUCTING TEST STRIP	EACH	2				2					
40600982			HOT-MIX ASPHALT SURFACE REMOVAL - BUTT JOINT	SQ YD	4,326				3,654				672	
40600990			TEMPORARY RAMP	SQ YD	3,920				3,920					
40603240			POLYMERIZED HOT-MIX ASPHALT BINDER COURSE, IL-19.0, N90	TON	6,164				5797.20				366.30	
40603595			POLYMERIZED HOT-MIX ASPHALT SURFACE COURSE, MIX "F", N90	TON	4,315				4058.50				256.80	
42001300			PROTECTIVE COAT	SQ YD	21,429	18148.0							3280.7	
42300400			PORTLAND CEMENT CONCRETE DRIVEWAY PAVEMENT, 8 INCH	SQ YD	1,249	1249								
42400430	*		PCC SIDEWALK 5 INCH, SPECIAL	SQ FT	131,570	110631							20939	
42400800			DETECTABLE WARNINGS	SQ FT	1,028	1028								
44000100			PAVEMENT REMOVAL	SQ YD	5,779	4797			363				619	
44000198	*		HOT-MIX ASPHALT SURFACE REMOVAL, VARIABLE DEPTH	SQ YD	41,766				39777				1989	
44000200			DRIVEWAY PAVEMENT REMOVAL	SQ YD	1,289	1281							8	
44000500			COMBINATION CURB AND GUTTER REMOVAL	FOOT	17,385	3814			12011				1560	
44000600			SIDEWALK REMOVAL	SQ FT	106,149	91411							14738	
44002000	*		CONCRETE CURB REMOVAL	FOOT	45	11							34	
44201325			CLASS C PATCHES, TYPE I, 8 INCH	SQ YD	7								7	
44201329			CLASS C PATCHES, TYPE II, 8 INCH	SQ YD	11								11	
44201737			CLASS D PATCHES TYPE I, 8 INCH	SQ YD	4	4								
44201741			CLASS D PATCHES TYPE II, 8 INCH	SQ YD	44	38							6	
44201745			CLASS D PATCHES TYPE III, 8 INCH	SQ YD	237	237								
44201747			CLASS D PATCHES TYPE IV, 8 INCH	SQ YD	577	531							46	
44300100			AREA REFLECTIVE CRACK CONTROL TREATMENT	SQ YD	43,074				43074					
50800305	*		WELDED WIRE FABRIC 6X6	SQ YD	6,231	4142							2089	
55039700	*		STORM SEWERS TO BE CLEANED	FOOT	14357.00						14357.00			
56400100			FIRE HYDRANTS TO BE MOVED	EACH	1	1								
56500600	*		DOMESTIC WATER SERVICE BOXES TO BE ADJUSTED	EACH	172	158			8				6	
60107600			PIPE UNDERDRAINS 4"	FOOT	959	828						131		
60200105			CATCH BASINS, TYPE A, 4'-DIAMETER, TYPE 1 FRAME, OPEN LID	EACH	95	54			38				3	
60218400			MANHOLES, TYPE A, 4' - DIAMETER, TYPE 1 FRAME, CLOSED LID	EACH	61	40			16				5	
60221100			MANHOLES, TYPE A, 5' DIAMETER, TYPE 1 FRAME CLOSED LID	EACH	9	4			5					
60250200			CATCH BASINS TO BE ADJUSTED	EACH	80				55				25	
60500040			REMOVING MANHOLES	EACH	9	9								
60500050			REMOVING CATCH BASINS	EACH	15	15								
60600605			CONCRETE CURB, TYPE B	FOOT	200	200								
60611600	*		COMBINATION CONCRETE CURB AND GUTTER, (SPECIAL)	FOOT	18,961	5199			12297				1465	
66900200			NON-SPECIAL WASTE DISPOSAL	CU YD	715	457			165			93		
66900450			SPECIAL WASTE PLANS AND REPORT	L SUM	1							1		
66900530			SOIL DISPOSAL ANALYSIS	EACH	5	4			1					
67000400			ENGINEER'S FIELD OFFICE, TYPE A	CAL MO	15				15					
67100100			MOBILIZATION	L SUM	1	0.61			0.29				0.10	
70101800	*		TRAFFIC CONTROL AND PROTECTION, (SPECIAL)	L SUM	1				1.00					
70300220			TEMPORARY PAVEMENT MARKING - LINE 4"	FOOT	67,922				67922					
70300240			TEMPORARY PAVEMENT MARKING - LINE 6"	FOOT	7,579	7579								
70300260			TEMPORARY PAVEMENT MARKING - LINE 12"	FOOT	1,519				1519					
70300280			TEMPORARY PAVEMENT MARKING - LINE 24"	FOOT	3,153				3153					
72000100	X		SIGN PANEL - TYPE 1	SQ FT	256	256								
72400100	X		REMOVE SIGN PANEL ASSEMBLY - TYPE A	EACH	76	76								
72400310	X		REMOVE SIGN PANEL - TYPE 1	SQ FT	398	398								
72400710	X		RELOCATE SIGN PANEL - TYPE 1	SQ FT	1,086	1086								
78000100	X		THERMOPLASTIC PAVEMENT MARKING - LETTERS AND SYMBOLS	SQ FT	1,555				1555					
78000200	X		THERMOPLASTIC PAVEMENT MARKING - LINE 4"	FOOT	14,304				14304					
78000400	X		THERMOPLASTIC PAVEMENT MARKING - LINE 6"	FOOT	5,382	3472			1910					
78000600	X		THERMOPLASTIC PAVEMENT MARKING - LINE 12"	FOOT	298				298					
78000650	X		THERMOPLASTIC PAVEMENT MARKING - LINE 24"	FOOT	925				925					
78100100	X		RAISED REFLECTIVE PAVEMENT MARKER	EACH	402				402					
78300200	X		RAISED REFLECTIVE PAVEMENT MARKER REMOVAL	EACH	402				402					

FILE NAME = DIRTE38-shr-50001.dgn	USER NAME = IDOT	DESIGNED - BB	REVISED - 04/02/2010
		DRAWN - TM	REVISED -
	PLOT SCALE = 20.0000' / IN.	CHECKED - JB	REVISED -
	PLOT DATE = 3/11/2010	DATE -	REVISED -

**STATE OF ILLINOIS
DEPARTMENT OF TRANSPORTATION**

SUMMARY OF QUANTITIES			
SCALE: 1" = 20'	SHEET NO. OF SHEETS	STA. TO STA.	

F.A.P. RTE. 347	SECTION 09-00248-00-RS	COUNTY COOK	TOTAL SHEETS 274	SHEET NO. 3
ILLINOIS FED. AID PROJECT			CONTRACT NO. 63432	

TERRA
 ENGINEERING LTD.
 225 W. OHIO ST., FOURTH FL.
 CHICAGO, IL 60654
 (312)467-0123

PAY ITEM CODE NO.	SI	SP	PAY ITEM DESCRIPTION	UNIT	TOTAL	ITEP			IDOT		NON PARTICIPATING			
						LANDSCAPING (80/20)	LIGHTING (80/20)	LIGHTING (50/50)	ROADWAY	TRAFFIC SIGNALS	MAINTENANCE	LANDSCAPING	ROADWAY	LIGHTING
						Y003	YO30-1E	YO30-1E	I000	Y031-1F	Y007			
80400100	X		ELECTRIC SERVICE INSTALLATION	EACH	6		6							
81000800	X		CONDUIT IN TRENCH, 3" DIA., GALVANIZED STEEL	FOOT	1,400		1400							
81018700	X		CONDUIT PUSHED, 3" DIA., GALVANIZED STEEL	FOOT	4,600		4284							316
81400100	X		HANDHOLE	EACH	77		62							15
81400115	X	*	HANDHOLE TO BE ADJUSTED	EACH	59	48			5				6	
81400215	X	*	HEAVY-DUTY HANDHOLE TO BE ADJUSTED	EACH	9				8				1	
81603130	X	*	UNIT DUCT, 600V, 2-1C NO. 10, 1/C NO. 10 GROUND, (EPR-TYPE RHW), 3/4" DIA. POLYETHYLENE	FOOT	1,310		1310							
81603150	X		UNIT DUCT, 600V, 2-1C NO. 4, 1/C NO. 6 GROUND, (EPR-TYPE RHW), 1" DIA. POLYETHYLENE	FOOT	6,919		6713							206
81603200	X		UNIT DUCT, 600V, 3-1C NO. 2, 1/C NO. 4 GROUND, (EPR-TYPE RHW), 1 1/4" DIA. POLYETHYLENE	FOOT	2,700		2700							
81603210	X		UNIT DUCT, 600V, 3-1C NO. 4, 1/C NO. 6 GROUND, (EPR-TYPE RHW), 1 1/4" DIA. POLYETHYLENE	FOOT	13,377		13377							
81700110	X		ELECTRIC CABLE IN CONDUIT, 600V (EPR-TYPE RHW) 1/C NO.10	FOOT	15,620		15620							
81700355	X		ELECTRIC CABLE IN CONDUIT, 600V (EPR-TYPE RHW) 3-1/C NO.2	FOOT	1,540		1540							
81900200	X		TRENCH AND BACKFILL FOR ELECTRICAL WORK	FOOT	23,762		23762							
82500360	X		LIGHTING CONTROLLER , BASE MOUNTED, 480 VOLT, 100 AMP	EACH	6		6							
83600200	X		LIGHT POLE FOUNDATION, 24" DIAMETER	FOOT	1,524		1380	144						
84200500	X		REMOVAL OF EXISTING LIGHTING UNIT, SALVAGE	EACH	7		7							
84200600	X		REMOVAL OF EXISTING LIGHTING UNIT, NO SALVAGE	EACH	138		138							
84200806	X	*	REMOVAL OF POLE FOUNDATION	EACH	137		137							
84500110	X		REMOVAL OF LIGHTING CONTROLLER	EACH	5		5							
84500120	X		REMOVAL OF ELECTRIC SERVICE INSTALLATION	EACH	5		5							
84500130	X		REMOVAL OF LIGHTING CONTROLLER FOUNDATION	EACH	4		4							
85100100	X	*	PAINT EXISTING TRAFFIC SIGNAL EQUIPMENT	EACH	5	5								
87900200	X		DRILL EXISTING HANDHOLE	EACH	1		1							
88600600	X	*	DETECTOR LOOP REPLACEMENT	FOOT	2,183					2183				
89000100	X		TEMPORARY TRAFFIC SIGNAL INSTALLATION	EACH	5					5				
89502300	X		REMOVE ELECTRIC CABLE FROM CONDUIT	FOOT	210		210							
A2004424	X		TREE, GINKGO BILOBA (GINKGO), 3" CALIPER, BALLED AND BURLAPPED	EACH	7	7								
A2005024	X		TREE, GYMNOCLADUS DIOICUS (KENTUCKY COFFEETREE), 3" CALIPER, BALLED AND BURLAPPED	EACH	14	14								
A2004824	X		TREE, GLEDITSIA TRIACANTHOS INERMIS SKYLINE (SKYLINE THORNLESS COMMON HONEYLOCUST), 3" CALIPER, BALLED AND BUR	EACH	14	13						1		
B2005726	X		TREE, PYRUS CALLERYANA CHANTICLEER (CHANTICLEER CALLERY PEAR), 3" CALIPER, TREE FORM, BALLED AND BURLAPPED	EACH	2	2								
B2005524	X		TREE, PYRUS CALLERYANA ARISTOCRAT (ARISTOCRAT CALLERY PEAR), 3" CALIPER, TREE FORM, BALLED AND BURLAPPED	EACH	19	12						7		
A2008750	X		TREE, ULMUS X PATRIOT (PATRIOT ELM), 3" CALIPER, TREE FORM, BALLED AND BURLAPPED	EACH	6	6								
C2C10218	X		SHRUB, SPIREA JAPONICA LITTLE PRINCESS (LITTLE PRINCESS JAPANESE SPIREA), 18" HEIGHT, CONTAINER	EACH	13	13								
LR420010	X	*	PORTLAND CEMENT CONCRETE PAVEMENT (SPECIAL)	SQ YD	2,215	2215								
LR430050	X	*	CONCRETE PAVER SIDEWALK	SQ YD	2,640	1801							839	
X0301578	X	*	REMOVE EXISTING EQUIPMENT	L SUM	1		1							
X0301828	X	*	ENGINEERED BARRIER	SQ YD	150				150					
X0321631	X	*	REMOVAL OF LUMINAIRE	EACH	2		2							
X0321905	X	*	STORM SEWERS, TYPE 1, WATER MAIN QUALITY PIPE, 12"	FOOT	2,453	1930			523					
X0322712	X	*	STREET NAME SIGN	EACH	124	124								
X0322917	X	*	PROPOSED STORM SEWER CONNECTION TO EXISTING MANHOLE	EACH	32	20			10				2	
X0323434	X	*	FILL EXISTING STRUCTURES	EACH	35	35								
X0323574	X	*	MAINTENANCE OF LIGHTING SYSTEM	CAL MO	16		16							
X0325737	X	*	TEMPORARY TRAFFIC SIGNAL TIMING	EACH	5					5				
X0326263	X	*	EQUIPMENT CABINET	EACH	20		12							8
X0326654	X	*	ORNAMENTAL LIGHT UNIT, COMPLETE	EACH	117		117							
X0326737	X	*	SANITARY SEWER PVC SDR 26 (WATER MAIN QUALITY), 8"	FOOT	2,233	1409			699				125	
X0350800	X	*	BOLLARDS	EACH	3	3								
X0539800	X	*	TREE GRATES	EACH	21	21								
X4022000	X	*	TEMPORARY ACCESS (COMMERCIAL ENTRANCE)	EACH	60	60								
X4023000	X	*	TEMPORARY ACCESS (ROAD)	EACH	41	41								
Z0013798	X	*	CONSTRUCTION LAYOUT	L SUM	1	0.61			0.29				0.10	
Z0018500	X	*	DRAINAGE STRUCTURES TO BE CLEANED	EACH	84					84				
Z0018900	X	*	DRILL AND GROUT DOWEL BARS	EACH	11,598	4716			6149				733	
Z0019600	X	*	DUST CONTROL WATERING	UNIT	100	100								
Z0076600	X	*	TRAINEES	HOURL	2,500	1525			725				250	
XX000541	X	*	EXPLORATORY EXCAVATION	CU YD	16								16	
XX000856	X	*	MAILBOX REMOVAL AND RELOCATION	EACH	6	3						3		
XX001011	X	*	BICYCLE RACKS	EACH	12	8						4		
XX001164	X	*	LUMINAIRE, HIGH PRESSURE SODIUM, SPECIAL	EACH	2			2						
XX001532	X	*	PROJECT SIGN	EACH	8	8								
XX002258	X	*	STRUCTURES TO BE ADJUSTED	EACH	243	55			141				47	
XX002948	X	*	TEMPORARY ACCESS WALK	EACH	310	310								
XX003614	X	*	RECEPTACLE (GFI TYPE) WITH WEATHERPROOF COVER	EACH	60	49								11
XX004101	X	*	ORNAMENTAL METAL FENCE	FOOT	75	32						43		
XX004533	X	*	SOIL PLANTING MIXTURE	CU YD	346	346								
XX004895	X	*	PIPE UNDERDRAIN CLEANOUT, COMPLETE	EACH	67	59						8		
XX005043	X	*	ORNAMENTAL SIGN POST	EACH	100	100								
XX005735	X	*	PLANTER CURB	FOOT	2,143	1769						374		
XX006598	X	*	ADDITIONAL GROUND ROD INSTALLATION	EACH	153		153							
XX006736	X	*	PLANTER FENCE (SPECIAL)	FOOT	2,143	1769						374		
XX006775	X	*	ARCHITECTURAL PRE-CAST CONCRETE - BENCH PLANTER SYSTEM (SPECIAL)	EACH	47	36						11		
XX006783	X	*	SIGN PANEL, FURNISHED AND INSTALLED	EACH	126	126								
XX007215	X	*	CONCRETE PLANTER WALL	CU YD	15	11.2						3.3		
XX007877	X	*	BICYCLE RACKS - FURNISH	EACH	13	10						3		
XX007978	X	*	ARCHITECTURAL LIGHTING SYSTEM	EACH	10			10						
XX007980	X	*	PLANTING SOIL FURNISH AND PLACE, 24"	SQ YD	540	435						105		
C2C07263	X	*	SHRUB, ROSA 'FLOWER CARPET RED' (FLOWER CARPET RED SHRUB ROSE), CONTAINER GROWN, 3-GALLON	EACH	235	197						38		

FILE NAME = DIRTE38-sht-50082.dgn	USER NAME = IDOT	DESIGNED - BB	REVISED - 04/02/2010
		DRAWN - TM	REVISOR -
		CHECKED - JB	REVISOR -
		DATE -	REVISOR -

**STATE OF ILLINOIS
DEPARTMENT OF TRANSPORTATION**

SUMMARY OF QUANTITIES			
SCALE:	SHEET NO.	OF SHEETS	STA. TO STA.
1" = 20'			

F.A.P. RTE.	SECTION	COUNTY	TOTAL SHEETS	SHEET NO.
347	09-00248-00-RS	COOK	274	4
CONTRACT NO. 63432				
ILLINOIS FED. AID PROJECT				

**MAINTENANCE OF TRAFFIC
GENERAL NOTES - ALL STAGES**

1. THE STAGING PROCEDURES PRESENTED HERIN ARE THE SUGGESTED SEQUENCE OF CONSTRUCTION OPERATIONS. IT IS THE CONTRACTORS OPTION TO SUBMIT AN ALTERNATIVE STAGING PLAN TO THE ENGINEER FOR APPROVAL.
2. TRAFFIC CONTROL AND PROTECTION SHALL BE PERFORMED IN ACCORDANCE WITH THE TRAFFIC CONTROL PLAN AND SECTION 701 OF THE STANDARD SPECIFICATIONS AS AMENDED BY THE SPECIAL PROVISION FOR CONSTRUCTION ZONE TRAFFIC CONTROL LRS-3.
3. EXISTING TRAFFIC CONTROL SIGNS AND DEVICES WILL BE REMOVED BY THE CONTRACTOR AFTER THE PROPOSED TRAFFIC CONTROL REQUIREMENTS ARE MET OR AS AUTHORIZED BY THE ENGINEER. ANY SIGNS OR DEVICES LEFT IN PLACE AT THIS TIME ARE TO BE PROTECTED FROM DAMAGE BY THE CONTRACTOR AND ANY DAMAGE CAUSED BY THIS WORK WILL BE PAID FOR BY THE CONTRACTOR.
4. THE FOLLOWING TRAFFIC CONTROL STANDARDS ARE THE MINIMUM REQUIREMENTS FOR THE TRAFFIC CONTROL FOR THIS PROJECT: 701501, 701502, 701602, 701701, 701801, 701901, TC-10, TC-14, TC-22 AND TC-26.
5. TEMPORARY CONCRETE BARRIER, DRUMS, AND TEMPORARY PAVEMENT MARKINGS SHALL BE INSTALLED THROUGHOUT THE LIMITS OF THE WORK ZONE AS SHOWN ON THE MAINTENANCE OF TRAFFIC TYPICAL SECTIONS AND PLAN SHEETS.
6. THE CONTRACTOR SHALL MAINTAIN TWO-WAY TRAFFIC ON ROOSEVELT RD. THROUGHOUT THE DURATION OF CONSTRUCTION. TRUCK ACCESS TO BUSINESS SHALL BE MAINTAINED AT ALL TIMES.
7. THE CONTRACTOR SHALL BEGIN WORK FROM HARLEM AVE. AND PROGRESS EAST ALONG ROOSEVELT RD. TO AUSTIN BLVD.
8. EACH STAGE, INCLUDING THE THREE CORRESPONDING SUB-STAGES, SHALL BE COMPLETED PRIOR TO STARTING THE NEXT STAGE.
9. THE CONTRACTOR WILL BE PERMITTED TO CLOSE A QUADRANT OF EACH SIDE STREET AT A TIME.
10. THE CONTRACTOR SHALL REMOVE ALL EXISTING PAVEMENT MARKINGS AND SIGNS WHEN IN CONFLICT WITH PROPOSED TEMPORARY PAVEMENT MARKINGS AND SIGNS.
11. WHERE THE PROPOSED WORK WILL IMPACT ALL OF THE ENTRANCES TO A PROPERTY THE CONTRACTOR SHALL STAGE THE WORK TO MAINTAIN BI-DIRECTIONAL ACCESS AT ALL TIMES. STAGING SHALL BE COORDINATED WITH THE PROPERTY OWNER AND APPROVED BY THE ENGINEER.
12. VERTICAL PANELS, TYPE I BARRICADES OR DRUMS SHALL BE AT THE FAR EDGE OF THE OUTSIDE SHOULDER WHERE SHOWN IN THE PLANS. SPACING SHALL BE AT 25 FOOT CENTERS ON THE TAPER SECTIONS AND AT 25 FOOT CENTERS ON TANGENTS UNLESS OTHERWISE SHOWN.

13. DRUMS SHALL BE EQUIPPED WITH STEADY BURNING LIGHTS AND PLACED AT 25 FOOT CENTERS ON TAPER SECTIONS AND AT 25 FOOT CENTERS ON TANGENT.
14. ALL ADVANCED WARNING SIGNS AND TEMPORARY PAVEMENT MARKINGS SHALL BE IN PLACE AND APPROVED BY THE ENGINEER PRIOR TO THE COMMENCEMENT OF ANY STAGE OR SUBSTAGE OF CONSTRUCTION.
15. TRAFFIC CONTROL SHALL BE PAID FOR AS TRAFFIC CONTROL AND PROTECTION (SPECIAL).
16. ARROW BOARDS ARE REQUIRED FOR LANE CLOSURES AS SHOWN ON THE TRAFFIC CONTROL STANDARDS AND PLAN SHEETS. ARROW BOARDS WILL NOT BE PAID FOR SEPARATELY, BUT SHALL BE INCLUDED IN THE COST OF TRAFFIC CONTROL AND PROTECTION (SPECIAL).
17. WHERE THE HEIGHT DIFFERENCE BETWEEN ADJACENT PAVEMENT SURFACES EXCEEDS 1 INCH THE CONTRACTOR SHALL MILL AND/OR PLACE HMA PAVEMENT TO REDUCE THE DROP OFF TO LESS THAN 1 INCH. THIS WILL BE REQUIRED AT LOCATIONS WHERE TRAFFIC MUST CROSS THE DROP OFF SUCH AS ENTRANCES AND INTERSECTIONS, OR AS DIRECTED BY THE ENGINEER. NO MILLING OR LEVELING BINDER SHALL BE PLACED ON THE PROPOSED HMA PAVEMENT SURFACE. IT MAY BE NECESSARY TO DELAY MILLING OF THE EXISTING PAVEMENT AT THESE LOCATIONS UNTIL THE CONTRACTOR IS PREPARED TO PLACE THE PROPOSED HMA PAVEMENT. THIS WORK SHALL BE MEASURED ON A SQUARE YARD BASIS AND PAID FOR AS HMA SURFACE REMOVAL BUTT JOINT.
18. THE FURNISHING, INSTALLATION AND RELOCATION OF ALL TEMPORARY TRAFFIC CONTROL DEVICES SHALL BE IN ACCORDANCE WITH THE MANUAL ON UNIFORM TRAFFIC CONTROL DEVICES AND THE STATE STANDARD SPECIFICATIONS. THIS WORK SHALL BE INCLUDED IN THE LUMP SUM COST FOR TRAFFIC CONTROL AND PROTECTION (SPECIAL).

19. ALL CONFLICTING TRAFFIC SIGNS SHALL BE COVERED AS DIRECTED BY THE ENGINEER. THIS WORK SHALL NOT BE PAID FOR SEPARATELY, BUT SHALL BE CONSIDERED INCIDENTAL TO THE LUMP SUM COST FOR TRAFFIC CONTROL AND PROTECTION (SPECIAL).
20. ALL SIDE STREETS AND DRIVEWAYS SHALL BE MAINTAINED DURING ALL STAGES OF CONSTRUCTION, WITH THE EXCEPTION OF SHORT TERM CLOSURES FOR HOT-MIX ASPHALT PAVING. ALL CLOSURES SHALL BE COORDINATED WITH THE ENGINEER AND THE PROPERTY OWNER.
21. PROPOSED STORM SEWER SHALL BE CONSTRUCTED PRIOR TO PLACING THE PROPOSED HMA PAVEMENT FOR EACH STAGE. STORM SEWER PIPES THAT EXTEND ACROSS SUB-STAGES SHALL BE PLACED TO THE LIMITS POSSIBLE IN EACH SUB-STAGE AND COMPLETED PRIOR TO COMMENCING WITH THE NEXT SUB-STAGE UNLESS OTHERWISE APPROVED BY THE ENGINEER. SHORT TERM LANE CLOSURES, SUCH AS IDOT STANDARD DRAWINGS 701502 AND 701602, SHALL BE USED TO COMPLETE THE CONNECTION OF THE PROPOSED STORM SEWER PIPES TO THE EXISTING STORM SEWER SYSTEM. ONE 11 FOOT LANE MUST BE MAINTAINED IN EACH DIRECTION AT ALL TIMES EXCEPT AS NOTED IN THE MAINTENANCE OF TRAFFIC PLANS.
22. FINAL PAVEMENT SURFACE SHALL BE PLACED CONTINUOUSLY AFTER COMPLETING ALL THREE STAGES. PLACEMENT OF FINAL PAVEMENT SURFACE BY INDIVIDUAL STAGE WILL NOT BE PERMITTED.
23. PROPOSED CURB & GUTTER, SIDEWALK, AND LANDSCAPING SHALL BE PLACED PRIOR TO PLACING FINAL PAVEMENT SURFACE TO AVOID DAMAGE TO THE PAVEMENT.
24. THE CONTRACTOR SHALL COORDINATE ALL BUS STOP ACCOMMODATIONS WITH THE CTA TO MAINTAIN BUS ACCESS.
25. CONTRACTOR SHALL PROTECT PROPOSED MEDIAN ISLANDS AND DECORATIVE CROSSWALKS DURING SUBSEQUENT STAGES OF CONSTRUCTION. SURFACE OF ISLANDS AND DECORATIVE CROSSWALKS SHALL BE PROTECTED FROM CONSTRUCTION EQUIPMENT, IMPACT DAMAGE, AND MARRING BY CONSTRUCTION DEBRIS SUCH AS ASPHALT, CONCRETE, AND LANDSCAPING MATERIALS. METHOD OF PROTECTION SHALL BE APPROVED BY THE ENGINEER PRIOR TO USE. MEDIAN ISLANDS AND DECORATIVE CROSSWALKS SHALL BE STAIN FREE AT THE TIME OF ACCEPTANCE.
26. LEFT TURNS FROM ROOSEVELT ROAD SHALL BE RESTRICTED DURING CONSTRUCTION EXCEPT WHERE A DEDICATED LEFT TURN LANE IS PROVIDED AND AT SIGNALIZED INTERSECTIONS.

**MAINTENANCE OF TRAFFIC
SUGGESTED STAGING PLAN**

- SUB-STAGE A (SOUTH SIDE OF ROOSEVELT ROAD)
INSTALL TEMPORARY TRAFFIC CONTROL FOR STAGE
CONSTRUCT NEW LIGHT POLE FOUNDATIONS
INSTALL STORM SEWER STRUCTURES AND LATERALS
REMOVE AND REPLACE EXISTING SIDEWALK, CROSSWALK, AND CURB & GUTTER
INSTALL LANDSCAPING
MILL EXISTING PAVEMENT AND CONSTRUCT CURB BUMP OUTS
PAVE PROPOSED HMA BINDER COURSE
INSTALL PROPOSED TRAFFIC CONTROL
- SUB-STAGE B (CENTER OF ROOSEVELT ROAD)
INSTALL TEMPORARY TRAFFIC CONTROL FOR STAGE
INSTALL/EXTEND STORM SEWER LATERALS
MILL EXISTING PAVEMENT
PAVE PROPOSED HMA BINDER COURSE
INSTALL PROPOSED TRAFFIC CONTROL
- SUB-STAGE C3 (NORTH SIDE OF ROOSEVELT ROAD)
INSTALL TEMPORARY TRAFFIC CONTROL FOR STAGE
CONSTRUCT NEW LIGHT POLE FOUNDATIONS
INSTALL STORM SEWER STRUCTURES AND LATERALS
REMOVE AND REPLACE EXISTING SIDEWALK, CROSSWALK, AND CURB & GUTTER
INSTALL NEW LANDSCAPING
MILL EXISTING PAVEMENT AND CONSTRUCT CURB BUMP OUTS
PAVE PROPOSED HMA BINDER COURSE
- PROJECT COMPLETION
PAVE PROPOSED HMA SURFACE
INSTALL REMAINDER OF PROPOSED TRAFFIC CONTROL
REMOVE ALL TEMPORARY TRAFFIC CONTROL AND REOPEN ENTIRE ROADWAY

MAINTENANCE OF TRAFFIC SCHEMATIC

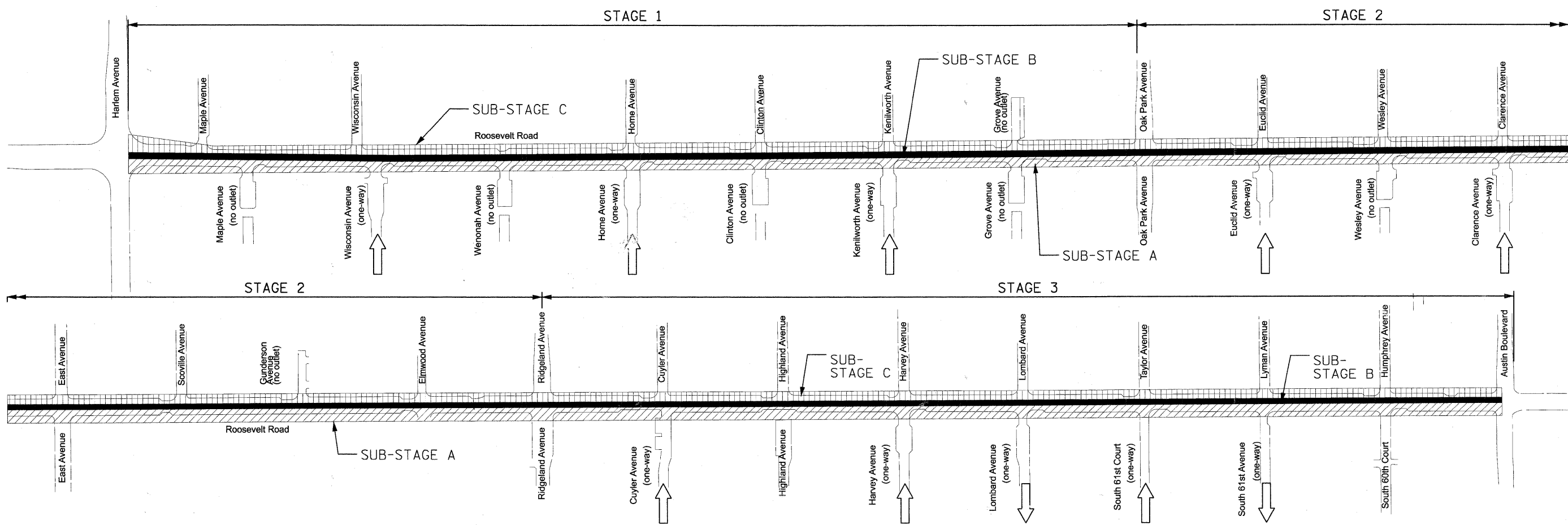
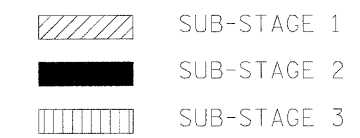

FILE NAME = DIRTE38-shr-staging01.dgn	USER NAME = IDOT	DESIGNED - MD	REVISED - 04/09/2010	STATE OF ILLINOIS DEPARTMENT OF TRANSPORTATION	MAINTENANCE OF TRAFFIC GENERAL NOTES			F.A.P. RTE. 347	SECTION 09-00248-00-RS	COUNTY COOK	TOTAL SHEETS 274	SHEET NO. 21
	PLOT SCALE = 20,0000 "/ IN.	DRAWN - LF	REVISI -		SCALE: 1" = 20'	SHEET NO. OF SHEETS	STA. TO STA.	ILLINOIS FED. AID PROJECT				
	PLOT DATE = 4/9/2010	CHECKED - JB	REVISI -									
		DATE -	REVISI -		CONTRACT NO. 63432							



LEGEND:

- G — GAS PIPE
- G — ABANDONED GAS PIPE
- A — ELECTRIC AERIAL CABLE
- E — ELECTRIC CABLE
- T — TELEPHONE CABLE
- W — ABANDONED WATER PIPE
- W — WATER PIPE
- FO — FIBER OPTIC
- MWRD SEWER
- SANITARY SEWER
- COMBINED SAN SEWER
- STORM SEWER
- STORM SEWER TO BE ABANDONED
- EX ROW — ROW LINE
- ① CATCH BASIN
- Ⓜ STORM MANHOLE
- ① STORM SEWER NUMBER
- ① STORM SEWER LATERAL NUMBER
- Ⓜ CB TO BE REMOVED
- Ⓜ CB TO BE FILLED
- Ⓜ CB TO BE ADJUSTED
- Ⓜ CB TO BE CLEANED
- Ⓜ STRUCTURES TO BE ADJUSTED
- CATCH BASIN
- Ⓜ MANHOLE
- STORM SEWER
- LIGHT POLE (FOR REFERENCE USE ONLY)

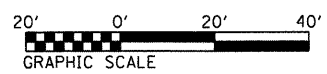
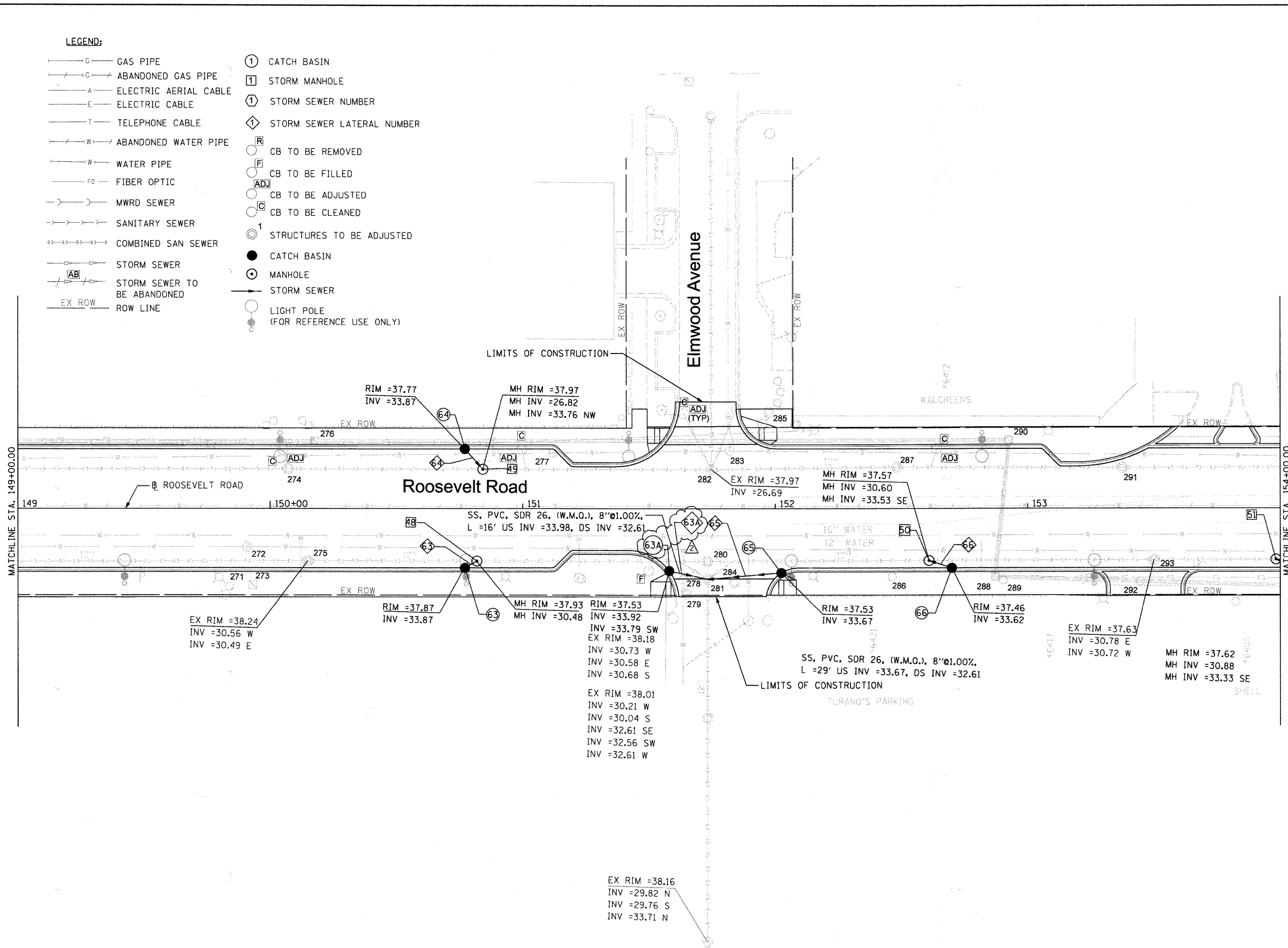

FILE NAME = DIRTE38-shr-drewn10.dgn	USER NAME = IDOT	DESIGNED - DA	REVISED - 04/09/2010	STATE OF ILLINOIS DEPARTMENT OF TRANSPORTATION	DRAINAGE AND UTILITIES PLAN	F.A.P. RTE. 347	SECTION 09-00248-00-RS	COUNTY COOK	TOTAL SHEET NO. 274	SHEET NO. 103	CONTRACT NO. 63432		
PLOT SCALE = 20,0000' / IN.				SCALE: 1" = 20'				SHEET NO. 10 OF 30 SHEETS				STA. 149+00.00 TO STA. 154+00.00	
PLOT DATE = 4/8/2010				ILLINOIS FED. AID PROJECT									

ELECTRICAL NOTES

PART 1: GENERAL

A. DESCRIPTION

Provide all requirements and criteria for safety and reliability to furnish and install complete operating electrical system, including materials, labor, necessary equipment as herein specified. Comply with local codes, National Electrical Code, IDOT, and all applicable codes and standards. The equipment and installation shall conform with the standard specifications for road and bridge construction of the Illinois Department Of Transportation including latest revision and supplemental specifications, as well as the special Provisions.

B. Scope of Work

- Contractor shall furnish, instal, and test complete street lighting system with all lighting poles, luminaries, foundations, lighting control cabinet, conduits, hangers, supports, devices, wiring, etc., required for a complete and operational installation. After installation, contractor shall completely test all components in compliance with IDOT standards to ensure complete functional installation.
- The work shall be performed in accordance with the rules and regulations set forth in the local governing code. The work shall also meet the laws and ordinance required by those agencies having jurisdiction.
- Contractor shall visit the site and make himself thoroughly familiar with existing conditions. Prior to submitting the proposal, include any relocation and/or alternations to the existing electrical system, components or equipment required to accommodate the new construction.
- Contractor shall obtain all permits required to perform his work. Prepare and submit to the authorities any and all data, drawings and details required for approval before commencing the installation.
- Maintain existing street lighting system operation during construction until new construction of street lighting system is completed. Maintain existing lighting as temporary lighting during the construction period. Remove same upon completion of the project.
- Contractor shall coordinate work with all trades and avoid conflicts and delays.
- Notify the engineer in writing of any discrepancies between the existing conditions and the new work. Lack of notification shall indicate that no discrepancies or conflicts exist.
- All light poles shall be non-breakaway type.
- Contractor shall coordinate work with utility companies, including electric, water, gas, sewer, cable, etc.
- Rigid Steel Conduit shall be pushed under street or driveway and extended 3'-0" on each side.
- As part of this work Owner shall have first salvage rights to any item removed as part of this project. Dispose of all others. Any unused equipment or wiring will not be allowed to be abandoned in place.
- Red tape or marking shall be 10" below grade to mark electrical conduit routing.
- After construction of new system remove old lighting poles, foundation and wiring. Abandon in place the conduit system.
- The contractor shall be responsible for damage incurred by him in any area of the project such as pavement, driveways, and sidewalks and shall restore them to their original condition as directed by the engineer. Landscaped areas shall be restored and damaged plant materials replaced to the satisfaction of the engineer.
- Lighting poles shall be located to provide unobstructed access to pedestrians meeting ADA requirements.
- Contractor is responsible to identify all underground and overhead utility conflicts and ensure adequate clearances between utilities and new lighting system.
- Ground rod material and installation is included as part of the electrical equipment and/or pole foundation systems. Refer to electrical details of cabinets and/or pole foundation for more information.

C. Guarantee

- Guarantee in writing all electrical equipment for a period of one year following date of substantial completion. State the additional amount for a five year full guarantee and full maintenance contract of electrical system.
- All apparatus shall be built and installed so as to deliver its full rated capacity at the efficiency for which it was designed.

D. Construction Phase Submittals

Submit: shop drawings to the engineer for approval. Prepare and provide the engineer with a complete set of circuted "record" drawings at project completion. Such drawings shall be submitted on a clear and legible reproducible form.

PART 2: PRODUCTS

A. Quality Level

All material and equipment used for this project shall be UL listed and approved for the intended applications unless otherwise noted.

B. Material

- Unit duct shall be Type MC 600 volt, EPR rated insulation, PVC jacket, Steel interlock armor, copper conductors and color coded.
- Site lighting branch circuits shall be #4 AWG minimum, unless otherwise noted. Control wiring shall be #14 AWG minimum.

PART 3: EXECUTION

- Provide a complete properly operating system for each item of equipment called for under this notes. Install in accord with the equipment manufacturer's instructions, the best industry practices and under competent supervision at all time.
- Prior to inspection to determine substantial completion the contractor shall operate all electrical system to demonstrate that the installation and performance of the system conform to the requirements specified above and on the drawings.

LEGEND

- ☒ Existing street light
- ☐ Proposed handhole
- Proposed 27'-0" street light 250W Metal Halide at 240V with 3' pedant arm at 27' high for roadway, & 70W Metal Halide at 240V with 1' pedant arm at 15' high for sidewalk.
- ☒ Proposed 30'-0" street light 250W Metal Halide at 240V with 3' pedant arm at 30' high for roadway, & 70W Metal Halide at 240V with 1' pedant arm at 15' high for sidewalk.
- ☒ Controller, 100A, 240/480V, 1PH, 3W
- P— Conduit, pushed, rigid galvanized steel 3'-0" below grade, extend 3'-0" on each side of the curb
- 3" galvanized steel conduit 3'-0" below grade
- Unit duct (Refer to plan for exact size)
- ☒ Existing street light to be removed (light pole and foundation)
- F1 Fixture type
- ☐ Proposed vandal proof receptacle (Weatherproof and Ground Fault Interrupter)
- ☐ UL listed, corrosion resistant and cover NEC 406.8.B.2a compliant
- ||— Ground Rod
- ☐ Weatherproof, corrosion resistant cabinet. Refer to detail for more information.

ELECTRICAL LOAD SCHEDULE							RED PH. (AT 240V)	BLACK PH. (AT 240V)
PANEL	CIRCUIT NUMBER	SIZE OF BREAKER	NO. OF LTG FIXTURE					
A1 (BERWYN) 100A, 240/480V, 1PH, 3W	A	50A, 240V	(5) 340W			1700VA		
	B	50A, 240V	(5) 340W			1700VA		
	C	50A, 240V	(6) 340W			2040VA	2040VA	
	D	50A, 240V	(6) 340W				2040VA	
	E,F,G,H	50A, 240V	SPARE					
SUBTOTAL						3740VA	3740VA	
CABINET A1 TOTAL LOAD (480V, 1PH)						7480VA*, 15.6A		
A2 (BERWYN) 100A, 240/480V, 1PH, 3W	A	50A, 240V	(6) 340W			2040VA		
	B	50A, 240V	(5) 340W			1700VA		
	C	50A, 240V	(10) 340W			3400VA		
	D	50A, 240V	(11) 340W				3740VA	
	E,F,G,H	50A, 240V	SPARE					
SUBTOTAL						5440VA	5440VA	
CABINET A2 TOTAL LOAD (480V, 1PH)						10880VA, 22.7A		
B1 (CICERO) 100A, 240/480V, 1PH, 3W	B	50A, 240V	SERVE EXISTING LIGHTING (EAST OF AUSTIN)				2700VA	
	C	50A, 240V	(4) 340W			1360VA		
	D	50A, 240V	(5) 340W				1700VA	
	A,E,F,G,H	50A, 240V	SPARE					
SUBTOTAL						1360VA	4400VA	
CABINET B1 TOTAL LOAD (480V, 1PH)						5760VA, 12A		
C1 (OAK PARK) 100A, 240/480V, 1PH, 3W	A	50A, 240V	(5) 340W			1700VA		
	B	50A, 240V	(6) 340W			2040VA		
	C	50A, 240V	(6) 340W			2040VA		
	D	50A, 240V	(6) 340W				2040VA	
	E,F,G,H	50A, 240V	SPARE					
SUBTOTAL						3740VA	4080VA	
CABINET C1 TOTAL LOAD (480V, 1PH)						7820VA*, 16.3A		
C2 (OAK PARK) 100A, 240/480V, 1PH, 3W	A	50A, 240V	(7) 340W			2380VA		
	B	50A, 240V	(6) 340W			2040VA		
	C	50A, 240V	(4) 340W			1360VA		
	D	50A, 240V	(4) 340W				1360VA	
	E,F,G,H	50A, 240V	SPARE					
SUBTOTAL						3740VA	3400VA	
CABINET C2 TOTAL LOAD (480V, 1PH)						7140VA*, 14.9A		
C3 (OAK PARK) 100A, 240/480V, 1PH, 3W	A	50A, 240V	(5) 340W			1700VA		
	B	50A, 240V	(5) 340W			1700VA		
	C	50A, 240V	(5) 340W			1700VA		
	D	50A, 240V	(5) 340W				1700VA	
	E,F,G,H	50A, 240V	SPARE					
SUBTOTAL						3550VA	3400VA	
CABINET C3 TOTAL LOAD (480V, 1PH)						6950VA, 14.5A		

*120V RECEPTACLE LOAD IS INCLUDED

Pole Identification

- ☐ C1 Control cabinet number
- ☐ B Circuit number
- ☐ T Pole number of the circuit

*All poles shall be offset 1.9 ft from back of curb to centerline of pole, unless roadway has bump-outs.

*All poles in bump-outs areas shall be offset from back of curb to centerline of pole as required to be inline with other poles.

*All poles shall have the same offset from the roadway centerline to maintain visual alignment.

New foundation and poles shall be located away from any existing utilities. Contractor shall identify all utilities and dig by hand to expose utility lines. Final exact location of foundation and pole shall be coordinated and approved prior to installation.

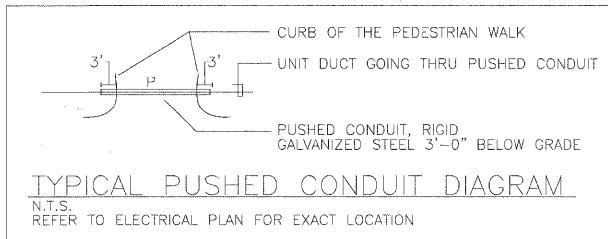

TYPICAL PUSHED CONDUIT DIAGRAM
N.T.S.
REFER TO ELECTRICAL PLAN FOR EXACT LOCATION



J. B. Smith
Exp 11/30/2011
For Elec. Sheets
221 TO 249

LIGHTING UNIT SCHEDULE

TAG	DESCRIPTION	MANUFACTURER	CATALOG NUMBER	LAMPS		INPUT WATTS	INPUT AMPS (240V)	POLE & BASE	MOUNTING	BALLAST	VOLT.	REMARKS
				NO.	TYPE							
F1	METAL HALIDE FIXTURE ON 27 FT. POLE WITH PEDESTRIAN ARM	STERNBERG-OMEGA	2-1527RFG/OD/70MHP/RO2H-L/OF/250MHP240/RO3H-L/MHP250/MOG/ED28-MHP70/MED/BK	1	250W METAL HALIDE (STREET LIGHT)	340	1.42	STRATFORD 22/30/A/RSS/DBA/RSB4/BK WITH STRATFORD BASE	(REFER TO DETAIL FOR EXACT MOUNTING OF FIXTURES)	CWA	240	OD SINGLE ARM FOR PEDESTRIAN OF SINGLE ARM FOR STREET
				1	70W METAL HALIDE (PEDESTRIAN)							
F2	METAL HALIDE FIXTURE ON 30 FT. POLE WITH PEDESTRIAN ARM	STERNBERG-OMEGA	2-1527RFG/OD/70MHP/RO2H-L/OF/250MHP240/RO3H-L/MHP250/MOG/ED28-MHP70/MED/BK	1	250W METAL HALIDE (STREET LIGHT)	340	1.42	STRATFORD 22/32/A/RSS/DBA/RSB4/BK WITH STRATFORD BASE	(REFER TO DETAIL FOR EXACT MOUNTING OF FIXTURES)	CWA	240	OD SINGLE ARM FOR PEDESTRIAN OF SINGLE ARM FOR STREET
				1	70W METAL HALIDE (PEDESTRIAN)							

TERRA ENGINEERING LTD.
225 W. OHIO ST., FOURTH FL.
CHICAGO, IL 60654
(312)467-0123

STATE OF ILLINOIS
DEPARTMENT OF TRANSPORTATION

ELECTRICAL NOTES, LEGEND AND ELECTRICAL LOAD SCHEDULE

SCALE: 1" = 20' SHEET NO. 1 OF 29 SHEETS STA. TO STA.

F.A.P. RTE.	SECTION	COUNTY	TOTAL SHEETS	SHEET NO.
347	09-00248-00-RS	COOK	274	221
CONTRACT NO. 63432				
ILLINOIS FED. AID PROJECT				

FILE NAME = DIRTE38-shr-light01.dgn

USER NAME = IDOT

DESIGNED - EE

REVISED - 04/09/2010

DRAWN - PY

CHECKED - JB

REVISED -

PLOT SCALE = 28.0000' / IN.

DATE -

REVISED -

PLOT DATE = 4/8/2010

DATE -

REVISED -