

MAINTENANCE OF TRAFFIC THROUGH WORK ZONE
 TYPICAL SECTION STAGE 3 (SUB-STAGE A)
 STA. 156+00 TO STA. 181+85
 (RIDGELAND AVE. TO AUSTIN BLVD.)
 NOT TO SCALE

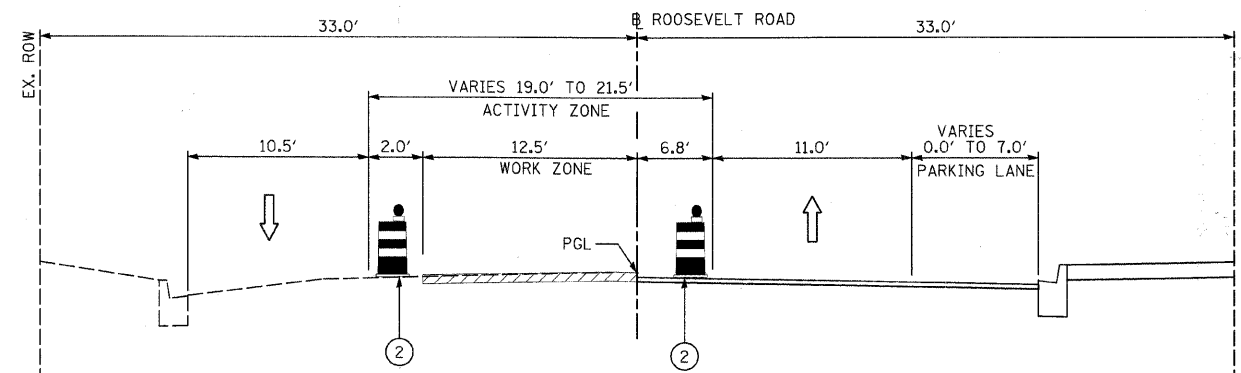

MAINTENANCE OF TRAFFIC THROUGH WORK ZONE
 TYPICAL SECTION STAGE 3 (SUB-STAGE B)
 STA. 156+00 TO STA. 181+85
 (RIDGELAND AVE. TO AUSTIN BLVD.)
 NOT TO SCALE

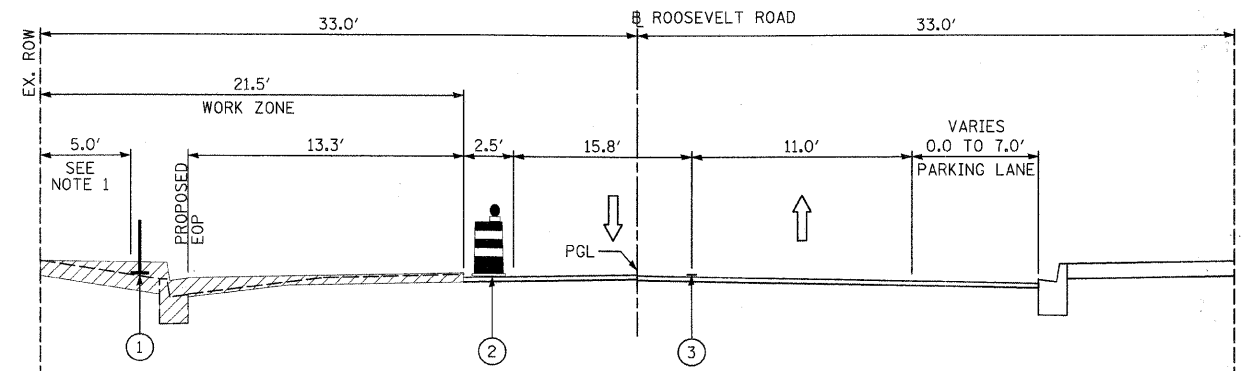

MAINTENANCE OF TRAFFIC THROUGH WORK ZONE
 TYPICAL SECTION STAGE 3 (SUB-STAGE C)
 STA. 156+00 TO STA. 181+85
 (RIDGELAND AVE. TO AUSTIN BLVD.)
 NOT TO SCALE

LEGEND

- ① TEMPORARY ORANGE HURRICANE FENCE
- ② TEMPORARY DRUM WITH WARNING LIGHT AT 25 FT SPACING (TYP.)
- ③ TEMPORARY PAVEMENT MARKING
- ▨ AREA UNDER CONSTRUCTION

NOTES:

1. CONTRACTOR TO MAINTAIN 5' MINIMUM PROTECTED PEDESTRIAN PATH AND BUILDING ACCESS THROUGHOUT CONSTRUCTION. SEE MAINTENANCE OF TRAFFIC GENERAL NOTES (SHEET 2 OF 2) FOR PEDESTRIAN PATH NOTES AND DETAILS.

FILE NAME = DIRTE38-sht-staging04.dgn	USER NAME = IDOT	DESIGNED - MD	REVISD -	STATE OF ILLINOIS DEPARTMENT OF TRANSPORTATION	MAINTENANCE OF TRAFFIC TYPICAL SECTIONS - STAGE 3			F.A.P. RTE. 347	SECTION 09-00248-00-RS	COUNTY COOK	TOTAL SHEETS 274	SHEET NO. 29
	PLOT SCALE = 5,0000' / IN.	DRAWN - LF	REVISD -		SCALE:	SHEET NO. OF SHEETS	STA. TO STA.	CONTRACT NO. 63432		ILLINOIS FED. AID PROJECT		
	PLOT DATE = 3/11/2018	CHECKED - JB	REVISD -									
		DATE	REVISD -									