

LEGEND:

- GAS PIPE
- ABANDONED GAS PIPE
- ELECTRIC AERIAL CABLE
- ELECTRIC CABLE
- TELEPHONE CABLE
- ABANDONED WATER PIPE
- WATER PIPE
- FIBER OPTIC
- MWRD SEWER
- SANITARY SEWER
- COMBINED SAN SEWER
- STORM SEWER
- STORM SEWER TO BE ABANDONED
- ROW LINE
- CATCH BASIN
- STORM MANHOLE
- STORM SEWER NUMBER
- STORM SEWER LATERAL NUMBER
- CB TO BE REMOVED
- CB TO BE FILLED
- CB TO BE ADJUSTED
- CB TO BE CLEANED
- STRUCTURES TO BE ADJUSTED
- CATCH BASIN
- MANHOLE
- STORM SEWER
- LIGHT POLE (FOR REFERENCE USE ONLY)

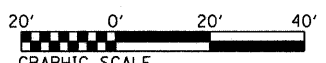
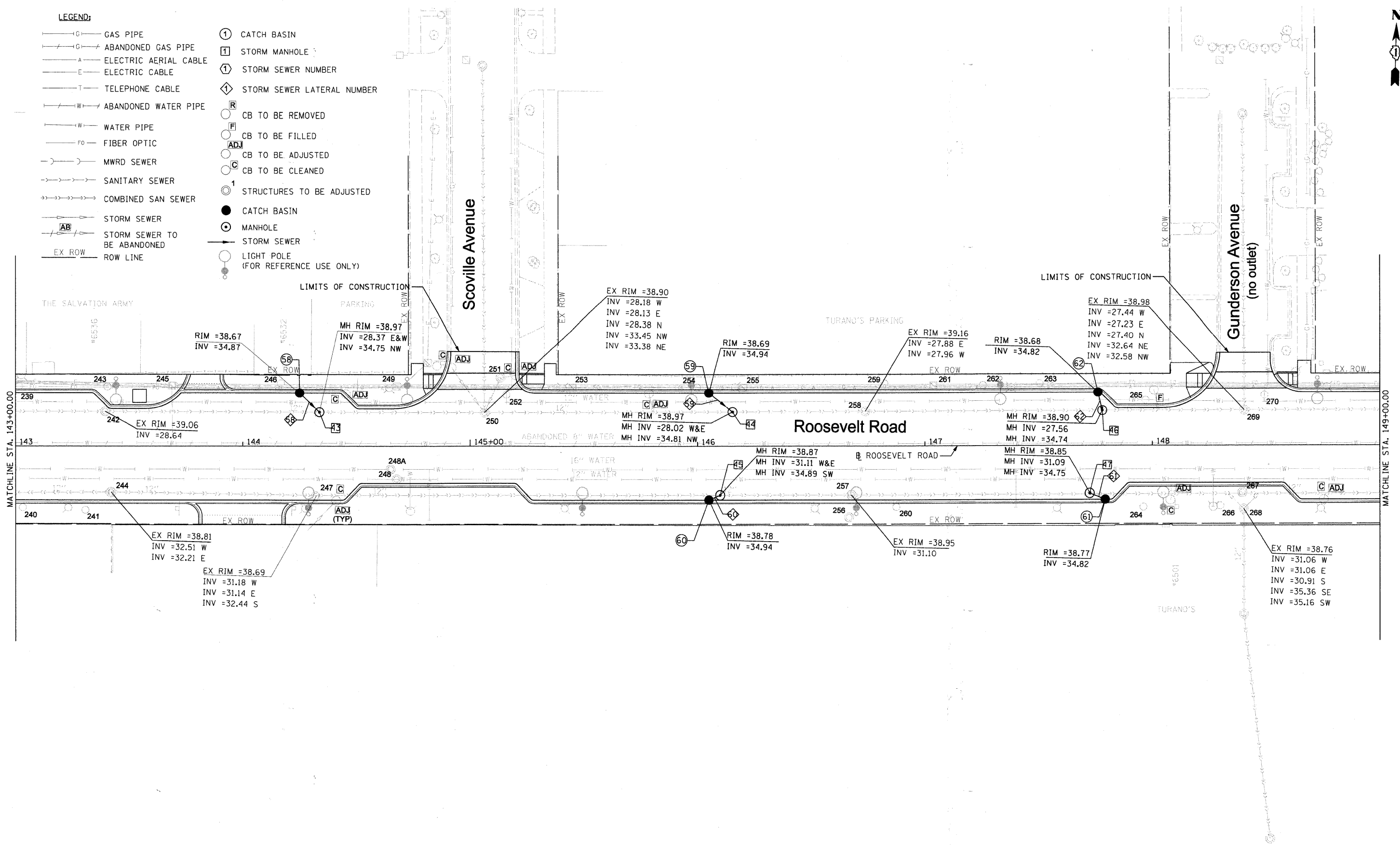

FILE NAME = DIRTE38-shst-drain@9.dgn	USER NAME = JBOT	DESIGNED - DA	REVISED -	STATE OF ILLINOIS DEPARTMENT OF TRANSPORTATION	DRAINAGE AND UTILITIES PLAN	F.A.P. RTE. 347	SECTION 09-00248-00-RS	COUNTY COOK	TOTAL SHEETS 274	SHEET NO. 102		
PLOT SCALE = 20.0000' / IN.		DRAWN - CC	REVISED -			SCALE: 1" = 20'		SHEET NO. 9 OF 30 SHEETS		CONTRACT NO. 63432		
PLOT DATE = 3/23/2010		CHECKED - JB	REVISED -			STA. 143+00.00 TO STA. 149+00.00		ILLINOIS FED. AID PROJECT				
DATE -		REVISOR -	REVISED -									