

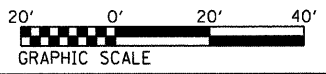

LEGEND:

- C— GAS PIPE
- C— ABANDONED GAS PIPE
- A— ELECTRIC AERIAL CABLE
- E— ELECTRIC CABLE
- T— TELEPHONE CABLE
- W— ABANDONED WATER PIPE
- W— WATER PIPE
- Fo— FIBER OPTIC
-) — MWRD SEWER
-) — SANITARY SEWER
-) — COMBINED SAN SEWER
-) — STORM SEWER
-) — STORM SEWER TO BE ABANDONED
- EX ROW — ROW LINE
- ① CATCH BASIN
- ① STORM MANHOLE
- ① STORM SEWER NUMBER
- ① STORM SEWER LATERAL NUMBER
- R CB TO BE REMOVED
- F CB TO BE FILLED
- ADJ CB TO BE ADJUSTED
- C CB TO BE CLEANED
- ① STRUCTURES TO BE ADJUSTED
- CATCH BASIN
- MANHOLE
- STORM SEWER
- LIGHT POLE (FOR REFERENCE USE ONLY)

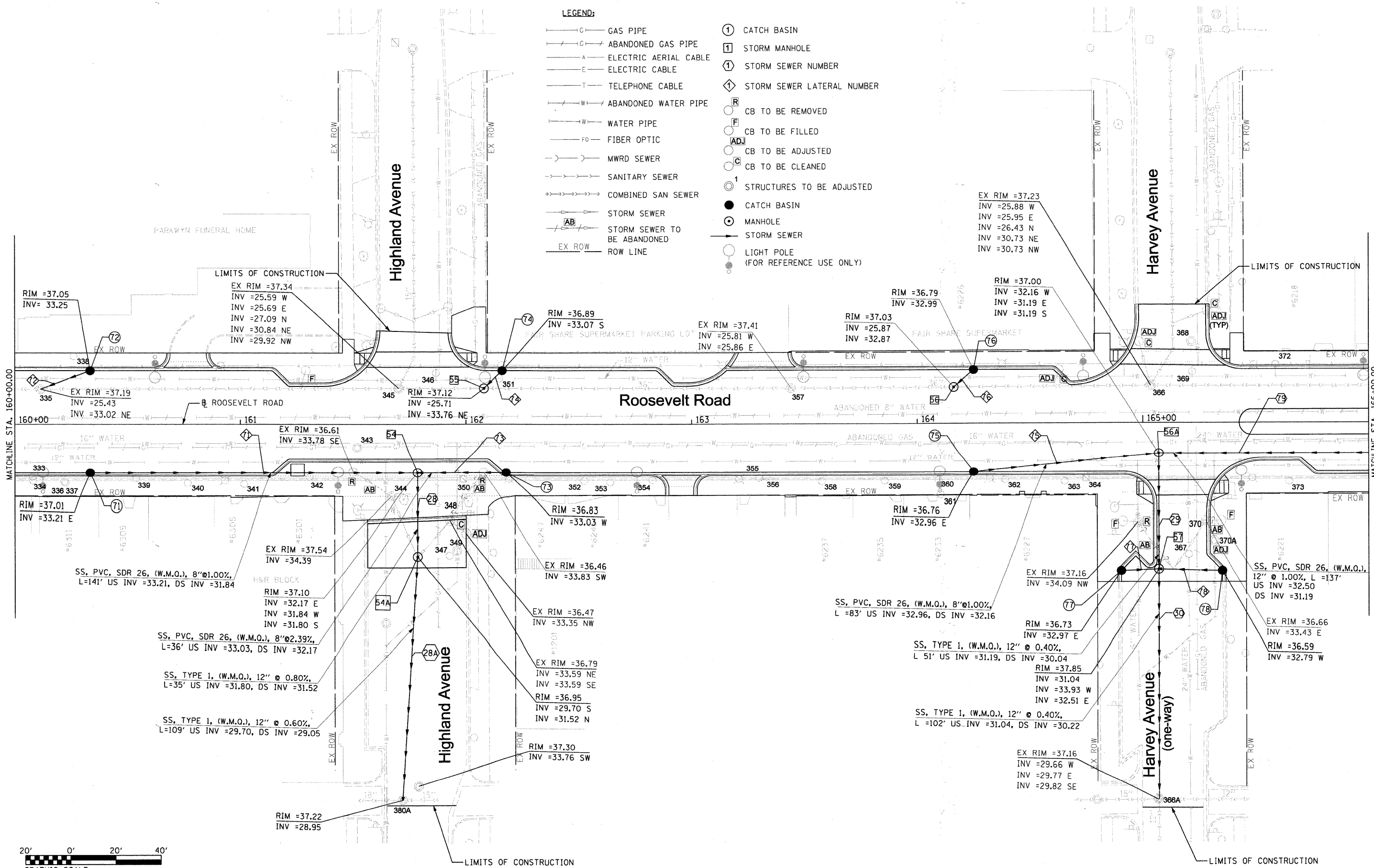

FILE NAME = DIRTE38-shd-drain12.dgn	USER NAME = IDDT	DESIGNED - DA	REVISED -	STATE OF ILLINOIS DEPARTMENT OF TRANSPORTATION	DRAINAGE AND UTILITIES PLAN	F.A.P. RTE. = 347	SECTION = 09-00248-00-RS	COUNTY = COOK	TOTAL SHEETS = 274	SHEET NO. = 105		
PLOT SCALE = 20.0000' / IN.	CHECKED - JB	REVISED -	SCALE: 1" = 20'			SHEET NO. 12 OF 30 SHEETS	STA. 160+00.00 TO STA. 166+00.00	CONTRACT NO. 63432		ILLINOIS FED. AID PROJECT		
PLOT DATE = 3/23/2010	DATE =	REVISED -										