

- LEGEND:**
- G- GAS PIPE
 - G- ABANDONED GAS PIPE
 - A- ELECTRIC AERIAL CABLE
 - E- ELECTRIC CABLE
 - T- TELEPHONE CABLE
 - W- ABANDONED WATER PIPE
 - W- WATER PIPE
 - FO- FIBER OPTIC
 -) MWRD SEWER
 -) SANITARY SEWER
 -) COMBINED SAN SEWER
 -) STORM SEWER
 -) STORM SEWER TO BE ABANDONED
 - EX ROW- ROW LINE
 - ① CATCH BASIN
 - 1 STORM MANHOLE
 - ① STORM SEWER NUMBER
 - ① STORM SEWER LATERAL NUMBER
 - R CB TO BE REMOVED
 - F CB TO BE FILLED
 - ADJ CB TO BE ADJUSTED
 - C CB TO BE CLEANED
 - 1 STRUCTURES TO BE ADJUSTED
 - CATCH BASIN
 - MANHOLE
 - STORM SEWER
 - LIGHT POLE (FOR REFERENCE USE ONLY)

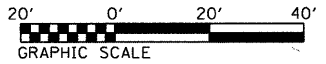
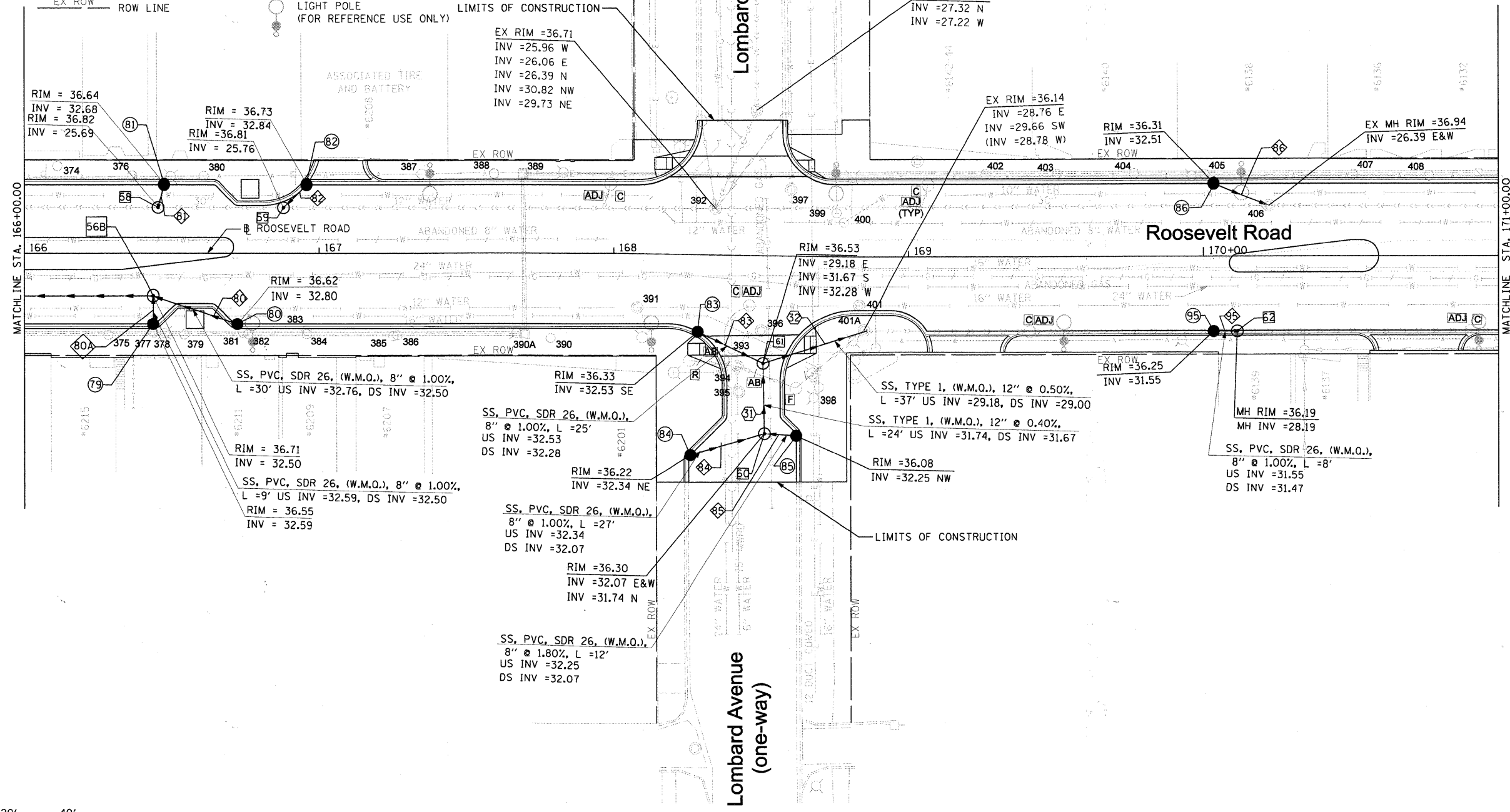

FILE NAME = DIRTE38-sht-drain13.dgn	USER NAME = IDOT	DESIGNED - DA	REVISED -
		DRAWN - CC	REVISED -
	PLOT SCALE = 20.0000' / IN.	CHECKED - JB	REVISED -
	PLOT DATE = 3/23/2010	DATE -	REVISED -

**STATE OF ILLINOIS
DEPARTMENT OF TRANSPORTATION**

DRAINAGE AND UTILITIES PLAN

SCALE: 1" = 20' SHEET NO. 13 OF 30 SHEETS STA. 166+00.00 TO STA. 171+00.00

F.A.P. RTE.	SECTION	COUNTY	TOTAL SHEETS	SHEET NO.
347	09-00248-00-RS	COOK	274	106
CONTRACT NO. 63432				
ILLINOIS FED. AID PROJECT				

