

PROPOSED ELEVATIONS

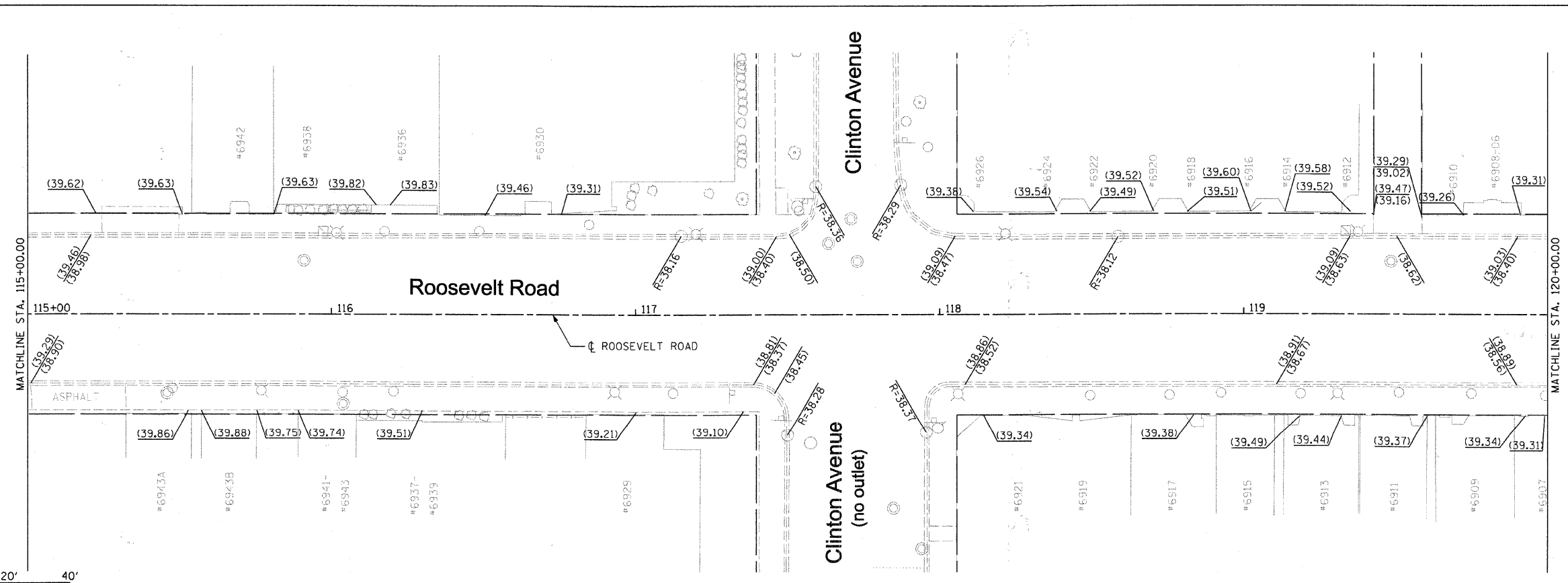

EXISTING ELEVATIONS

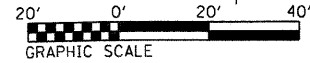

FILE NAME = DIRTE36-sht-elev24.dgn	USER NAME = IDOT	DESIGNED - BB	REVISED -	STATE OF ILLINOIS DEPARTMENT OF TRANSPORTATION	PROPOSED AND EXISTING ELEVATIONS			F.A.P. RTE. 347	SECTION 09-00248-00-RS	COUNTY COOK	TOTAL SHEETS 274	SHEET NO. 141
	PLOT SCALE = 20.0000' / IN.	CHECKED - JB	REVISED -		SCALE: 1" = 20'	SHEET NO. 4 OF 15 SHEETS	STA. 115+00.00 TO STA. 120+00.00	CONTRACT NO. 63432				
	PLOT DATE = 3/11/2010	DATE -	REVISED -		ILLINOIS FED. AID PROJECT							