

PROPOSED ELEVATIONS

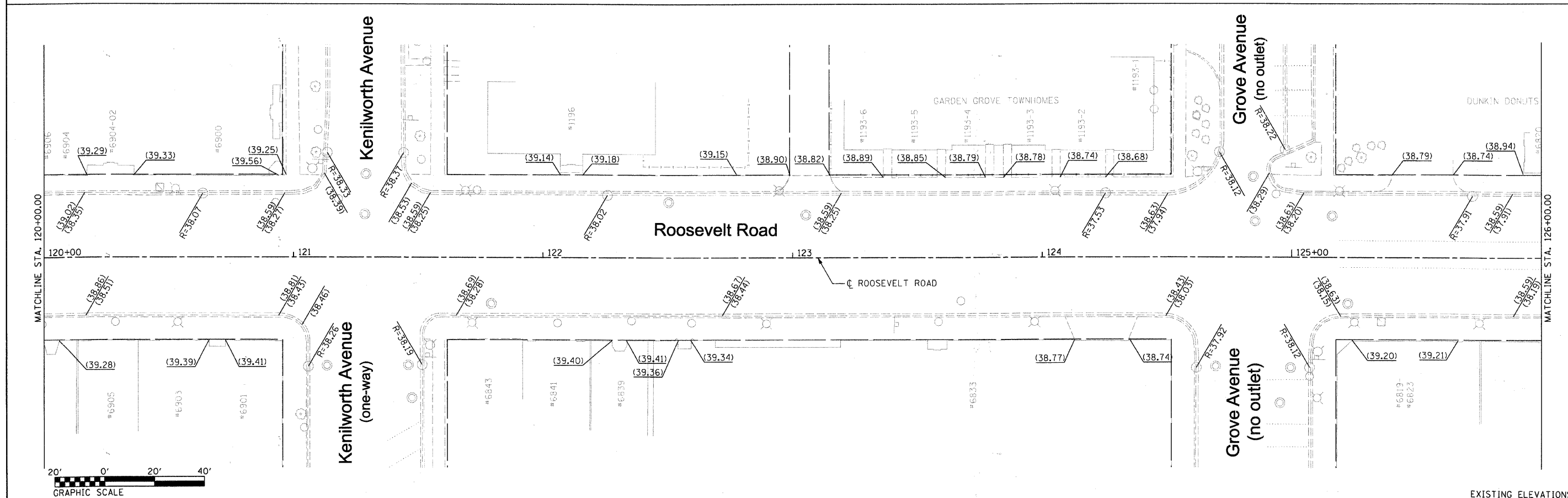

EXISTING ELEVATIONS

FILE NAME = DIRTE38-shu-elev05.dgn	USER NAME = T00T	DESIGNED - BB	REVISED -	STATE OF ILLINOIS DEPARTMENT OF TRANSPORTATION	PROPOSED AND EXISTING ELEVATIONS			F.A.P. RTE. 347	SECTION 09-00248-00-RS	COUNTY COOK	TOTAL SHEETS 274	SHEET NO. 142
	PLOT SCALE = 20.0000' / IN.	CHECKED - JB	REVISED -					SCALE: 1" = 20' SHEET NO. 5 OF 15 SHEETS STA. 120+00.00 TO STA. 126+00.00				CONTRACT NO. 63432
PLOT DATE = 3/11/2010	DATE -	DATE -	REVISED -	ILLINOIS FED. AID PROJECT								