

PROPOSED ELEVATIONS

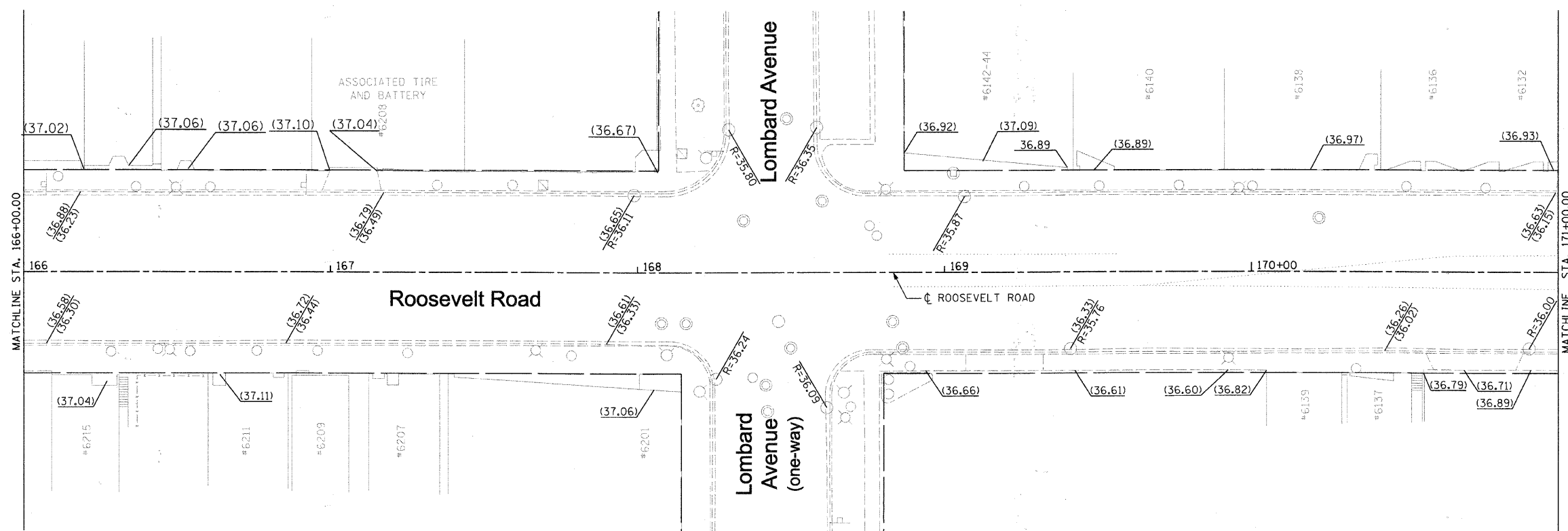

EXISTING ELEVATIONS

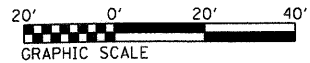

FILE NAME = DIRTE38-sht-elev3.dgn	USER NAME = IDOT	DESIGNED - BB	REVISED -	STATE OF ILLINOIS DEPARTMENT OF TRANSPORTATION	PROPOSED AND EXISTING ELEVATIONS			F.A.P. RTE. 347	SECTION 09-00248-00-RS	COUNTY COOK	TOTAL SHEETS 274	SHEET NO. 150
	PLOT SCALE = 20.0000' / IN.	CHECKED - JB	REVISED -					SCALE: 1" = 20'	SHEET NO. 13 OF 15 SHEETS	STA. 166+00.00 TO STA. 171+00.00	CONTRACT NO. 63432	
PLOT DATE = 3/11/2010	DATE -	REVISED -	REVISED -									