

TRAFFIC SIGNAL LEGEND

	PROPOSED	EXISTING
CONTROLLER		
SERVICE INSTALLATION		
SIGNAL HEAD		
SIGNAL HEAD WITH BACKPLATE		
SIGNAL HEAD, PEDESTRIAN		
SIGNAL POST		
MAST ARM ASSEMBLY AND POLE, STEEL		
MAST ARM ASSEMBLY AND POLE, ALUMINUM		
COMMON TRENCH		
UNIT DUCT		
HANDHOLE		
HEAVY DUTY HANDHOLE		
DOUBLE HANDHOLE		
G.S. CONDUIT IN TRENCH OR PUSHED		
PEDESTRIAN PUSHBUTTON DETECTOR		
DETECTOR LOOP		
CAST IRON JUNCTION BOX		
EMERGENCY VEHICLE SYSTEM DETECTOR		
CONFIRMATION BEACON		
SIGNAL HEAD OPTICALLY PROGRAMMED		
CONDUIT SPLICE		
WOOD POLE		
RACEWAY FOR MAGNETIC DETECTOR, TYPE I OR TYPE II		
VEHICLE DETECTOR, NON COMPENSATED MAGNETIC TYPE		
RAILROAD CONTROL CABINET		
COMBINATION MAST ARM ASSEMBLY AND POLE, STEEL WITH LUMINAIRE		

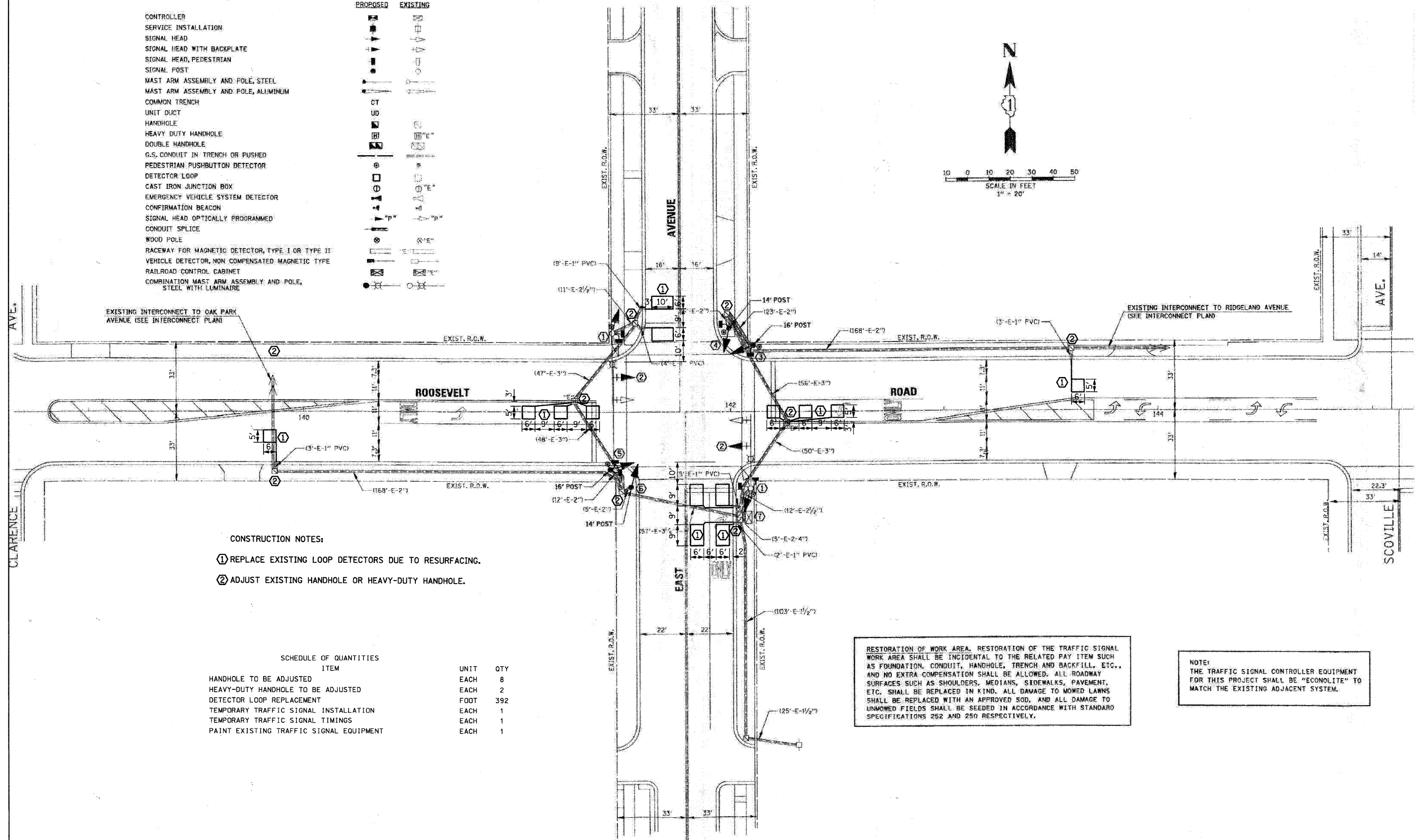
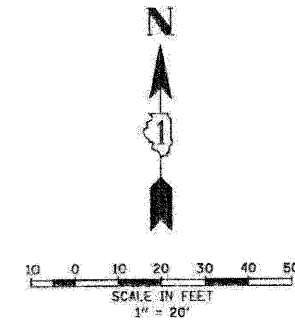

- CONSTRUCTION NOTES:
- ① REPLACE EXISTING LOOP DETECTORS DUE TO RESURFACING.
  - ② ADJUST EXISTING HANDHOLE OR HEAVY-DUTY HANDHOLE.

SCHEDULE OF QUANTITIES

ITEM	UNIT	QTY
HANDHOLE TO BE ADJUSTED	EACH	8
HEAVY-DUTY HANDHOLE TO BE ADJUSTED	EACH	2
DETECTOR LOOP REPLACEMENT	FOOT	392
TEMPORARY TRAFFIC SIGNAL INSTALLATION	EACH	1
TEMPORARY TRAFFIC SIGNAL TIMINGS	EACH	1
PAINT EXISTING TRAFFIC SIGNAL EQUIPMENT	EACH	1

RESTORATION OF WORK AREA. RESTORATION OF THE TRAFFIC SIGNAL WORK AREA SHALL BE INCIDENTAL TO THE RELATED PAY ITEM SUCH AS FOUNDATION, CONDUIT, HANDHOLE, TRENCH AND BACKFILL, ETC., AND NO EXTRA COMPENSATION SHALL BE ALLOWED. ALL ROADWAY SURFACES SUCH AS SHOULDERS, MEDIANS, SIDEWALKS, PAVEMENT, ETC. SHALL BE REPLACED IN KIND. ALL DAMAGE TO MOWED LAWNS SHALL BE REPLACED WITH AN APPROVED SOD, AND ALL DAMAGE TO UNMOWED FIELDS SHALL BE SEEDED IN ACCORDANCE WITH STANDARD SPECIFICATIONS 252 AND 250 RESPECTIVELY.

NOTE:  
THE TRAFFIC SIGNAL CONTROLLER EQUIPMENT FOR THIS PROJECT SHALL BE "ECONOLITE" TO MATCH THE EXISTING ADJACENT SYSTEM.

FILE NAME = DIRTE38-pht-tsl6.dgn	USER NAME = IDCT
PLOT SCALE = 22.0000' / IN.	DESIGNED -
PLOT DATE = 3/11/2012	DRAWN -
	CHECKED - JB
	DATE -
	REVISED -

DESIGNED -	REVISED -
DRAWN -	REVISED -
CHECKED - JB	REVISED -
DATE -	REVISED -

**STATE OF ILLINOIS  
DEPARTMENT OF TRANSPORTATION**

**TRAFFIC SIGNAL MODIFICATION PLAN  
ROOSEVELT ROAD AT EAST AVENUE**

SCALE: 1" = 20' SHEET NO. 16 OF 27 SHEETS STA. TO STA.

F.A.P. RTE. 347	SECTION 09-00248-00-RS	COUNTY COOK	TOTAL SHEETS 274	SHEET NO. 209
CONTRACT NO. 63432			[ILLINOIS] FED. AID PROJECT	