

SECTION 1, TOWNSHIP 36, RANGE 11  
 SECTION 2, TOWNSHIP 36, RANGE 11  
 SECTION 11, TOWNSHIP 36, RANGE 11  
 SECTION 12, TOWNSHIP 36, RANGE 11

F. A. U. FILE	SECTION	COUNTY	TOTAL SHEETS	SHEET NO.
1600	06-00006-00-BT	WILL	73	23
STA. 63+00		TO STA. 73+00		
FED. ROAD DIST. NO. 1		ILLINOIS	FED. AID PROJECT CMM-0001 (673)	

CONTRACT #63440

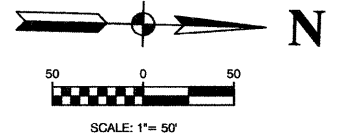

**LEGEND:**

	SODDING/LIMITS OF GRADING
	SEEDING/LIMITS OF GRADING

**BENCH MARK: 5**  
 SPIKE SET IN HILLSIDE ALONG W. HIAWATHA DRIVE'S EASTERLY EXTENSION, APPROXIMATELY 214' EAST OF W. CREEKSIDE DRIVE INTERSECTION, AND 90' SOUTH OF WIRE FENCE, AND 45' SOUTHEAST OF WOOD POWER POLE.  
 ELEVATION = 720.99

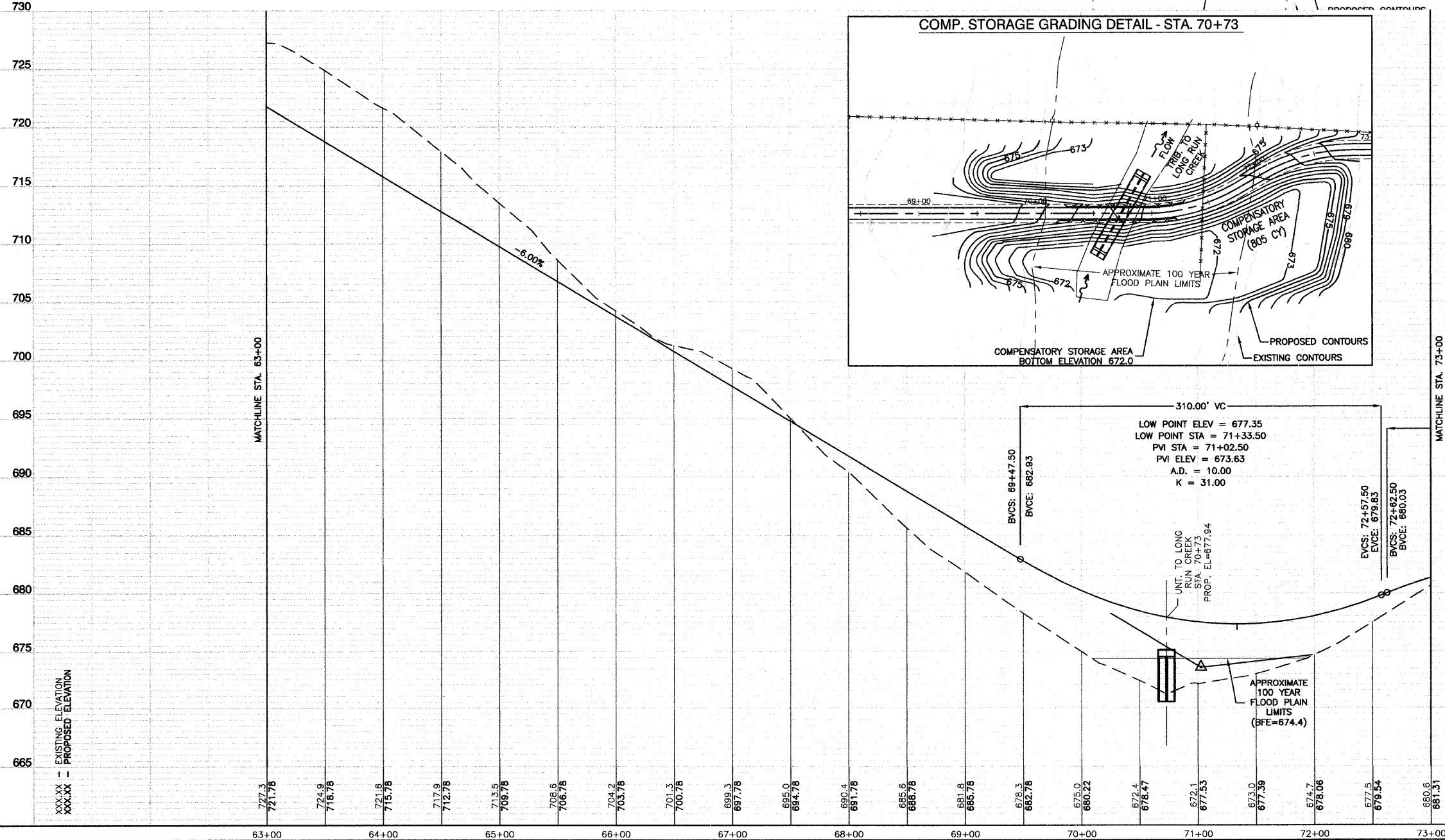
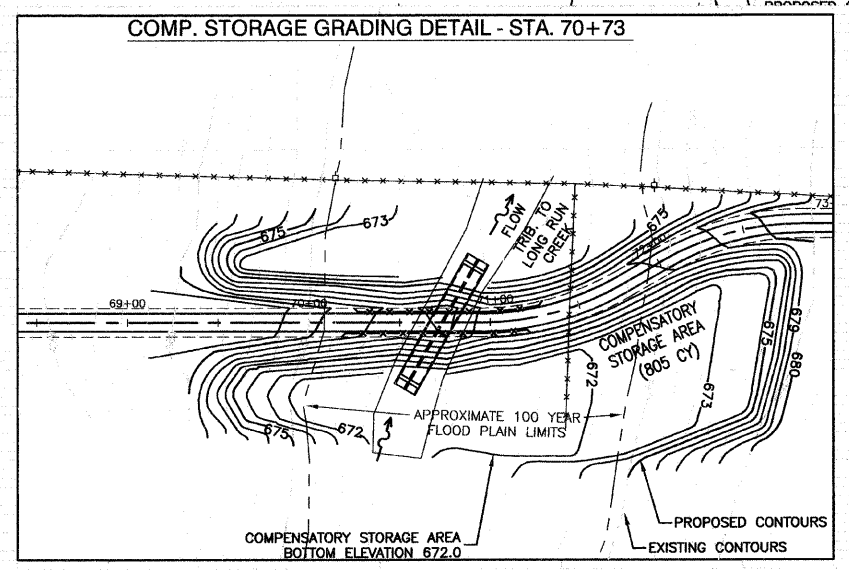
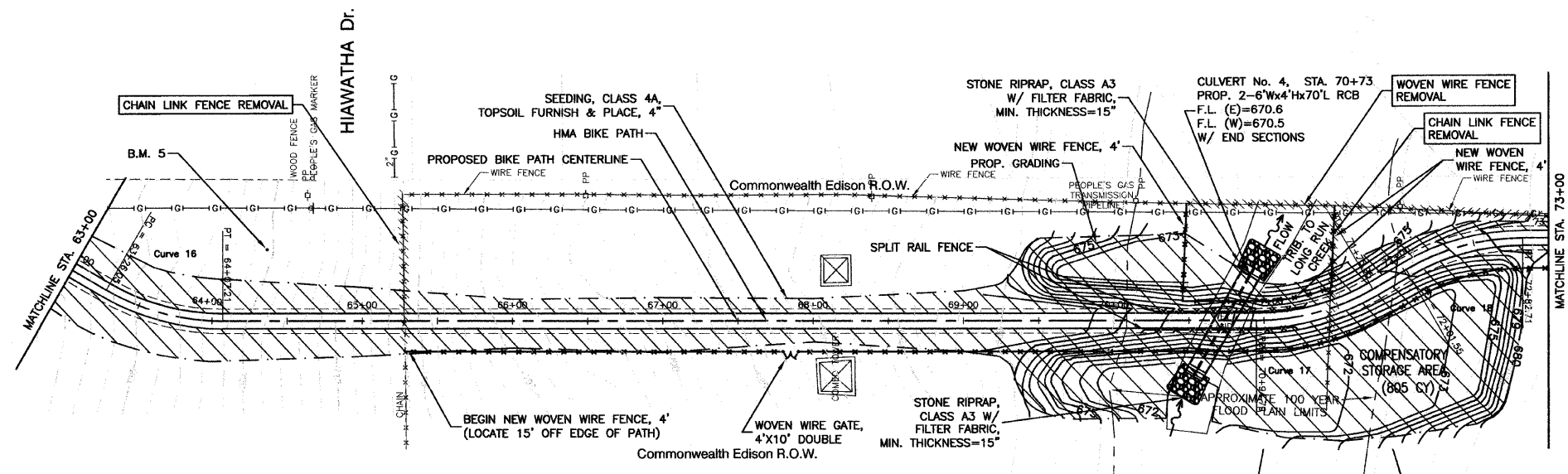

**BIKE TRAIL SIGN LEGEND:**

1  R1-1 18"x18"	2  W1-1R 18"x18"	3  W1-1L 18"x18"	4  M4-6 6"x4"	6  W11-1 24"x24"
	5  12"x4"	5  12"x4"	5  D11-1 24"x18"	

**REVISIONS**

NAME	DATE

ILLINOIS DEPARTMENT OF TRANSPORTATION

**HOMER GLEN GMAQ COMMUNITY BIKE TRAIL AND EAST EXTENSION PLAN & PROFILE SHEETS**  
 Pin Oak Dr. to Beaver Lake Dr. STA 63+00 TO STA 73+00

SCALE: VERT. 1"=5'  
 HORIZ. 1"=50'

DATE: FEBRUARY 2, 2010

DRAWN BY: JJB  
 CHECKED BY: BDB