

SECTION 1, TOWNSHIP 36, RANGE 11
 SECTION 2, TOWNSHIP 36, RANGE 11
 SECTION 11, TOWNSHIP 36, RANGE 11
 SECTION 12, TOWNSHIP 36, RANGE 11

F. A. U. NO.	SECTION	COUNTY	TOTAL SHEETS	SHEET NO.
1600	06-00008-00-BT	WILL	73	38
STA.	TO STA.			
FED. ROAD DIST. NO. 1	ILLINOIS	FED. AID PROJECT	CMM-0001 (873)	

CONTRACT #63440



SCALE: 1" = 50'

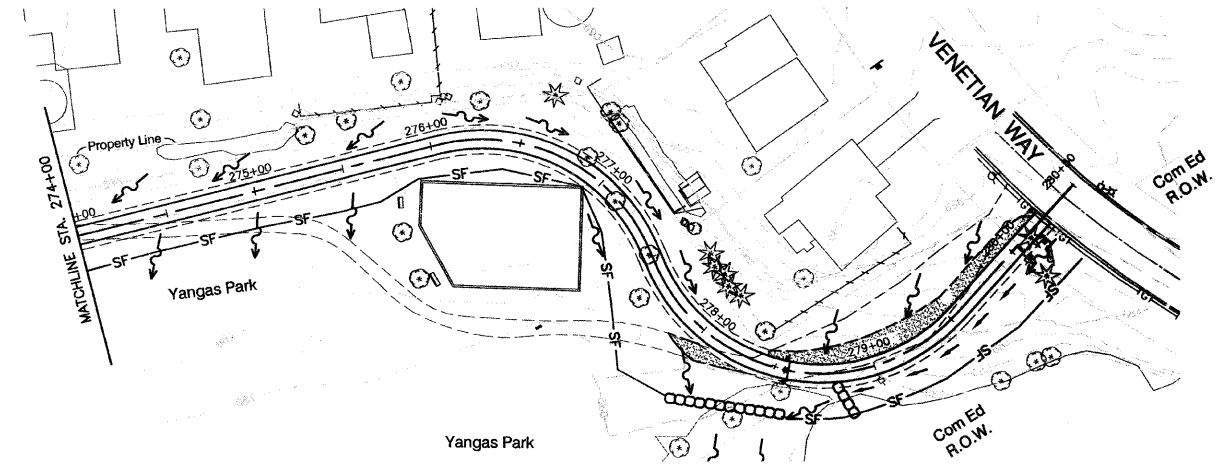
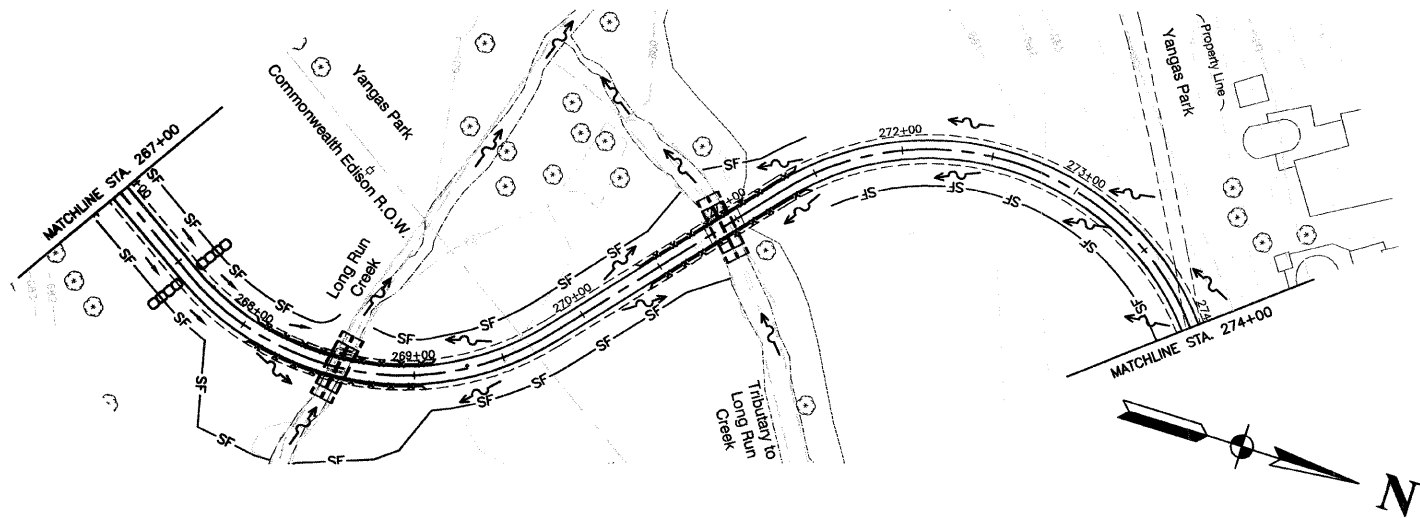
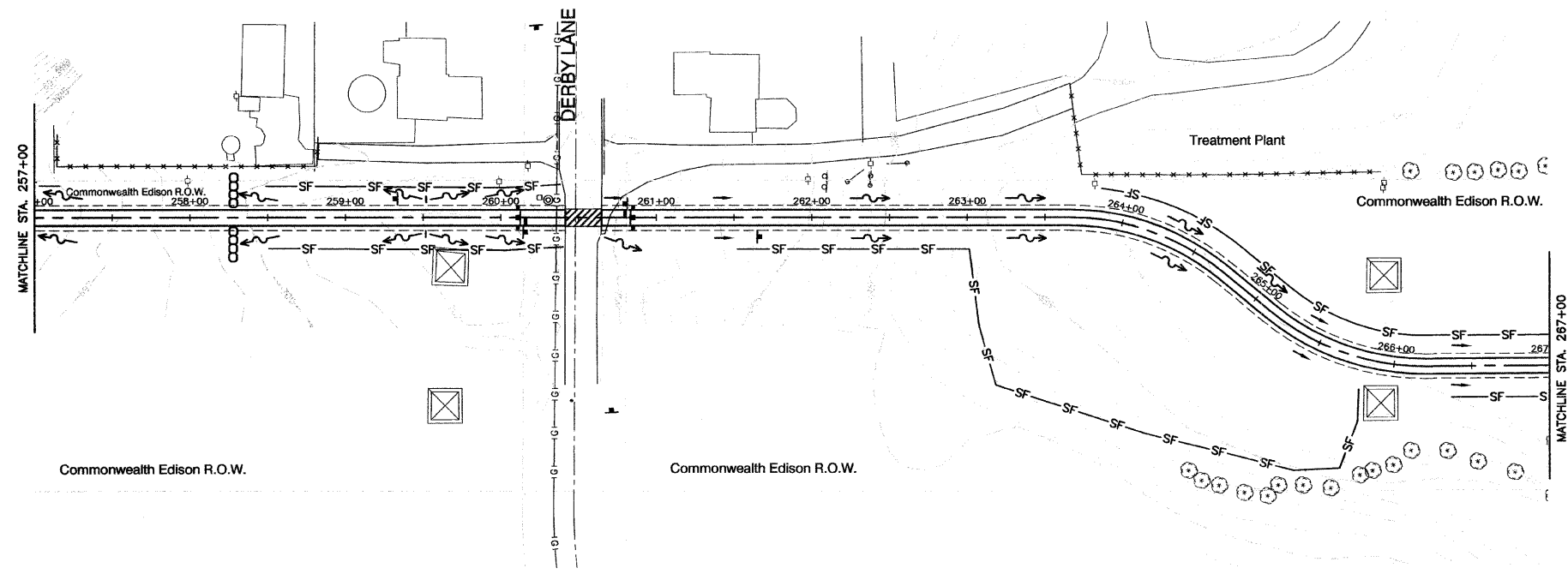

KEY	ITEM NAME
—SF—	PERIMETER EROSION BARRIER TO BE PLACED AS DIRECTED
~>	FLOW DIRECTION
—>	DITCH FLOW DIRECTION
—+—	FLOW DIRECTION LOW POINT
—-—	FLOW DIRECTION HIGH POINT
⊠	INLET AND PIPE PROTECTION
○○○○	TEMPORARY DITCH CHECKS
⊞	RIPRAP (SEE PLAN SHEETS)

REVISIONS	
NAME	DATE

ILLINOIS DEPARTMENT OF TRANSPORTATION
HOMER GLEN GMAQ COMMUNITY BIKE TRAIL AND EAST EXTENSION EROSION CONTROL PLAN
 Mustang Drive to Venetian Way
 SCALE: VERT. N/A
 HORIZ. 1"=50'
 DATE: FEBRUARY 2, 2010
 DRAWN BY: JJB
 CHECKED BY: BDB
ROBINSON ENGINEERING, L.P.C.
 1700 SOUTH PARK AVENUE, SOUTH HOLLAND, ILLINOIS 60473
 (708) 381-0700 FAX (708) 381-0665
 ILLINOIS DESIGN FIRM REGISTRATION NO. 18402108