

F. A. U. R.T.	SECTION	COUNTY	TOTAL SHEETS	SHEET NO.
1600	06-00008-00-BT	WILL	73	41
STA. 5+73	TO STA. 7+50			
FED. ROAD DIST. NO. 1	ILLINOIS	FED. AID PROJECT	CMM-0001 (873)	

CONTRACT #63440

NOTES:  
 1.) CROSS SLOPE OF PROPOSED BIKE PATH TO DRAIN TOWARD COM-ED EASEMENT PROPERTY, UNLESS SPECIFIED OTHERWISE.  
 2.) TYPICAL DITCH IS 1.0 FOOT BELOW EDGE OF 3 FOOT EARTH SHOULDER WITH 3:1 SIDE SLOPES AND A 2 FOOT DITCH BOTTOM UNLESS OTHERWISE SPECIFIED.

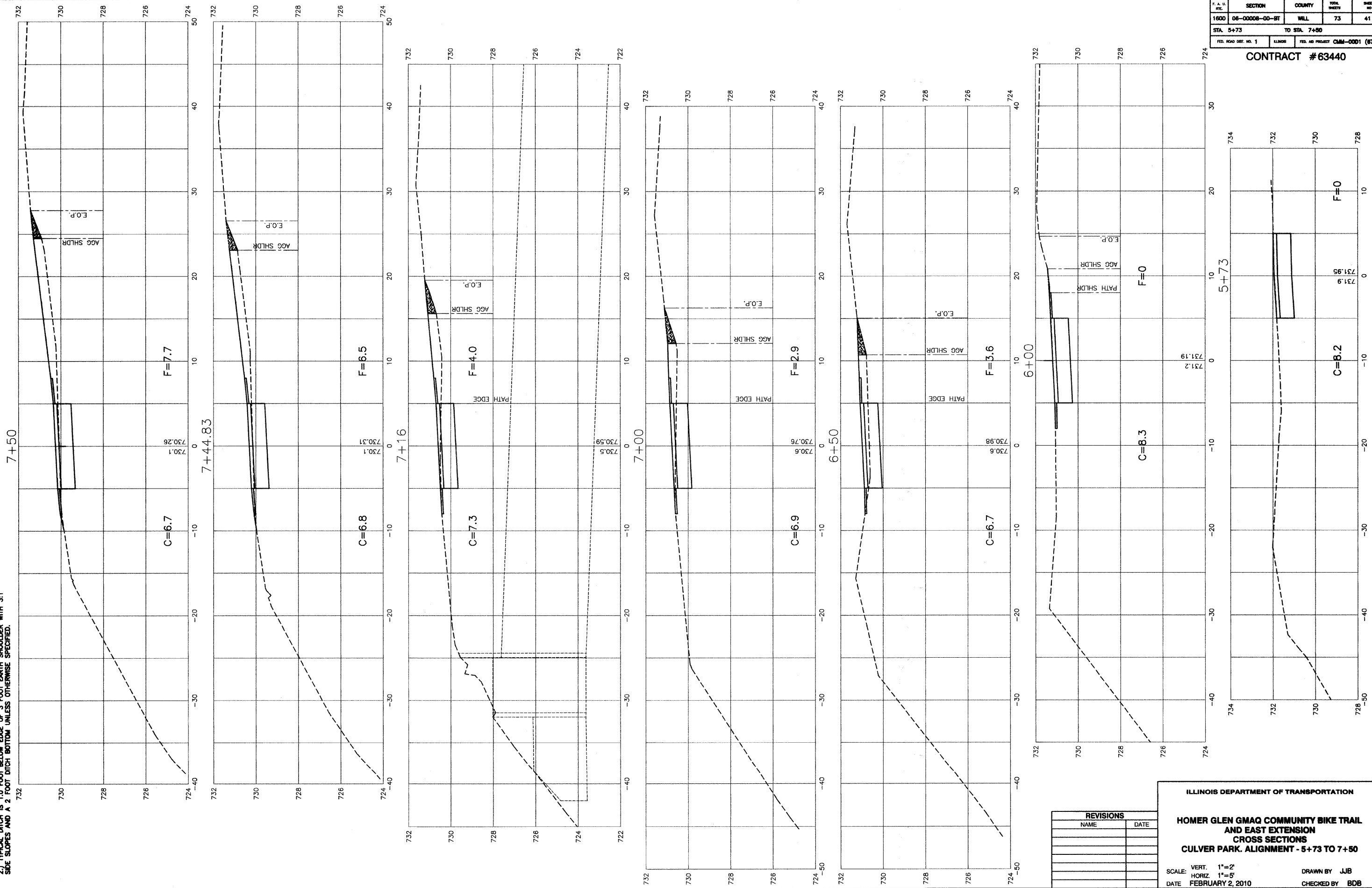

REVISIONS	
NAME	DATE

ILLINOIS DEPARTMENT OF TRANSPORTATION

**HOMER GLEN GMAQ COMMUNITY BIKE TRAIL AND EAST EXTENSION CROSS SECTIONS CULVER PARK, ALIGNMENT - 5+73 TO 7+50**

SCALE: VERT. 1"=2'  
 HORIZ. 1"=5'

DATE: FEBRUARY 2, 2010

DRAWN BY: JJB  
 CHECKED BY: BDB

ROBINSON ENGINEERING, LTD.  
 1700 SOUTH PARK AVENUE, SOUTH HOLLAND, ILLINOIS 60471  
 (708) 581-8700 FAX (708) 581-8888  
 ILLINOIS DESIGN FIRM REGISTRATION NO. 15402128

06231-XSCT-01-P2