

F. A. U. #	SECTION	COUNTY	TOTAL SHEETS	SHEET NO.
1600	06-0000B-00-BT	WILL	73	53
STA. 162+00		TO STA. 168+00		
FED. ROAD DIST. NO. 1	ILLINOIS	FED. AID PROJECT	CMM-0001 (673)	

CONTRACT #63440

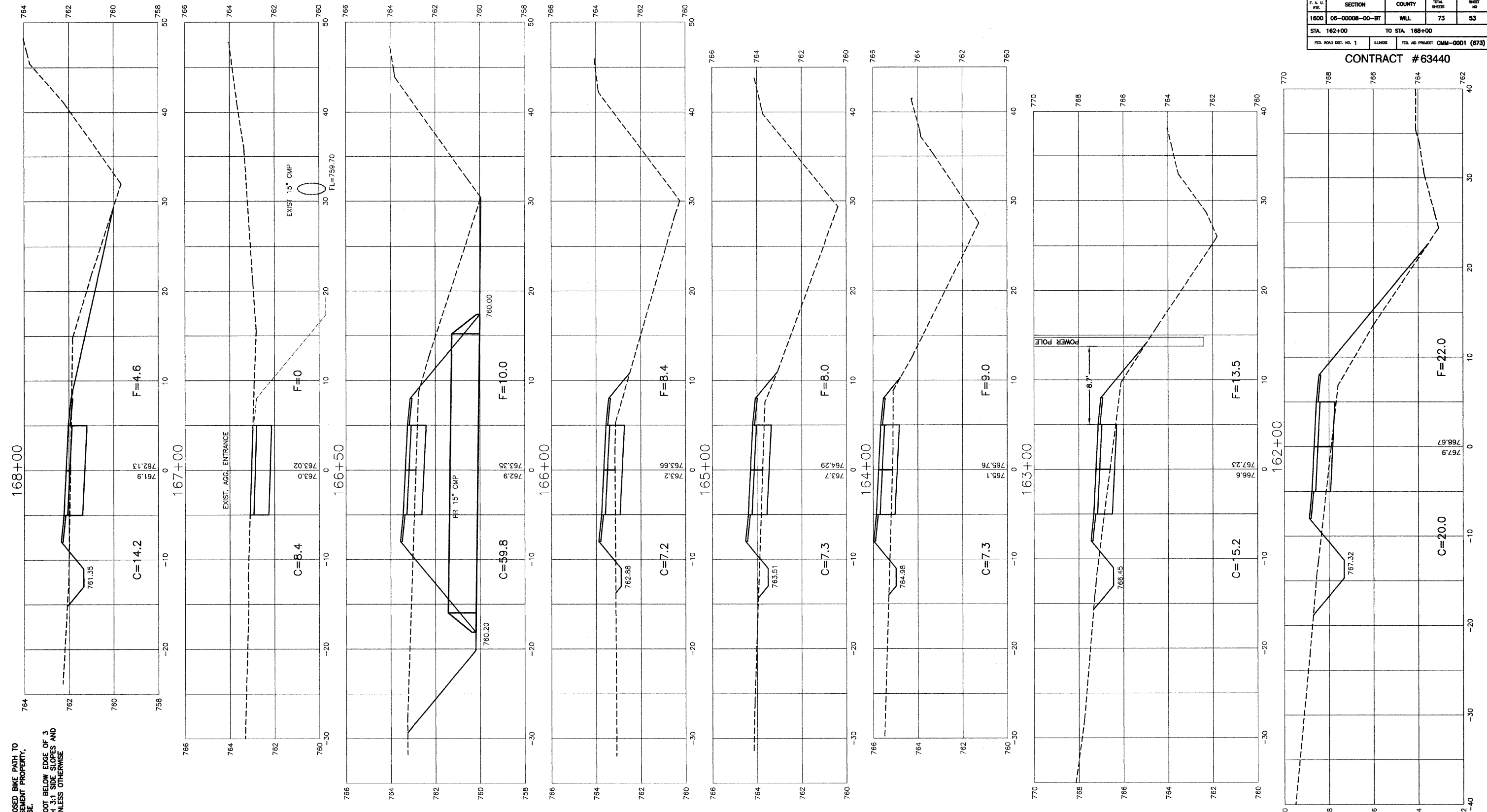

NOTES:  
 1.) CROSS SLOPE OF PROPOSED BIKE PATH TO DRAIN TOWARD COM-ED EASEMENT PROPERTY, UNLESS SPECIFIED OTHERWISE.  
 2.) TYPICAL DITCH IS 1.0 FOOT BELOW EDGE OF 3 FOOT EARTH SHOULDER WITH 3% SIDE SLOPES AND 5.0 FOOT DITCH BOTTOM UNLESS OTHERWISE SPECIFIED.

REVISIONS	
NAME	DATE

ILLINOIS DEPARTMENT OF TRANSPORTATION  
**HOMER GLEN GMAQ COMMUNITY BIKE TRAIL AND EAST EXTENSION**  
**BELL RD. ALIGNMENT - 162+00 TO 168+00**  
 SCALE: VERT. 1"=2'  
 HORIZ. 1"=5'  
 DATE: FEBRUARY 2, 2010  
 DRAWN BY: JJB  
 CHECKED BY: BDB