

F. A. U. ETC.	SECTION	COUNTY	TOTAL SHEETS	SHEET NO.
1800	06-00008-00-BT	WILL	73	62
STA. 257+00		TO STA. 264+00		
FED. ROAD DIST. NO. 1	ILLINOIS	FED. AID PROJECT	CMM-00D1 (673)	

CONTRACT #63440

NOTES:  
 1.) GROSS SLOPE OF PROPOSED BIKE PATH TO DRAIN TOWARD COM-ED EASEMENT PROPERTY, UNLESS SPECIFIED OTHERWISE.  
 2.) TYPICAL DITCH IS 1.0 FOOT BELOW EDGE OF 3 FOOT EARTH SHOULDER WITH 3:1 SIDE SLOPES AND A 2 FOOT DITCH BOTTOM UNLESS OTHERWISE SPECIFIED.

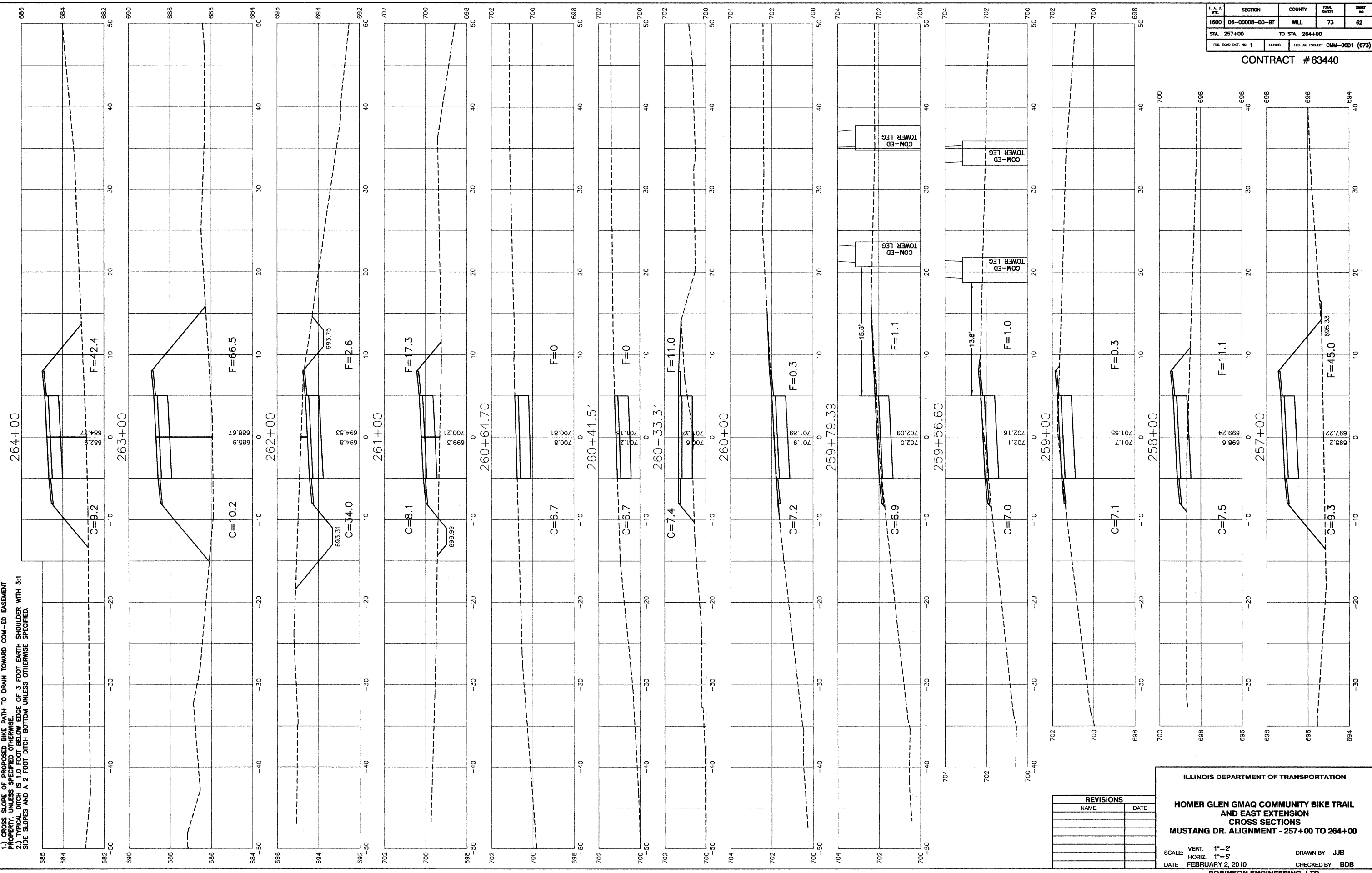

REVISIONS	
NAME	DATE

ILLINOIS DEPARTMENT OF TRANSPORTATION

**HOMER GLEN GMAQ COMMUNITY BIKE TRAIL AND EAST EXTENSION CROSS SECTIONS MUSTANG DR. ALIGNMENT - 257+00 TO 264+00**

SCALE: VERT. 1"=2'  
 HORIZ. 1"=5'

DATE: FEBRUARY 2, 2010

DRAWN BY: JJB  
 CHECKED BY: BDB