

GENERAL NOTES

- All new Fasteners shall be AASHTO M164 Type 1, mechanically galvanized bolts (in painted areas and M164 Type 3 in unpainted areas). Holes shall be subpunched or subdrilled 1/16" dia. and reamed in the field to 3/16" dia. for 3/4" dia. bolts, unless otherwise noted.
- Calculated weight of Structural Steel = 10,090 lbs.
- No field welding is permitted except as specified in the contract documents.
- Reinforcement bars shall conform to the requirements of ASTM A 706 Gr 60. See Special Provisions.
- Reinforcement bars designated (E) shall be epoxy coated.
- Prior to pouring the new concrete deck, all heavy or loose rust, loose mill scale, and other loose or potentially detrimental foreign material shall be removed from the surfaces in contact with concrete. Tightly adhered paint may remain unless otherwise noted. Removal shall be accomplished by methods that will not damage the steel and the cost will be included in the pay item covering removal of the existing concrete.
As directed by the Engineer, existing construction accessories welded to the top flange of beams and girders shall be removed. The weld areas shall be ground flush and inspected for cracks using magnetic particle testing (MT) or dye penetrant testing (PT) by qualified personnel approved by the Engineer.
Any cracks that cannot be removed by grinding 1/4 inch deep shall be identified and reported to the Bureau of Bridges and Structures for further disposition. The cost of removing welded accessories, grinding and inspecting weld areas and grinding cracks will be paid for according to Article 109.04 of the Standard Specifications.
- If the Contractor elects to use cantilever forming brackets on the exterior beams or girders, the brackets shall be placed at the same locations as required for the hardwood blocks in Article 503.06(b) of the Standard Specifications. If additional cantilever forming brackets are required, hardwood blocking shall be wedged between the exterior and first interior beam at each of these additional bracket locations.
- Plan dimensions and details relative to existing plans are subject to nominal construction variations. The Contractor shall field verify existing dimensions and details affecting new construction and make necessary approved adjustments prior to construction or ordering of materials. Such variations shall not be cause for additional compensation for a change in scope of the work, however, the Contractor will be paid for the quantity actually furnished at the unit price bid for the work.
- Bearing seat surfaces shall be constructed or adjusted to their designated elevations within a tolerance of 1/8 inch (0.01 ft.). Adjustment shall be made either by grinding the surface or by shimming the bearings.
- Concrete Sealer shall be applied to the designated areas of abutment seats, backwalls and Pier 3 seat.
- The existing structural steel coating contains lead. The Contractor shall take appropriate precautions to deal with the presence of lead on this project.
- The OZ/E/U Paint System shall be used for shop and field painting of new structural steel except where otherwise noted. The color of the final finish coat for all interior steel surfaces shall be gray, Munsell No 5B 7/1. See Special Provision for Cleaning and Painting New Metal Structures.
- Layout of slope protection system may be varied in the field to suit ground conditions as directed by the Engineer.
- The Contractor shall obtain a construction permit from the Illinois Department of Natural Resources (IDNR), Office of Water Resources for any temporary construction activity placed in the water except cofferdams. This shall include the placement of material for run-arounds, causeways, etc. Any permit application by the Contractor shall refer to the IDNR 3704 Floodway Construction permit number allowing permanent construction as shown in the contract plans.
- A minimum of 2 air monitors will be required to monitor abrasive blasting operations at this site, see special provision for "Containment and Disposal of Lead Paint Cleaning Residues".
- Cleaning and painting of the existing structural steel shall be as specified in the special provision for "Cleaning and Painting Existing Steel Structures". All beams, bearings and other structural steel within 5 ft. (measured along the beam) of either side of the deck joints shall be cleaned per Near White Blast Cleaning - SSPC-SP10. The exterior surfaces and bottom of the bottom flange of the fascia beams shall be cleaned per Power Tool Cleaning - Commercial Grade. All remaining structural steel shall be cleaned per Power Tool Cleaning - Modified SSPC-SP3.
The designated areas cleaned per Near White Blast Cleaning - SSPC-SP10 and per Power Tool Cleaning - Commercial Grade shall be painted according to the requirements of Paint System 1 - OZ/E/U. The designated areas cleaned per Power Tool Cleaning - Modified SSPC-SP3 shall be painted according to the requirements of Paint System 2 - PS/EM/U. The color of the final finish coat for all interior steel surfaces shall be Gray, Munsell No 5B 7/1. The color of the finish coat for the exterior and bottom flange of the fascia beams shall be Interstate Green. Munsell No 7.5G 4/8.

DESIGNED -	JLS
CHECKED -	MRB/KWS
DRAWN -	VH/MB
CHECKED -	MRB

STATE OF ILLINOIS
DEPARTMENT OF TRANSPORTATION

INDEX OF SHEETS

- S1 General Plan and Elevation 1 of 2
- S2 General Plan and Elevation 2 of 2
- S3 General Data
- S4 Concrete Removal
- S5 Miscellaneous Removal
- S6 Top of Slab Elevation Layout 1 of 2
- S7 Top of Slab Elevation Layout 2 of 2
- S8 Top of Slab Elevations 1 of 3
- S9 Top of Slab Elevations 2 of 3
- S10 Top of Slab Elevations 3 of 3
- S11 Top of North Approach Slab Elevations
- S12 Top of South Approach Slab Elevations
- S13 Deck Reinforcement Plan 1 of 3
- S14 Deck Reinforcement Plan 2 of 3
- S15 Deck Reinforcement Plan 3 of 3
- S16 Parapet Elevation
- S17 Deck Cross Section and Details
- S18 Deck Details
- S19 Bridge Approach Slab Details 1 of 2
- S20 Bridge Approach Slab Details 2 of 2
- S21 Preformed Joint Strip Seal
- S22 Drainage Scupper, DS-12
- S23 Structural Steel Repairs 1 of 2
- S24 Structural Steel Repairs 2 of 2
- S25 Bearings Details 1 of 2
- S26 Bearings Details 2 of 2
- S27 Abutment Details 1 of 3
- S28 Abutment Details 2 of 3
- S29 Abutment Details 3 of 3
- S30 Pier 1 and 2 Repairs
- S31 Pier 3 Repair 1 of 2
- S32 Pier 3 Repair 2 of 2
- S33 Pier 4 and 5 Repairs
- S34 Bar Splicer Assembly and Mechanical Splicer Details
- S35 Concrete Parapet Slipforming Option
- S36-S47 Existing Plan Information

DES PLAINES RIVER
RE-BUILT 20__ BY
WILL COUNTY
SECTION 04-00090-07-BR
F.A.U. RT. 341 STA. 16+65
STRUCTURE NO. 099-3298
LOADING HS-20

NAME PLATE

Existing Name Plate shall be cleaned and relocated next to new Name Plate. Cost included with Name Plates. See Std. 515001.

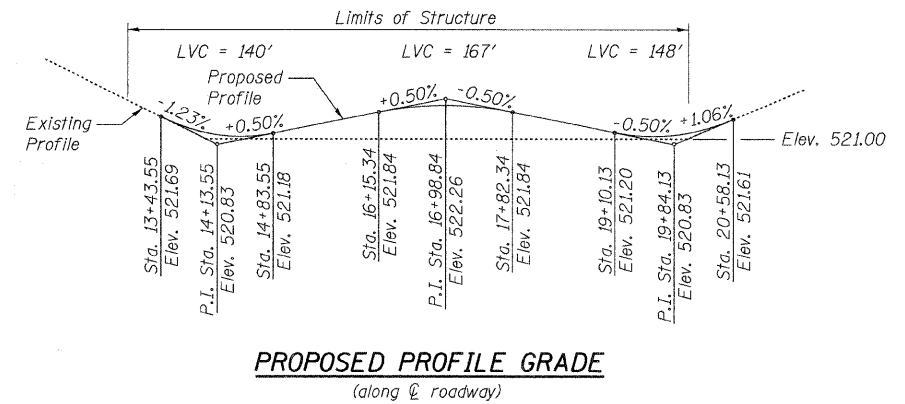

TOTAL BILL OF MATERIAL

ITEM	UNIT	SUPER	SUB	TOTAL
Porous Granular Embankment, Special	Cu. Yd.		126	126
Stone Riprap, Class A4	Sq. Yd.		375	375
Filter Fabric	Sq. Yd.		375	375
Approach Slab Removal	Sq. Yd.	240		240
Concrete Removal	Cu. Yd.		39.9	39.9
Slope Wall Removal	Sq. Yd.		375	375
Removal of Existing Concrete Deck	L Sum		1	1
Protective Shield	Sq. Yd.	2334		2334
Structure Excavation	Cu. Yd.		156	156
Concrete Structures	Cu. Yd.		69.4	69.4
Concrete Superstructure	Cu. Yd.	900.0		900.0
Bridge Deck Grooving	Sq. Yd.	2224		2224
Protective Coat	Sq. Yd.	2961		2961
Furnishing and Erecting Structural Steel	L Sum		1	1
Stud Shear Connectors	Each	2580		2580
Jack and Remove Existing Bearings	Each	30		30
Structural Steel Removal	Pound	3790		3790
Cleaning and Painting Steel Bridge	L Sum		1	1
Containment and Disposal of Lead Paint Cleaning Residues	L Sum		1	1
Reinforcement Bars, Epoxy Coated	Pound	199,720	11,750	211,470
Bar Splicers	Each		62	62
Name Plates	Each		1	1
Preformed Joint Strip Seal	Foot	96.0		96.0
Elastomeric Bearing Assembly, Type I	Each	10		10
Elastomeric Bearing Assembly, Type II	Each	10		10
Anchor Bolts, 1"	Each	40		40
Anchor Bolts, 1 1/4"	Each	20		20
Concrete Sealer	Sq. Ft.		755	755
Epoxy Crack Injection	Foot		198	198
Geocomposite Wall Drain	Sq. Yd.		65	65
Pipe Underdrains For Structures 4"	Foot		104	104
Barrier Wall Markers, Type C	Each	20		20
Drainage Scuppers, DS-12	Each	8		8
Structural Repair of Concrete (Depth Greater Than 5 Inches)	Sq. Ft.		35	35
Structural Repair of Concrete (Depth Equal to or Less Than 5 Inches)	Sq. Ft.		44	44

GENERAL DATA
STRUCTURE NO. 099-3298

SHEET NO. S3	F.A.U. RTE.	SECTION	COUNTY	TOTAL SHEETS	SHEET NO.
	341	04-00090-07-BR	WILL	57	11
S47 SHEETS	CONTRACT NO. 63442				
FED. ROAD DIST. NO.		ILLINOIS	FED. AID PROJECT		

benesch

alfred benesch & company
Engineers - Surveyors - Planners
205 North Michigan Avenue, Suite 2400
Chicago, Illinois 60601
312-565-0450 Job No. 3808.02