

TRAFFIC CONTROL PLAN

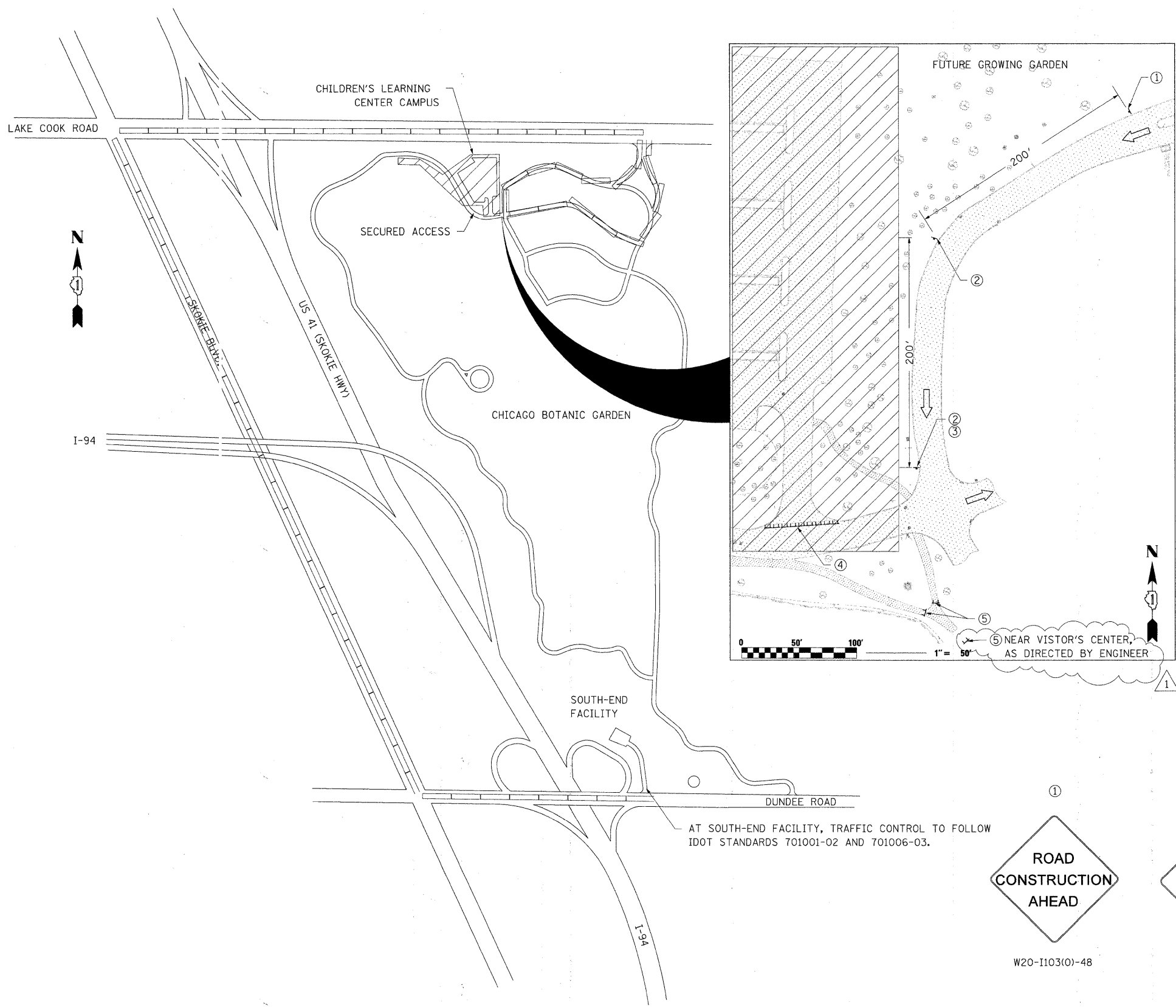

AT SOUTH-END FACILITY, TRAFFIC CONTROL TO FOLLOW IDOT STANDARDS 701001-02 AND 701006-03.

GENERAL NOTES FOR TRAFFIC CONTROL

THE CONTRACTOR WILL FOLLOW ENTRANCE AND EXIT ROUTES AS DIRECTED BY THE ENGINEER.

ALL TRAFFIC CONTROL DEVICES SHALL CONFORM TO THE TRAFFIC CONTROL PLANS OR THE LATEST EDITION OF THE STATE OF ILLINOIS SUPPLEMENT TO THE NATIONAL "MANUAL OF UNIFORM TRAFFIC CONTROL DEVICES FOR STREETS AND HIGHWAYS" (MUTCD) AND SHALL BE IN PLACE BEFORE CONSTRUCTION COMMENCES.

THE TRAFFIC CONTROL PLANS SHALL SERVE AS A GUIDE FOR THE SAFE DIVERSION OF TRAFFIC DURING THE EXECUTION OF THIS CONTRACT. ANY CONTRACTOR-PROPOSED TRAFFIC CONTROL PLANS SHALL BE SUBMITTED FOR THE WRITTEN APPROVAL OF THE ENGINEER.

THE SIZES OF THE SIGNS NOT SPECIFIED IN THESE PLANS SHALL BE AS REQUIRED BY THE "MUTCD".

ALL EXISTING SIGNING THAT IS NOT APPLICABLE WHILE THE CONSTRUCTION IS IN EFFECT SHALL BE COMPLETELY COVERED OR REMOVED BY THE CONTRACTOR.

ALL BARRICADES, VERTICAL PANELS, AND/OR DRUMS SHALL BE EQUIPPED WITH MONO-DIRECTIONAL STEADY BURNING LIGHTS.

THE CONTRACTOR SHALL BE RESPONSIBLE FOR ENSURING THAT ALL BARRICADES, SIGNS, LIGHTS, AND OTHER DEVICES INSTALLED BY HIM/HER ARE IN PLACE AND OPERATIONAL 24 HOURS EACH DAY INCLUDING SUNDAYS AND HOLIDAYS DURING THE TIME THIS CONSTRUCTION IS IN EFFECT.

AS A MINIMUM, ALL AMBER FLASHING LIGHTS THAT ARE REQUIRED SHALL MEET THE REQUIREMENTS FOR A LOW INTENSITY FLASHING LIGHTS IN ARTICLE 1084.01 OF THE STANDARD SPECIFICATIONS. ALL LIGHTS SHALL OPERATE DURING HOURS OF DARKNESS. ONLY LIGHTS THAT HAVE BEEN APPROVED BY IDOT SHALL BE USED.

THE EXACT NUMBER, LOCATION, AND SPACING OF ALL SIGNS AND TRAFFIC CONTROL DEVICES MAY BE ADJUSTED TO FIT FIELD CONDITIONS AS DIRECTED BY THE ENGINEER.

ALL UNBALLASTED TYPE I AND TYPE II BARRICADES SHALL HAVE TWO SANDBAGS ON THE BOTTOM RAIL.

LEGEND

- ROUTE TO AND FROM THE NORTH-END FACILITY TO THE SOUTH-END FACILITY
- WORK ZONE
- TYPE III BARRICADE W/2 FLASHING BEACONS (NO. OF BARRICADES AS DIRECTED BY ENGINEER)
- DIRECTION OF TRAFFIC
- CONSTRUCTION SIGN

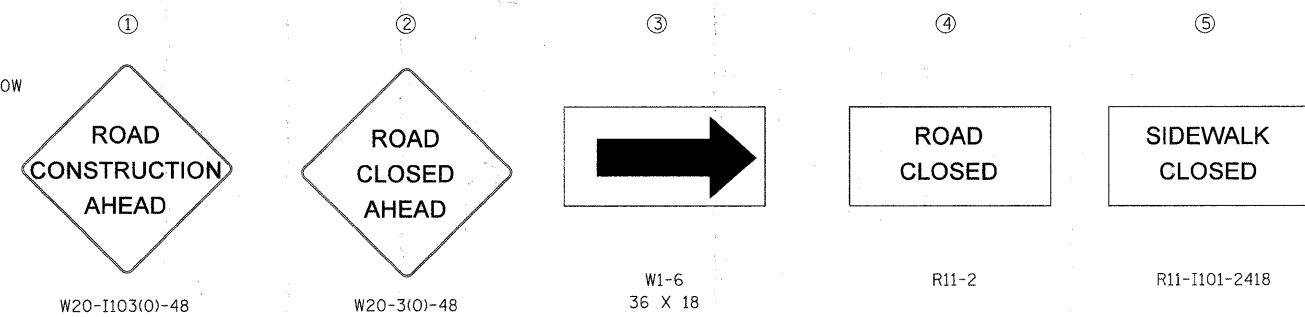

FILE NAME = 49105_sht_trafficcontrol.dgn	USER NAME = supencheck	DESIGNED - LLS	REVISED - 03/24/2010 ADD. NO. 1
DESIGNED BY HNTB	PLOT DATE = 24-MAR-2010	DRAWN - LLS	REVISED - ---
		CHECKED - KJK	REVISED - ---
		DATE - 02/16/2010	REVISED - ---

STATE OF ILLINOIS
DEPARTMENT OF TRANSPORTATION

CHICAGO BOTANIC GARDEN - CLC ENTRYWAY
TRAFFIC CONTROL PLAN

SCALE: NTS SHEET NO. 1 OF 1 SHEETS STA. N/A TO STA. N/A

F.A. RTE. N/A	SECTION 08-00061-00-RS	COUNTY COOK	TOTAL SHEETS 28	SHEET NO. 6
CONTRACT NO. 63449				
FED. ROAD DIST. NO. ILLINOIS FED. AID PROJECT				