

Traffic Control Plan STAGE I

Refer to Standard 701321 for additional signs, details & devices

City
of
Geneseo

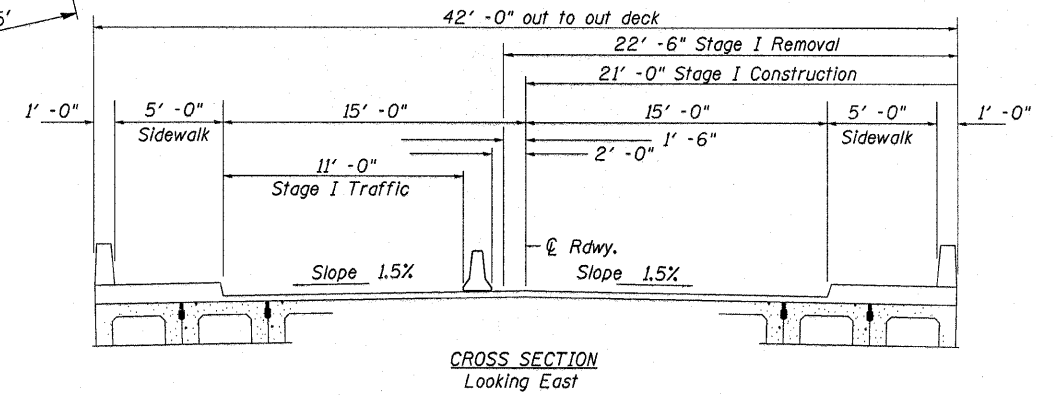
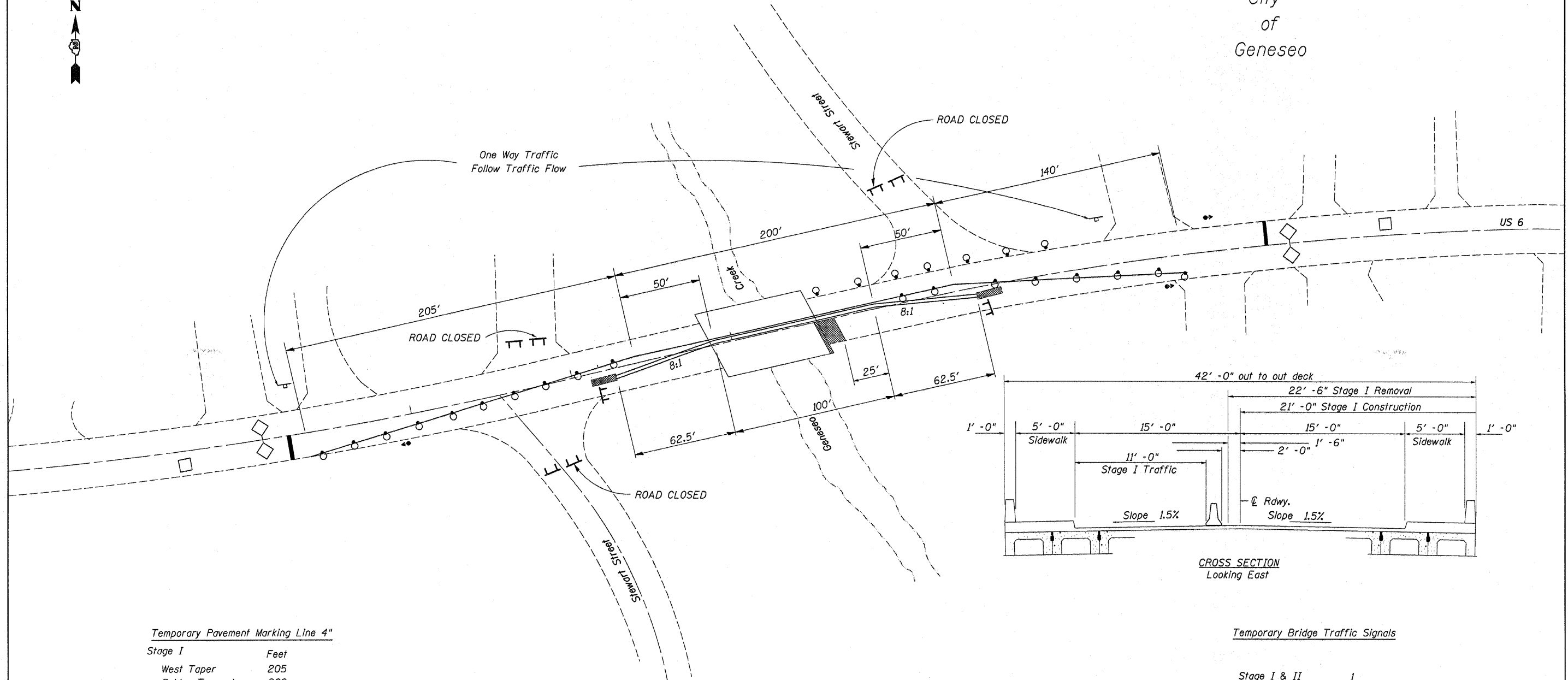
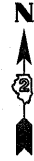

CROSS SECTION
Looking East

Temporary Pavement Marking Line 4"

Stage I	Feet
West Taper	205
Bridge Tangent	200
East Taper	140

Stage II

West Taper	136
Bridge Tangent	225
East Taper	180
Total	1086 Feet

Temporary Pavement Marking Line 24"

Stop Bars	Feet
US 6 EB	12
US 6 WB	12
Total	24 Feet

Temporary Concrete Barrier

Stage I	Feet
West Taper	62.5
Bridge Tangent	100
East Taper	62.5
Total	225 Feet

Temporary Impact Attenuator

Stage I	Each
West	1
East	1
Total	2 Each

Temporary Bridge Traffic Signals

Stage I & II	1
	1

Note: Reduce sign spacing to 200' where the speed limit is 30 MPH.

FILE NAME =	USER NAME = linkdj	DESIGNED -	REVISED -	STATE OF ILLINOIS DEPARTMENT OF TRANSPORTATION	Traffic Control Plan Stage I		F.A.U. RTE.	SECTION	COUNTY	TOTAL SHEETS	SHEET NO.			
Di:\BRYCADD plans\Henry County\0370133\Planeng.dgn		DRAWN -	REVISED -		SCALE: _____	SHEET NO. _____	OF _____ SHEETS	STA. _____	TO STA. _____	5671	(4B-1R-M)	Henry	13	4
		CHECKED -	REVISED -								CONTRACT NO. 64F97			
		DATE -	REVISED -								ILLINOIS FED. AID PROJECT			